

TECHNICAL DATA SHEET

DOC NUMBER:	REVISION:	ISSUE:	DATE:
EMF-TR-002	01	00	17 JUNE 2023

EMPIRE
METAL FABRICATORS
EMFab

EMFAB TEMPRAIL ANCHOR

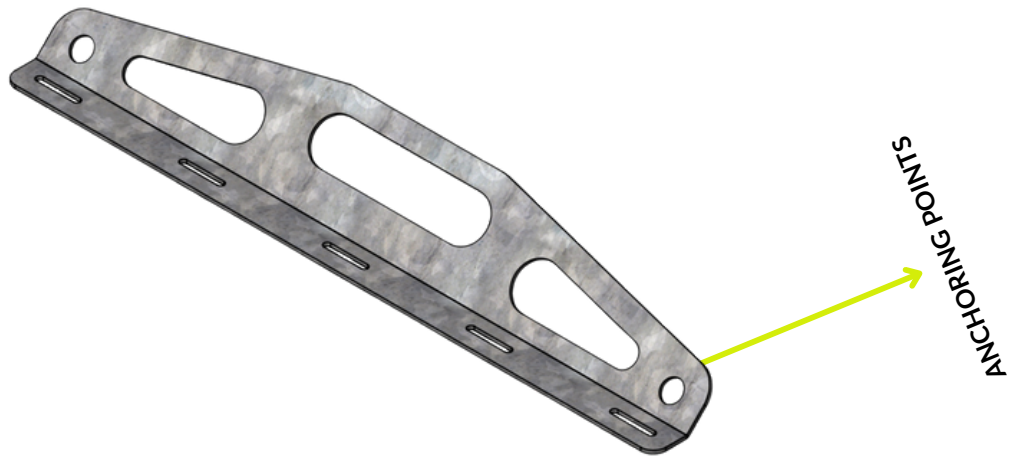

ANCHOR DESCRIPTION:

Our anchor is made from a durable 4mm mild steel plate, providing strength and reliability. It is powder coated in black, adding a sleek and professional finish. With a weight of 5.81kg, the anchor offers stability and security. The anchor comes equipped with six IBR pan stabilizers, which are securely attached, providing additional support and balance. It also features an easy-to-carry handle and seven anchoring attachment points, allowing for convenient transportation and flexibility in positioning. Moreover, the anchor includes four holes for hooks, enabling the attachment of lifelines or retractable devices. In addition, the anchor is supplied with seven class 3 hex zap self-drilling 65mm topspeed screws and seven topspeed 26mm bonded washers, ensuring easy installation and optimal performance. Overall, our anchor is a robust and versatile solution for all your anchoring needs.

WHY CHOOSE EMFAB'S ROOF ANCHORS:

With over 30 years of roofing experience amongst EMFab's Top Management, our roof anchor systems are specifically designed for different roof types with our top priority being to provide fall protection for workers who perform tasks at height. They are engineered with precision to ensure maximum safety, and our expert team can install them quickly and efficiently. All our anchors are designed and tested to carry over 15kN weight. Our fall protection equipment complies with OHSA regulations and is designed to keep workers safe while on the job.

ANCHOR SIZE:

Length : 1 100mm
Height : 150mm
Width : 190mm

MATERIAL:

Mild Steel

MAXIMUM PERMISSIBLE RATE OF DESENT:

Maximum of 2 Person

MAXIMUM DESCENT DISTANCE:

6 Meters

TEST COMPLIANCE:

Pull Tester - 15KN for 3 minutes