

# FOR SUBLEASE

14074 RANCHO COURT

COMMERCE CENTER | FONTANA



## HIGHLIGHTS

- Office Space: 5,000 SF
- 32' Clear Height
- ESFR Sprinklers
- Ten (10) Dock High Doors
- One (1) Ground Level Door
- Secured Truck Court (135')
- 4-Ply Built Up Asphalt Roof with ten (10) year, no dollar limit warranty from the manufacturer
- Scrim Foil Insulation

## AVAILABLE SPACE

**100,039 SF**

## OFFICE SIZE

**5,000 SF**

## TERMS EXPIRATION

**8/31/2027**

### Jeff Huberman

Principal  
P | 562.568.2024  
E | [jhuberman@lee-associates.com](mailto:jhuberman@lee-associates.com)  
Lic. ID 01224138

### Spencer Casement

Principal  
P | 562.568.2045  
E | [scasement@lee-associates.com](mailto:scasement@lee-associates.com)  
Lic. ID 01813874

# DISTANCE MAP

## COMMERCE CENTER | FONTANA

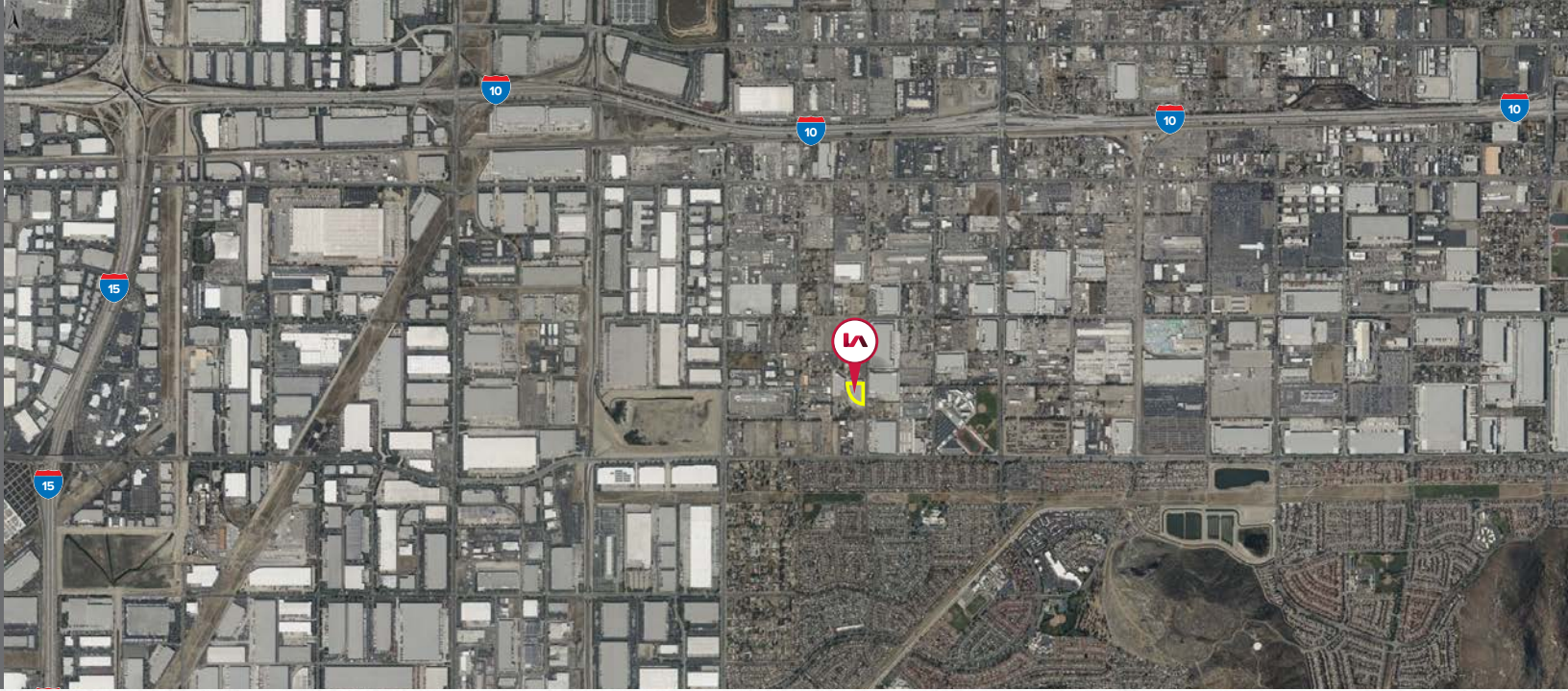

14074 Rancho Ct. | Fontana, CA

The information contained herein is obtained from sources believed to be reliable. However, we have not verified it and make no guarantees, warranties or representations as to the completeness or accuracy thereof. The presentation of this property is used for example and is submitted subject to errors, omissions, change of price or conditions, and is subject to prior sale, lease or withdrawal without notice.

# SITE PLAN

## COMMERCE CENTER | FONTANA

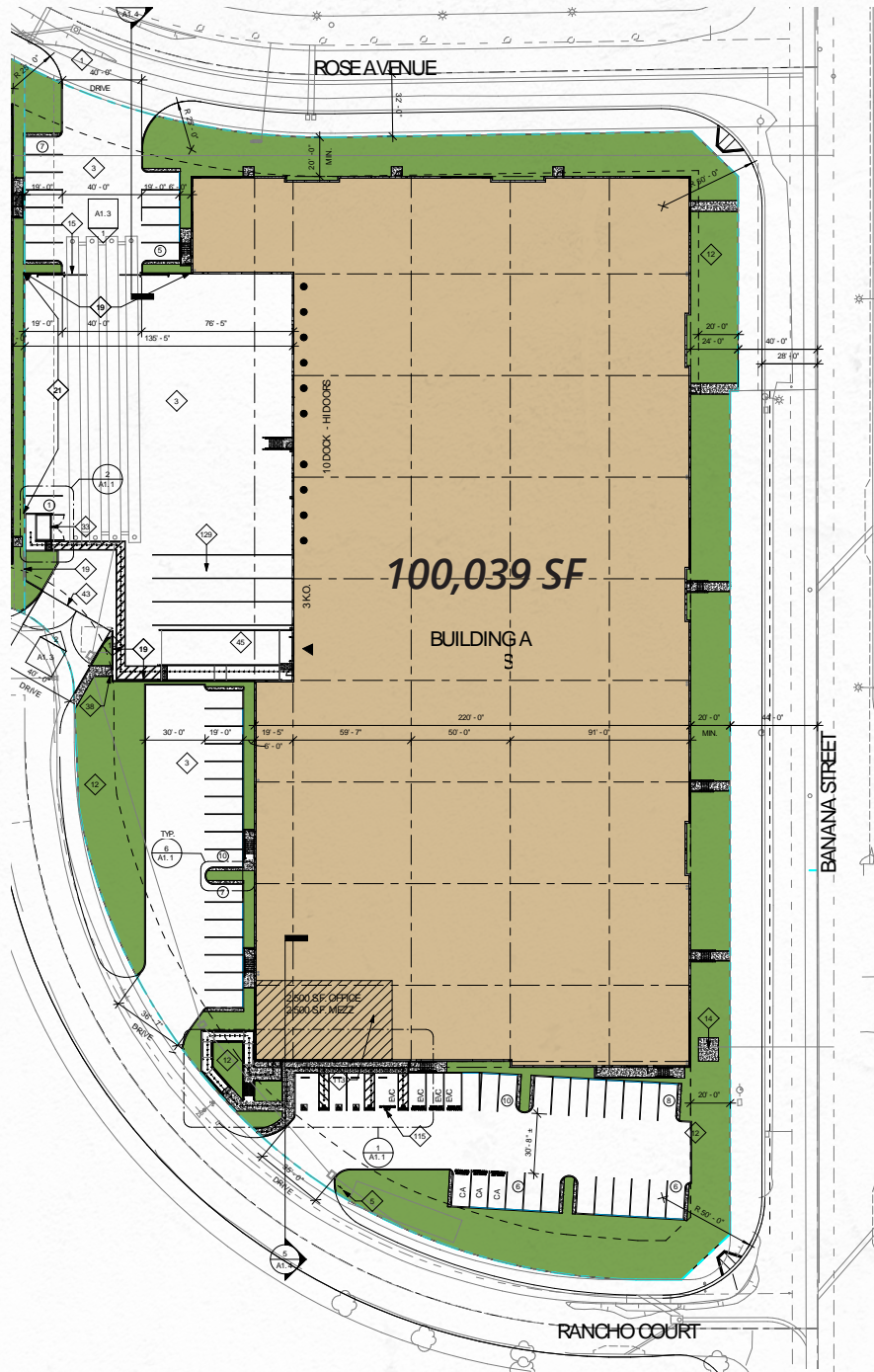

14074 RANCHO CT FONTANA, CA

SITE PLAN

14074 Rancho Ct. | Fontana, CA

The information contained herein is obtained from sources believed to be reliable. However, we have not verified it and make no guarantees, warranties or representations as to the completeness or accuracy thereof. The presentation of this property is used for example and is submitted subject to errors, omissions, change of price or conditions, and is subject to prior sale, lease or withdrawal without notice.