

Type _____
Project _____
Date _____

Citadel Round Vapor Tight Light

Description

The Citadel Round™ Compact Vapor Tight LED Low Bay packs the Citadel platform into a clean 18" round footprint built for tight low bay spaces. SLP's PinSert™ System replaces bulky latches for a sleeker profile, and the fixture achieves IP65, IP66, IP67, and IP69 ratings with a 1500 PSI washdown rating. The UL 5VA fiberglass housing won't melt or burn, and the poured-in-place polyurethane gasket ensures exceptional sealing. NSF-certified for food processing, it's ideal for processing plants, parking garages, and industrial low bay applications.



Fiberglass Housing



Part Number Breakdown Example

BASE							OPTIONS					
CTR	18DFA	16L40	90	H	DTO	D	HK	E10	C10	OS		
Family	Length	Lens Options	Lumens	CCT	CRI	Voltage	Dimming	Driver Config.	Mounting	Emergency	Cord	Control
Citadel Round	18: 18"	DCA: Drop Clear Acrylic DFA: Drop Frosted Acrylic DCP: Drop Clear PC DFP: Drop Frosted PC	16L: 16,000 lm XL: xx,000 lm*	30: 3000K 35: 3500K 40: 4000K 50: 5000K	Blank: 80 CRI 90: 90 CRI	Blank: Universal (120-277 VAC) H: High (347-480 VAC)	Blank: 0-10V DTO: Dim to OFF	Blank: One Driver D: Dual Drivers	HK: ¾" Hook H: ¾" Die Cast Hub	E10: 10 W Emergency	C10: 10 ft White C10P: 10 ft White Cord with Plug	OS: PIR Occupancy Sensor

*Note: SLP offers extended lumen packages, ask our customer service for more info

Benefits and Features

- Non-combustible UL 5VA fiberglass housing won't melt or burn
- UV-stabilized f1 rating for continuous outdoor exposure
- UL 746 certified for water exposure and immersion
- Poured-in-place polyurethane gasket creates watertight seal
- 34% more lens-to-gasket contact for superior sealing
- Fungus-resistant gasket prevents biological growth
- Patent-pending PinSert™ System replaces bulky latches
- IK10-rated impact-resistant acrylic or polycarbonate lens options
- Separate driver and board trays improve heat dissipation
- Compact 18" round, 6" tall low bay footprint
- Made in USA with BAA/BABA compliance

Electrical

- Universal voltage operation (120-277 VAC) standard.
- High voltage option available (347-480 VAC).
- Standard 0-10V dimming for lighting control integration.
- Dim-to-off capability for maximum energy savings.
- Multi-CCT switchable options (3000K/4000K/5000K).

Applications

- Parking garages and covered parking structures
- Food processing facilities requiring washdown capabilities
- Cold storage warehouses and walk-in freezers
- Manufacturing facilities with dust and moisture
- Low ceiling industrial areas and mezzanines
- Loading docks and shipping/receiving areas
- Commercial kitchens and prep areas
- Car wash facilities
- Aircraft hangars and aviation maintenance facilities
- Indoor pools and aquatic facility decks

Certifications

- UL 1598 listed for wet location applications.
- NSF International certified for food service environments.
- IP65, IP66, IP67, and IP69 ingress protection ratings.
- NEMA 4X rated for corrosive and outdoor conditions.
- RoHS compliant for environmental safety.
- DLC QPL qualified for energy rebate programs.





Specification Sheet Citadel Round

Type _____
Project _____
Date _____

Installation

- Multiple mounting options: hook, pendant, or J-box
- 316 stainless steel hook option for corrosive environments
- Snap-in retainer clips simplify board tray access
- Hub configurations available in 1/2" or 3/4" NPT
- Flexible cable or rigid ceiling mount configurations available

Dimensional Diagram

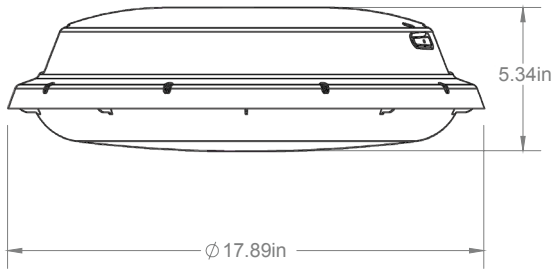

Component Assembly View

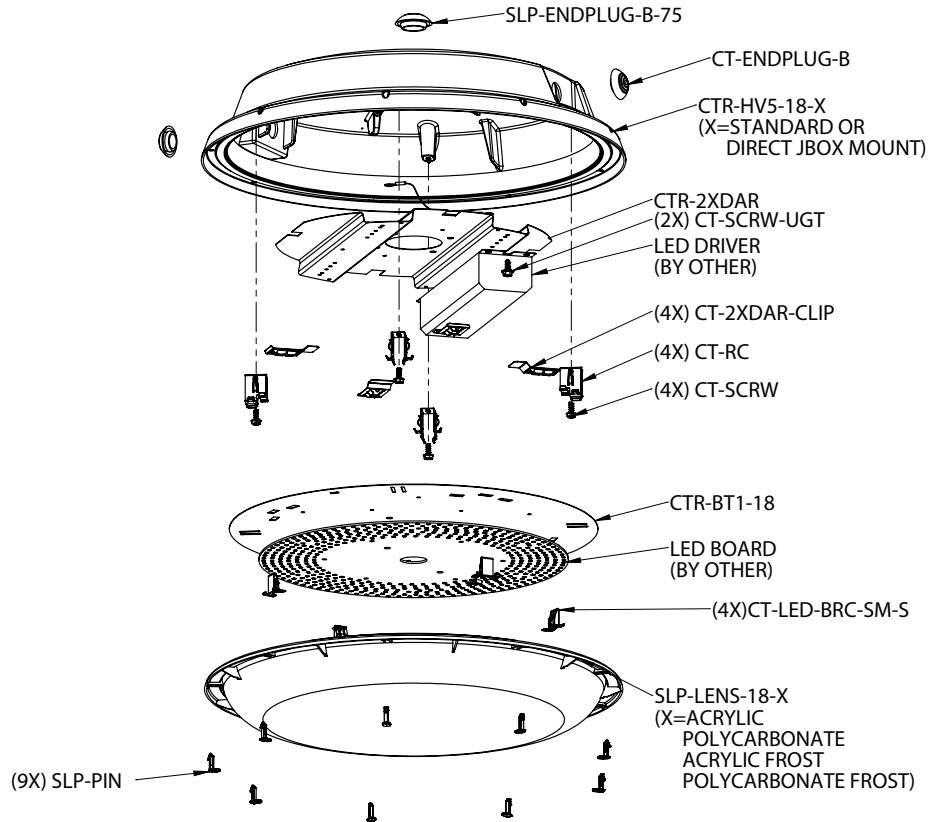

1400 S Old Highway 141
Fenton, MO 63026
www.slplighting.com
636.660.4084

Contact customer support for all product options.
Note: Product specifications and details subject to change without notification.



Made in USA · BAA & BABA Compliant · Version 1.2 06/19/26



Specification Sheet
Citadel Round

Type _____
Project _____
Date _____

General Specifications

Physical	Value
Dimensions (D x H)	17.89" x 5.34"
Weight / Housing Material	X lbs* / UL 5VA Fiberglass
Lens Material	Acrylic or Polycarbonate
Lens Options	Clear, FR50 Frosted
Electrical	Value
Input	120-277 VAC (Universal)
High Voltage Option	347-480 VAC
Frequency	50/60 Hz
Power Factor	>0.90
Dimming / Option	0-10V Standard / Dim-to-off
Performance	Value
Lumen Packages	12,000 - 30,000 lumens
Wattage Range	XW - XW
Efficacy	Up to 175 lm/W
CCT Options	3000K, 3500K, 4000K, 5000K
CRI	80 (Standard), 90 (Optional)
Operating Temp	-40°F to 131°F (-40°C to 55°C)
Environmental	Value
IP Rating	IP65, IP66, IP67, IP69
NEMA Rating	4X
NSF	Certified (Near Food Safe)
UL Listing	Wet Location, UL 1598
Warranty	5 Year**
Mounting	Value
Mounting Option	Hook, Pendant, J-Box
Hub Sizes	½" NPT, ¾" NPT
Continuous Row	No

*Note: Weight varies from lumen packages, mounting and options

**Note: 5-Year Warranty based on our Limited Warranty Document



1400 S Old Highway 141
Fenton, MO 63026
www.splighting.com
636.660.4084

Contact customer support for all product options.
Note: Product specifications and details subject to change without notification.



Made in USA · BAA & BABA Compliant · Version 1.2 06/19/26