

CircLED™ Round LED High Bay Light

Description

The CircLED™ high bay is a high-performance lighting solution for industrial and commercial use. Constructed from a thermally conductive molded polymer, its design offers a lighter alternative to traditional die-cast fixtures while ensuring optimal thermal management. An IP65-rated fixture protects the unit from dust and water jets, providing long-term durability in environments.



FR50 VO Polycarbonate Drop Lens



Clear VO Polycarbonate Flat Lens



Part Number Breakdown Example

CLD	18	PC-FR50	L30	40K	U	75	CS6P
Family	Housing	Lens Options	Lumens	CCT	Voltage	Mounting	Cord and Length
CLD: CircLED	18: 18" housing diameter	PC: Polycarbonate PC-FR50: Polycarbonate Frosted CLR-18D: Clear 18" FR50-18D: Frosted	Lxx: x lumens	40K: 4000K 50K: 5000K	U: Universal 120–277 VAC H: High 347–480 VAC	75: Eyebolt	CSx: Custom Length CS6P: 6ft Cord with Plug

Features and Benefits

- A lightweight alternative to die-cast fixtures, weighing just 15 lbs.
- IP65 rated for protection against dust and water jets.
- Thermally conductive polymer housing ensures superior heat dissipation and a long operational lifespan.
- Contractor-friendly and easy to install.
- Designed for use with a round LED module and can accommodate an occupancy sensor.
- Available with a drop lens to control glare or a flat lens.
- Optional white wall diffuse reflector to boost lumen output.
- UL 1598 listed and made in the USA.

Certifications

- UL 1598 listed.
- IP65 rated.
- The product is US manufactured.

Installation

- It is designed for easy, contractor-friendly installation.
- The central threaded post holds the LED array and is enclosed with a liquid-tight plug.
- Mount with provided eyebolt
- Universal (120–277 VAC) or High Voltage (347–480 VAC) driver options available
- It includes a cord grip boss for 3/4" NPT/M20 fittings.

Applications

- Manufacturing, warehouse, and distribution facilities
- Automotive repair shops and service bays
- Food processing plants requiring easy cleaning (NSF option only)
- Aircraft hangars with vibration and temperature extremes
- Industrial laundries and textile facilities
- Metal fabrication shops with welding operations
- Gymnasiums and University buildings
- Electronics manufacturing clean rooms

Electrical

- Designed for a round high bay driver, Meanwell or Sosen.
- Remote Box option available
- Available in a variety of wattage and lumen configurations

Dimensional Diagram

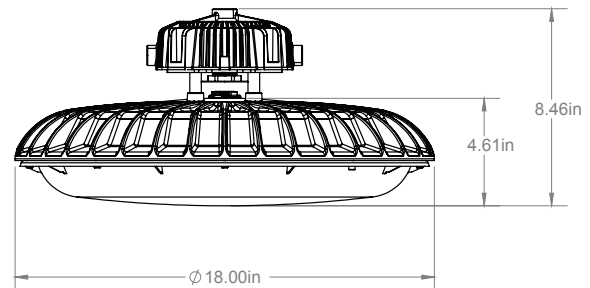

Component Assembly View

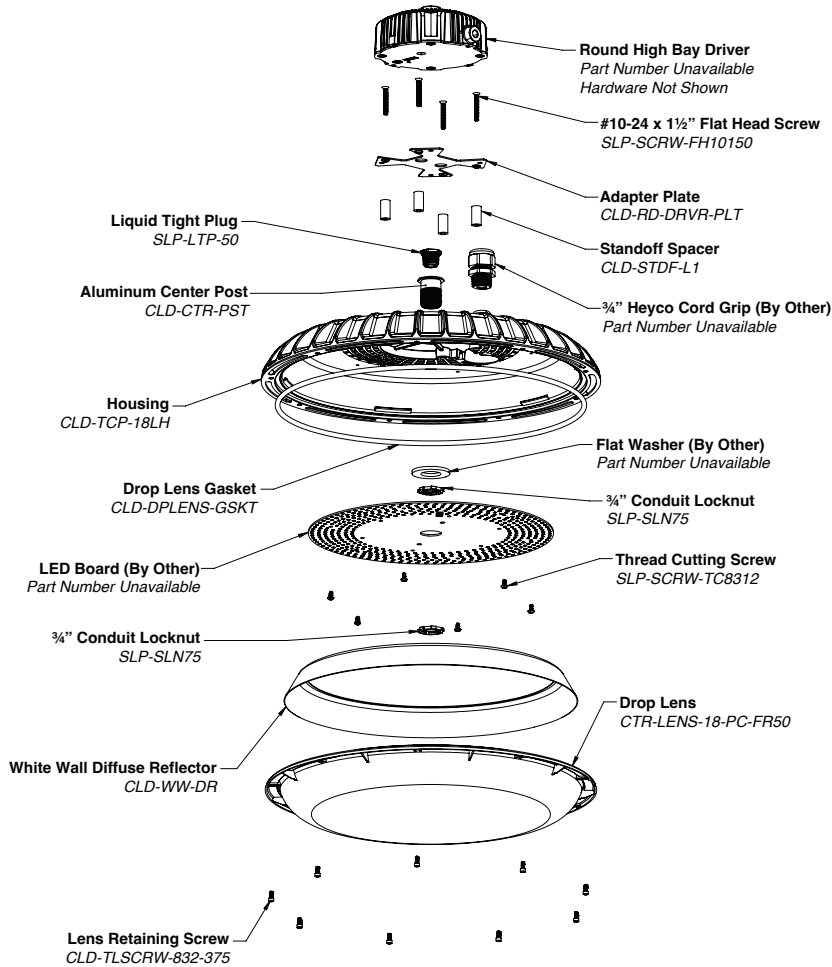



Specification Sheet

CircLED™

Type _____
Project _____
Date _____

General Specifications

Physical	Value
Dimensions (D x H)	18" x 8.46"
Weight / Housing Material	15 lbs* / Thermally Conductive Polymer Housing
Lens Material	Acrylic or Polycarbonate
Lens Options	FR50 Frosted Drop Lens, Clear Flat Lens
Electrical	Value
Input	120-277 VAC (Universal)
High Voltage Option	347-480 VAC
Frequency	50/60 Hz
Power Factor	>0.90
Dimming / Option	0-10V Standard / Dim-to-off
Performance	Value
Lumen Packages	5,000–30,000 lumens
Wattage Range	16–37W
Efficacy	Up to 140 lm/W
CCT Options	4000K, 5000K
CRI	80
Operating Temp	-40°F to 131°F (-40°C to 55°C)
Environmental	Value
IP Rating	IP65
UL Listing	Wet Location, UL 1598
Warranty	5 Year**
Mounting	Value
Mounting Option	Eyebolt

*Note: Weight varies from lumen packages, mounting and options

**Note: 5-Year Warranty based on our Limited Warranty Document



1400 S Old Highway 141
Fenton, MO 63026
www.splighting.com
636.660.4084

Contact customer support for all product options.
Note: Product specifications and details subject to change without notification.



Made in USA · BAA & BABA Compliant · Version 1.2 12/15/25