

The Citadel Round™ is a combination of the Citadel Enclosures' best features in a smaller, round unit for tight, low bay areas that need LED light. Latches are replaced with SLP's PinSert System giving it a super sleek and clean look.

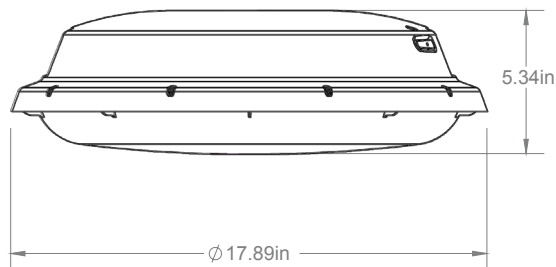

Features & Benefits

- Compact Size: Nominal 18" round, 6" tall
- Designed for complete compatibility with LEDs
- PinSert System (patent pending) with a poured-in-place gasket
- No bulky latches
- Familiar Economical Mounting Options
 - SLP Hook
 - Pendant
 - J-Box Housing (CTR-HV5-18-PIP-JB)
 - Grippler Cable
- Separate driver and LED board mounting surfaces
- Flat, round LED reflector tray
- Board retention clips quickly snap the boards into place
 - Scratch proof and conductivity inhibitor coating on clips
- IK10 rated diffusers resist breakage and reduce replacement costs
 - Water Clear
 - Frosted
- Utilizes SLP Hubs ½" and ¾" NPT fitting

Applications

- Low bay areas requiring a smaller LED enclosure
- Replacement for existing round installations
- Ideal for both industrial and architectural environments
- Parking garages
- Food processing

Certifications

- UL wet location
- UL evaluated for 25°C and 40°C
- NSF
- IP65, IP66, IP67, IP69
- RoHS
- SLP Guardian Seal™
- PSI 1500

Product offering and specifications subject to change without notice

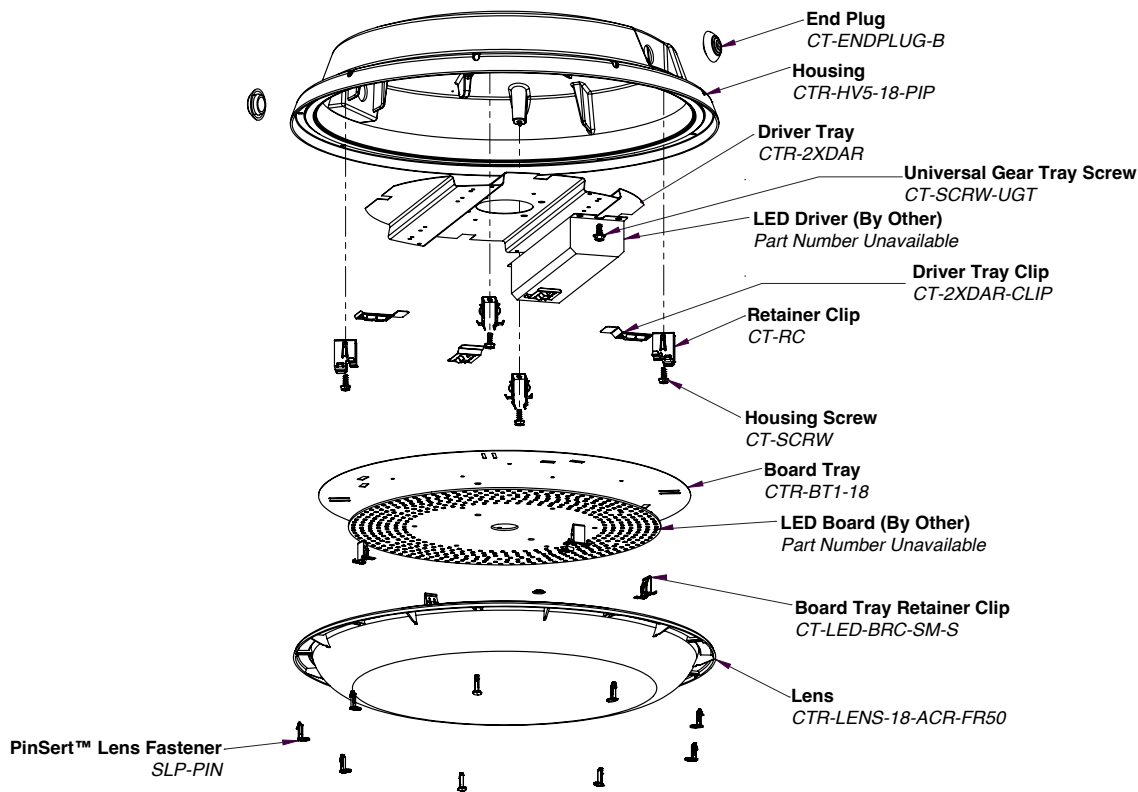

Housing & Hardware		
Description	Part #	Quantity Per Unit
Housing	CTR-HV5-18-PIP	1
Housing Screw	CT-SCRW	4
Lens & Hardware		
Frosted Acrylic Lens	CTR-LENS-18-ACR-FR50	1
PinSert™ Lens Fastener	SLP-PIN	9
Driver Tray & Hardware		
Driver Tray	CTR-2XDAR	1
Driver Tray Screw	CT-SCRW-UGT	2
Driver Rail Clip	CT-2XDAR-CLIP	4
Retainer Clip	CT-RC	4
Board Tray & Hardware		
Board Tray	CTR-BT1-18	1
Board Tray Retainer Clip	CT-LED-BRC-SM-S	4
End Plugs		
Black End Plug	CT-ENDPLUG-B	2

Product offering and specifications subject to change without notice

Housing

Diameter	Description	Part #	PCS / CTN	WT / CTN	Skid Quantity
18"	5VA (f1) Fiberglass (UL)	CTR-HV5-18-PIP	10		
18"	5VA (f1) Fiberglass (UL) J-Box Mount Pattern	CTR-HV5-18-PIP-JB	10		

Lenses

Description	Part #	PCS / CTN	WT / CTN	Full Skid Quantity
Clear Polycarbonate Drop Lens	CTR-LENS-18-PC	10		
FR50 Frosted Polycarbonate Drop Lens	CTR-LENS-18-PC-FR50	10		
Clear Acrylic Drop Lens	CTR-LENS-18-ACR	10		
FR50 Frosted Acrylic Drop Lens	CTR-LENS-18-ACR-FR50	10		

Reflectors

Description	Material	Part #	PCS / CTN	WT / CTN	Full Skid Quantity
Garage Reflector	Polycarbonate	CTR-REF-GR-MR			

Board & Driver Tray

Description	Material	Part #	PCS / CTN	WT / CTN	Full Skid Quantity
Board Tray	White Enamel Steel	CTR-BT1-18			
Driver Tray	Sheet Metal	CTR-2XDAR			

Hardware

Component	Part #	PCS / BAG	PCS / CTN	WT / CTN
PinSert™ Lens Fasteners	SLP-PIN	100		
Board Retention Clip Single	CT-LED-BRC-SM-S	200	5,000	
Driver Rail Clip	CT-2XDAR-CLIP	Bulk	4,000	44 lbs / 19.95 kg
Retainer Clip	CT-RC	200	2,400	16 lbs / 7.3 kg
Housing Screw	CT-SCRW	100	10,000	47 lbs / 23.58 kg
Citadel End Plug	CT-ENDPLUG-B	200	3,000	23 lbs / 10.43 kg
SLP-ENDPLUG-75 (*Top of housing if needed)	SLP-ENDPLUG-B-75	10		
Stainless Lens Tether	CT-LT12	20	2,000	11 lbs / 4.98 kg
Board Tray Safety Strap (100 / Bag)	CT-SST	100	10,000	17 lbs / 7.7 kg
Driver Tray Screw	CT-SCRW-UGT	100	10,000	56 lbs

Mounting

Description	Part #	PCS / BAG	PCS / CTN	WT / CTN
J-Box Gasket	SLP-GSK-JBX			
316 Stainless Steel Hook	SLP-HOOK-SS-NH75			
¾" Hub for Pendant Mounting	CT-DCB-75	100		20 lbs / 9.07 kg
Safety Cable Bracket	SLP-BKT-SAF			
½" Hub for Direct Mounting Bracket	CT-DCB-50			

Product offering and specifications subject to change without notice