

CT2 HOUSINGS

- CT2-HV5-1L4
- CT2-HV5-2L2
- CT2-HV5-2L4
- CT2-HV5-2L8



LINEAL RIBBED DIFFUSERS

- CT2-DIRA-1L4(-FR50)
- CT2-DP-1L4(-FR50)
- CT2-DIRA-2L2(-FR50)
- CT2-DP-2L2(-FR50)
- CT2-DIRA-2L4(-FR50)
- CT2-DP-2L4(-FR50)
- CT2-DIRA-2L8(-FR50)

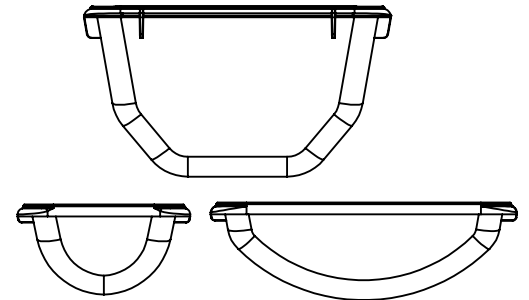

OPTICALLY CLEAR DIFFUSERS

- CT2-LIRA-2L2(-FR50)
- CT2-LIRA-2L4(-FR50)
- CT2-LIRA-2L8(-FR50)
- CT2-CIRA-1L4(-FR50)
- CT2-CP-1L4(-FR50)
- CT2-CIRA-2L4(-FR50)
- CT2-CP-2L4(-FR50)

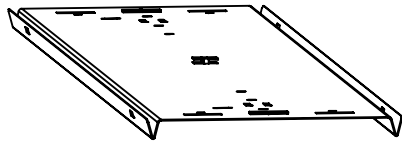

BOARD TRAYS

- See specific BT1 page

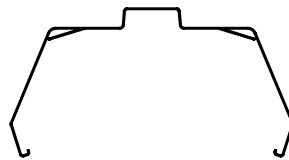

MOUNTING BRACKETS

- CT2-MB-1L
- CT2-MB-2L

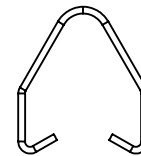

CHAIN HANG

- CT-BAIL



GT RC SCREW

- CT-SCRW

UNIVERSAL GEAR TRAY SCREW

- CT-SCRW-UGT

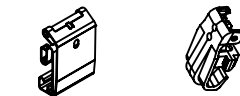

LATCHES

- CT2-LATCHSS
- CT2-LATCHC
- CT2-LATCHW



END PLUG

- CT-ENDPLUG-B



GT RETAINER CLIP

- CT-RC
- CT-RC-WIDE



SAFETY STRAP

- CT-SST



LENS TETHER

- CT-LT8
- CT-LT12

Diffuser Material Note:
DIRA & CIRA is Impact Resistant Acrylic
DP & CP is Polycarbonate
FR50 is optional frosted variation.

Citadel 2

Parts List

Page 1 of 11



1400 South Old Highway 141
 Fenton, MO. 63026
 PH (636) 600-4084 FX (636) 600-4108
 www.SLPighting.com

Citadel 2 LED: *FLAT BOARD TRAY SYSTEM*

CT2 LED FLAT BOARD TRAY

- CT2-LED-BT1-1L4-1R
- CT2-LED-BT1-2L2-1R
- CT2-LED-BT1-2L2-2R-095
- CT2-LED-BT1-2L2-2R-160
- CT2-LED-BT1-2L2-2R-190
- CT2-LED-BT1-2L4-1R
- CT2-LED-BT1-2L4-2R-095
- CT2-LED-BT1-2L4-2R-160
- CT2-LED-BT1-2L4-2R-190
- CT2-LED-BT1-2L8-1R
- CT2-LED-BT1-2L8-2R-095
- CT2-LED-BT1-2L8-2R-160
- CT2-LED-BT1-2L8-2R-190

1R: One Row; requires CT-RC-WIDE
 2R: Two Rows
 4R: For Rows
 095: Nominal Board Width 0.950"
 160: Nominal Board Width 1.600"
 190: Nominal Board Width 1.900"

All Models and Drawings of the Flat Board Trays with the exception of "Viewed" Files use cut-outs to symbolize lances, bridges, and K.O.'s for our manufacturing purposes. The "Viewed" files are strictly a 3D Visual of the stamped features.

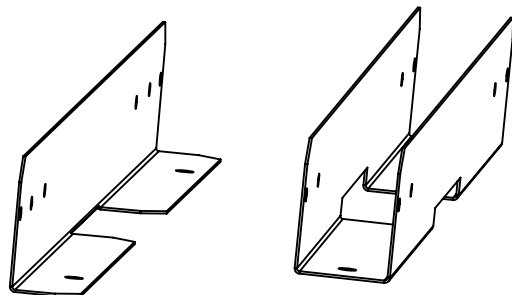

DRIVER TRAY

- CT-LED-DT-L
- CT-LED-DT-U

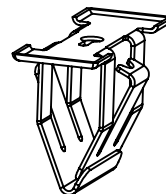

BOARD RETENTION CLIP

- CT2-LED-BRC-SM

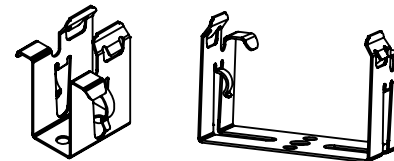

GT RETAINER CLIP

- CT-RC
- CT-RC-WIDE

UNIVERSAL GEAR TRAY SCREW

- CT-SCRW-UGT

Citadel 2 LED

Parts List

Page 2



1400 South Old Highway 141
 Fenton, MO. 63026
 PH (636) 600-4084 FX (636) 600-4108
www.SLPlighting.com

HOUSINGS

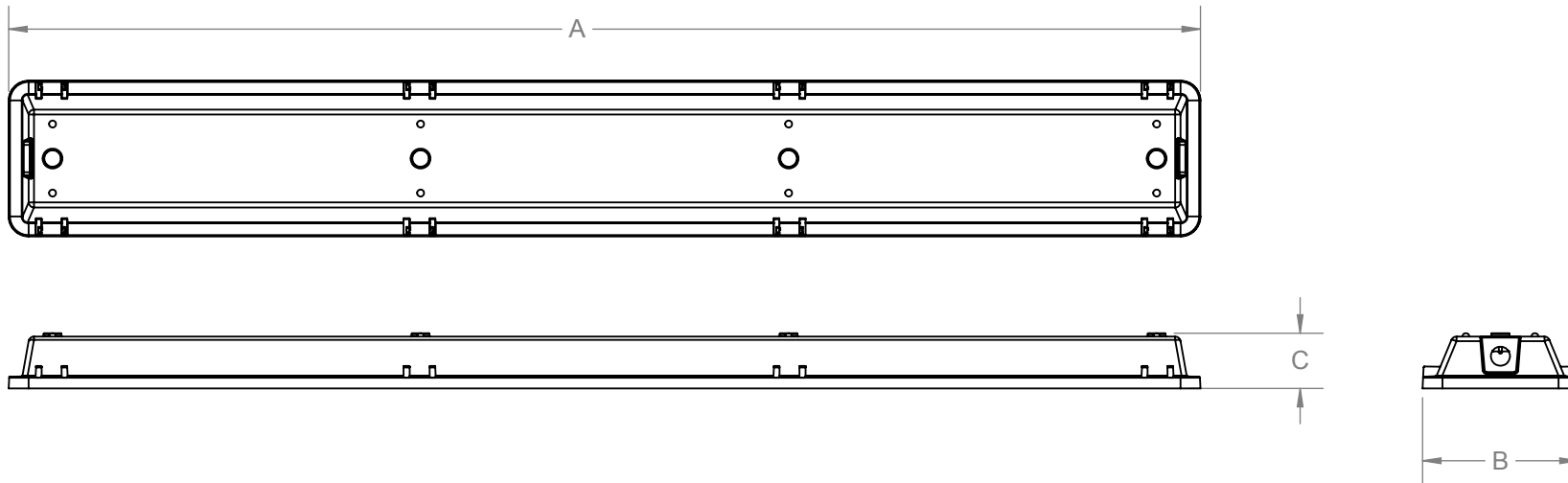

PART	A	B	C	Material
CT2-HV5-1L4	51.6	4.02	2.24	5VA Fibergalss
CT2-HV5-2L2	27.7	6.77	2.24	5VA Fibergalss
CT2-HV5-2L4	51.7	6.77	2.24	5VA Fibergalss
CT2-HV5-2L8	100.0	6.77	2.24	5VA Fibergalss

Citadel 2

Housings

Page 2 of 10



1400 South Old Highway 141
 Fenton, MO. 63026
 PH (636) 600-4084 FX (636) 600-4108
 www.SLPlighting.com



LINEAL RIBBED CLEAR & FROSTED DIFFUSERS

CT2-DP-2L4/CT2-DP-2L4-FR50 CT2-DIRA-2L4/CT2-DIRA-2L4-FR50 CT2-DIRA-2L8/CT2-DIRA-2L8-FR50

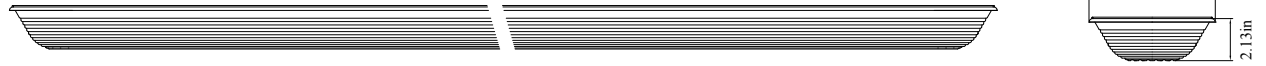

CT2-DP-1L4/CT2-DP-1L4-FR50 CT2-DIRA-1L4/CT2-DIRA-1L4-FR50

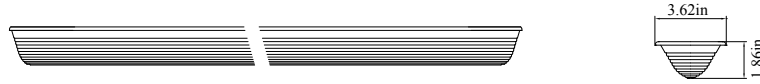

CT2-DP-2L2/CT2-DP-2L2-FR50 CT2-DIRA-2L2/CT2-DIRA-2L2-FR50



SHALLOW OPTICALLY CLEAR & FROSTED LENS

CT2-CIRA-2L4/CT2-CIRA-2L4-FR50 CT2-CP-2L4/CT2-CP-2L4-FR50

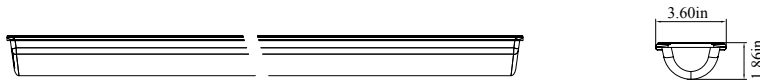
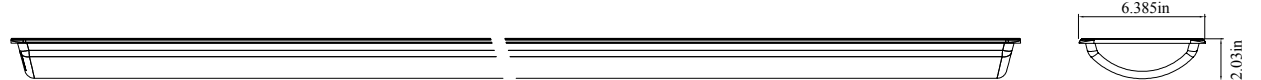

OPTICALLY CLEAR & FROSTED LENS

CT2-LIRA-2L2/CT2-LIRA-2L2-FR50 CT2-LIRA-2L4/CT2-LIRA-2L4-FR50 CT2-LIRA-2L8/CT2-LIRA-2L8-FR50

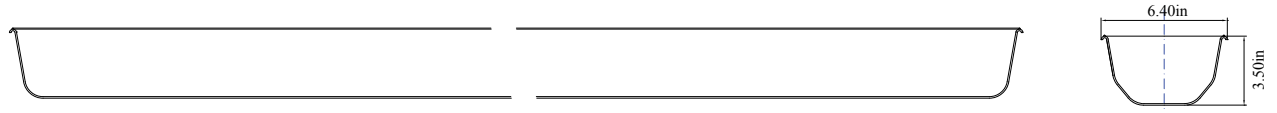

	Width	Nominal Length	Part Number	Available in Frosted	Injection Molded With Guardian Seal	Overall Dimensions			
					Impact Resistant Acrylic	(dimensions given in inches)			
						Width	Length	Depth	
Lineal Ribbed Diffuser	Narrow (1 Light)	4'	CT2-DIRA-1L4	CT2-DIRA-1L4-FR50	+	3.62	51.26	1.86	
			CT2-CIRA-1L4	CT2-CIRA-1L4-FR50	+	3.60	51.52	1.87	
	Wide (2 Light)	2'	CT2-DIRA-2L2	CT2-DIRA-2L2-FR50	+	6.38	27.24	2.13	
			4'	CT2-DIRA-2L4	CT2-DIRA-2L4-FR50	+	6.40	51.37	2.13
			CT2-CIRA-2L4	CT2-CIRA-2L4-FR50	+	6.39	51.37	2.03	
Optically Clear Lens	Wide (2 Light)	2'	CT2-LIRA-2L2	CT2-LIRA-2L2-FR50	+	6.40	27.24	3.50	
		4'	CT2-LIRA-2L4	CT2-LIRA-2L4-FR50	+	6.40	51.37	3.50	
		8'	CT2-LIRA-2L8	CT2-LIRA-2L8-FR50	+	6.40	99.50	3.50	



CITADEL 2 Lens and Diffusers

V08042015

SLP Lighting

1400 South Old Highway 141, Fenton, MO 63026 USA
Tel. 636-600-4084 - Fax 636-600-4108

West Coast 16423 Berwyn Road, Cerritos, CA 90703 USA
Tel. 1-562-404-1440 - Fax 1-562-404-4711

All dimensions are given to our best knowledge and without obligation. We reserve the right to make changes to materials or design.

BOARD TRAYS

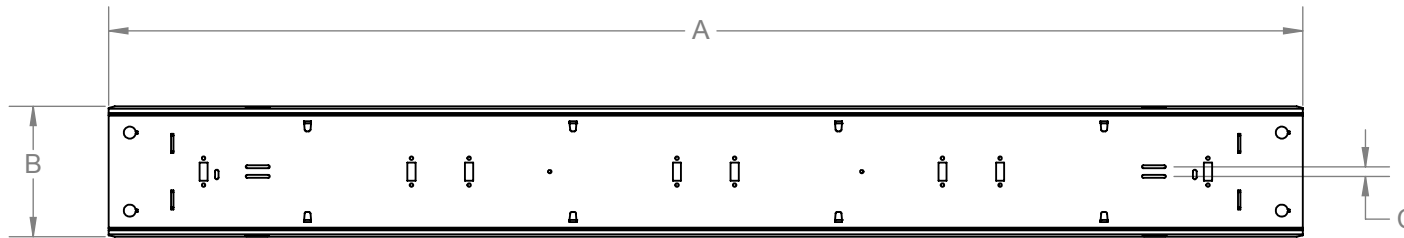

PART NUMBER	A	B	C
CT2-LED-BT1-1L4-1R	49.76	2.58	1.65
CT2-LED-BT1-1L4-1R-095			
CT2-LED-BT1-1L4-1R-160			
CT2-LED-BT1-2L2-1R	25.75	5.34	1.65
CT2-LED-BT1-2L2-1R-095			
CT2-LED-BT1-2L2-1R-160			
CT2-LED-BT1-2L2-2R-095	25.75	5.34	0.40
CT2-LED-BT1-2L2-2R-160			
CT2-LED-BT1-2L2-2R-190			
CT2-LED-BT1-2L4-1R	49.75	5.34	1.65
CT2-LED-BT1-2L4-1R-095			
CT2-LED-BT1-2L4-1R-160			
CT2-LED-BT1-2L4-2R-095	49.75	5.34	0.40
CT2-LED-BT1-2L4-2R-160			
CT2-LED-BT1-2L4-2R-190			
CT2-LED-BT1-2L8-1R	98.08	5.34	1.65
CT2-LED-BT1-2L8-1R-095			
CT2-LED-BT1-2L8-1R-160			
CT2-LED-BT1-2L8-2R-095	98.08	5.34	0.40
CT2-LED-BT1-2L8-2R-160			
CT2-LED-BT1-2L8-2R-190			

Material 0.020" Precoat CRS

Citadel 2 LED
BT1 Board Trays



1400 South Old Highway 141
Fenton, MO. 63026
PH (636) 600-4084 FX (636) 600-4108
www.SLPighting.com

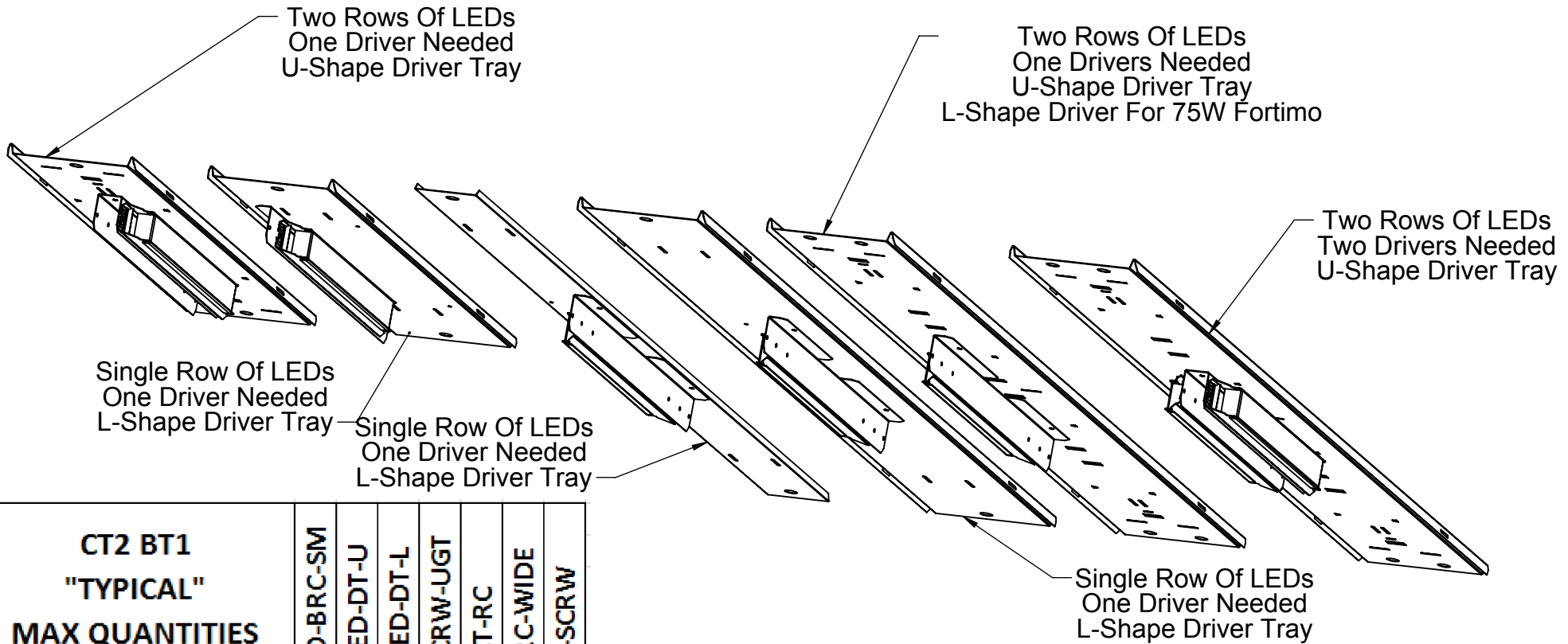

CT2 BT1 "TYPICAL" MAX QUANTITIES <i>some variations may differ</i>	CT-LED-BRC-SM	CT-LED-DT-U	CT-LED-DT-L	CT-SCRW-UGT	CT-RC	CT-RC-WIDE	CT-SCRW
	LED Flat Board Tray						
CT2-LED-BT1-1L4-1R	-	-	1	4	-	2	2
CT2-LED-BT1-2L2-1R	-	1	-	4	-	2	2
CT2-LED-BT1-2L2-2R-095	4	1	-	4	2	-	2
CT2-LED-BT1-2L2-2R-160	4	1	-	4	2	-	2
CT2-LED-BT1-2L2-2R-190	-	1	-	4	2	-	2
CT2-LED-BT1-2L4-1R	-	-	1	4	-	2	2
CT2-LED-BT1-2L4-2R-095	8	1	-	6	2	-	2
CT2-LED-BT1-2L4-2R-160	8	1	-	6	2	-	2
CT2-LED-BT1-2L4-2R-190	-	1	-	6	2	-	2
CT2-LED-BT1-2L8-1R	-	-	2	4	-	4	4
CT2-LED-BT1-2L8-2R-095	16	2	-	8	4	-	4
CT2-LED-BT1-2L8-2R-160	16	2	-	8	4	-	4
CT2-LED-BT1-2L8-2R-190	-	2	-	8	4	-	4

The Main Point Here

When there are two rows of LEDs, you will usually use the clips, with the exception of the(-190). When you use clips, you want to use the U-Shaped Driver Tray. In the U-Shape Driver Tray, there is a hole cut out for the clips. The L-Shaped Driver tray is reserved for all single row configurations, or the (-C) board trays.

For the (-C) board trays, you also have to use the CT-RC-WIDE clip.

The Universal Gear Tray Screw is used to attached the drivers to the driver tray, and the driver tray to the board tray.

Special Consideration: CT-LED-DT-L needs to be used with Fortimo 75W Driver for dual row options.

ACTUAL SIZE: SCALE 1:1

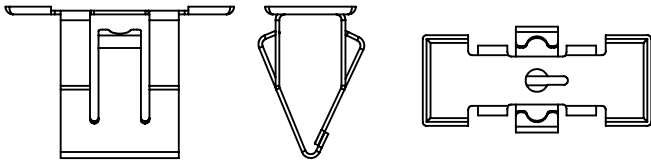

REVISIONS			
REV.	DESCRIPTION	DATE	APPROVED
A	For Production	4.23.14	CSO

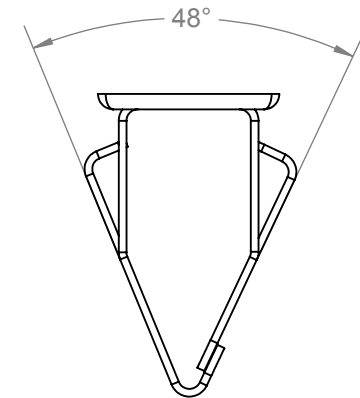
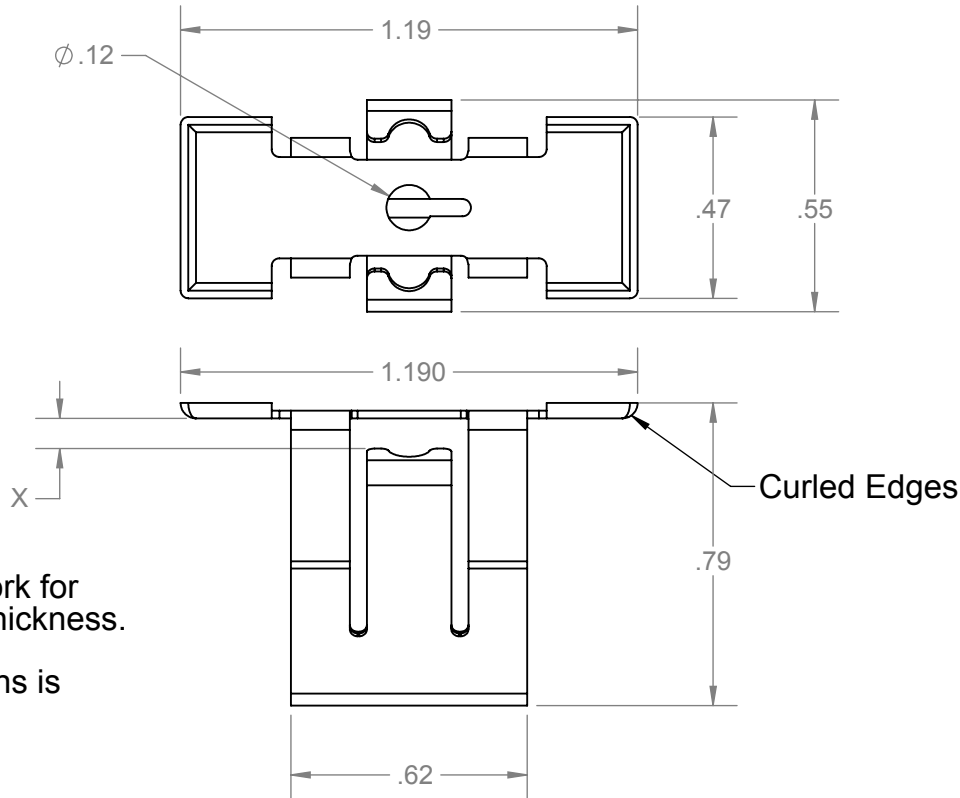

Clip designed to work for .060" to .084" overall thickness.

Cut Out Dimensions is .750" X .354"

UNLESS OTHERWISE SPECIFIED:

DIMENSIONS ARE IN INCHES
TOLERANCES AS NOTED
FRACTIONAL $\pm 1/16"$
ANGULAR $\pm 1^\circ$
TWO PLACE DECIMAL $\pm .060$
THREE PLACE DECIMAL $\pm .030$

INTERPRET GEOMETRIC TOLERANCING PER:

	NAME	DATE
DRAWN	-	xx/xx/xx
CHECKED	-	xx/xx/xx
ENG APPR.	-	xx/xx/xx
MFG APPR.	-	xx/xx/xx
Q.A.	-	xx/xx/xx
COMMENTS:		
....		

The information contained in this document is the confidential property of Koller Enterprises Inc. This information is to be used by the recipient only for the purpose of which it has been provided by Koller. This document and any information contained therein may not be reproduced or made available to any third party without the written authorization of Koller. No tooling to produce the product which is the subject of this document can be made without written authorization from Koller. Recipient's acceptance of this document is an acknowledgement of agreement to these terms.



1400 South Old Highway 141
Fenton, MO. 63026

PH (636) 600-4084 FX (636) 600-4108
www.SLPlighting.com

Part Weight		CT-LED-BRC-SM Flat Board Tray Retention Clip		REV. A
Material	Spring Steel			
Finish	PS-7001	SIZE A	Scale 2:1	SHEET 1 OF 1
Drawn By:	CSO	DATE : 4/23/2014	DWG. No. CT-LED-BRC-SM	

RETAINER CLIP

CT-RC (.021" 316 SS)

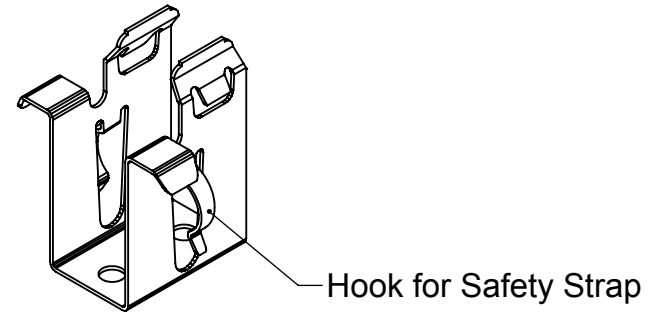
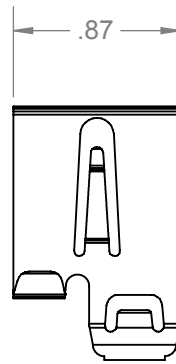
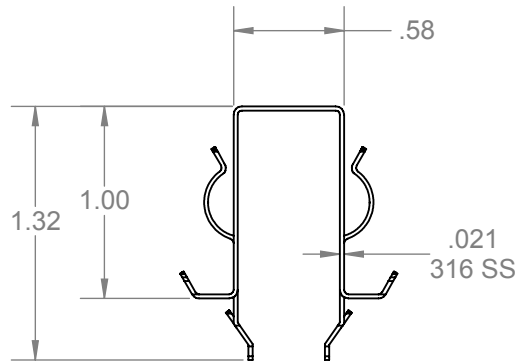

Required Accessory:

CT RC SCREW
 CT-SCRW (Hi-Lo 10-16 hex head)
 Max Torque : 35 in-lbs



Optional Accessory:

SUPPORT STRAP
 CT-SST (Nylon)

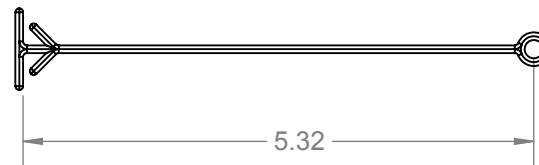

LENS/GEAR TRAY TETHER
 CT-LT8 or CT-LT12 (304 SS)

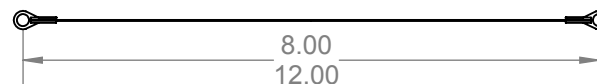

Citadel 2

Retainer Clip

Page 5 of 10



1400 South Old Highway 141
 Fenton, MO. 63026
 PH (636) 600-4084 FX (636) 600-4108
 www.SLPlighting.com

REVISIONS			
REV.	DESCRIPTION	DATE	APPROVED
0	For Final Prototype	4.23.14	CSO
A	For Production	5.20.14	CSO

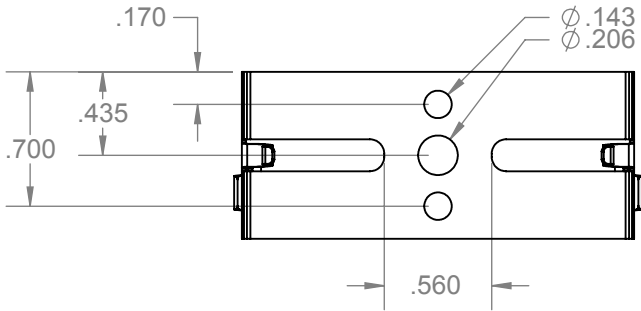
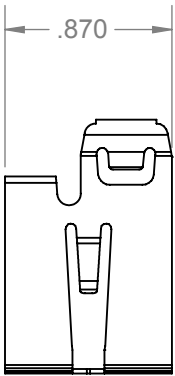
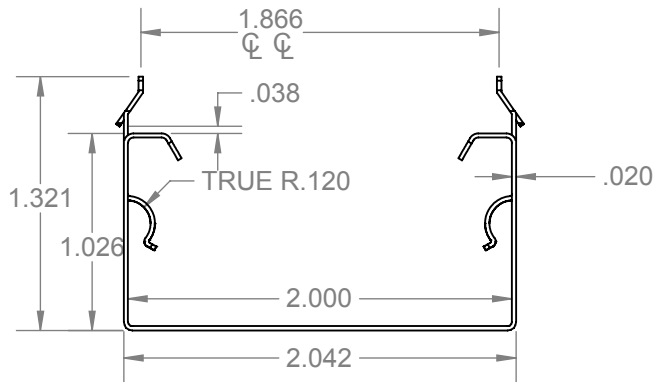

UNLESS OTHERWISE SPECIFIED:
 DIMENSIONS ARE IN INCHES
 TOLERANCES AS NOTED
 FRACTIONAL ± 1/16"
 ANGULAR ± 1°
 TWO PLACE DECIMAL ± .060
 THREE PLACE DECIMAL ± .030
 INTERPRET GEOMETRIC TOLERANCING PER:

	NAME	DATE
DRAWN	-	xx/xx/xx
CHECKED	-	xx/xx/xx
ENG APPR.	-	xx/xx/xx
MFG APPR.	-	xx/xx/xx
Q.A.	-	xx/xx/xx

COMMENTS:

The information contained in this document is the confidential property of Koller Enterprises Inc. This information is to be used by the recipient only for the purpose of which it has been provided by Koller. This document and any information contained therein may not be reproduced or made available to any third party without the written authorization of Koller. No tooling to produce the product which is the subject of this document can be made without written authorization from Koller. Recipient's acceptance of this document is an acknowledgement of agreement to these terms.



1400 South Old Highway 141 Fenton, MO. 63026 PH (636) 600-4084 FX (636) 600-4108 www.SLPlighting.com

Part Weight		CT-RC-WIDE		
Material 316SS half hard				
Finish	SIZE A	Scale 1:1	SHEET 1 OF 1	REV. A
Drawn By: CSO	DATE: 4/23/2014	DWG. No. CT-RC-WIDE		

316 SS MOUNTING BRACKET

CT2-MB-2L (.025" 316 SS)

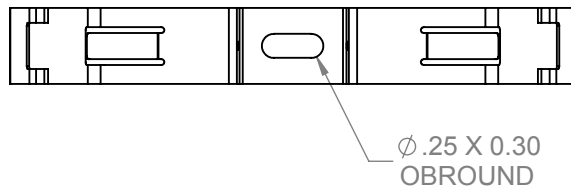
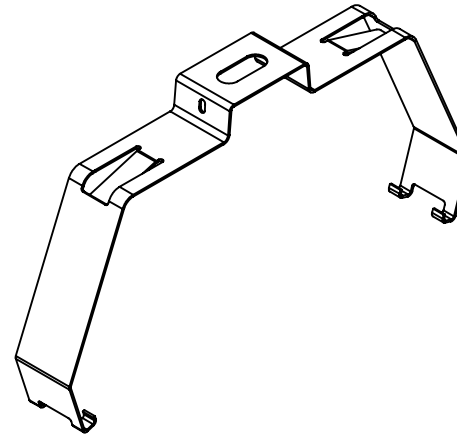
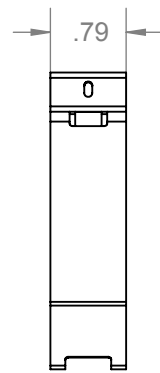
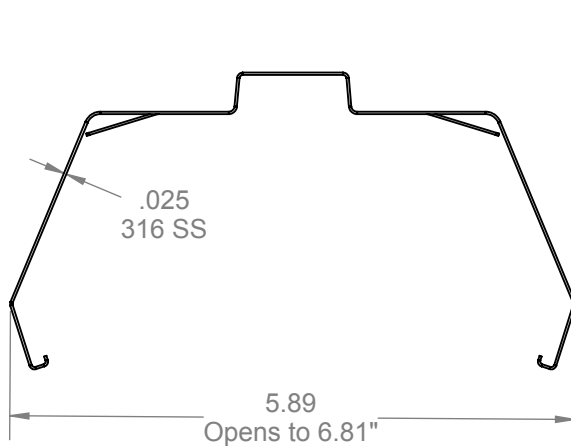

Optional Accessory:

CT BAIL

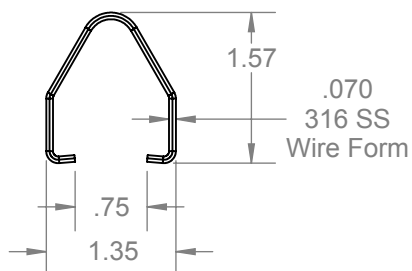

Citadel 2

Mounting Bracket

Page 6 of 10



1400 South Old Highway 141
Fenton, MO. 63026
PH (636) 600-4084 FX (636) 600-4108
www.SLPlighting.com

PLASTIC LATCH

CT2-LATCHC (Polycarbonate)

CT2-LATCHW (POM)

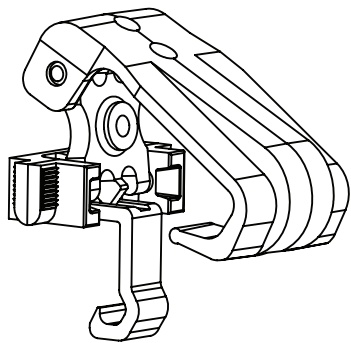

Opened

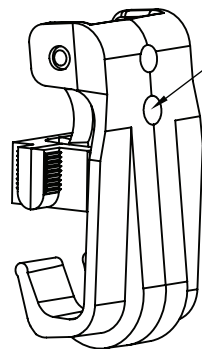

Closed

Tamper Proof Hole

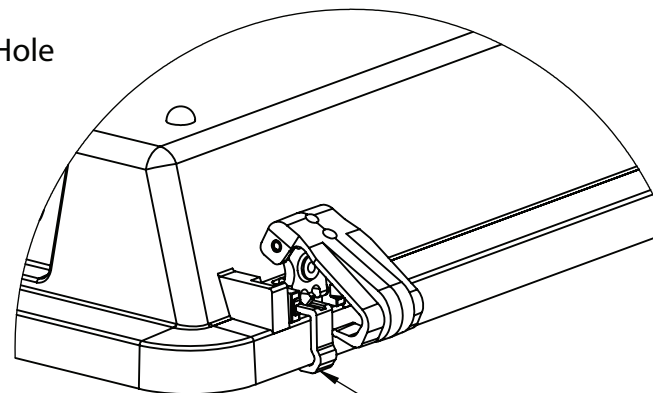

Captive

The latches come fully assembled. Simply press the base into the latch pocket, and guide the captive base over the edge of the housing. For Tamper Proofing use 6-1/2" sheet metal screw.

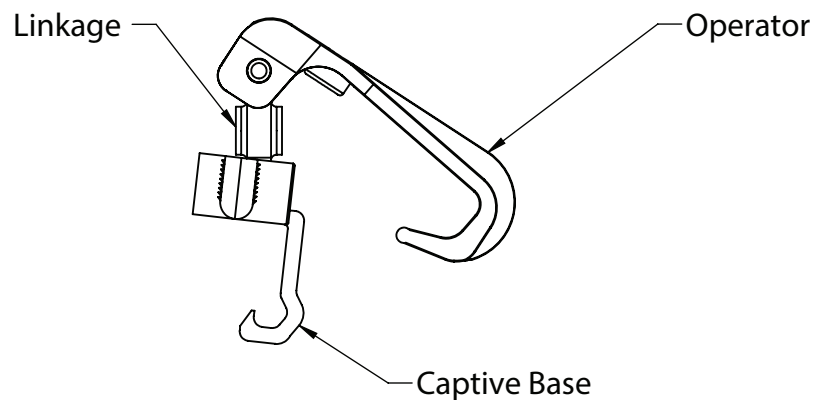

Citadel 2

Plastic Latch

Page 7 of 10



1400 South Old Highway 141
Fenton, MO. 63026
PH (636) 600-4084 FX (636) 600-4108
www.SLPlighting.com

316 SS LATCH CT2-LATCHSS

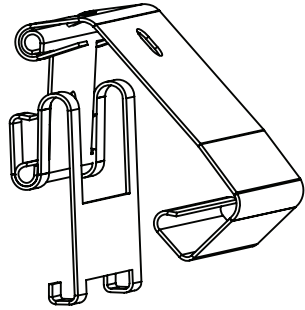

Opened

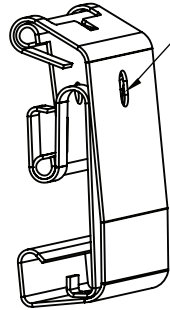

Closed

Tamper Proof Hole

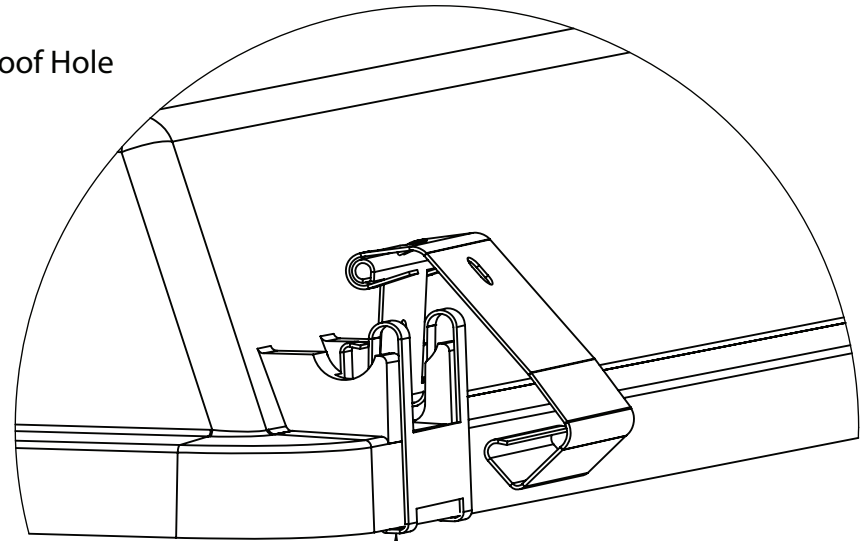

Keeper Teeth go
over lip of CT Housing

- Simple and Secure
- 316 Stainless Steel
- Latch is mechanically secure to the housing and prevents accidental loss of latch during fixture maintenance.

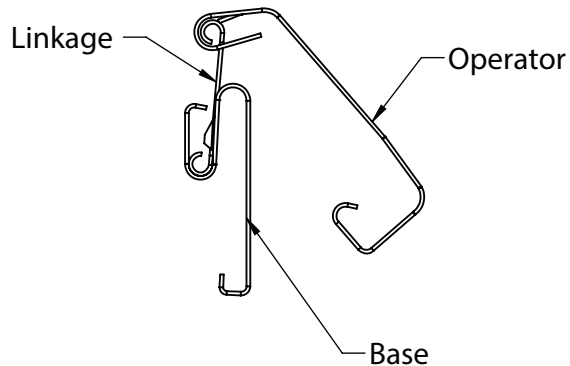

The latches come full assembled. Simply press the base into the latch pockets on the housing, and slip the keeper teeth over the edge of the housing.

For Tamper proofing use a 6-3/4" sheet metal screw

Citadel 2

SS Latch

Page 8 of 10



1400 South Old Highway 141
Fenton, MO. 63026
PH (636) 600-4084 FX (636) 600-4108
www.SLPlighting.com