

NOTES:

1. 1.5000 DIA. HARD CHROME PLATED ROD
2. .750-16 SAE NO. 8 O-RING PORTS
3. REPHASING ORIFICE DIA. = .046
4. 3000 PSI MAXIMUM OPERATING PRESSURE
5. SEAL KIT NO. 44-4600-S INCLUDES ITEMS 3,4,5,7,11,12,16 & 17
6. SAFETY FACTORS BELOW 2:1 AT 3000 PSI -
IN RETRACT -
ROD PINEYE = 1.58:1
BASE PINEYE = 0.71:1
ROD THREAD TENSILE = 1.10:1
ROD THREAD TENSILE W/ CONC. = 0.55:1
ROD THREAD SHEAR = 1.33:1
IN EXTEND -
BASE PLATE = 1.62:1
ROD SHOULDER = 0.81:1
ROD BUCKLING = 0.88:1
7. STATIC TEST AT 3500 PSI IN BOTH DIRECTIONS
8. PAINT GLOSS BLACK

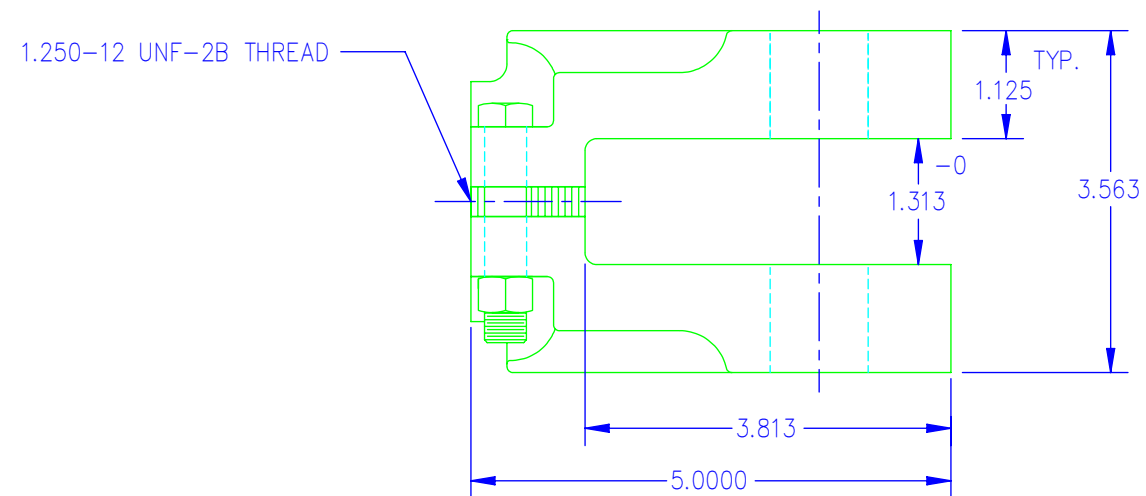

TRIPLE C, INC.

P.O. BOX 248, SABETHA, KS 66534
(785) 284-3674 FAX (785) 284-3931

MATERIAL:
X

DWG PATH: X

DO NOT SCALE
DRAWING

SHEET
1 OF 1

SCALE:
X:X

DRAWN BY:
CHRIS ABERLE
x

TOLERANCES

Unless otherwise specified
XX .010
XXX .005
XXXX .0005
X/X 1/32
ANGLE 0°30'

TITLE:
CYLINDER, MAIN LIFT
4.500 BORE

DRAWING NUMBER:
GR450-ML
REV