

Soils Map

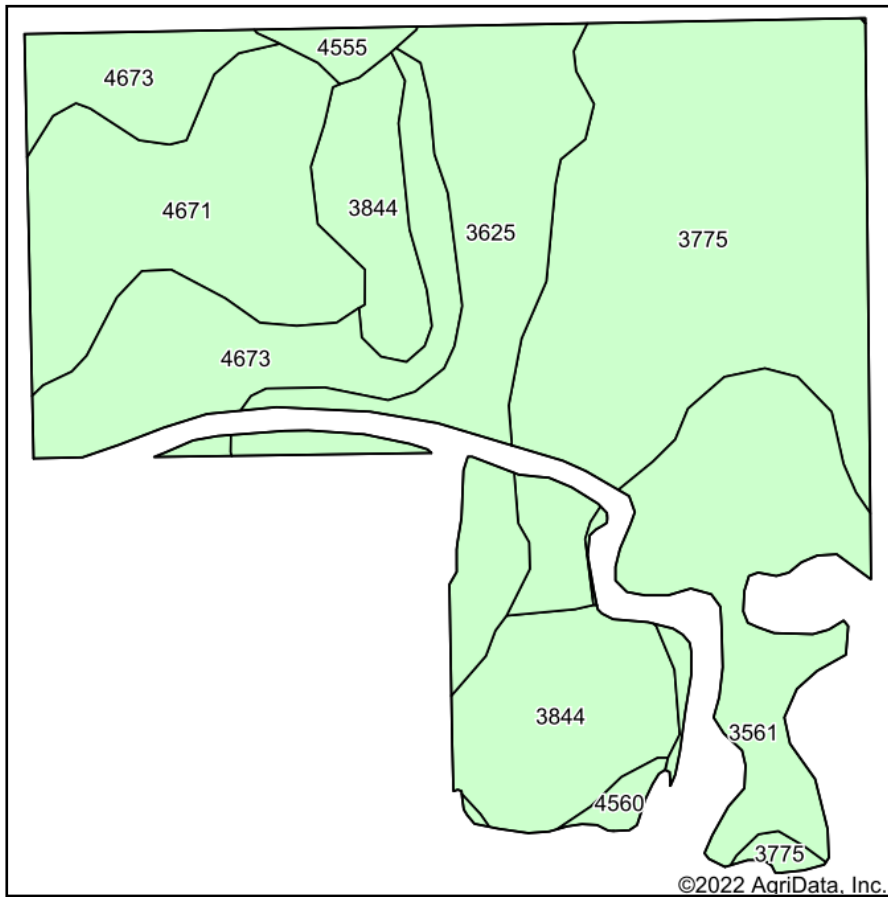

Soils data provided by USDA and NRCS.

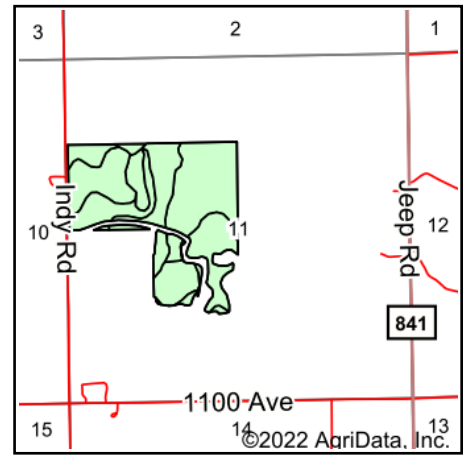

State: **Kansas**
 County: **Dickinson**
 Location: **11-15S-2E**
 Township: **Jefferson**
 Acres: **103.27**
 Date: **7/20/2022**



Maps Provided By:



Area Symbol: KS041, Soil Area Version: 20

Code	Soil Description	Acres	Percent of field	Non-Irr Class *c	Irr Class *c	Range Production (lbs/acre/yr)	*n NCCPI Soybeans
3775	Muir silt loam, rarely flooded	30.95	30.0%	Iw	Iw	4655	81
4673	Irwin silty clay loam, 3 to 7 percent slopes	14.70	14.2%	IVe	IVe	3550	57
4671	Irwin silty clay loam, 1 to 3 percent slopes	14.62	14.2%	IIIs	IIIs	3635	56
3625	Sutphen silty clay loam, occasionally flooded	14.18	13.7%	IIw	IIw	5030	49
3561	Hobbs silt loam, occasionally flooded	13.74	13.3%	IIw	IIw	5845	79
3844	Geary silt loam, 3 to 7 percent slopes	13.29	12.9%	IIIe	IIIe	4085	72
4555	Clime silty clay loam, 3 to 7 percent slopes	1.04	1.0%	IIIe	IIIe	3540	43
4560	Clime silty clay loam, 7 to 15 percent slopes	0.75	0.7%	VIe		3670	39
Weighted Average				2.29	*-	4471.4	*n 67.5

*n: The aggregation method is "Weighted Average using all components"

*c: Using Capabilities Class Dominant Condition Aggregation Method

*- Irr Class weighted average cannot be calculated on the current soils data due to missing data.

Soils data provided by USDA and NRCS.