

## Soils Map

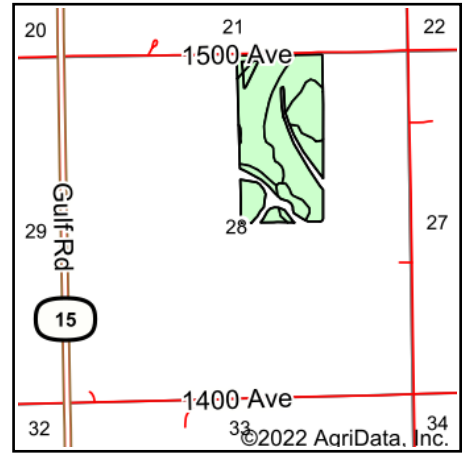

State: **Kansas**  
County: **Dickinson**  
Location: **28-14S-2E**  
Township: **Newbern**  
Acres: **70.16**  
Date: **7/20/2022**

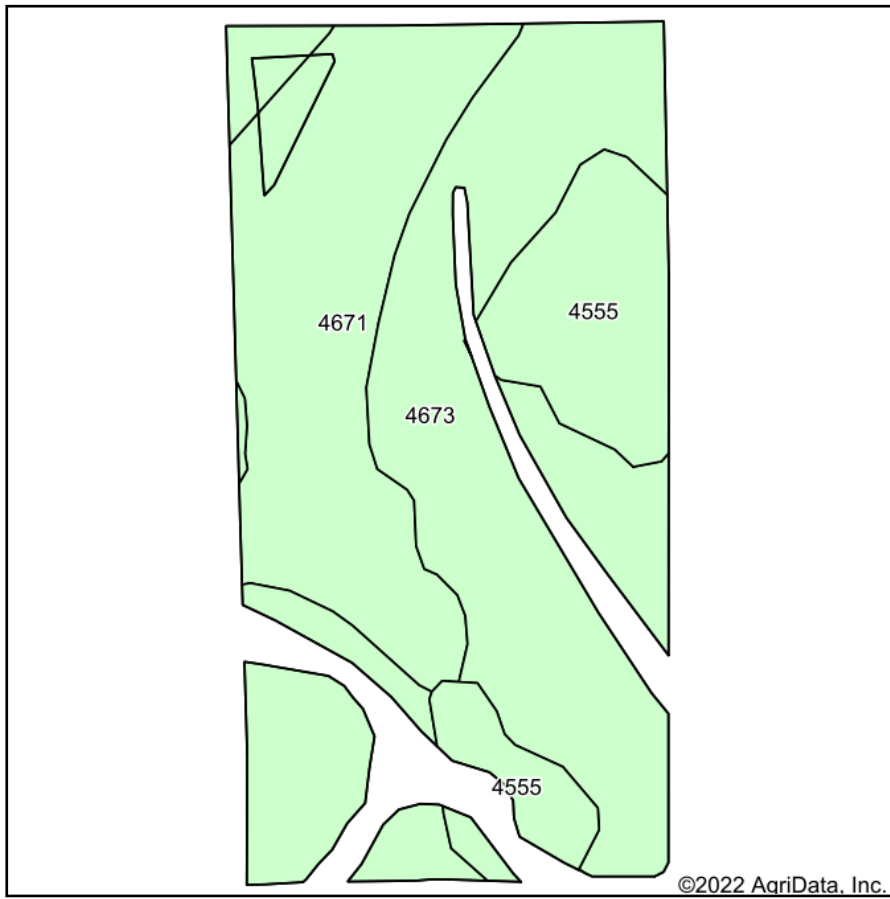

Maps Provided By:



Soils data provided by USDA and NRCS.

Area Symbol: KS041, Soil Area Version: 20

Code	Soil Description	Acres	Percent of field	Non-Irr Class *c	Irr Class *c	Range Production (lbs/acre/yr)	*n NCCPI Soybeans
4673	Irwin silty clay loam, 3 to 7 percent slopes	36.62	52.2%	IVe	IVe	3550	57
4671	Irwin silty clay loam, 1 to 3 percent slopes	21.87	31.2%	IIIIs	IIIIs	3635	56
4555	Clime silty clay loam, 3 to 7 percent slopes	11.67	16.6%	IIIe	IIIe	3540	43
<b>Weighted Average</b>				<b>3.52</b>	<b>3.52</b>	<b>3574.8</b>	<b>*n 54.4</b>

\*n: The aggregation method is "Weighted Average using all components"

\*c: Using Capabilities Class Dominant Condition Aggregation Method

Soils data provided by USDA and NRCS.