

Soils Map

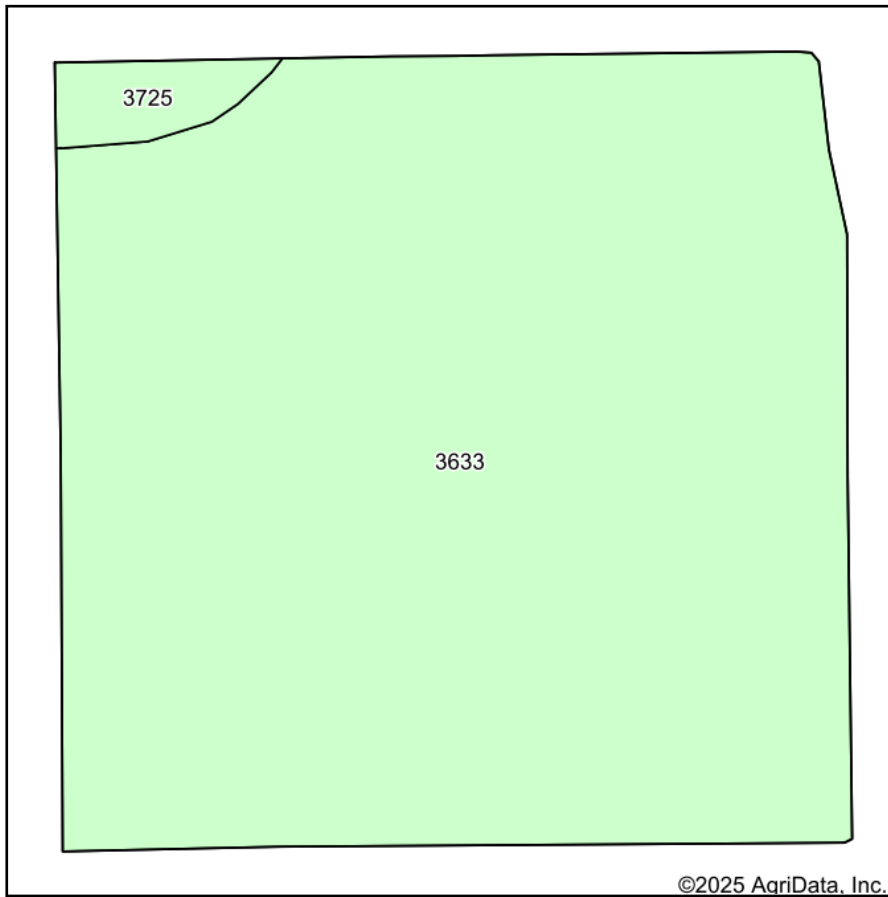

Soils data provided by USDA and NRCS.

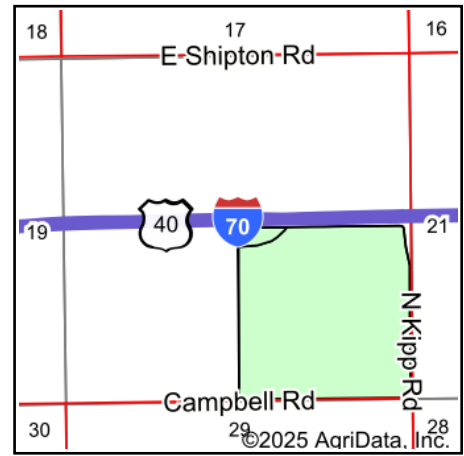

State: **Kansas**
 County: **Saline**
 Location: **20-13S-1W**
 Township: **Dayton**
 Acres: **157.29**
 Date: **11/21/2025**



Maps Provided By:



Area Symbol: KS169, Soil Area Version: 22

Code	Soil Description	Acres	Percent of field	Water Table	Non-Irr Class *c	Irr Class *c	*n NCCPI Soybeans
3633	Sutphen silty clay, 0 to 1 percent slopes, occasionally flooded	153.55	97.6%	1.1ft.	IIIw	IIIw	44
3725	Detroit silty clay loam, rarely flooded	3.74	2.4%	> 6.5ft.	Iw	Iw	65
Weighted Average					2.95	2.95	*n 44.5

*n: The aggregation method is "Weighted Average using all components"

*c: Using Capabilities Class Dominant Condition Aggregation Method