

Soils Map

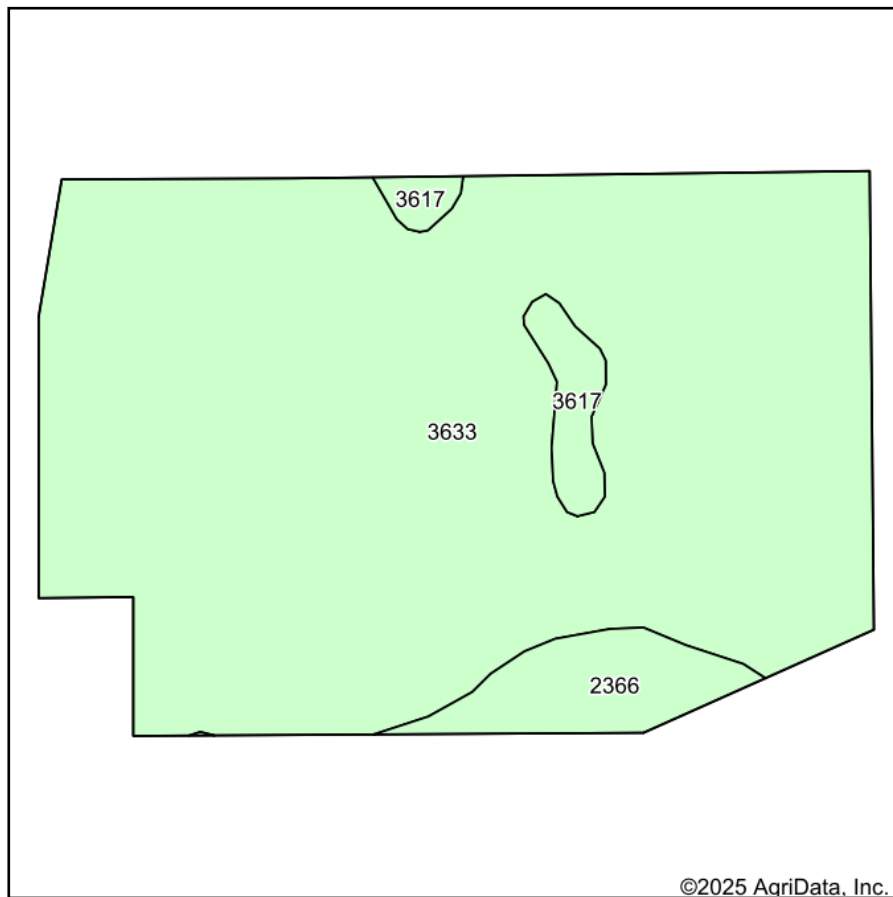

Soils data provided by USDA and NRCS.

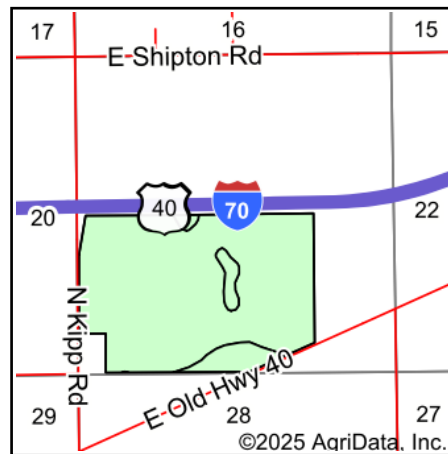

State: **Kansas**
 County: **Saline**
 Location: **21-13S-1W**
 Township: **Dayton**
 Acres: **220.96**
 Date: **11/24/2025**



Maps Provided By:



Area Symbol: KS169, Soil Area Version: 22							
Code	Soil Description	Acres	Percent of field	Water Table	Non-Irr Class *c	Irr Class *c	*n NCCPI Soybeans
3633	Sutphen silty clay, 0 to 1 percent slopes, occasionally flooded	202.46	91.7%	1.1ft.	IIIw	IIIw	44
2366	New Cambria silty clay, rarely flooded	11.81	5.3%	> 6.5ft.	IIIs	IIIs	57
3617	Solomon silty clay, occasionally flooded	6.69	3.0%	1ft.	IIIw	IIIw	19
Weighted Average					2.95	2.95	*n 43.9

*n: The aggregation method is "Weighted Average using all components"

*c: Using Capabilities Class Dominant Condition Aggregation Method

Soils data provided by USDA and NRCS.