

Soils Map

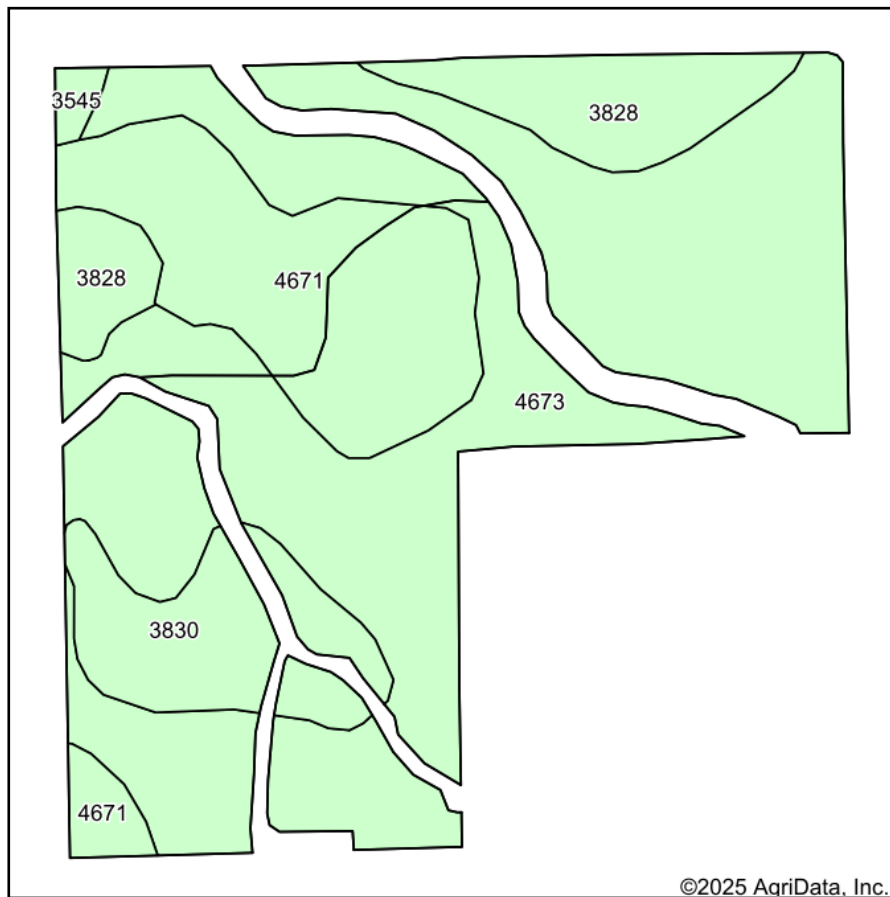

Soils data provided by USDA and NRCS.

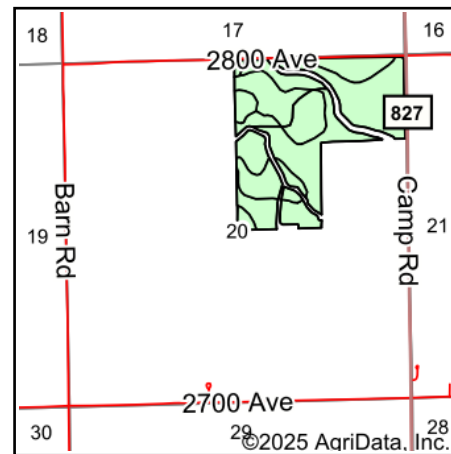

State: **Kansas**
 County: **Dickinson**
 Location: **20-12S-1E**
 Township: **Willowdale**
 Acres: **108.36**
 Date: **11/21/2025**



Maps Provided By:



Area Symbol: KS041, Soil Area Version: 24						
Code	Soil Description	Acres	Percent of field	Non-Irr Class *c	Irr Class *c	*n NCCPI Soybeans
4673	Irwin silty clay loam, 3 to 7 percent slopes	66.26	61.2%	IVe	IVe	57
4671	Irwin silty clay loam, 1 to 3 percent slopes	20.94	19.3%	IIIs	IIIs	55
3828	Crete silty clay loam, 1 to 3 percent slopes	10.53	9.7%	Ile	Ile	63
3830	Crete silty clay loam, 3 to 7 percent slopes	9.88	9.1%	IIle	IIle	62
3545	Hobbs silt loam, channeled, frequently flooded	0.75	0.7%	Vw		44
Weighted Average				3.53	*-	*n 57.6

*n: The aggregation method is "Weighted Average using all components"

*c: Using Capabilities Class Dominant Condition Aggregation Method

*- Irr Class weighted average cannot be calculated on the current soils data due to missing data.

Soils data provided by USDA and NRCS.