

Soils Map

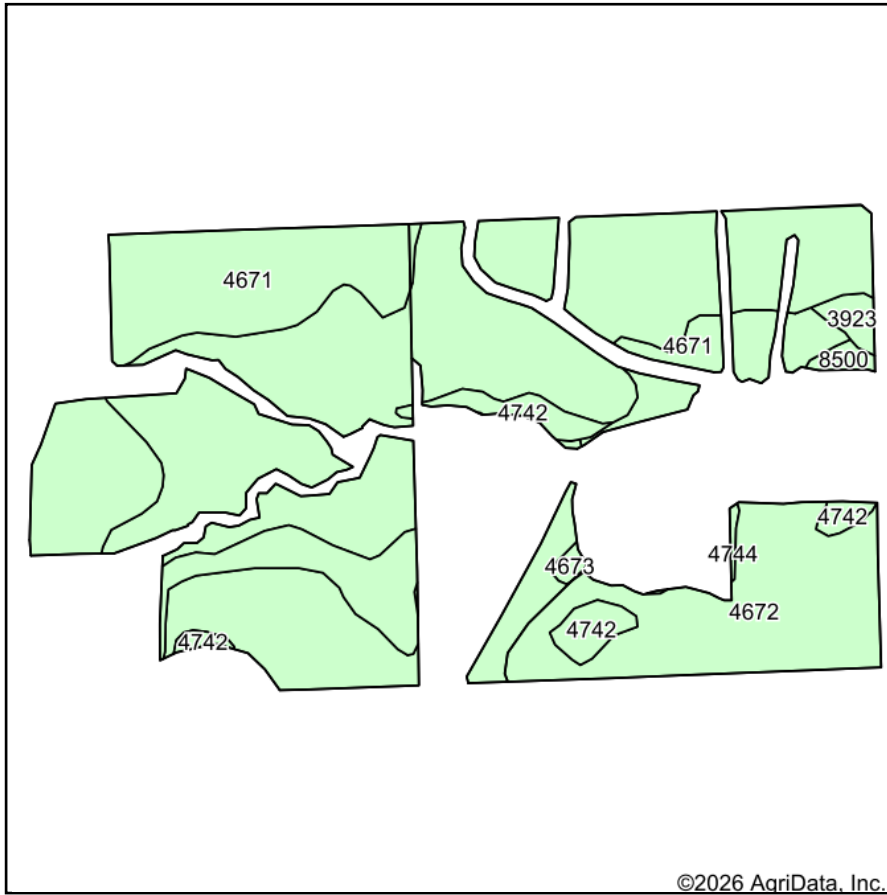

Soils data provided by USDA and NRCS.

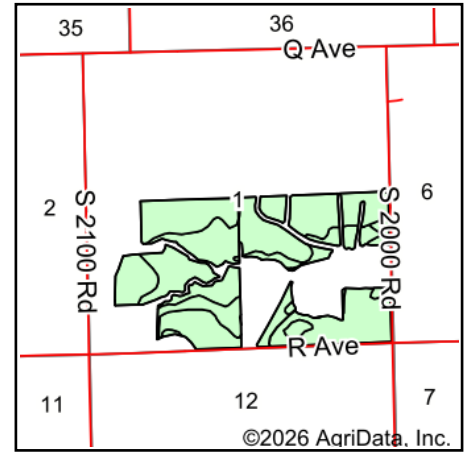

State: **Kansas**
 County: **Morris**
 Location: **1-16S-6E**
 Township: **Township No. 9**
 Acres: **188.92**
 Date: **2/18/2026**



Maps Provided By:



Area Symbol: KS127, Soil Area Version: 22

Code	Soil Description	Acres	Percent of field	Non-Irr Class *c	Irr Class *c	*n NCCPI Soybeans
4672	Irwin silty clay loam, 1 to 3 percent slopes, eroded	128.74	68.1%	IVe	IVe	50
4671	Irwin silty clay loam, 1 to 3 percent slopes	50.09	26.5%	IIIIs	IIIIs	55
4742	Labette silty clay loam, 3 to 7 percent slopes	6.53	3.5%	IIIle	IIle	43
3923	Smolan silty clay loam, 3 to 7 percent slopes, eroded	1.62	0.9%	IIIle	IIIle	57
8500	Mason and Reading silt loams, rarely flooded	0.99	0.5%	Iw	Iw	79
4673	Irwin silty clay loam, 3 to 7 percent slopes	0.63	0.3%	IVe	IVe	57
4744	Labette-Dwight complex, 0 to 3 percent slopes	0.32	0.2%	IIle	IIle	43
Weighted Average				3.67	3.64	*n 51.3

*n: The aggregation method is "Weighted Average using all components"

*c: Using Capabilities Class Dominant Condition Aggregation Method

Soils data provided by USDA and NRCS.