

Soils Map

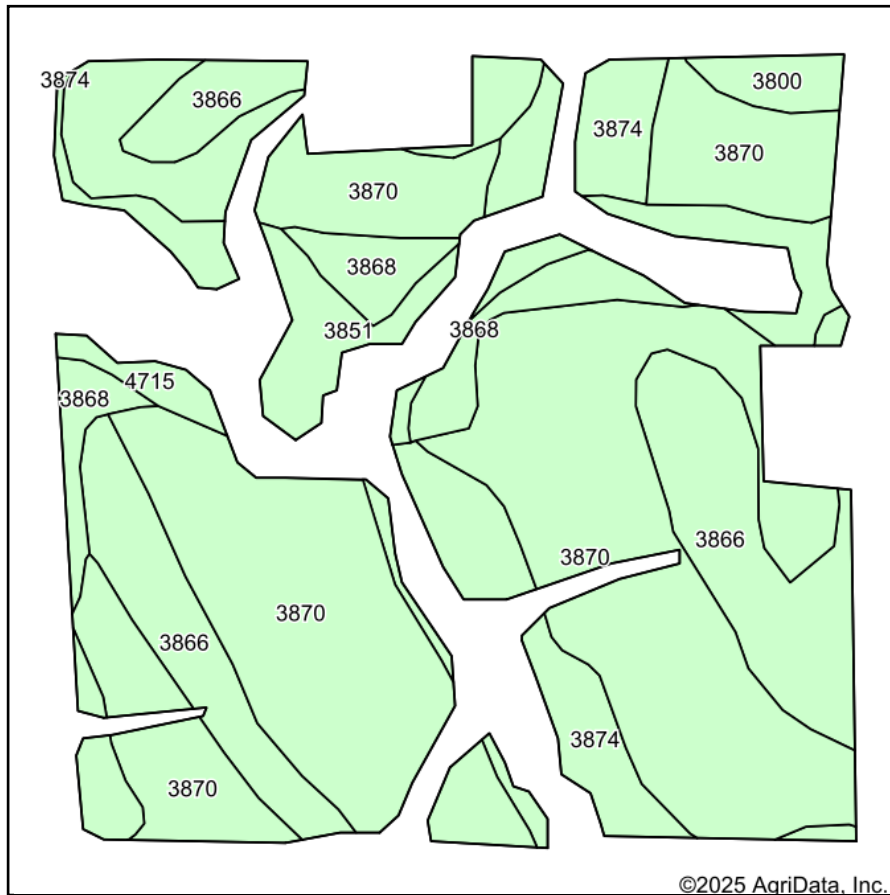

Soils data provided by USDA and NRCS.

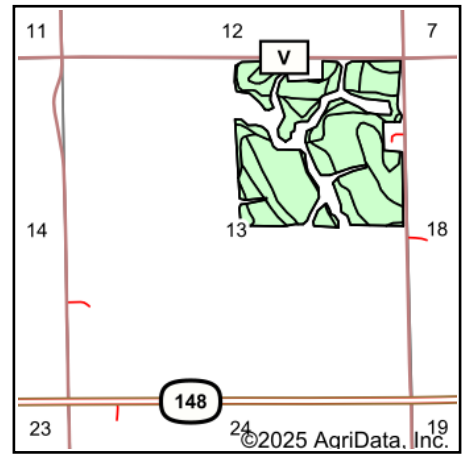

State: **Kansas**
 County: **Republic**
 Location: **13-4S-4W**
 Township: **Norway**
 Acres: **114.67**
 Date: **10/14/2025**



Maps Provided By:



Area Symbol: KS157, Soil Area Version: 23

Code	Soil Description	Acres	Percent of field	Non-Irr Class *c	Irr Class *c	*n NCCPI Soybeans
3870	Hastings silty clay loam, 3 to 7 percent slopes, eroded	63.98	55.9%	IIIe	IIIe	58
3866	Hastings silt loam, 1 to 3 percent slopes	19.72	17.2%	Ile	Ile	67
3874	Hastings-Hobbs complex, 0 to 25 percent slopes	11.16	9.7%	VIe		66
3851	Geary-Hobbs silt loams, 0 to 30 percent slopes	8.76	7.6%	VIe		66
3868	Hastings silt loam, 3 to 7 percent slopes	6.58	5.7%	IIIe	IIIe	67
4715	Kipson soils, 5 to 30 percent slopes	2.78	2.4%	VIIs		26
3800	Crete silt loam, 0 to 1 percent slopes, loess plains and breaks	1.69	1.5%	IIs	IIs	65
Weighted Average				3.41	*-	*n 60.8

*n: The aggregation method is "Weighted Average using all components"

*c: Using Capabilities Class Dominant Condition Aggregation Method

*- Irr Class weighted average cannot be calculated on the current soils data due to missing data.