

# Soils Map

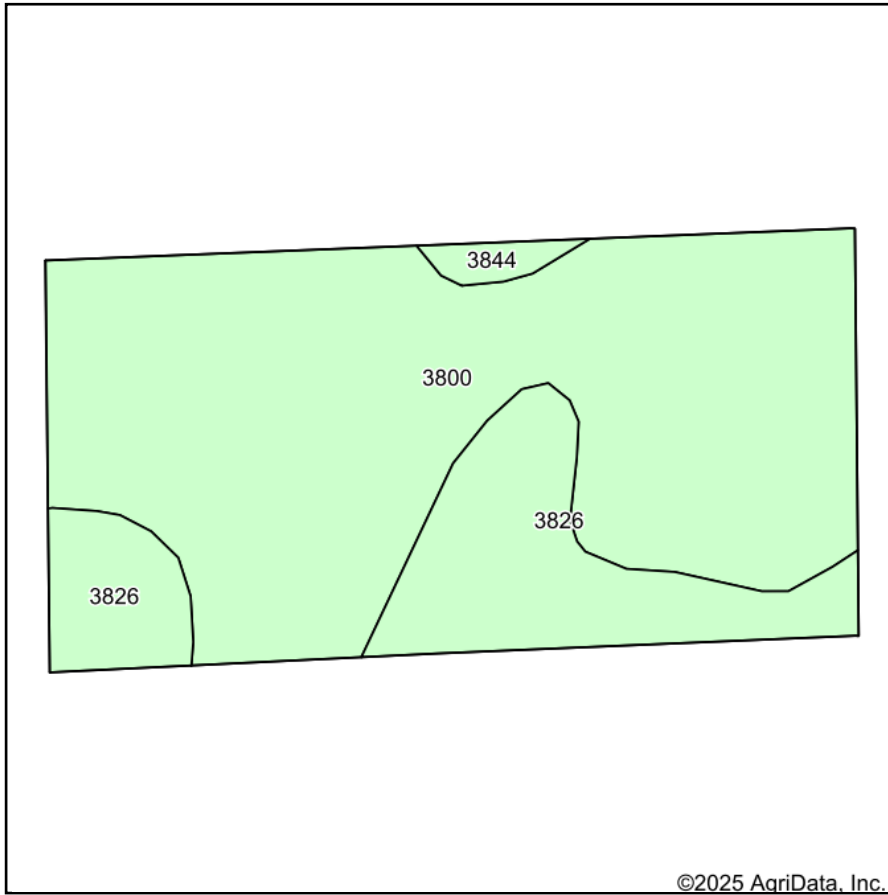

Soils data provided by USDA and NRCS.

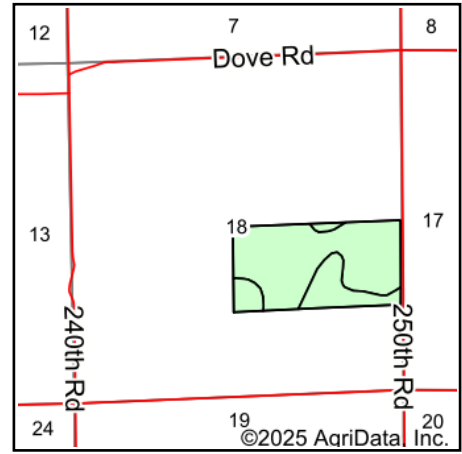

State: **Kansas**  
 County: **Ottawa**  
 Location: **18-12S-1W**  
 Township: **Lincoln**  
 Acres: **79.38**  
 Date: **9/26/2025**



Maps Provided By:



Area Symbol: KS143, Soil Area Version: 22

Code	Soil Description	Acres	Percent of field	Non-Irr Class *c	Irr Class *c	*n NCCPI Soybeans
3800	Crete silt loam, 0 to 1 percent slopes, loess plains and breaks	59.60	75.1%	IIs	IIs	65
3826	Crete silt loam, 3 to 7 percent slopes	18.63	23.5%	IIIe	IIIe	63
3844	Geary silt loam, 3 to 7 percent slopes	1.15	1.4%	IIIe	IIIe	71
Weighted Average				2.25	2.25	*n 64.6

\*n: The aggregation method is "Weighted Average using all components"

\*c: Using Capabilities Class Dominant Condition Aggregation Method