

Stationery

WORKS

home of
CHECKERBOARD
DESIGNERS' FINE PRESS
LALLIE

CREATIVE LIBRARY TOOLS

PRICING & SERVICES

January 1, 2026

V5

This book has been designed to guide you in pricing any printed item from any of our Stationery Works Brands and works in conjunction with the Creative Library, our albums and websites.

Using this book you will be able to price any order from
Designers’ Fine Press, Checkerboard and Lallie.

Our Customer Service Team is always available to assist you in answering any question you might have about our capabilities and pricing. Feel free to reach out to us!

ring 513-831-0523 | orders@stationeryworks.com | fax 513-831-0103
Monday - Friday | 8:30 AM - 5:00 PM

stationeryworks.com
designersfinepress.com | checkerboardltd.com | lallie.com



TABLE OF CONTENTS

INVITATIONS AND ANNOUNCEMENTS

Invitation Sizes 8
Letterpress Base Pricing 9
Thermography and Flat Base Pricing 10
Digital Base Pricing 11
Foil Base Pricing 12

ENVELOPES

Standard and Upgraded Envelopes 14
Envelope Chart 15
Return Address and Guest Address Printing 16
Liners and Decorations 17
Ordering Envelopes Only 18

ACCESSORY CARDS

COMPANION, REPLY CARDS & ENVELOPES

Letterpress Base Pricing 20
Thermography and Flat Base Pricing 21
Digital Base Pricing 22
Foil Base Pricing 23

NOTE CARDS AND STATIONERY

Note Cards 26-27
Letterhead 28-29
Business Cards 30-31
Sympathy Cards 32

OPTIONS

LAYERS AND PAPERS

Add A Layer 34
Price Code 2 & 3 Papers 35

EMBELLISHMENTS

Shape Options, Corner Rounding, Hole Drilling . 35
Edge Treatment Options 36
Pockets & Portfolios 37
Belly Bands 38
Ribbons 39
Embossed Frames & Art. 40
Photos, Assembly & Extras 40

DAY-OF

Program Pricing 42-43
Menu Pricing 44
Place Cards & Table Cards 45

SPECIALTY CARDS AND LALLIE

Folded and Specialty Folded Cards 48-49
Lallie 50-51

ADDITIONAL INFORMATION

Additional Services and Details 54-55

HOW TO PRICE

PRICING EXAMPLES FOR QUANTITY 100

THERMOGRAPHY SUITE
A8 Invitation Set and 4bar Reply Set
printed in Gold Thermography ink (all pieces) on
Pearl 130# Cover and standard envelopes

WHERE TO START?

Thermography and Flat Base Pricing on pages 10 and 21

- Invitation Classic Size, 1 color Gold Thermography.....\$315
- Return Address, 1 color Gold Thermography.....\$95
- Reply Card & 4bar Envelope, 1 color Gold Thermography....\$330

SUITE PRICE IS \$7.40 EA



THERMOGRAPHY SUITE
Same design as above, printed in *Black Thermography ink*



Printing in all black ink takes advantage of our
SIGNATURE COLLECTION PRICING!
See page 10 and 21 for details.

- Invitation Classic Size, 1 color Black Thermography.....\$295
- Return Address, 1 color Black Thermography.....\$85
- Reply Card & 4bar Envelope 1 color Black Thermography....\$295

SUITE PRICE IS \$6.75 EA



COMBINING PRINT METHODS LETTERPRESS + DIGITAL

A8 Invitation Set and 4bar Reply Set
Invitation printed in Twilight Letterpress and Full Color
Digital Inks Envelopes and Reply Set printed in Twilight
Digital Ink on Pearl 130# Cover and standard envelopes

START WITH THE INVITATION

Letterpress Base Pricing on page 9

- Invitation Classic Size, 1 color Twilight Letterpress.....\$410
- Additional Printing, Add Digital printing.....\$200
- Total Invitation Cost.....\$610

NEXT, THE ENVELOPES AND REPLY SET
Return Address on page 16 and Digital Base Pricing on page 22

- Return Address, Twilight Digital.....\$90
- Reply Card & 4bar Envelope, Full Color Digital.....\$285

SUITE PRICE IS \$9.85 EA



HOW TO ORDER

1. EMAIL OR FAX US YOUR ORDER FORMS

We strive to bring your client's vision to life starting with the very first proof set. Complete order forms are the best way for us to clearly understand your order and send an accurate proof. The more detail the better! We welcome any available supporting references including sketches, inspirations, and word documents.

Our order form is available in two formats to choose from:
Download & Print PDF and Electronic Form PDF
Both versions can be found on our websites within Dealer Resources.

Submit your form via email or fax:
orders@stationeryworks.com
f 513.831.0103 or f 866.317.4157

2. WE EMAIL YOU AN ORDER CONFIRMATION

Look for an order confirmation email within 1 business day. If you do not receive a confirmation, please contact us to be sure we received your order successfully.

3. WE EMAIL YOU A FREE PROOF SET AND COVER SHEET

You will receive a complimentary Proof via email. Our proofs are sent in color, to size, and include all the necessary production details in the header. PLEASE check ALL information! Read your text to make sure everything is spelled correctly, check dates and addresses and times and venues, and then read all the text again! Check, check, and triple check!

Need to make some changes? Up to three complimentary proof sets are included with your order. Orders with lots of custom design work may receive fewer complimentary proofs. Additional proof sets are available for \$50 retail each.

4. EMAIL OR FAX US YOUR APPROVAL

When your proofs are just perfect, please fax or email signed approved proof versions for each item along with your cover sheet. In order to make certain we know exactly which version(s) you are expecting we will only proceed to print once these signed forms have been received.

5. WE EMAIL YOU AN APPROVAL CONFIRMATION

We will confirm in 1 business day that we've received your approval and provide an anticipated ship date. Like sending in orders, if you don't receive our confirmation email then we didn't get your approval and the order remains on hold.

The image shows a detailed order form from Stationery Works. It includes sections for Designer's Fine Press, Client Information, Shipping, Text, Finished Size, Paper, Methods & Colors, Typesetting, Finishing, Photo Services, and Guest Addressing. A large blue circular overlay with white text reads "COMPLETE FORMS = FAST & ACCURATE PROOFS".

NO FAX?
SNAP A PIC &
EMAIL

3 FREE
PROOF SETS!

The image shows a wedding invitation proof from Stationery Works. The invitation text reads: "MR. and MRS. TIMOTHY J. LIVINGSTON REQUEST the PLEASURE of YOUR COMPANY at the MARRIAGE of THEIR DAUGHTER Katherine Marie to Dylan Samuel Wright". The date and time are "SATURDAY, THE SEVENTH of JUNE TWO THOUSAND TWENTY-FIVE at HALF PAST FIVE O'CLOCK in the EVENING". The venue is "THE LIBERTY WAREHOUSE brooklyn, new york". The reception is to follow. A blue circular overlay with white text reads "APPROVED? SIGN HERE".

INVITATIONS
AND
ANNOUNCEMENTS

INVITATIONS AND ANNOUNCEMENTS SIZES

CLASSIC CARD SIZES

4Bar 3.5" x 4.875"	A2 4.25" x 5.5"	Baronial 5.25" x 5.25"	A6 4.5" x 6.25"	A7 5" x 7"	A7 Outer 5.25" x 7.25"
Monarch 3.625" x 7.25"	A8 5.25" x 7.75"	A8 Outer 5.5" x 8"			

GRAND CARD SIZES

Marquis 6.75" x 6.75"	Marquis Outer 7" x 7"	Duchess 5.88" x 7.88"	Duchess Outer 6.13" x 8.13"	A9 5.5" x 8.5"	A9 Outer 5.75" x 8.75"
No. 10 4" x 9.25"	A10 5.75" x 9.25"	A10 Outer 6" x 9.5"			

REGAL CARD SIZES

Supreme 7.75" x 7.75"	Royalty 6.125" x 8.875"	Royalty Outer or Royalty Palisade 6.25" x 9.125"	Grandee 4.75" x 9.75"	8.25" Square 8.25" x 8.25"
--------------------------	----------------------------	---	--------------------------	-------------------------------

INVITATIONS AND ANNOUNCEMENTS

FIRST PRINTED CARD BASE PRICING BY PRINT METHOD

LETTERPRESS

QTY	SIZE CLASSIC	SIZE GRAND	SIZE REGAL	RETURN ADDRESS
25	\$355	\$383	\$478	\$105
50	366	396	505	110
75	388	423	560	120
100	410	450	615	130
125	455	505	725	150
150	500	560	835	170
175	545	615	945	190
200	590	670	1055	210
225	635	725	1165	230
250	680	780	1275	250
ADD 25	45	55	110	20

PRICE INCLUDES

- 1 Letterpress ink color on Letterpress paper or Matte Price Code 1 single ply papers
- Invitation includes unprinted Standard envelope or Letterpress envelope (*while supplies last*)

ADDITIONAL PRINTING

FLAT FEE FOR QUANTITIES UNDER 500

Add 2nd Letterpress ink \$200
 Add 3rd Letterpress ink \$250
 Add Digital printing \$200
 Add Digital reverse side printing . . . \$200

Print Return Address anywhere other than flap, add \$.68 per envelope to Return Address pricing

Letterpress Printing Considerations

When customizing, depending on the coverage and design, we may suggest "Special Press Handling" which can include additional fees. Please see our Design Tips online for examples or contact us with any questions.



Printing in all black ink takes advantage of our
SIGNATURE COLLECTION PRICING!

LETTERPRESS BLACK INK

QTY	INVITATION		RETURN ADDRESS
	CLASSIC	GRAND	
25	\$325	\$355	\$95
50	336	368	100
75	358	394	110
100	380	420	120
125	423	473	139
150	466	526	158
175	509	579	177
200	552	632	196
225	595	685	215
250	638	738	234
ADD 25	43	53	19

PRICE INCLUDES

Black Letterpress ink color on:

- Letterpress paper or Matte Price Code 1 single ply papers
- Invitation includes unprinted Standard envelope or Letterpress envelope (*while supplies last*)

Print Return Address anywhere other than flap, add \$.68 per envelope to Return Address pricing

ADDITIONAL PRINTING

options do not apply to the Signature Collection Pricing

INVITATIONS AND ANNOUNCEMENTS

FIRST PRINTED CARD

BASE PRICING BY PRINT METHOD

THERMOGRAPHY AND FLAT

QTY	SIZE CLASSIC	SIZE GRAND	SIZE REGAL	RETURN ADDRESS
25	\$253	\$290	\$408	\$88
50	265	305	435	88
75	290	335	490	88
100	315	365	545	95
125	365	425	655	110
150	415	485	765	125
175	465	545	875	140
200	515	605	985	155
225	565	665	1095	170
250	615	725	1205	185
ADD 25	50	60	110	15

PRICE INCLUDES

- 1 Thermography/Flat ink color on Price Code 1 single ply papers (excluding Letterpress papers)
- Invitation includes unprinted Standard envelope

ADDITIONAL PRINTING

FLAT FEE FOR QUANTITIES UNDER 500

Add 2nd Thermo/Flat ink \$200
 Add 3rd Thermo/Flat ink \$250
 Add Digital printing \$200
 Add Digital reverse side printing . . . \$200

Print Return Address anywhere other than flap, add \$.68 per envelope to Return Address pricing



Printing in all black ink takes advantage of our
SIGNATURE COLLECTION PRICING!

THERMOGRAPHY BLACK INK

QTY	INVITATION CLASSIC	GRAND	RETURN ADDRESS
25	\$235	\$263	\$78
50	247	277	78
75	271	306	78
100	295	335	85
125	343	393	99
150	391	451	113
175	439	509	127
200	487	567	141
225	535	625	155
250	583	683	169
ADD 25	48	58	14

PRICE INCLUDES

Black Thermography ink color on:

- Price Code 1 single ply papers (excluding Letterpress papers)
- Invitation includes unprinted Standard envelope

Print Return Address anywhere other than flap, add \$.68 per envelope to Return Address pricing

ADDITIONAL PRINTING

options do not apply to the
Signature Collection Pricing

INVITATIONS AND ANNOUNCEMENTS

FIRST PRINTED CARD BASE PRICING BY PRINT METHOD

DIGITAL

QTY	SIZE CLASSIC	SIZE GRAND	SIZE REGAL	RETURN ADDRESS
25	\$220	\$270	\$390	\$80
50	230	280	410	80
75	245	300	450	85
100	260	320	490	90
125	310	375	590	103
150	360	430	690	116
175	410	485	790	129
200	460	540	890	142
225	510	595	990	155
250	560	650	1090	168
ADD 25	50	55	100	13

PRICE INCLUDES

- Full Color Digital printing on Price Code 1 single ply papers (excluding Letterpress papers*)
- Invitation includes unprinted Standard envelope

PRICE DETAILS

- *To upgrade to Letterpress paper or Letterpress Envelope (*while supplies last*) with Digital printing, add \$.30 per card and \$.30 per envelope

ADDITIONAL PRINTING

FLAT FEE FOR QUANTITIES UNDER 500

Add Digital reverse side printing to a Digitally printed front \$150

If adding Letterpress, Thermography, Flat or Foil printing, please start with pricing from those pages and then "Add Digital Printing" pricing to card.



Printing in all black ink takes advantage of our
SIGNATURE COLLECTION PRICING!

DIGITAL BLACK INK

QTY	INVITATION		RETURN ADDRESS
	CLASSIC	GRAND	
25	\$210	\$260	\$75
50	220	270	75
75	235	280	80
100	250	295	85
125	298	348	97
150	346	401	109
175	394	454	121
200	442	507	133
225	490	560	145
250	538	613	157
ADD 25	48	53	12

PRICE INCLUDES

Black Digital printing on:

- Price Code 1 single ply papers (excluding Letterpress papers*)
- Invitation includes unprinted Standard envelope

PRICE DETAILS

- *To upgrade to Letterpress paper or Letterpress Envelope (*while supplies last*) with Digital printing, add \$.30 per card and \$.30 per envelope

ADDITIONAL PRINTING

options do not apply to the Signature Collection Pricing

INVITATIONS AND ANNOUNCEMENTS

FIRST PRINTED CARD

BASE PRICING BY PRINT METHOD

FOIL

QTY	SIZE CLASSIC	SIZE GRAND	SIZE REGAL	RETURN ADDRESS
25	645	\$673	\$768	\$262
50	660	689	798	270
75	685	722	859	285
100	710	755	918	300
125	765	821	1039	330
150	820	887	1160	360
175	875	953	1281	390
200	930	1019	1402	420
225	985	1085	1523	450
250	1040	1151	1644	480
ADD 25	55	66	121	30

PRICE INCLUDES

- 1 Foil color on Price Code 1 single ply papers
- Invitation includes unprinted Standard envelope or Letterpress envelope (*while supplies last*)

ADDITIONAL PRINTING

FLAT FEE FOR QUANTITIES UNDER 500

Add 1 Letterpress ink \$200
 Add 1 Thermo/Flat ink \$200
 Add Digital printing \$200
 Add 2nd Foil color \$450
 Add 3rd Foil color \$500
 Add 2nd Letterpress/Thermo/Flat ink . . \$250
 Add Digital reverse side printing \$200

ENVELOPES

ENVELOPES

Envelope Type	Colors Available	Can Install Optional Paper Liner?	Can Digitally Print Interior Decoration?	Print Method Available	Upgrade Cost <i>per env</i>	Ordering Extra or Envelopes Only <i>per env</i>
Standard	White, Pearl, Cream	Yes	No	All Print Methods	\$0.00	\$0.80
Standard Inner		Yes	No	All Print Methods	n/a	\$0.80
Colored (PC 1 papers)	4BAR - PC1 Papers	Yes	No	All Print Methods	\$0.70	\$1.50
	A8, A10, Duchess & Marquis*	Yes	No	All Print Methods	\$0.90	\$1.70
<i>while supplies last</i> Letterpress	White, Pearl	Yes	No	Letterpress, Foil, Digital [*]	\$0.30	\$1.10
<i>while supplies last</i> Letterpress Inner		Yes	No	Letterpress, Foil, Digital [*]	n/a	\$1.10
Palisade						
Taj, Rondo, Diamond, Mansart	White, Pearl, Cream	No	Yes <i>(included in cost!)</i>	Digital Only	\$5.00	\$5.80
French, Geneva, Royalty, Supreme		Yes	Yes <i>(included in cost!)</i> <i>*excluding French A10</i>	Digital Only	\$5.00	\$5.80
Palisade Plus						
Taj, Rondo, Diamond, Mansart Colored	Price Code 1 Papers	No	No	Digital Only	\$5.00	\$5.80
French, Geneva, Royalty, Supreme Colored		Yes	No	Digital Only	\$5.00	\$5.80
Heavyweight						
A8 & A10 Pointed Flap	White, Pearl, Cream	Yes	No	All Print Methods	\$3.00	\$3.80
<i>while supplies last</i> French, Bavarian, Geneva, Swiss	White, Cream	Yes	No	All Print Methods	\$3.00	\$3.80

Colored Envelopes:

- For Colored Envelope Options, please reference your Price Code 1 Swatch Deck and our Resources online.
- We stock 4bar, A8, Duchess & A10 size Colored Envelopes, and select Colors in the Marquis size. Additional Sizes might be available for Special Order. Cost varies, however minimum cost would be Colored Envelope Fee + \$100.

Letterpress Envelopes:

- Only an upgrade cost if printing a Digital Return Address, or if paired with a non-Letterpress Card.*

Palisade Envelopes:

- Envelopes are made by hand and do not have a gum line. A pack of Double Sided Tape Tabs are included to seal the envelope. For Envelopes in White, Pearl and Cream, a Decoration can be digitally printed on the interior for no additional cost.

Palisade Plus Envelopes:

- Envelopes are made by hand and do not have a gum line. A pack of Double Sided Tape Tabs are included to seal the envelope.
- Any Colored Cover Weight (PC1) Stock is an option, excluding Letterpress papers.
- Interior Decoration Printing is not available with Colored Cardstock.

Heavyweight Envelopes:

- Heavyweight Envelopes available in the A8 & A10 Pointed Flap. Made from 100# Cardstock.
- Special Flap Styles and color options available while supplies last.

ADD EASY STICK ENVELOPE TAPE to any Square Flap Envelope for \$.30 per envelope (\$20 min).

ENVELOPES



ENVELOPE AVAILABILITY

WHITE | PEARL | CREAM

	4Bar <i>Classic</i>	A2 <i>Classic</i>	A6 <i>Classic</i>	A7 <i>Classic</i>	A8 <i>Classic</i>	Duchess <i>Grand</i>	A9 <i>Grand</i>	A10 <i>Grand</i>	Monarch <i>Classic</i>	#10 <i>Grand</i>	Grandee <i>Regal</i>	Royalty <i>Regal</i>	Baronial <i>Classic</i>	Marquis <i>Grand</i>	Supreme <i>Regal</i>	8.25" <i>Regal</i>
<i>card size</i>	4.875" x 3.5"	4.25" x 5.5"	4.5" x 6.25"	5" x 7"	5.25" x 7.75"	5.88" x 7.88"	5.5" x 8.5"	5.75" x 9.25"	3.625" x 7.25"	3.625" x 7.25"	4.75" x 9.75"	6.125" x 8.875"	5.25" x 5.25"	6.75" x 6.75"	7.75" x 7.75"	8.25" x 8.25"
STANDARD VELLUM <i>available in:</i> white pearl cream <i>See the Creative Library for colored envelope options</i>																
UPGRADE LETTERPRESS* <i>while supplies last:</i> white pearl																
UPGRADE PALISADE CARDSTOCK <i>available in:</i> white pearl cream <i>Palisade Plus also available in PCI colored stocks (excludes Letterpress papers)</i>																
UPGRADE HEAVYWEIGHT <i>available in:</i> white pearl cream																

* Letterpress envelopes are included (not an upgrade) when printed in Letterpress or Foil

RETURN ADDRESS PRINTING

QTY	LETTERPRESS			THERMOGRAPHY			DIGITAL		FOIL
	Back Flap	Signature Black Ink	Other than Back Flap	Back Flap	Signature Black Ink	Other than Back Flap	Front and or Flap	Signature Black Ink	Back Flap
25	\$105	\$95	+17	\$88	\$78	+17	\$80	\$75	\$262
50	110	100	+34	88	78	+34	80	75	270
75	120	110	+51	88	78	+51	85	80	285
100	130	120	+68	95	85	+68	90	85	300
125	150	139	+85	110	99	+85	103	97	330
150	170	158	+102	125	113	+102	116	109	360
175	190	177	+119	140	127	+119	129	121	390
200	210	196	+136	155	141	+136	142	133	420
225	230	215	+153	170	155	+153	155	145	450
250	250	234	+170	185	169	+170	168	157	480
ADD 25	20	19	+17	15	14	+17	13	12	30

PRICE INCLUDES

1 Ink or Foil color or Digital full color on a standard envelope

Digital Printing a Return Address on Letterpress envelopes (*while supplies last*) is an additional \$.30 per envelope

ADDITIONAL PRINTING

FLAT FEE FOR QUANTITIES UNDER 500

To add 2nd ink (Letterpress, Thermography/Flat or Digital), start with highest price print method and add \$200

GUEST ADDRESSING

Let us complete the suite by digitally printing the guest addresses!

Download our Guest Addressing Template from the Resources page on our website.

Review the How-To Guide, fill out and email the list to orders@stationeryworks.com.

QTY	VARIABLE PRINTING	
	OUTER ENVELOPE	INNER ENVELOPE
25	\$85	\$55
50	120	70
75	180	105
100	240	140
125	300	175
150	360	210
175	420	245
200	480	280
225	540	315
250	600	350
ADD 25	60	35

FULL GUEST ADDRESS PROOF

Order a Full Guest Address Proof Set(s) on your order form or request one before the order is approved for print.

\$50 per proof set

Double envelopes are 2 proof sets

BONUS!

Digital return addressing is included for envelopes printed with guest addressing.

GUEST ADDRESSING QTY & COST

For quantities over 50, you will be billed for the exact number of guest addresses printed.

(no pricing adjustment for quantities under 50)

For quantities 50 or more:

\$2.40 per Outer Envelope

\$1.40 per Inner Envelope

For Qty 50 or more, the balance of envelopes with a printed

Digital Return Address will be billed at \$1.20 each.

(no pricing adjustment for quantities under 50)

LINERS

You can find the available Price Code 1, 2, 3 and 4 Liner Options in the Paper Swatch Decks.
In house Foil Liner Patterns can be found in the Creative Library and Resources online

	PRICE CODE 1	DIGITALLY PRINTED	PRICE CODE 2	PRICE CODE 3	PRICE CODE 4	FLAT PRINTED 1 color	LETTERPRESS 1 color	FOIL STAMPED 1 color in house foil pattern	FOIL STAMPED 1 color custom
QTY	PC1	ON PC1	PC2	PC3	PC4	ON PC1	ON PC1	ON PC1	ON PC1
25	\$66	\$121	\$121	\$154	\$176	\$240	\$341	\$250	\$550
50	78	128	128	166	188	255	352	300	600
75	117	192	192	249	282	285	385	350	650
100	156	256	256	332	376	305	429	407	707
125	195	320	320	415	470	370	501	506	806
150	234	384	384	498	564	435	573	605	905
175	273	448	448	581	658	500	645	704	1004
200	312	512	512	664	752	565	717	803	1103
225	351	576	576	747	846	630	789	902	1202
250	390	640	640	830	940	695	861	1001	1301
ADD 25	39	64	64	83	94	65	72	99	99

Digitally printed liners can add extra color and flair to any envelope.
Reference the Creative Library or Resources online for pattern options!

We can also create a Custom Liner for you, additional Design costs are below.

Custom Design Needed for Liner

Add Single Monogram or Name
Placing Print Ready File (see Creative Library for more information)
Enlarging or Decreasing Size of In House Artwork
Change Color (if applicable) of In House Pattern
Creating Repeating Pattern with In House Artwork
Creating Repeating Pattern with Custom Artwork, Name or Monogram
Supplied Artwork needing to be pieced together

Custom Design Fee

\$0
\$0
\$0
\$0
\$90
\$180
\$180

PALISADE DECORATIONS

Available with White, Pearl & Cream Envelopes

100# Cover Palisade envelopes take style to a new level

with your choice of decoration digitally printed on the inside included in its price!



Reference the
Creative Library or
Resources online for
envelope and
decoration options!

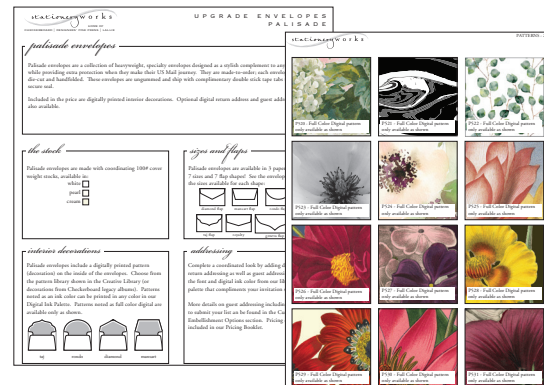

ORDERING ENVELOPES ONLY

PRINTING ON BACK FLAP

PRICE INCLUDES

- Standard Envelope
- 1 Ink or Foil color or Digital Full Color

If Guest Addressing needed, please add in that pricing on the previous page.

	LETTERPRESS	THERMO	DIGITAL	FOIL
QTY	Back Flap	Back Flap	Back Flap	Back Flap
25	\$225	\$208	\$200	\$382
50	250	228	220	410
75	280	248	245	445
100	310	275	270	480
125	350	310	303	530
150	390	345	336	580
175	430	380	369	630
200	470	415	402	680
225	510	450	435	730
250	550	485	468	780
ADD 25	40	35	33	50

PRINTING ON FRONT or OTHER THAN FLAP

PRICE INCLUDES

- Standard Envelope
- 1 Ink or Foil color or Digital Full Color

	LETTERPRESS	THERMO	DIGITAL	FOIL
QTY	Printing not on Flap	Printing not on Flap	Printing not on Flap	Printing not on Flap
25	\$242	\$225	\$217	\$399
50	284	262	254	444
75	331	299	296	496
100	378	343	338	548
125	435	395	388	615
150	492	447	438	682
175	549	499	488	749
200	606	551	538	816
225	663	603	588	883
250	720	655	638	950
ADD 25	57	52	50	67

UPGRADED ENVELOPE ADDER

ENVELOPE TYPE	PRINT METHOD	UPGRADE COST PER ENVELOPE
<i>while supplies last</i> Letterpress Envelopes	Letterpress, Foil, Digital	\$0.30
Colored Envelope <i>4bar</i>	Letterpress, Thermo/Flat, Foil, Digital	\$0.70
Colored Envelope <i>A8, Duchess, A10, Marquis*</i>	Letterpress, Thermo/Flat, Foil, Digital	\$0.90
Heavyweight Envelope <i>pointed & specialty flaps</i>	Letterpress, Thermo/Flat, Foil, Digital	\$3.00
Palisade Envelope	Digital only	\$5.00

ACCESSORY CARDS

Companion Cards,
Reply Cards,
Reply Envelopes

ACCESSORY CARDS

BASE PRICING BY PRINT METHOD

LETTERPRESS

QTY	COMPANION CARDS <i>flat cards</i>		REPLY ENVELOPES 4BAR, A2 & A6
	CLASSIC Reply, Reception	GRAND Details	
25	\$250	\$283	\$130
50	260	295	136
75	280	320	148
100	300	345	160
125	340	395	185
150	380	445	210
175	420	495	235
200	460	545	260
225	500	595	285
250	540	645	310
ADD 25	40	50	25

PRICE INCLUDES

- Companion Card: 1 Letterpress ink color on Letterpress paper or Matte Price Code 1 single ply papers. See page 8 for Classic & Grand Card Sizes.
- Reply Envelope: 4bar, A2 or A6, 1 Letterpress ink color on Standard or Letterpress envelope (*while supplies last*).

PRICE DETAILS

- Companion Card pricing is *only* used when it accompanies an Invitation.
- Reply Envelope Pricing is *only* used when it accompanies a Reply Card (any print method).

ADDITIONAL PRINTING FLAT FEE FOR QUANTITIES UNDER 500

Add 2nd Letterpress ink \$200
 Add 3rd Letterpress ink \$250
 Add Digital printing \$200
 Add Digital reverse side printing . . . \$200

Note: See Invitation Pricing if only ordering a Single Card. See Envelope Only Pricing in Envelope Section if only ordering an Envelope.



THE
Signature
COLLECTION

Letterpress Printing Considerations
 When customizing, depending on the coverage and design, we may suggest "Special Press Handling" which can include additional fees. Please see our Design Tips online for examples or contact us with any questions.

Printing in all black ink takes advantage of our
SIGNATURE COLLECTION PRICING!

LETTERPRESS BLACK INK

QTY	COMPANION CLASSIC Reply, Details	REPLY ENVELOPE 4BAR, A2 & A6
25	\$228	\$128
50	237	133
75	256	144
100	275	155
125	313	178
150	351	201
175	389	224
200	427	247
225	465	270
250	503	293
ADD 25	38	23

PRICE INCLUDES

Black Letterpress ink color on:

- Companion Card: Letterpress paper or Matte Price Code 1 single ply papers.
- Reply Envelope: 4bar, A2 or A6 Standard or Letterpress envelope (*while supplies last*).

PRICE DETAILS

- Companion Card pricing is *only* used when it accompanies an Invitation.
- Reply Envelope Pricing is *only* used when it accompanies a Reply Card (any print method).

ADDITIONAL PRINTING

options do not apply to the
Signature Collection Pricing

ACCESSORY CARDS

BASE PRICING BY PRINT METHOD

THERMOGRAPHY AND FLAT

QTY	COMPANION CARDS <i>flat cards</i>		REPLY ENVELOPES
	CLASSIC Reply, Details	GRAND Details	4BAR, A2 & A6
25	\$160	\$193	\$100
50	170	205	104
75	190	230	112
100	210	255	120
125	250	305	137
150	290	355	154
175	330	405	171
200	370	455	188
225	410	505	205
250	450	555	222
ADD 25	40	50	17

PRICE INCLUDES

- Companion Card: 1 Thermography/Flat ink color on Price Code 1 single ply papers (excluding Letterpress papers). See page 8 for Classic & Grand Card Sizes.
- Reply Envelope: 4bar, A2 or A6, 1 Thermography ink color on Standard envelope.

PRICE DETAILS

- Companion Card pricing is *only* used when it accompanies an Invitation.
- Reply Envelope Pricing is *only* used when it accompanies a Reply Card (any print method).

ADDITIONAL PRINTING

FLAT FEE FOR QUANTITIES UNDER 500

Add 2nd Thermo/Flat ink \$200
 Add 3rd Thermo/Flat ink \$250
 Add Digital printing \$200
 Digital reverse side printing \$200

Note: See Invitation Pricing if only ordering a Single Card. See Envelope Only Pricing in Envelope Section if only ordering an Envelope.



Printing in all black ink takes advantage of our
SIGNATURE COLLECTION PRICING!

THERMOGRAPHY BLACK INK

QTY	COMPANION CLASSIC	REPLY ENVELOPE
	Reply, Details	4BAR, A2 & A6
25	\$148	\$80
50	157	84
75	176	92
100	195	100
125	233	116
150	271	132
175	309	148
200	347	164
225	385	180
250	423	196
ADD 25	38	16

PRICE INCLUDES

Black Thermography ink color on:

- Companion Card: Price Code 1 single ply papers.
- Reply Envelope: 4bar, A2 or A6 Standard envelope.

PRICE DETAILS

- Companion Card pricing is *only* used when it accompanies an Invitation.
- Reply Envelope Pricing is *only* used when it accompanies a Reply Card (any print method).

ADDITIONAL PRINTING

options do not apply to the
Signature Collection Pricing

ACCESSORY CARDS

BASE PRICING BY PRINT METHOD

DIGITAL

QTY	COMPANION CARDS <i>flat cards</i>			REPLY ENVELOPES 4BAR, A2 & A6
	CLASSIC Reply, Details	GRAND Details	REGAL	
25	\$165	\$215	\$260	\$80
50	175	225	270	80
75	185	240	290	85
100	195	255	310	90
125	228	300	365	107
150	261	345	420	124
175	294	390	475	141
200	327	435	530	158
225	360	480	585	175
250	393	525	640	192
ADD 25	33	45	55	17

PRICE INCLUDES

- Companion Card: Full Color Digital printing on Price Code 1 single ply papers (**excluding Letterpress papers*). See page 8 for Classic, Grand & Regal Card Sizes.
- Reply Envelope: 4bar, A2 or A6, Digital Printing on Standard envelope.

PRICE DETAILS

- Companion Card pricing is *only* used when it accompanies an Invitation.
- Reply Envelope Pricing is *only* used when it accompanies a Reply Card (any print method).

*To upgrade to Letterpress paper or Letterpress envelope with Digital printing, add \$.30 per card and \$.30 per envelope.

ADDITIONAL PRINTING

FLAT FEE FOR QUANTITIES UNDER 500

Add Digital reverse side printing to a Digitally printed front. \$150

If adding Letterpress, Thermography, Flat or Foil printing, start with pricing from those pages and then "Add Digital Printing" pricing to card.

Note: See Invitation Pricing if only ordering a Single Card. See Envelope Only Pricing in Envelope Section if only ordering an Envelope.



THE
Signature
COLLECTION

Printing in all black ink takes advantage of our
SIGNATURE COLLECTION PRICING!

DIGITAL BLACK INK

QTY	COMPANION CLASSIC	REPLY ENVELOPE
	Reply, Details	4BAR, A2 & A6
25	\$155	\$70
50	165	70
75	175	75
100	185	80
125	216	96
150	247	112
175	278	128
200	309	144
225	340	160
250	371	176
ADD 25	31	16

PRICE INCLUDES

Black Digital printing on:

- Price Code 1 single ply papers (**excluding Letterpress papers*).
- Reply Envelope: sized 4bar, A2 or A6 standard envelope.

PRICE DETAILS

- Companion Card pricing is *only* used when it accompanies an Invitation.
- Reply Envelope Pricing is *only* used when it accompanies a Reply Card (any print method).

*To upgrade to Letterpress paper or Letterpress envelope (*while supplies last*) with Digital printing, add \$.30 per card and \$.30 per envelope.

ADDITIONAL PRINTING

options do not apply to the Signature Collection

ACCESSORY CARDS

BASE PRICING BY PRINT METHOD

FOIL

QTY	COMPANION CARDS <i>flat cards</i>		REPLY ENVELOPES
	CLASSIC Reply, Details	GRAND Details	4BAR, A2 & A6
25	\$408	\$555	\$168
50	420	570	176
75	445	600	193
100	470	630	210
125	520	691	245
150	570	752	280
175	620	813	315
200	670	874	350
225	720	935	385
250	770	996	420
ADD 25	50	61	35

Note: See Invitation Pricing if only ordering a Single Card. See Envelope Only Pricing in Envelope Section if only ordering an Envelope.

PRICE INCLUDES

- Companion Card: 1 Color Foil printing on Price Code 1 single ply papers. See page 8 for Classic & Grand Card Sizes.
- Reply Envelope: 4bar, A2 or A6, 1 Color Foil on Standard envelope.

PRICE DETAILS

- Companion Card pricing is *only* used when it accompanies an Invitation.
- Reply Envelope Pricing is *only* used when it accompanies a Reply Card (any print method).

ADDITIONAL PRINTING

FLAT FEE FOR QUANTITIES UNDER 500

Add 1 Letterpress ink.....\$200
 Add 1 Thermo/Flat ink.....\$200
 Add Digital printing.....\$200
 Add 2nd Foil color.....\$450
 Add 2nd Letterpress/Thermo/Flat ink..\$250
 Add Digital reverse side printing.....\$200

NOTE CARDS & STATIONERY

Note Cards,
Letterhead,
Business Cards,
Sympathy Cards

NOTE CARDS

BASE PRICING BY PRINT METHOD

LETTERPRESS

QTY	REGULAR SIZE 4bar, A2, A6		LARGE SIZE Monarch, A7, A8, Baronial		XLARGE SIZE No. 10	
	1 Ink	Signature Black Ink	1 Ink	Signature Black Ink	1 Ink	Signature Black Ink
25	\$330	\$303	\$355	\$325	\$383	\$355
50	340	312	366	336	396	368
75	360	331	388	358	423	394
100	380	350	410	380	450	420
125	420	388	455	424	505	473
150	460	426	500	468	560	526
175	500	464	545	512	615	579
200	540	502	590	556	670	632
225	580	540	635	600	725	685
250	620	578	680	644	780	738
ADD 25	40	38	45	44	55	53

NOTE CARD ORDERING INFORMATION:

Note Cards can be ordered by themselves, and do not have to accompany an Invitation order. Note Cards would feature a Name or Monogram. If ordering any other type of card, please use Invitation or Folded Card pricing.

PRICE INCLUDES

- FLAT OR FOLDED NOTE CARD
- 1 Letterpress ink color on Letterpress paper or Matte Price Code 1 single ply papers.
- Note Card includes unprinted Standard or Letterpress envelope *(while supplies last)*.

ADDITIONAL PRINTING

FLAT FEE FOR QUANTITIES UNDER 500

Add 2nd Letterpress ink \$200
 Add 3rd Letterpress ink \$250
 Add Digital printing \$200
 Add Digital reverse side printing . . . \$200

THERMOGRAPHY

QTY	REGULAR SIZE 4bar, A2, A6		LARGE SIZE Monarch, A7, A8, Baronial		XLARGE SIZE No. 10	
	1 Ink	Signature Black Ink	1 Ink	Signature Black Ink	1 Ink	Signature Black Ink
25	\$187	\$173	\$253	\$235	\$290	\$263
50	198	183	265	247	305	277
75	220	204	290	271	335	306
100	242	225	315	295	365	335
125	286	268	365	343	425	393
150	330	311	415	391	485	451
175	374	354	465	439	545	509
200	418	397	515	487	605	567
225	462	440	565	535	665	625
250	506	483	615	583	725	683
ADD 25	44	43	50	48	60	58

PRICE INCLUDES

- FLAT OR FOLDED NOTE CARD
- 1 Thermography ink color on Price Code 1 single ply papers (excluding Letterpress papers).
- Note Card includes unprinted Standard Envelope.

ADDITIONAL PRINTING

FLAT FEE FOR QUANTITIES UNDER 500

Add 2nd Thermo/Flat ink \$200
 Add 3rd Thermo/Flat ink \$250
 Add Digital printing \$200
 Add Digital reverse side printing . . . \$200

NOTE CARDS

BASE PRICING BY PRINT METHOD

DIGITAL

QTY	REGULAR SIZE 4bar, A2, A6		LARGE SIZE Monarch, A7, A8, Baronial		XLARGE SIZE No. 10	
	Full Color	Signature Black Ink	Full Color	Signature Black Ink	Full Color	Signature Black Ink
25	\$154	\$146	\$220	\$210	\$270	\$260
50	165	156	230	220	280	270
75	187	177	245	235	300	280
100	209	198	260	250	320	295
125	253	241	310	298	375	348
150	297	284	360	346	430	401
175	341	327	410	394	485	454
200	385	370	460	442	540	507
225	429	413	510	490	595	560
250	473	456	560	538	650	613
ADD 25	44	43	50	48	55	53

NOTE CARD ORDERING INFORMATION:

Note Cards can be ordered by themselves, and do not have to accompany an Invitation order. Note Cards would feature a Name or Monogram. If ordering any other type of card, please use Invitation or Folded Card pricing.

PRICE INCLUDES

- FLAT OR FOLDED NOTE CARD
- Digital Printing on Price Code 1 single ply papers (*excluding Letterpress Papers).
- Note Card includes unprinted Standard Envelope.

*To upgrade to Letterpress paper or Letterpress envelope with Digital printing, add \$.30 per card and \$.30 per envelope.

ADDITIONAL PRINTING

FLAT FEE FOR QUANTITIES UNDER 500

Add Digital reverse side printing to a Digitally printed front. \$150

If adding Letterpress, Thermography, Flat or Foil printing, start with pricing from those charts and then "Add Digital Printing" pricing to card.

FOIL

QTY	REGULAR SIZE 4bar, A2, A6	LARGE SIZE Monarch, A7, A8, Baronial	XLARGE SIZE No. 10
	1 Foil	1 Foil	1 Foil
25	\$488	\$648	\$673
50	500	661	689
75	525	688	722
100	550	715	755
125	600	770	821
150	650	825	887
175	700	880	953
200	750	935	1019
225	800	990	1085
250	850	1045	1151
ADD 25	50	55	66

PRICE INCLUDES

- FLAT OR FOLDED NOTE CARD
- 1 Color Foil on Price Code 1 single ply papers.
- Note Card includes unprinted Standard Envelope.

ADDITIONAL PRINTING

FLAT FEE FOR QUANTITIES UNDER 500

Add 1 Letterpress ink \$200
 Add 1 Thermo/Flat ink \$200
 Add Digital printing \$200
 Add 2nd Foil color \$450
 Add 2nd Letterpress/Thermo/Flat ink . . \$250
 Add Digital reverse side printing \$200

STATIONERY SHEET

BASE PRICING BY PRINT METHOD

LETTERPRESS

ANY SIZE			4Bar, A2, A6, A7, Monarch		No. 10		Additional Blank Sheets
Printing at Top of Sheet OR Bottom of Sheet Only			Printing at Top AND Bottom of Sheet		Printing at Top AND Bottom of Sheet		
QTY	1 Ink	Signature Black Ink	1 Ink	Signature Black Ink	1 Ink	Signature Black Ink	
25	\$333	\$307	\$357	\$328	\$384	\$353	\$17
50	342	316	368	338	397	366	34
75	361	334	390	359	424	392	51
100	380	352	412	380	451	418	68
125	419	389	456	422	506	471	85
150	458	426	500	464	561	524	102
175	497	463	544	506	616	577	119
200	536	500	588	548	671	630	136
225	575	537	632	590	726	683	153
250	614	574	676	632	781	736	170
ADD 25	39	37	44	42	55	53	17

PRICE INCLUDES

- 1 Letterpress ink color on Letterpress text weight or Matte Price Code 1 text weight papers.
- Letterhead includes unprinted Standard or Letterpress envelope *(while supplies last)*.

ADDITIONAL PRINTING FLAT FEE FOR QUANTITIES UNDER 500

Add 2nd Letterpress ink \$200
 Add 3rd Letterpress ink \$250
 Add Digital printing \$200
 Add Digital reverse side printing . . . \$200

LETTERHEAD AVAILABLE SIZES

AVAILABLE FOR ALL PRINT METHODS

4.875" x 7.0" half sheet fits a 4bar Env	5.5" x 8.5" half sheet fits an A2 Env	6.25" x 9.0" half sheet fits an A6 Env	7.0" x 10.0" half sheet fits an A7 Env	7.25" x 10.5" fits a Monarch Env	8.5" x 11" fits a #10 Env
--	---------------------------------------	--	--	----------------------------------	---------------------------

THERMOGRAPHY

ANY SIZE			4Bar, A2, A6, A7, Monarch		No. 10		Additional Blank Sheets
Printing at Top of Sheet OR Bottom of Sheet Only			Printing at Top AND Bottom of Sheet		Printing at Top AND Bottom of Sheet		
QTY	1 Ink	Signature Black Ink	1 Ink	Signature Black Ink	1 Ink	Signature Black Ink	
25	\$187	\$173	\$250	\$232	\$288	\$264	\$17
50	198	183	262	244	303	278	34
75	220	204	287	268	333	307	51
100	242	225	312	292	363	336	68
125	286	267	362	340	423	394	85
150	330	309	412	388	483	452	102
175	374	351	462	436	543	510	119
200	418	393	512	484	603	568	136
225	462	435	562	532	663	626	153
250	506	477	612	580	723	684	170
ADD 25	44	42	50	48	60	58	17

PRICE INCLUDES

- 1 Thermography ink color on text weight Price Code 1 papers (excluding Letterpress papers).
- Letterhead includes unprinted Standard Envelope.

ADDITIONAL PRINTING FLAT FEE FOR QUANTITIES UNDER 500

Add 2nd Thermo/Flat ink \$200
 Add 3rd Thermo/Flat ink \$250
 Add Digital printing \$200
 Add Digital reverse side printing . . . \$200

STATIONERY SHEET

BASE PRICING BY PRINT METHOD

DIGITAL

ANY SIZE			Additional Blank Sheets
ANY PRINT AREA			
QTY	Full Color	Signature Black Ink	
25	\$176	\$146	\$17
50	187	156	34
75	198	177	51
100	209	198	68
125	253	240	85
150	297	282	102
175	341	324	119
200	385	366	136
225	429	408	153
250	473	450	170
ADD 25	44	42	17

PRICE INCLUDES

- Digital Printing on text weight Price Code 1 papers (*excluding Letterpress papers).
- Letterhead includes unprinted Standard Envelope.

*To upgrade to Letterpress paper or Letterpress envelope (*while supplies last*) with Digital printing, add \$.30 per card and \$.30 per envelope.

ADDITIONAL PRINTING

FLAT FEE FOR QUANTITIES UNDER 500

Add Digital reverse side printing to a Digitally printed front. \$150

If adding Letterpress, Thermography, Flat or Foil printing, please start with pricing from those charts and then "Add Digital Printing" pricing to card.

FOIL

ANY SIZE		4Bar, A2, A6, A7, Monarch	No. 10	Additional Blank Sheets
Printing at Top of Sheet OR Bottom of Sheet Only		Printing at Top AND Bottom of Sheet	Printing at Top AND Bottom of Sheet	
QTY	1 Foil	1 Foil	1 Foil	
25	\$488	\$648	\$672	\$17
50	500	661	688	34
75	525	688	721	51
100	550	715	754	68
125	600	770	820	85
150	650	825	886	102
175	700	880	952	119
200	750	935	1018	136
225	800	990	1084	153
250	850	1045	1150	170
ADD 25	50	55	66	17

PRICE INCLUDES

- 1 Color Foil on text weight Price Code 1 single ply papers.
- Letterhead includes unprinted Standard Envelope.

ADDITIONAL PRINTING

FLAT FEE FOR QUANTITIES UNDER 500

Add 1 Letterpress ink \$200
 Add 1 Thermo/Flat ink \$200
 Add Digital printing \$200
 Add 2nd Foil color \$450
 Add 2nd Letterpress/Thermo/Flat ink . . \$250
 Add Digital reverse side printing \$200

BUSINESS CARDS

PRINT METHOD ON PRICE CODE 1 PAPERS

QTY	Letterpress 1 ink	Thermo 1 ink	Foil 1 color	Digital full color
100	\$335	\$275	\$495	\$198
200	345	286	506	209
300	365	302	540	220
400	385	320	572	231
500	425	365	627	275
600	465	410	682	319
700	505	455	737	363
800	545	500	792	407
900	585	545	847	451
1000	625	590	902	495
ADD 100	40	45	55	44

PRICE INCLUDES

- 1 color printing on Price Code 1 single ply papers, 1-sided printing.

Standard Card Sizes:

3.5" x 2"

2.5" x 2.5"

2.75" x 2.75"

3" x 3"

Other sizes available for additional fee

ADDITIONAL PRINTING ON SIDE ONE OR LAYERED SIDE

FLAT FEE FOR QUANTITIES UNDER 2000

Letterpress Cards:

Add 2nd Letterpress ink \$200

Thermography/Flat Cards:

Add 2nd Thermo/Flat ink \$200

Foil Cards:

Add 1 Letterpress ink \$200

Add 1 Thermography/Flat ink . . . \$200

Add 2nd Foil color \$450

Add Digital printing to any \$200

One Ply Digital Cards:

Add Digital reverse side printing . . . \$150

BUSINESS CARD LAYERING OPTIONS

Pricing includes Flush Layering Cost - 2ply total weight

QTY	Add Unprinted Layer	Add 1 color Letterpress Layer	Add 1 color Thermo Layer	Add 1 Color Foil Layer	Add Digitally Printed Layer
100	\$50	\$275	\$210	\$445	\$245
200	100	335	270	555	255
300	150	400	330	680	315
400	200	465	390	805	375
500	250	545	470	945	450
600	300	625	550	1085	525
700	350	705	630	1225	600
800	400	785	710	1365	675
900	450	865	790	1505	750
1000	500	945	870	1645	825
ADD 100	50	80	80	140	75

EDGING OPTIONS

QTY	Corner Round	1 Color Edge Paint	1 or 2 Ply Straight Foil Edge
100	\$80	\$198	\$341
200	124	242	495
300	168	286	649
400	212	330	803
500	256	374	957
600	300	418	1111
700	344	462	1265
800	388	506	1419
900	432	550	1573
1000	476	594	1727
ADD 100	44	44	154

Important Note: Foil Edging increases production time. Visit our website for current timing.

BUSINESS CARDS

BONUS! YOU CAN GROUP TOGETHER UP TO 4 PEOPLE!

The fine print...

- Artwork is the same, only contact information is different
- *Each Additional Name adds \$100*
- If the same quantity is not ordered for each person, then each quantity needed has to be divisible by 4 and equal 25/50/75 percent of the total ordered.

FOR EXAMPLE:

2 PEOPLE NEED 250 CARDS EACH (50/50 SPLIT)
ORDER 500 CARDS & ADD \$100 FOR ADDITIONAL NAME.

NAME 1 Qty 125 (250 total)	NAME 1 Qty 125 (250 total)
NAME 2 Qty 125 (250 total)	NAME 2 Qty 125 (250 total)

4 PEOPLE NEED 200 CARDS EACH (25/25/25/25 SPLIT)
ORDER 800 CARDS & ADD \$300 FOR 3 ADDITIONAL NAMES.

NAME 1 Qty 200	NAME 2 Qty 200
NAME 3 Qty 200	NAME 4 Qty 200

3 PEOPLE NEED CARDS, QUANTITIES 200, 100 & 100 (50/25/25 SPLIT)
ORDER 400 CARDS & ADD \$200 FOR 2 ADDITIONAL NAMES.

NAME 1 Qty 100 (200 total)	NAME 1 Qty 100 (200 total)
NAME 2 Qty 100	NAME 3 Qty 100

Example of what you can't combine:

3 people need cards, for total of 800 - quantities 400, 300 & 100 (50/37.5/12.5 split).

These quantities could not be combined since it is not a 25/50/75 split. An option to combine them would be to change the quantities to 400/200/200 (50/25/25).

NEED HELP FIGURING OUT THE BEST OPTION? CONTACT US!

SYMPATHY CARDS

QTY	LETTERPRESS		THERMOGRAPHY		DIGITAL		FOIL
	1 ink color	Signature Black Ink	1 ink color	Signature Black Ink	Full Color	Signature Black Ink	1 foil color
25	\$355	\$325	\$253	\$235	\$220	\$210	\$645
50	366	336	265	247	230	220	660
75	388	358	290	271	245	235	685
100	410	380	315	295	260	250	710
125	455	423	365	343	310	298	765
150	500	466	415	391	360	346	820
175	545	509	465	439	410	394	875
200	590	552	515	487	460	442	930
225	635	595	565	535	510	490	985
250	680	638	615	583	560	538	1040
ADD 25	45	43	50	48	50	48	55

PRICE INCLUDES

- 1 color printing on 1 side on Price Code 1 papers.
- Includes unprinted Standard Envelope.

CARD SIZES OFFERED:

4bar Flat or Folded
A2 Flat or Folded
A6 Flat or Folded
A7 Flat
A8 Flat

ADDITIONAL PRINTING

FLAT FEE FOR SAME SIDE OR REVERSE SIDE,
QUANTITIES UNDER 500

Letterpress Cards:

Add 2nd Letterpress ink \$200
Add 3rd Letterpress ink \$250
Add Digital printing \$200

Thermography/Flat Cards:

Add 2nd Thermography/Flat ink . . . \$200
Add 3rd Thermography/Flat ink . . . \$250
Add Digital printing \$200

Digital Cards:

Add Digital reverse side printing . . . \$150

Foil Cards:

Add 1 Letterpress ink \$200
Add 1 Thermography/Flat ink \$200
Add 2nd Foil color \$450
Add Digital printing \$200

SIGNATURE BLACK INK

Additional Printing Options
do not apply. Pricing is for
Black Ink ONLY.

OPTIONS

Layers, Papers,
and Embellishments

ADD A LAYER

MAKE YOUR CARD THICKER BY ADDING FLUSH OR REVEAL LAYERS

- 1. Layers can be Unprinted or Printed
- 2. Layers can be Flush or Reveal (same price!)
- 3. Choose how many Layers you would like to add

UNPRINTED LAYER

ANY SIZE CARD!

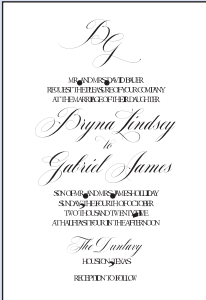

FLUSH LAYER

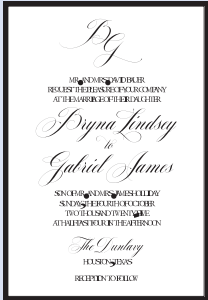

REVEAL LAYER

MIDDLE OR BOTTOM LAYER

COST INCLUDES PAPER AND MOUNTING

PAPER PRICE CODE	MIDDLE OR BOTTOM LAYER
Price Code 1	+ \$2.20/CARD
Price Code 2	+ \$2.50/CARD
Price Code 3	+ \$3.60/CARD
Price Code 4	+ \$4.40/CARD
WOOD CLASSIC SIZE	QTY 25 = \$300 QTY 50+ = \$9/CARD
WOOD GRAND SIZE	QTY 25 = \$420 QTY 50+ = \$11/CARD
WOOD REGAL SIZE	QTY 25 = \$480 QTY 50+ = \$12/CARD

ADD PRINTED LAYER												
MIDDLE OR BOTTOM LAYER												
COST INCLUDES PRINTING AND MOUNTING ON PRICE CODE 1 PAPERS												
QTY	DIGITAL LAYER FULL COLOR			LETTERPRESS LAYER 1 INK COLOR			THERMOGRAPHY/FLAT 1 INK COLOR			FOIL STAMPED LAYER 1 FOIL COLOR		
	SIZE CLASSIC	SIZE GRAND	SIZE REGAL	SIZE CLASSIC	SIZE GRAND	SIZE REGAL	SIZE CLASSIC	SIZE GRAND	SIZE REGAL	SIZE CLASSIC	SIZE GRAND	SIZE REGAL
25	\$330	\$380	\$425	\$429	\$464	\$510	\$340	\$380	\$420	\$590	\$719	\$791
50	340	390	435	439	474	530	350	390	430	600	749	871
75	385	440	490	487	517	595	400	440	489	653	807	953
100	430	490	545	535	580	660	445	490	550	705	865	1035
125	520	590	655	630	685	790	540	595	672	810	981	1200
150	610	690	765	725	790	920	635	700	794	915	1097	1365
175	700	790	875	820	895	1050	730	805	916	1020	1213	1530
200	790	890	985	915	1000	1180	825	910	1038	1125	1329	1695
225	880	990	1095	1010	1105	1310	920	1015	1160	1230	1445	1860
250	970	1090	1205	1105	1210	1440	1015	1120	1282	1335	1561	2025
ADD 25	90	100	110	95	105	130	95	105	122	105	116	165

PRINTING A LAYER ON UPGRADED STOCKS	
ADD TO PRINTING AND MOUNTING COST ABOVE	
Price Code 2	+ \$1.10/CARD
Price Code 3	+ \$1.60/CARD
Price Code 4	+ \$2.80/CARD
WOOD CLASSIC SIZE	QTY 25 = \$240 QTY 50+ = \$7/CARD
WOOD GRAND SIZE	QTY 25 = \$360 QTY 50+ = \$8/CARD
WOOD REGAL SIZE	QTY 25 = \$430 QTY 50+ = \$10/CARD

Thinking of an all over pattern
or something custom?

Make sure to check with our team to make
sure it is doable in your chosen print process
and that you have the correct pricing!

PRICE CODE 2, 3, 4 PAPERS & WOOD

The Invitation and Companion Card base pricing charts by print method include printing on our Price Code 1 Papers.

An adder applies when printing on a Price Code 2, 3, 4 Paper or Wood.

Reference our Paper Swatch Decks for available print options.

PRINTING ON UPGRADED PAPERS	
TOP LAYER	
ADD TO INVITATION OR COMPANION CARD PRICING	
PAPER PRICE CODE	
Price Code 1	INCLUDED IN COST OF PRINTING
Price Code 2	+ \$1.10/CARD
Price Code 3	+ \$1.60/CARD
Price Code 4	+ \$2.80/CARD
WOOD CLASSIC SIZE	QTY 25 = \$240 QTY 50+ = \$7/CARD
WOOD GRAND SIZE	QTY 25 = \$360 QTY 50+ = \$8/CARD
WOOD REGAL SIZE	QTY 25 = \$430 QTY 50+ = \$10/CARD



SHAPES

DIE CUTS, CORNER ROUNDING & HOLE DRILL

- See the Creative Library or website for Die Cut Shapes.
- Die Cut Shapes cannot be used in combination with Straight Edge Paint or Foil Edge Embellishments. See the website for shapes available with Luxury Bevel Painted Edge.
- Die Cut Shapes and Corner Rounding are options for PC1,PC2 Papers and Suede only.

QTY	DIE CUTTING	CORNER ROUNDING or HOLE DRILLING
25	\$242	\$51
50	242	63
75	248	75
100	256	87
125	281	99
150	306	111
175	331	123
200	356	135
225	381	147
250	406	159
ADD 25	25	12

DIGITAL SHAPES

- A Digital Shape is created using a vector image in place of a steel rule die. See our Library of in-house Digital Die Shapes or we can help you create a custom shape!
- Digital Printing Only (1 or 2 sided)
- Single Ply, PC1 Cardstock only

QTY	3x3.5 or smaller	4bar	A2	A6, A7
25	\$342	\$342	\$342	\$342
50	342	342	342	342
75	348	348	348	348
100	356	356	356	414
125	381	381	411	497
150	406	424	466	580
175	431	467	521	663
200	456	510	576	746
225	481	553	631	829
250	506	596	686	n/a
ADD 25	25	43	55	n/a

EDGE TREATMENTS

PAINTED, FOIL AND BEVEL EDGES

EDGE PAINT & PAINTED BEVEL EDGE

QTY	1 Paint Color EDGE PAINT		2 Paint Colors GRADIENT or ADJACENT SIDES				BEVEL EDGE 1 Paint Color or Inkless	
	FIRST CARD IN ORDER	ADD'TL CARD (SAME COLOR)	FIRST CARD IN ORDER	ADD'TL CARD (SAME COLORS)	FIRST CARD IN ORDER	ADD'TL CARD (SAME COLORS)	Standard 65 degree edge	Luxury 45 degree edge
25	\$176	\$110	\$264	\$165	\$352	\$220	\$341	\$671
50	176	110	264	165	352	220	341	671
75	187	121	280	181	374	242	341	671
100	198	132	297	198	396	264	341	671
125	209	143	314	215	418	286	391	765
150	220	154	331	232	440	308	441	859
175	231	165	348	249	462	330	491	953
200	242	176	365	266	484	352	541	1047
225	253	187	382	283	506	374	591	1141
250	264	198	399	300	528	396	641	1235
ADD 25	11	11	17	17	22	22	50	94

See our online Resources for the Edge Paint details.

Add \$100 to order a custom Pantone Solid Uncoated Edge Paint Color

SHAPED CARDS WITH A LUXURY BEVEL PAINTED EDGE

In-house Shapes and Custom Shapes are available. For pricing, add the Die Cutting fee shown on previous page to the Luxury Bevel Painted Edge pricing.

See our online Resources for more details on this decadent option!

Important Note: Bevel Edging increases production time. Visit our website for current timing.

FOIL EDGE & FOIL BEVEL EDGE

QTY	STRAIGHT FOIL EDGE			STANDARD BEVEL FOIL EDGE (65 DEGREE EDGE)			LUXURY BEVEL FOIL EDGE (45 DEGREE EDGE)		
	2 PLY	3 PLY	4 PLY	2 PLY	3 PLY	4 PLY	2 PLY	3 PLY	4 PLY
25	\$341	\$341	\$341	\$341	\$341	\$341	671	\$671	\$671
50	341	341	341	341	341	341	671	671	671
75	341	341	374	341	385	396	671	770	803
100	341	341	418	341	440	473	671	880	946
125	380	391	490	391	512	556	765	1012	1100
150	419	441	562	441	584	639	859	1144	1254
175	458	491	634	491	656	722	953	1276	1408
200	497	541	706	541	728	805	1047	1408	1562
225	536	591	778	591	800	888	1141	1540	1716
250	575	641	850	641	872	971	1235	1672	1870
ADD 25	39	50	72	50	72	83	94	132	154

See the Foil Swatch Deck for Foil color options

Important Note: Foil and Bevel Edging increases production time. Visit our website for current timing.

EDGE TREATMENTS

HAND TORN EDGES

Hand tearing is available for any 1 ply Classic or Grand Size card using a Matte Price Code 1 paper.
Adds \$3.00 per card

- Pro tips:
- While we can hand tear any of our Matte Price Code 1 papers, the loose fibers of Letterpress papers make them a great option.
 - Use as a Reveal Bottom Layer or add a Reveal Bottom Layer for a thicker finished card.

POCKETS AND PORTFOLIOS

QTY	UNPRINTED	FULL COLOR DIGITAL	LETTERPRESS (LP) & THERMOGRAPHY (TH)		FOIL
	ALL STYLES	ALL STYLES	1 ink color 1 panel		1 color foil 1 panel
			LP AND TH PRICE CODE 1 STYLES	TH ONLY PRICE CODE 2 STYLES	ALL STYLES
25	\$220	\$303	\$506	\$748	\$770
50	264	364	522	764	788
75	396	546	682	924	961
100	528	728	836	1077	1126
125	660	910	1018	1259	1319
150	792	1092	1200	1441	1512
175	924	1274	1382	1623	1705
200	1056	1456	1564	1805	1898
225	1188	1638	1746	1987	2091
250	1320	1820	1928	2169	2284
ADD 25	132	182	182	182	193

PRICE INCLUDES

Unprinted and Printed items on Price Code 1 Papers (excluding Letterpress papers)

POCKET, SLEEVE AND PORTFOLIO EXAMPLES

See our online Resources for our full offering of Pocket, Portfolio, Pouches and Sleeve Styles

Pockets and Sleeves

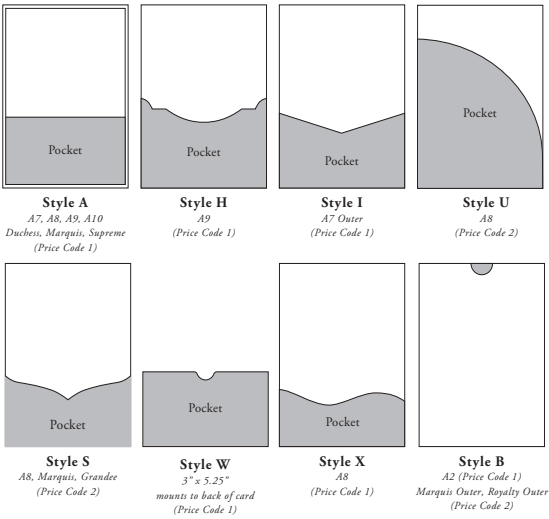

Portfolios

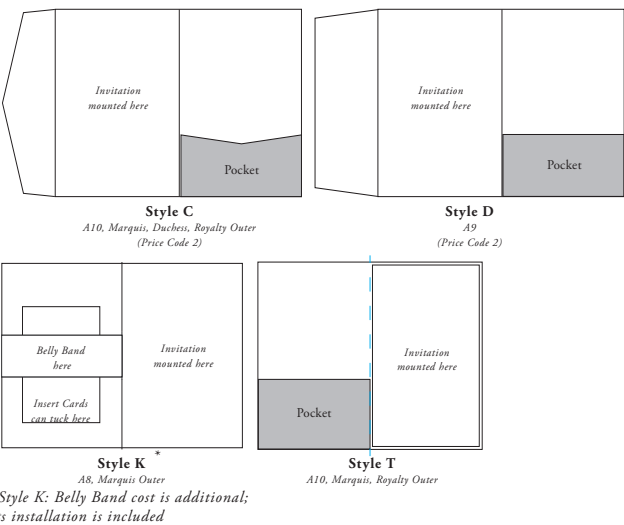

BELLY BANDS

ON PRICE CODE 1 PAPERS

UNPRINTED BELLY BANDS

SHIPPED FLAT - NO SCORING						
QTY	COVER WEIGHT Scored Price Code 1	TEXT WEIGHT Price Code 1	VELLUM Price Code 2	IMPORTED PAPERS Price Code 2	MOIRE Price Code 3	SUEDE Price Code 4
25	\$130	\$50	\$65	\$65	\$75	\$85
50	150	63	88	88	113	125
75	170	94	131	131	169	188
100	220	125	175	175	225	250
125	275	156	219	219	281	313
150	330	188	263	263	338	375
175	385	219	306	306	394	438
200	440	250	350	350	450	500
225	495	281	394	394	506	563
250	550	313	438	438	563	625
ADD 25	55	55	44	44	56	63

BELLY BAND SIZING

Belly Band Maximum Length:

- Unprinted max length is 18"
- Digital max length is 18"
- Letterpress, Thermo and Foil Belly Bands can print on front panel only and max length is 13.25", or max card width of 6.25"

Belly Band Width:

- Belly Band width can be from 1" up to 2.25" wide

PRINTED BELLY BANDS

PRINTING LIMITED TO FRONT PANEL					
QTY	DIGITAL On Price Code 1	DIGITAL ON VELLUM SHIPS FLAT	THERMO 1 COLOR On Price Code 1	LETTERPRESS 1 COLOR On Price Code 1	FOIL 1 COLOR On Price Code 1
25	\$285	\$225	\$330	\$330	\$470
50	285	225	340	340	480
75	335	255	360	360	510
100	385	285	385	385	540
125	435	335	435	435	600
150	485	390	485	485	660
175	535	445	535	535	720
200	585	500	585	585	780
225	635	555	635	635	840
250	685	610	685	685	900
ADD 25	50	55	50	50	60

SPECIALTY PAPERS

- Vellum is available with Digital Printing
- Moire is available with Foil Printing (adds \$1.60 per band)
- Suede is available with Letterpress or Foil printing (adds \$2.80 per band)

Cover Weight Belly Bands will be scored. Belly Bands made with Text Weight papers are unable to be scored.
All Belly Bands ship flat and unassembled (no tape)

Please note: Pricing assumes Belly Band is ordered with Invitation Suite. Extra fees apply if ordered as a stand alone item.

RIBBONS

	Price Code	Price Code	Price Code
QTY	1	2	3
25	\$127	\$152	\$191
50	140	168	204
75	210	252	306
100	280	336	408
125	350	420	510
150	420	504	612
175	490	588	714
200	560	672	816
225	630	756	918
250	700	840	1020
ADD 25	70	84	102

RIBBON OPTIONS

- Ribbon Colors can be found in the Creative Library.
- A larger reference of Ribbon Ties and Price Codes can also be found in our Resources online

Lallie

- Ribbon Tie Styles and Multiple Ribbon Pricing for Lallie Designs can be found on page 51.

TIE STYLES Price Code 1

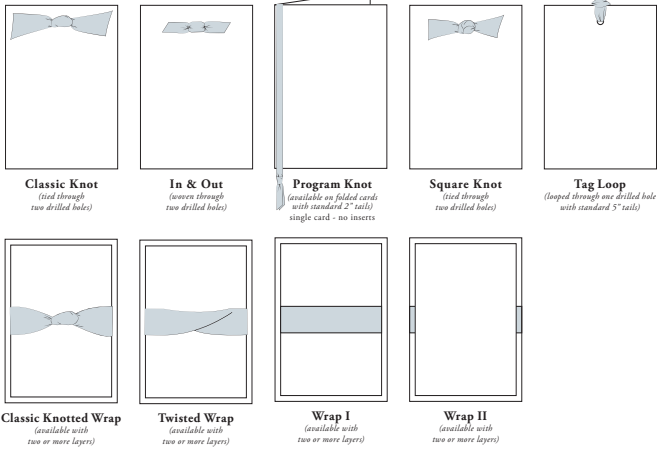

TIE STYLES Price Code 2

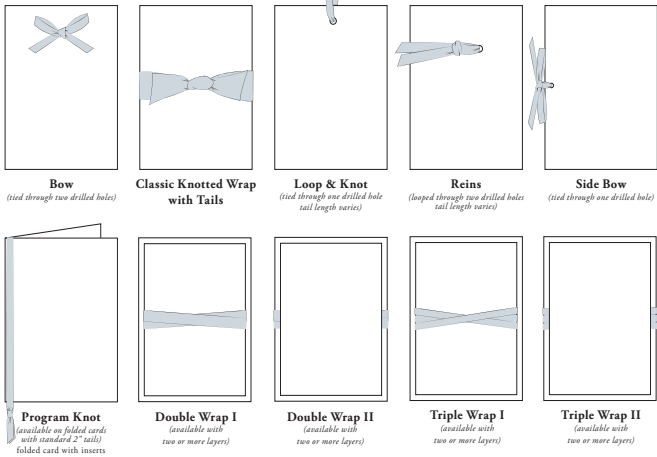

Price Code 3

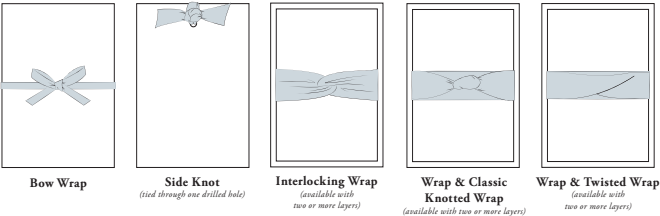

AN IMPORTANT NOTE ABOUT RIBBON AVAILABILITY:

Every effort is made to keep our available ribbons list up to date. However, ribbon manufacturers are constantly changing their product offerings and substitutions may occasionally be necessary. You will be notified if this issue affects your order.

EMBOSSSED FRAMES & ART

See our Embossing Library online for our in-house embossing options and their available sizes.

QTY	STANDARD PRE-CONV.	SEMI- CUSTOM	FULL CUSTOM
25	\$83	\$225	Please contact us for a Quote
50	83	233	
75	99	249	
100	116	266	
125	133	283	
150	150	300	
175	167	317	
200	184	334	
225	201	351	
250	218	368	
ADD 25	17	17	

FOIL EMBOSSSED FRAME
Duchess Size EMB234 available as a Foil Embossed Frame -
Pick your Foil Color!
ADD \$100 to the Semi-Custom Embossed Pricing.

STANDARD - PRE-CONVERTED

Embossed Frame options are pre-converted in certain sizes and available on the following papers:

White 130# Cover • Letterpress White
Pearl 130# Cover • Letterpress Pearl
Cream 100# Cover

Pre-converted options cannot be combined with Digital Printing

SEMI-CUSTOM

- Choose any Embossed Frame or Art from our Embossing Library and print on your choice of Price Code 1 papers.
- Can be combined with Digital Printing!

FULL CUSTOM ART

- Custom Monogram, Name, or Artwork not shown in Embossing Library requires a custom plate and must be quoted.

PHOTOS, ASSEMBLY & EXTRAS

PHOTO PROCESSING - \$3.50

Photos can be ordered and mounted to any card for a charge of \$3.50 per photo. Photo size is 4x6 or 4x4 or smaller.

Please note that adding Photo Processing may increase turnaround time.

PHOTO TAPE ONLY - \$.80

Adding double sided photo tape to any card for client to install own photo is \$.80 per photo.

MOUNT SUPPLIED PHOTO - \$2.20

Sending us your photo to mount to card is \$2.20 per photo.

TISSUE - \$20

Add Tissue to your Invitation order for \$20 (per card). Tissue is cut to Card Size and is available in White only.

EASY STICK ENVELOPE TAPE - \$.30

Add easy release tape to your Square Flap envelope for an additional \$.30 per envelope. Minimum \$20 Retail.

MOUNT TAG - \$2.20

Mounting a tag to a portfolio or card is \$2.20 per tag.

BRAD ASSEMBLY - \$3

Attaching a Brad, up to 3 layers, is \$3 per Brad. The price includes hole drilling and assembly. Brads are available in Silver, Gold, Copper and Antique Copper.

GROMMET ASSEMBLY - \$3

Attaching a Grommet, up to 3 layers, is \$3 per Grommet. The price includes hole drilling and assembly. Grommets are available in 3/16" Brass, Silver, Copper and Black.

CRYSTALS - \$2.20

Swarovski® crystals can be added to any item for an additional charge of \$2.20 each. Available in 4mm size in Clear, Iridescent and Red.

LANYARD - \$2.20

Lanyards are available in black and include hole drilling for \$2.20 each. Lanyards arrive unassembled.

DAY-OF

Programs, Menus,
Table Cards and
Place Cards

FLAT PROGRAMS

Day-Of Event Items

LETTERPRESS

1 Letterpress Ink on Price Code 1, Single Ply Papers

FLAT PROGRAM			
QTY	CLASSIC	GRAND	REGAL
25	\$440	\$467	\$567
50	451	480	594
75	473	507	649
100	495	534	704
125	539	589	814
150	583	644	924
175	627	699	1034
200	671	754	1144
225	715	809	1254
250	759	864	1364
ADD 25	44	55	110

ADDITIONAL PRINTING

2nd Letterpress ink \$200
 3rd Letterpress ink \$250
 Add Digital printing \$200
 Add Digital reverse side printing. \$200

THERMOGRAPHY

1 Thermography Ink on Price Code 1, Single Ply Papers

FLAT PROGRAM			
QTY	CLASSIC	GRAND	REGAL
25	\$323	\$360	\$473
50	335	375	500
75	360	405	555
100	385	435	610
125	435	495	720
150	485	555	830
175	535	615	940
200	585	675	1050
225	635	735	1160
250	685	795	1270
ADD 25	50	60	110

ADDITIONAL PRINTING

2nd Thermo/Flat ink \$200
 3rd Thermo/Flat ink \$250
 Add Digital printing \$200
 Add Digital reverse side printing. \$200



DIGITAL

Full Color Digital on Price Code 1*, Single Ply Papers

FLAT PROGRAM			
QTY	CLASSIC	GRAND	REGAL
25	\$294	\$349	\$483
50	306	361	507
75	318	373	531
100	330	385	555
125	380	435	654
150	430	485	753
175	480	535	852
200	530	585	951
225	580	635	1050
250	630	685	1149
ADD 25	50	50	99

ADDITIONAL PRINTING

Add Digital reverse side printing to a
 Digitally printed front \$150

**To upgrade to Letterpress paper with a
 Digitally printed card, Add \$.30 per card*

FOIL

1 Foil Color on Price Code 1, Single Ply Papers

FLAT PROGRAM			
QTY	CLASSIC	GRAND	REGAL
25	\$719	\$743	\$840
50	732	759	870
75	759	792	930
100	786	825	990
125	841	891	1111
150	896	957	1232
175	951	1023	1353
200	1006	1089	1474
225	1061	1155	1595
250	1116	1221	1716
ADD 25	55	66	121

ADDITIONAL PRINTING

1 Letterpress ink \$200
 1 Thermo/Flat ink \$200
 Add Digital printing \$200
 Add 2nd Foil color \$450
 Add 2nd Letterpress/Thermo/Flat ink . . . \$250
 Add Digital reverse side printing \$200

FOLDED PROGRAMS

Day-Of Event Items

FOLDED PROGRAM

Available Sizes (when folded):

5" x 7" | 5.25" x 7.75" | 5.25" x 5.25" | 3.625" x 7.75" | 4.0" x 9.25" | 5.5" x 8.5" | 5.25" x 5.25"



Cover only

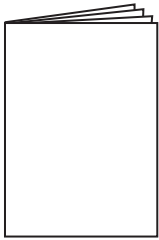

Insert page

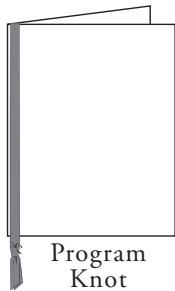

Program
Knot

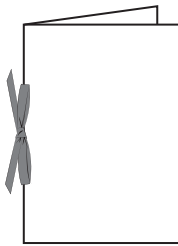

Program
Bow

1 Ink, Foil Color, or Full Color Digital printed on Price Code 1, Single Ply Papers

FOLDED PROGRAM					
QTY	Letterpress	Thermography	Digital		Foil
	1 Sided Printing	1 Sided Printing	1 Sided	2 Sided	Cover Only
25	\$582	\$517	\$572	\$722	\$840
50	607	528	594	744	870
75	658	572	616	766	930
100	709	621	638	788	990
125	811	723	726	876	1111
150	913	825	814	964	1232
175	1015	927	902	1052	1353
200	1117	1029	990	1140	1474
225	1219	1131	1078	1228	1595
250	1321	1233	1166	1316	1716
ADD 25	102	102	88	88	121

See previous page for Additional Printing costs for Print Method, if more than 1 ink desired.

PROGRAM RIBBONS

DIGITALLY PRINTED	
QTY	2 Sided Insert Page
25	\$367
50	378
75	389
100	400
125	444
150	488
175	532
200	576
225	620
250	664
ADD 25	44

- Digital Insert Page(s) ships Flat, unless ordered with a Program Ribbon.
- Folded Programs with Insert Pages and Program Ribbons are shipped fully assembled.
- Need holes drilled only? See page 35 for pricing.

QTY	Program Knot	Program Bow
	1 Ribbon	1 Ribbon
25	\$180	\$218
50	220	258
75	330	387
100	440	516
125	550	645
150	660	774
175	770	903
200	880	1032
225	990	1161
250	1100	1290
ADD 25	110	129

PREFER OTHER PROGRAM SHAPES AND SIZES?

There are many program styles beyond the options featured here that we can work with you to create including different sizes, fold styles and shapes. Let us know your client's vision and we can help provide printing, pricing and turn-around options.

MENUS

Day-Of Event Items

QTY	LETTERPRESS			THERMOGRAPHY			FOIL		
	1 INK COLOR			1 INK COLOR			1 FOIL COLOR		
	SIZE CLASSIC	SIZE GRAND	SIZE REGAL	SIZE CLASSIC	SIZE GRAND	SIZE REGAL	SIZE CLASSIC	SIZE GRAND	SIZE REGAL
25	\$355	\$383	\$478	\$253	\$290	\$408	645	\$673	\$768
50	366	396	505	265	305	435	660	689	798
75	388	423	560	290	335	490	685	722	859
100	410	450	615	315	365	545	710	755	918
125	455	505	725	365	425	655	765	821	1039
150	500	560	835	415	485	765	820	887	1160
175	545	615	945	465	545	875	875	953	1281
200	590	670	1055	515	605	985	930	1019	1402
225	635	725	1165	565	665	1095	985	1085	1523
250	680	780	1275	615	725	1205	1040	1151	1644
ADD 25	45	55	110	50	60	110	55	66	121

PRICING INCLUDES

- 1 color printing on Price Code 1 single ply papers, 1-sided printing

ADDITIONAL PRINTING

Letterpress Menu: Add 2nd Letterpress ink..... \$200
Thermography/Flat Menu: Add 2nd Thermo/Flat Ink.. \$200
Foil Menu: Add 1 Letterpress ink..... \$200
Add 1 Thermo/Flat Ink \$200
Add 2nd Foil color \$450
Add Digital printing to any \$200
Add Digital reverse side printing to any \$200

DIGITAL PRINTING

INCLUDES VARIABLE PRINTING OPTIONS

PRICING INCLUDES

- Printing on Price Code 1 single ply papers (excluding Letterpress papers*)

- 1 sided printing

*To upgrade to Letterpress paper with Digital printing, add \$.30 per card

ADDITIONAL PRINTING

Add Digital reverse side printing to a Digitally Printed Front \$150

QTY	DIGITAL					
	FULL COLOR					
	CLASSIC		GRAND		REGAL	
	1 SIDED	WITH GUEST NAME	1 SIDED	WITH GUEST NAME	1 SIDED	WITH GUEST NAME
25	\$220	\$275	\$270	\$325	\$390	\$445
50	230	300	280	350	410	480
75	245	350	300	405	450	555
100	260	400	320	460	490	630
125	310	485	375	550	590	765
150	360	570	430	640	690	900
175	410	655	485	730	790	1035
200	460	740	540	820	890	1170
225	510	825	595	910	990	1305
250	560	910	650	1000	1090	1440
ADD 25	50	85	55	90	100	135

PLACE CARDS

Day-Of Event Items

PRICE INCLUDES

- Printing on Price Code 1 single ply papers (excluding Letterpress paper for Digital, Thermography & Flat Printing)

DETAILS

Place Card Sizes STANDARD SIZE

Flat or Folded

2" x 3.5"

2" x 4"

2.5" x 4.5"

fits enclosure envelope

2.5" x 3.43"

Flat Only and Digital Printing Only

3" x 4"

fits enclosure envelope

3.5" x 4.875"

ADDITIONAL PRINTING for Digitally Printed Place Cards

2nd side Digital Printing

Non Variable . . . \$150 Flat Fee

Variable . . . cost of 1st side x 2

Need an Unprinted Place Card?

\$1.50 Each

(minimum qty 100 for unprinted)

DIGITAL PRINTING SINGLE PLY - 1 SIDED PRINTING

STANDARD SIZE		
QTY	DIGITAL DESIGN ONLY	DIGITAL WITH GUEST NAME
25	\$154	\$237
50	165	248
75	176	292
100	187	336
125	220	402
150	253	468
175	286	534
200	319	600
225	352	666
250	385	732
ADD 25	33	66

LETTERPRESS, THERMOGRAPHY AND FOIL PRINTING (DESIGN ONLY, NO GUEST NAME OPTION)

STANDARD SIZE			
QTY	LETTERPRESS DESIGN ONLY	THERMO DESIGN ONLY	FOIL DESIGN ONLY
25	\$253	\$176	\$413
50	264	187	424
75	281	198	446
100	297	209	479
125	336	248	529
150	375	287	579
175	414	326	629
200	453	365	679
225	492	404	729
250	531	443	779
ADD 25	39	39	50

SHAPED PLACE CARDS

Does your client have Day-Of vision that includes shaped Place Cards? We offer both die cut and digital shapes.

See our library of options online in our Resources.

Pricing details can be found on page 35.

Find Placecard Envelope Options on the next page →

PLACE CARD ENVELOPES AND TABLE CARDS

Day-Of Event Items

PLACE CARD ENVELOPES WITH DIGITAL PRINTING

PLACE CARD ENVELOPES

Envelope Pricing assumes
it is being printed with a
Printed Place Card order.

Add \$100 if Envelope
accompanies an
Unprinted Place Card
or if Envelope Only order

See our 4bar Colored Envelope
Options in Resources online!

STANDARD ENVELOPES			COLORED ENVELOPES	
Enclosure & 4Bar White, Pearl & Cream			4Bar Envelopes	
QTY	BLANK & UNPRINTED	DIGITAL WITH GUEST NAME	BLANK & UNPRINTED	DIGITAL WITH GUEST NAME
25	\$20	\$70	\$38	\$73
50	40	110	75	145
75	60	165	113	218
100	80	220	150	290
125	100	275	188	363
150	120	330	225	435
175	140	385	263	508
200	160	440	300	580
225	180	495	338	653
250	200	550	375	725
ADD 25	20	55	38	73

Enclosure Envelope Flap Shape

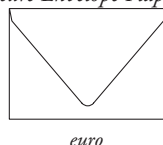

euro

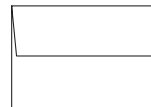

square

4bar Envelope Flap Shapes

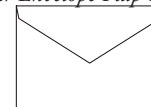

pointed

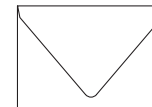

euro

ADD A LINER! Liners are an available option for Enclosure and 4bar envelopes!

TABLE CARDS

DIGITAL PRINTING ONLY

PRICE INCLUDES

- Printing on Price Code
1 single ply papers
(excluding Letterpress papers)

CLASSIC SIZE				GRAND SIZE	
QTY	1 SIDED WITH NUMBERS	1 SIDED DESIGN ONLY	TENTED WITH NUMBERS	1 SIDED WITH NUMBERS	1 SIDED DESIGN ONLY
25	\$187	\$154	\$292	\$231	\$198
50	237	165	352	280	215

DETAILS

Table Card Sizes:
5" x 7" - Classic Size
available 1 Sided or Tented

5.5" x 8.5" - Grand Size
available 1 sided only

Order a Tented Table Card if
2 sided printing is needed

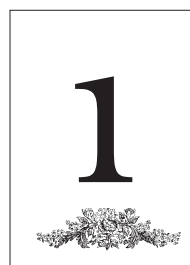

1 Sided
with numbers

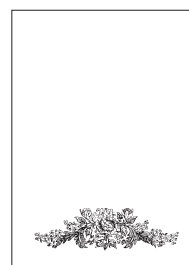

1 Sided
design only



2 Sided (Tented)
with numbers

SPECIALTY
CARDS
&
Lallie

FOLDED & SPECIALTY FOLDS

FOLDED CARD STYLES

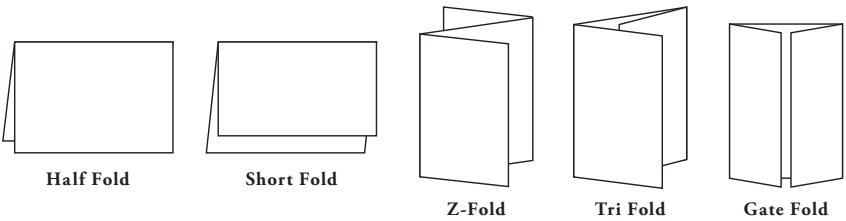

Other “design specific” fold styles are show and priced in our Collections.

Custom fold styles are available, contact us for feasibility and pricing

CARD SIZE CATEGORY

F1 - F4

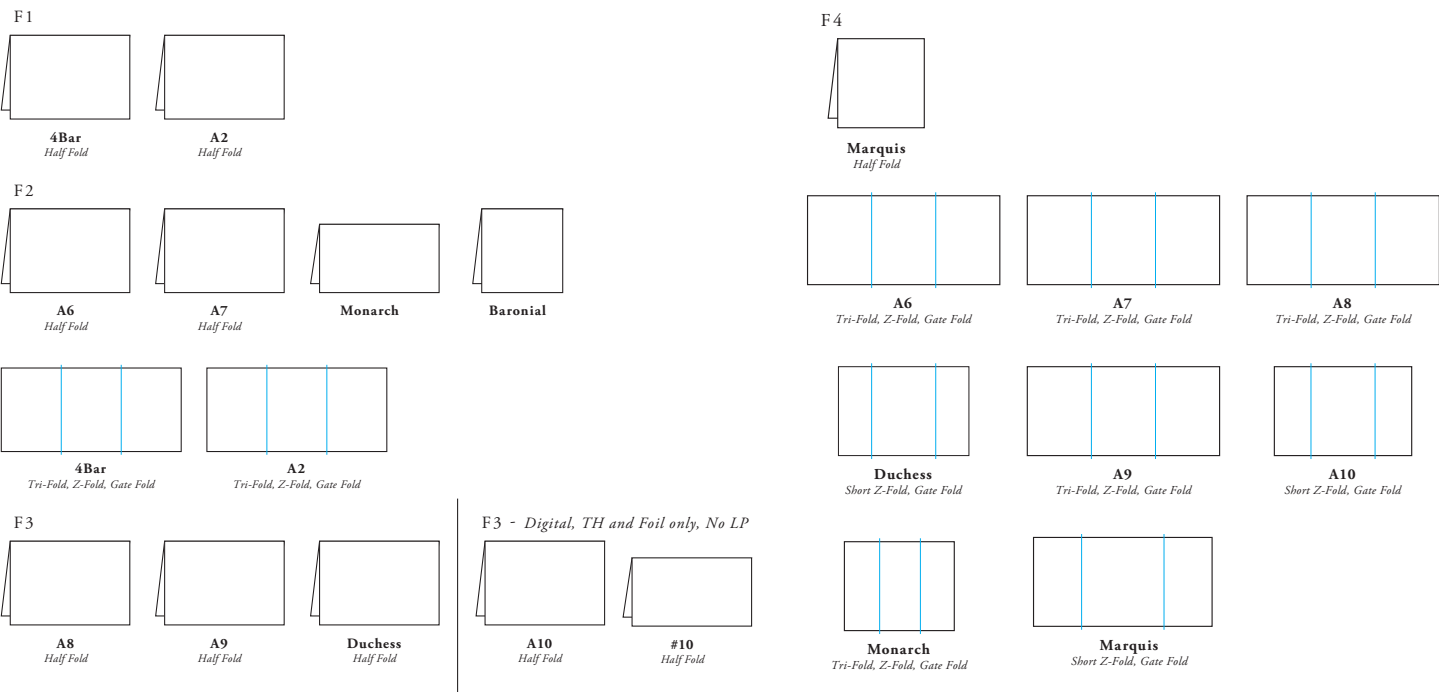

SPECIAL PRESS HANDLING

* F3 & F4 Sizes may require special press handling given their size and amount of artwork and ink coverage.
Contact us for feasibility and pricing (adder starts at \$100 retail).
Lallie Designs - see page 50 for important information

FOLDED & SPECIALTY FOLDS

DIGITAL full color 1 sided printing						
QTY	F1	F2	F3	F4	Vellum Gate Fold <i>Ships Flat</i>	Vellum Gate Fold <i>Hand Folded</i>
25	\$316	\$354	\$481	\$520	\$275	\$350
50	338	376	503	542	314	464
75	371	420	569	586	363	588
100	398	454	630	684	413	713
125	459	515	740	794	496	871
150	520	576	850	904	579	1029
175	581	637	960	1014	662	1187
200	642	698	1070	1124	745	1345
225	703	759	1180	1234	828	1503
250	764	820	1290	1344	911	1661
ADD 25	61	61	110	110	83	158

UNPRINTED Vellum Gate Fold		
QTY	SHIPS FLAT	HAND FOLDED
25	\$63	\$113
50	125	225
75	188	338
100	250	450
125	313	563
150	375	675
175	438	788
200	500	900
225	563	1013
250	625	1125
ADD 25	63	112

LETTERPRESS 1 ink color 1 sided printing			
QTY	F1	F2	F3*
25	\$448	\$470	\$564
50	470	492	586
75	509	537	662
100	542	575	740
125	608	652	872
150	674	729	1004
175	740	806	1136
200	806	883	1268
225	872	960	1400
250	938	1037	1532
ADD 25	66	77	132

THERMOGRAPHY 1 ink color 1 sided printing				
QTY	F1	F2	F3*	F4*
25	\$344	\$371	\$503	\$525
50	366	393	525	548
75	404	437	591	619
100	443	481	657	690
125	515	564	789	833
150	587	647	921	976
175	659	730	1053	1119
200	731	813	1185	1262
225	803	896	1317	1405
250	875	979	1449	1548
ADD 25	72	83	132	143

FOIL 1 color 1 sided printing				
QTY	F1	F2	F3*	F4*
25	\$712	\$734	\$838	\$1,102
50	734	756	860	1124
75	784	811	948	1218
100	828	860	1036	1466
125	905	948	1179	1620
150	982	1036	1322	1774
175	1059	1124	1465	1928
200	1136	1212	1608	2082
225	1213	1300	1751	2236
250	1290	1388	1894	2390
ADD 25	77	88	143	154

PRICE INCLUDES

- 1 color printing on 1 side on Price Code 1, Single Ply Paper
- Includes Standard envelope
- **To upgrade to Letterpress paper or Letterpress Envelope with all Digital printing, add \$.30 per card and \$.30 per envelope*

ADDITIONAL PRINTING FLAT FEE FOR SAME SIDE OR REVERSE SIDE, QUANTITIES UNDER 500

FOR F1, F2 & F3
[contact us for additional printing on F4](#)

Letterpress Cards:
Add 2nd Letterpress ink \$200
Add 3rd Letterpress ink \$250
Add Digital printing \$200

Thermography/Flat Cards:
Add 2nd Thermography/Flat ink . . . \$200
Add 3rd Thermography/Flat ink . . . \$250
Add Digital printing \$200

Foil Cards:
Add 1 Letterpress ink \$200
Add 1 Thermography/Flat ink \$200
Add 2nd Foil color \$450
Add Digital printing \$200

For F1, F2, F3 & F4

Digital Cards:
Add Digital reverseside printing . . . \$150

OPTIONS FOR 2ND SIDE PRINTING

Letterpress front panel:
Inside panel can be Letterpress, Foil¹ or Digital printing

Thermography/Flat front panel:
inside panel can be Flat, Foil¹ or Digital printing

¹ Use Foil Pricing and add Letterpress or Thermography/Flat

Foil front panel:
inside panel can be Letterpress, Thermography, Flat, Foil or Digital

Digital front panel:
inside panel can be Letterpress², Thermography², Flat², Foil² or Digital

² Use LP, TH or Foil Pricing and add Digital

Lallie

The Lallie name is synonymous with joyful designs, bright color combinations, fun layers and many ribbons. We are thrilled to be able to offer these designs to all of our Stationery Works customers!

What makes Lallie unique from Designers' Fine Press and Checkerboard?

Lallie designs like to be bold and fantastic - showcasing bright colors and large areas of Thermography printing. Its distinct style often requires custom ink mixes and special press handling - so certain press fees may apply. Given the unique nature of Lallie designs, feel free to contact us for a quote.

SPECIAL PRESS FEES

Custom Ink Mix: \$120 adder

Large Area Coverage Printing: \$120 adder

CUSTOM INK MIX (+\$120)

In our world, when you print blue ink on white paper you get blue ink. Printing on white stock is the most straight forward!

Lallie's color rich designs often pair vibrant inks and bright papers. Take the blue ink and print it on yellow paper. Left alone, the end result is a greenish ink color. A new ink needs to be custom mixed in order to achieve blue ink on yellow paper.

Blue

Blue ink on white

Blue

Blue ink on yellow

Blue

Custom ink mix on yellow

LARGE AREAS OF THERMOGRAPHY (+\$120)

Lallie likes to speak its message large and in charge. It is known for bold graphics, chunky fonts, and large printed areas. Thermography works well for typical larger areas, but "Lallie level" requires special press handling to look extra fabulous.



Large Area Coverage Examples



DESIGNS WITH BOTH CUSTOM INK MIXES & LARGE AREAS OF THERMOGRAPHY (+\$240)



Emerald Custom Ink Mix & Large Area Coverage



Carmine Custom Ink Mix & Large Area Coverage

Lallie

Lallie Designs also often feature unique Multi-Ribbon and Specialty Ribbon Ties



LALLIE RIBBON TIES

(some ribbon ties are only shown in Lallie albums)

PRICE CODE 1:

Tag Loop
In & Out
Square Knot

PRICE CODE 2:

Any Bundle
Attaching a Tag
Bow
Loop & Knot

PRICE CODE 3:

Side Knot
Wrap & Bow
Wrap Knot

PRICE CODE 4:

Weave
Garland
Pom Pom

QTY	Price Code	Each	Price Code	Each	Price Code	Each	Price Code	Each
	1	Additional Ribbon	2	Additional Ribbon	3	Additional Ribbon	4	Additional Ribbon
25	\$127	\$76	\$152	\$76	\$191	\$76	\$348	\$110
50	140	76	168	76	204	76	380	126
75	210	96	252	96	306	96	570	189
100	280	128	336	128	408	128	760	252
125	350	160	420	160	510	160	950	315
150	420	192	504	192	612	192	1140	378
175	490	224	588	224	714	224	1330	441
200	560	256	672	256	816	256	1520	504
225	630	288	756	288	918	288	1710	567
250	700	320	840	320	1020	320	1900	630
ADD 25	70	32	84	32	102	32	190	63

REFERENCE THE CREATIVE LIBRARY AND ONLINE RESOURCES
FOR MOST RIBBON TIE STYLES, COLORS AND OPTIONS

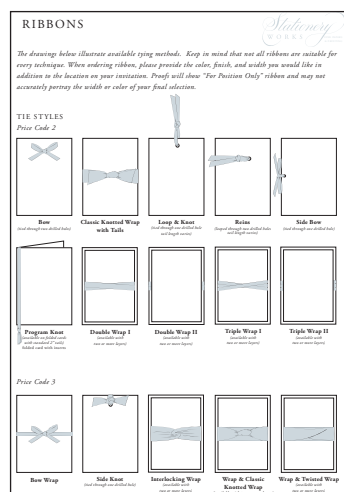
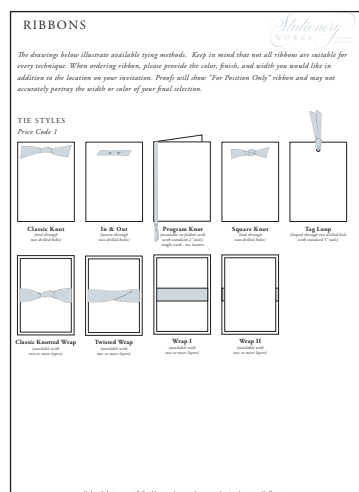

ADDITIONAL INFORMATION

ADDITIONAL INFORMATION

HOW TO ORDER... CUSTOMIZE!

1. ORDER FORMS

Order forms are the best way for us to clearly understand your order and successfully send you an accurate Proof. Feel free to send us wording via email to accompany your order form. Order forms can be found on our websites. Please note that an order received without a form could delay your proof and take additional design time.

2. PROOFS

You will receive a color proof via email. Up to three complimentary proof sets are included with each order. If additional proofs are needed, they are \$50 per Proof Set. Orders submitted without a form or with custom design work may receive fewer complimentary proofs.

Color Proofs are representative of card layout and typesetting, but not of actual printed ink or foil color. Proofs viewed on computer monitors and/or printed from digital/laser/inkjet printers are not accurate in their representation of how the printed ink or foil will appear. Please refer to our ink and foil swatches and album suites for a more representative color.

It is your responsibility to carefully check all details of each proof before providing an approval. Stationery Works is not responsible for any errors or revisions after approval and/or printing, including errors introduced by Stationery Works during order set up and proofing. Any and all costs associated with revisions requested by the customer after providing approval will be the responsibility of the customer.

3. APPROVALS

To approve your order, please sign each proof and fax or scan and email them back to us. We will ALWAYS send you an email confirmation within 1 business day of your approval. If you do not hear from us, please contact us!

IN A HURRY?

4. RUSH REQUESTS

Rush requests can typically be accommodated. Please see our Rush web page (designersfinepress.com/page/DealerResources) for current timing and pricing information. Rush Fees start at \$150 and increase depending on season, print methods, pieces in order, etc. Please note that we will need to review the order to ensure stock and production capabilities before we can confirm the Rush processing.

If you need a Proof Rushed, the fee is \$50 per Proof Set and will be sent within 4 business hours of our order confirmation.

5. EARLY ENVELOPES

Printed envelopes can be ordered separately which may help enable them to ship ahead of the rest of the printed order. See page 18 for details and pricing. Blank, unlined Envelopes may ship ahead for a \$40 fee + shipping.

6. FLAT FEES - ADDITIONAL INKS

You'll note many flat fees throughout the Album. The Flat Fees cover up to quantity of 500. An additional Fee will be added for every 500 quantity. For large quantities, feel free to contact us to ensure accurate pricing.

7. CUSTOM INK COLORS

Choose a Custom Pantone (PMS) color for an additional Fee.

Letterpress (Solid Uncoated) or Thermography (Solid Coated) /Flat:

Standard PMS Inks	\$120
-------------------	-------

Metallic or Neon PMS Inks	\$200
---------------------------	-------

Swatch-Matched Inks	\$175
---------------------	-------

Digital (Solid Uncoated):

Standard Uncoated Solid PMS Color Match	\$80
---	------

Edge Paint (Solid Uncoated) :

Standard Uncoated Solid PMS Color Match	\$100
---	-------

8. LOW GLOSS THERMOGRAPHY

Add \$100 to your order if you would like a matte finish to any Thermography ink (not available for Gold or Silver).

9. SUPPLIED ARTWORK

There are no fees if artwork is received "Print-Ready" (see the Creative Library for file requirements). Design Fees, starting at \$50 per file, apply if the file(s) need adjustments to make Print Ready. Feel free to send in your artwork prior to order submission for us to review and advise.

10. HEBREW & FOREIGN LANGUAGE

Use our Hebrew Conversion Chart found on our website to incorporate Hebrew into your order. Typesetting of Hebrew is \$20 for the first line and \$10 for each additional line. To typeset a Foreign Language (using the Roman Alphabet) add \$25 per card.

Additional visual aids like images or pdfs or typed word docs are welcomed to help assure typesetting accuracy.

Supplying print ready (see Creative Library for file requirements) files do not incur the typesetting fee.

11. SUPPLIED PAPER AND ENVELOPES

We are happy to consider requests to print on custom supplied paper and envelopes. Please contact us prior to ordering stock to confirm the feasibility and quantity of the items you are interested in supplying to us. It is the responsibility of the Dealer to ensure that the dimensions of the supplied stock are compatible with our products. Please know that we do not extend a credit for supplied stock, but we also do not charge extra for its handling.

12. SPECIAL PRESS HANDLING

When customizing, especially with Letterpress Printing, we may suggest Special Press Handling, which can include additional fees. Please see the Creative Library Binder for more details.

ADDITIONAL INFORMATION

FINISHING TOUCHES.

13. TISSUE

Add Tissue to your Invitation order for \$20. Tissue is cut to Card Size and is available in White only.

14. EASY STICK ENVELOPE TAPE

Add easy release tape to your *Square Flap* Envelope for an additional \$.30 per envelope (\$20 minimum).

15. SEALING & MAILING YOUR ENVELOPES

A good seal is the final step to ensure that invitations arrive safely. Too much or too little moisture on the gum line can affect how well the glue adheres. We recommend using double sided tape for the best sealing success.

Check with the local Post Office to arrange for Hand Canceling whenever possible. Stationery Works does not assume liability for any issues or damage during the delivery process.

ON ITS WAY!

16. SHIPPING

We have Flat Shipping Fees for Ground Delivery within the Continental US. We can also Drop Ship the order directly to your client or an address other than the one we have on file.

Drop Ship Adder	\$10
-----------------	------

Ground Shipping	
Any Order	

Ground	\$20
--------	------

Express Shipping	
Order Total up to \$3,000 Retail	

3 Day Express Saver	\$45
---------------------	------

2 Day Express	\$55
---------------	------

Overnight	\$85
-----------	------

Express Shipping	
Order Total \$3,000 - \$5,000 Retail	

3 Day Express Saver	\$65
---------------------	------

2 Day Express	\$85
---------------	------

Overnight	\$155
-----------	-------

Express Shipping	
Order Total over \$5,000 Retail	

Custom quoted	
---------------	--

Stationery Works, Inc. is not responsible for any shipping delays, damages, or other risk of loss once products are transferred to the carrier. Insurance and Signature Required are available for an additional fee.

ON ITS WAY!

(CONTINUED)

17. SPLIT SHIPMENT

If your order needs to be divided and shipped to multiple addresses (e.g., 100 Invitations to Address 1 and 50 to Address 2), a \$40 split shipment fee will apply. Sending envelopes only to a calligrapher does not count as a split shipment and will not incur this fee.

18. RECEIVED ORDER REVIEW

We must be notified of any discrepancies regarding a shipped order within 10 business days of receipt of order for consideration of resolution.

CHANGES?

19. CHANGES AFTER APPROVAL

If changes are requested after approval, which can include but are not limited to changes in quantity, proof changes or paper changes, a minimum \$150 fee will apply, in addition to any new plate fee, new design/proof fee, staging fee or reprint fee.

20. CANCELLATIONS

Should you need to cancel your order, you will be billed for the work already completed. Minimum cancellation fee is \$150 and increases if more than one proof has been created.

Any order that has been inactive for 90 days will automatically be cancelled and the cancellation fee charged for the proofing and work completed and commissioned up to that point.

21. RETURNS

Custom Printed Items are not returnable.

22. REORDERS

The minimum quantity for reorder is 25 pieces. Reorders are priced as a new order without regard to previous quantities printed. While the original order will be referenced, an exact match is not guaranteed.