



Whidbey Equestrian Center June Dressage Show June 19 - 21, 2026



USEF/USDF No. 6884 (level 3)

Opening Date: May 10, 2026

Entry Received by (Closing) Date: June 8, 2026
(entry is late if after this date)

Official Qualifying Competition for:

the 2026 USEF Children Dressage National Championship; the 2026 USEF Pony Rider Dressage National Championship; 2026 USEF Junior Dressage National Championships; 2026 USEF Young Rider Dressage National Championship; 2026 USEF Brentina Cup Dressage National Championship; 2026 Markel/USEF Young and Developing Horse Dressage National Championships; 2026 USEF Intermediaire I Dressage National Championship; 2026 Adequan®/USEF Para Dressage National Championship; 2026 Great American Insurance Group/USDF Regional Championship and 2026 Whidbey Eq Center Finals Competition

Judges		Technical Delegate (TD)
Joan Williams Ca 'S' DR, YH, Equitation, FS	Fran Kehr Tx 'S'/Dressage, YH, FS	Peter Rothschild Wa 'r' DTD +Measurement Certification

Show Officials		
EMT / Medical On grounds during show hours, on call after show hours	Farrier Wild Horse Farriers Phone number posted in show program	Veterinarian Mt. Vernon Animal Hospital Phone number will be posted in barns & show program
Show Management		
Show Manager Mari St. Amand 360-929-2601 info@ridewec.com	Safety Coordinator Mari St. Amand 360-929-2601 info@ridewec.com	Show Secretary Kathy Eyth 425-238-5459 Kaeyth70619@gmail.com

ON LINE Entries at: Horse Show Office -- www.horseshowoffice.com

Address: 21306 SR 20, Coupeville, WA 98239-3802.
Phone: (360)678-8860. Website: www.ridewec.com. All email to info@ridewec.com

Directions on Whidbey Island, from Coupeville, WA: WEC is approximately 0.5 mile south of Coupeville, WA. From the South: After the Mukilteo-Clinton Ferry, WEC is approximately 26 miles north of the Clinton ferry terminal, on the east side of Hwy 20.

Entry information: Online entries are strongly encouraged. ***Signed Signature page, release pages and required documents MUST be uploaded to your account and submitted with your entry. Competitors are responsible to include a current copy of all memberships for horse, owner, rider and trainer listed on any entry form. If in a freestyle class, a copy of the qualifying test must also be included.***

Please see Rules and Entry information. All entries accepted with understanding the competitor has read entry information.

“EVERY CLASS OFFERED HEREIN WHICH IS COVERED BY THE RULES AND SPECIFICATIONS OF THE CURRENT USEF RULE BOOK WILL BE CONDUCTED AND JUDGED IN ACCORDANCE THEREWITH.”

2026 WEC Dressage Fee Schedule

Description	Fee	Detail/Notes
Office Fee	\$45	Per show, per horse/rider combination (all entries)
Grounds/Facility Use	\$20	Per show, per horse/rider combination.
Stabling	\$170	Per horse for show weekend. 1PM Friday to 4PM Sunday or 2 hours after last ride, whichever is earlier. Initial bedding provided (one bale)
Day Stall (contact show office)	\$120	Per day, per horse. Confirm availability . No Overnight. One-hr. prior to/one-hr. after last ride of the day. Bedding Additional.
Tack Stalls (no bedding)	\$100	For show weekend. Space available only . Include separate check with "tack stall" on memo line, Check cashed ONLY IF STALL ASSIGNED .
Bedding (NO Outside Bedding)	\$15	Bedding is \$ 15 per bale/bag for bagged bedding (or market price).
Stabling per Additional Night	\$50	Extended stabling before or after dates of show. Per horse, per night Non show dates. Bedding additional. Confirm availability with show management.
Non-competing or Schooling Horse	\$75	Per day, per horse. For horses not entered in show classes, horse must have assigned bridle number. Entry accepted as space allows . Must have stabling. Plus all administrative fees.
Haul-In Fee	N/A	contact show management to confirm IF Haul-In is allowed.
Incomplete Entry (including verification of documents)	\$25	For each entry. This is for any missing information, example(s): missing emergency contact information, incorrect horse owner information, missing or invalid memberships, missing membership cards, missing or incomplete signature pages, or non-WEC signature pages. And this is for verification of any membership information (including safesport) and horse owner name(s) or memberships. No competitor number will be released until the entry has all the correct information for the competition.
Post Entry to a class, time change	\$20	Post entry additional to class fee; time change(s) and test changes are per change. Changes must be requested by 3PM the day prior. Changes taken as scheduling permits.
Rider/Handler/Horse Change	\$25	For either rider or horse change after entry is submitted. New entry form must be completed and all membership cards.
Late Entries	\$20	Entry received after the "Received By" (closing) date.
Credit Card Convenience Fee	3% for HSO 3.5% for POS	For online entries transaction credit card. Singular charge, per entry total Point Of Sale (POS)/Card Swipe fee for payment at office
Cancellation Fee	\$50	Cancellation fee will be deducted from all refunds, regardless of date.
NSF Check or Declined credit:	\$50	See Returned Checks. This is also for declined credit/debit charges.
Pony Measurement	Tbd	See FEI Pony. Must be prearranged. Cost to Vet directly.
USEF Drug Fee	\$25	\$15.00 USEF Drug & Medication Fee and \$10.00 USEF Administration per horse, per show, required for all competition entered horses except as otherwise stated.
USDF Qualifying Fee, per test	\$20	per eligible class, prior to class start, additional to class fee
USEF Non-member / USEF Show Pass	\$55	If not a competing USEF member. Only one show pass per competition year for a single show . Must complete online at USEF.org prior to Competition dates.
USDF Affidavit	\$5	USDF Member Rider &/or owner unable to provide membership validation to competition
USDF HID	\$45	per horse (Except Opportunity and Intro Classes)
USDF Life Horse	\$115	per horse
USDF Membership (Participating)	\$100	Per Person per year. Please see: https://www.usdf.org/join/
USDF Non-Member	\$55	per competition, for each NM rider & owner, if not current Business (owner), Group or Participating member. Exception for Opportunity Classes.

WEC June Dressage Show
June 19 - 21, 2026

Fri	Sat	Sun		Class Name	Division	Fee	Q*
101	201	301		USDF Intro Test A	O/AA/JrYR	\$60	
102	202	302		USDF Intro Test B	O/AA/JrYR	\$60	
103	203	303		USDF Intro Test C	O/AA/JrYR	\$60	
104	204	304		USEF Training Level Test 1	O/AA/JrYR	\$60	
105	205	305		USEF Training Level Test 2	O/AA/JrYR	\$60	
106	206	306	*	USEF Training Level Test 3	O/AA/JrYR	\$60	\$20
107	207	307		USEF First Level Test 1	O/AA/JrYR	\$60	
108	208	308		USEF First Level Test 2	O/AA/JrYR	\$60	
109	209	309	*	USEF First Level Test 3	O/AA/JrYR	\$60	\$20
110	210	310		USEF Second Level Test 1	O/AA/JrYR	\$65	
111	211	311		USEF Second Level Test 2	O/AA/JrYR	\$65	
112	212	312	*	USEF Second Level Test 3	O/AA/JrYR	\$65	\$20
113	213	313		USEF Third Level Test 1	O/AA/JrYR	\$65	
114	214	314		USEF Third Level Test 2	O/AA/JrYR	\$65	
115	215	315	*	USEF Third Level Test 3	O/AA/JrYR	\$65	\$20
116	216	316		USEF Fourth Level Test 1	O/AA/JrYR	\$65	
117	217	317		USEF Fourth Level Test 2	O/AA/JrYR	\$65	
118	218	318	*	USEF Fourth Level Test 3	O/AA/JrYR	\$65	\$20
119	219	319		USEF TOC (Specify Level, Test 1 or 2)	O/AA/JrYR	\$65	
120	220	320	*	USEF TOC (Specify Level, Test 3)	O/AA/JrYR	\$65	\$20
121	221	321	*	FEI Prix St. George	O/AA/JrYR	\$75	\$20
122	222	322	*	FEI Intermediate I	O/AA/JrYR	\$75	\$20
123	223	323	*	FEI Grand Prix	O/AA/JrYR	\$75	\$20
124	224	324	*	FEI Intermediate II	O/AA/JrYR	\$75	\$20
125	225	325		FEI Intermediate A or B TOC (Specify Test)	O/AA/JrYR	\$75	
126	226	326		FEI Grand Prix Special	O/AA/JrYR	\$75	
127	227	327	*	USDF Freestyle TOC	Open	\$75	\$20
128	228	328	*	FEI Freestyle TOC	Open	\$75	\$20
129	229	329		FEI Para-Dressage TOC (Specify Test – No FS)	O/AA/JrYR	\$75	
130	230	330	*	FEI -- TOC* (Specify Test – No FS, YH, Para, Pony Rider, or Children Rider Tests)	Open	\$75	\$20
131	231	331	*	FEI Junior Rider TOC (Specify Test – No FS)	JR	\$75	\$20
132	232	332	*	FEI Young Rider TOC (Specify Test – No FS)	YR	\$75	\$20
133	233	333	*	FEI Children Rider TOC (Specify Test – No FS)	JR	\$75	\$20
134	234	334		FEI Pony Rider TOC (Specify Test – No FS)	JR	\$75	
135	235	335		Dressage Seat Equitation	AA/JrYR	\$60	
136	236	336		Materiale (3 yo Filly)		\$60	
137	237	337		Materiale (3 yo Colts/Geldings)		\$60	
138	238	338		Materiale (4 or 5 yo Mare, specify)		\$60	
139	239	339		Materiale (4 or 5 yo Stallion or Gelding, specify)		\$60	
USEF Classes, Markel YH & DH Qualifying							
141EF				FEI Children's Team – USEF Qualifying	JR	\$75	
	242EF			FEI Children's Individual – USEF Qualifying	JR	\$75	
145EF			*	FEI Junior Team – USEF Qualifying	JR	\$75	\$20
	246EF			FEI Junior Individual – USEF Qualifying	JR	\$75	
		347EF		FEI Junior Freestyle	JR	\$75	
143EF				FEI Pony Rider Team – USEF Qualifying	JR	\$75	

WEC June Dressage Show

June 19 - 21, 2026

USEF Classes, Markel YH & DH Qualifying

	244EF			FEI Pony Rider Individual – USEF Qualifying	JR	\$75	
148EF			*	FEI Young Rider Team – USEF Qualifying	YR	\$75	\$20
	249EF			FEI Young Rider Individual – USEF Qualifying	YR	\$75	
		350EF		FEI Young Rider Freestyle	YR	\$75	
		351EF		FEI Grand Prix (16-25) – USEF Qualifying	YR	\$75	
	252EF		*	FEI Intermediate II – Markel/USEF Qualifying		\$75	\$20
	253EF		*	FEI Prix St George – Markel/USEF Qualifying		\$75	\$20
		354EF	*	FEI Intermediate I – USEF Qualifying		\$75	\$20
	257EF			FEI Para Intermediate Test A TOC – USEF Qualifying		\$75	
	258EF			FEI Para Grand Prix Test A TOC – USEF Qualifying		\$75	
		359EF		FEI Para Intermediate B TOC – USEF Qualifying		\$75	
		360EF		FEI Para Grand Prix Test B TOC – USEF Qualifying		\$75	
		361EF		FEI Para Intermediate Freestyle TOC – USEF Qualifying		\$75	
		362EF		FEI Para Grand Prix Freestyle TOC - USEF Qualifying		\$75	
		366EF		USEF 4 YO Test – Markel/USEF Qualifying		\$75	
	263EF			FEI 5 YO Preliminary Test – Markel/USEF Qualifying		\$75	
		367EF		FEI 5 YO Final Test – Markel/USEF Qualifying		\$75	
	264EF			FEI 6 YO Preliminary Test – Markel/USEF Qualifying		\$75	
		368EF		FEI 6 YO Final Test – Markel/USEF Qualifying		\$75	
	265EF			FEI 7 YO Preliminary Test – Markel/USEF Qualifying		\$75	
		369EF		FEI 7 YO Final Test – Markel/USEF Qualifying		\$75	
	270EF			USEF Developing Horse PSG (7-9 yr old) – Markel/USEF Qualifying		\$75	
		371EF		USEF Developing Horse GP (8-10 yr old) – Markel/USEF Qualifying		\$75	
Opportunity Classes							
173	273	373		USEF 2023 Training Level Test 1 Opportunity Class	AA/JrYR	\$60	
174	274	374		USEF 2023 Training Level Test 2 Opportunity Class	AA/JrYR	\$60	
175	275	375		USEF 2023 First Level Test 1 Opportunity Class	AA/JrYR	\$60	
176	276	376		USEF 2023 First Level Test 2 Opportunity Class	AA/JrYR	\$60	
177	277	377		USDF 2023 Intro A Opportunity Class	AA/JrYR	\$60	
178	278	378		USDF2023 Intro B Opportunity Class	AA/JrYR	\$60	
179	279	379		USEA 2023 Eventing Dressage ToC Test 'A' Opportunity Class	AA/JrYR	\$60	
180	280	380		USEA 2023 Eventing Dressage ToC Test 'B' Opportunity Class	AA/JrYR	\$60	

* Specify if GREAT AMERICAN INSURANCE GROUP/USDF Regional Championship Qualifying (Note: NOT available for TRAINING LEVEL FREESTYLE, INT-A/B and GP SPECIAL).
"Q" fee is additional to class fee.

<input type="checkbox"/>	VISA	<input type="checkbox"/>	AMEX	CARD NO. _____ - _____ - _____	EXP DATE _____
<input type="checkbox"/>	MasterCard	<input type="checkbox"/>	Other _____	NAME ON CARD: _____ CVV # _____	
BILLING ADDRESS _____				ZIP CODE _____	



USDF HOLD HARMLESS AGREEMENT : I hereby agree to release, indemnify and hold harmless USDF, its instructors, officers, directors, agents, and volunteers from and against any and all loss, liability or damage arising from or because of, or in connection with participation in this competition or related activities. I also hereby agree to release, indemnify and hold harmless the competition management, show committee and members, officers, directors, agents and volunteers from and against any and all loss, liability or damage arising from or because of, or in connection with, participation in this competition or related activities.



FEDERATION ENTRY AGREEMENT

By entering a Federation-licensed Competition and signing this entry blank as the Owner, Lessee, Trainer, Manager, Agent, Coach, Driver, Rider, Handler, Vaultor or Longeur and on behalf of myself and my principals, representatives, employees and agents, I agree that I am subject to the Bylaws and Rules of the United States Equestrian Federation, Inc. (the "Federation") and the local rules of **2026 Whidbey Equestrian Center Dressage Shows** (Competition). I agree to be bound by the Bylaws and Rules of the Federation and of the competition. I will accept as final the decision of the Hearing Committee on any question arising under the Rules, and agree to release and hold harmless the competition, the Federation, their officials, directors and employees for any action taken under the Rules. I represent that I am eligible to enter and/or participate under the Rules, and every horse I am entering is eligible as entered. I also agree that as a condition of and in consideration of acceptance of entry, the Federation and/or the Competition may use or assign photographs, videos, audios, cable - casts, broadcasts, internet, film, new media or other likenesses of me and my horse taken during the course of the competition for the promotion, coverage or benefit of the competition, sport, or the Federation. Those likenesses shall not be used to advertise a product and they may not be used in such a way as to jeopardize amateur status. I hereby expressly and irrevocably waive and release any rights in connection with such use, including any claim to compensation, invasion of privacy, right of publicity, or to misappropriation. The construction and application of Federation rules are governed by the laws of the State of New York, and any action instituted against the Federation must be filed in New York State. See GR907.4.

If not currently a USEF Active Competing member or Subscriber and competing only in classes that are exempt from membership requirements, I acknowledge and agree that I will be enrolled at no cost as a USEF Fan and my USEF Fan Account will continue to annually automatically renew unless and until USEF determines in its sole discretion to terminate my Fan account. Additionally, I acknowledge that the benefits of a USEF Fan are subject to change without notice. I acknowledge that I may opt out at any time by going to My USEF Dashboard or calling (859) 810-8733.

BY SIGNING BELOW, I AGREE that I have read, understand, and agree to be bound by all applicable Federation Bylaws, rules, and policies including the USEF Safe Sport Policy and Minor Athlete Abuse Prevention Policies (MAAPP) as published at www.usef.org, as amended from time to time, as well as all terms and provisions of this Prize List. If I am signing and submitting this Agreement electronically, I acknowledge that my electronic signature shall have the same validity, force and effect as if I affixed my signature by my own hand.

RIDER/DRIVER/HANDLER/VAULTOR/LONGEUR (mandatory)

Signature: _____

Print Name: _____

TRAINER (mandatory)

Signature: _____

Print Name: _____

OWNER/AGENT (mandatory)

Signature: _____

Print Name: _____

COACH (if applicable)

Signature: _____

Print Name: _____

Parent/Guardian Signature: (Required if Rider/Driver/Handler/Vaultor/Longeur is a minor) _____

Print Parent//Guardian Name: _____ Emergency Contact Phone No. _____

Is Rider/Driver/Vaultor a U.S. Citizen: ___ Yes ___ No

Required for Each Competition



WAIVER AND RELEASE OF LIABILITY, ASSUMPTION OF RISK AND INDEMNITY AGREEMENT

Washington State Waiver -- Applicable for the following
WEC 2026 Competition Numbers: 5669, 274647, 6884,
311884, 327505, 5967, 5508, 325613, 316379

For and in consideration of United States Equestrian Federation, Inc. dba US Equestrian ("USEF") allowing me, the undersigned, to participate in any capacity (including as a rider, driver, handler, vaulter, longeur, lessee, owner, agent, coach, official, trainer or volunteer) in a USEF sanctioned, licensed or approved event or activity, including but not limited to equestrian clinics, practices, shows, competitions and related or incidental activities and

2026 Whidbey Equestrian Center (WEC) Dressage Shows ("USEF Event" or "USEF Events"); I, for myself, and on behalf of my spouse, children, heirs and next of kin, and any legal and personal representatives, executors, administrators, successors, and assigns, hereby agree to and make the following contractual representations pursuant to this Agreement (the "Agreement"):

A. RULES AND REGULATIONS: I hereby agree that I have read, understand, and agree to be bound by all applicable Federation Bylaws, rules, and policies including the USEF Safe Sport Policy and Minor Athlete Abuse Prevention Policies (MAAPP) as published at www.usef.org, as amended from time to time.

B. ACKNOWLEDGMENT OF INHERENT RISKS: I knowingly, willingly, and voluntarily acknowledge the inherent risks associated with equine activities, including but not limited to horseback riding and equestrian sport, are inherently dangerous, and that participation in any USEF Event involves risks and dangers including, without limitation, the potential for serious bodily injury (including broken bones, head or neck injuries), sickness and disease (including communicable diseases), trauma, pain & suffering, permanent disability, paralysis and death; loss of or damage to personal property (including my mount & equipment) arising out of the unpredictable behavior of horses; exposure to extreme conditions and circumstances; accidents involving other participants, event staff, volunteers or spectators; contact or collision with other participants and horses, natural or manmade objects; adverse weather conditions; facilities issues and premises conditions; failure of protective equipment (including helmets); inadequate safety measures; participants of varying skill levels; situations beyond the immediate control of the USEF Event organizers and competition management; and other undefined, not readily foreseeable and presently unknown risks and dangers ("Risks").

EQUINE ACTIVITY LIABILITY ACT WARNING:

CAUTION: HORSEBACK RIDING AND EQUINE ACTIVITIES CAN BE DANGEROUS. RIDE AT YOUR OWN RISK.

Under the laws of most States, an equine activity sponsor or equine professional is not liable for any injury to, or the death of, a participant in equine activities resulting from the inherent risks of equine activities.

C. ASSUMPTION OF RISK: I understand that the aforementioned Risks may be caused in whole or in part or result directly or indirectly from the negligence of my own actions or inactions, the actions or inactions of others participating in the USEF Events, or the negligent acts or omissions of the Released Parties defined below, and I hereby voluntarily and knowingly assume all such Risks and responsibility for any damages, liabilities, losses, or expenses that I incur as a result of my participation in any USEF Events. I also agree to be responsible for any injury or damage caused by me, my horse, my employees or contractors under my direction and control at any USEF Event.

D. WAIVER AND RELEASE OF LIABILITY, HOLD HARMLESS AND INDEMNITY: In conjunction with my participation in any USEF Event, I hereby release, waive and covenant not to sue, and further agree to indemnify, defend and hold harmless the following parties: USEF, USEF Recognized Affiliate Associations, the United States Olympic & Paralympic Committee (USOPC), USEF clubs, members, Event participants (including athletes/riders, coaches, trainers, judges/officials, and other personnel), the Event owner, licensee, and competition managers; the promoters, sponsors, or advertisers of any USEF Event; any charity or other beneficiary which may benefit from the USEF Event; the owners, managers, or lessors of any facilities or premises where a USEF Event may be held; and all directors, officers, employees, agents, contractors, and volunteers of any of the aforementioned parties (Individually and Collectively, the "Released Parties" or "Event Organizers"), with respect to any liability, claim(s), demand(s), cause(s) of action, damage(s), loss, or expense (including court costs and reasonable attorney fees) of any kind or nature ("Liability") which may arise out of, result from, or relate in any way to my participation in the USEF Events, including claims for Liability caused in whole or in part by the negligent acts or omissions of the Released Parties.

E. COMPLETE AGREEMENT AND SEVERABILITY CLAUSE: This Agreement represents the complete understanding between the parties regarding these issues and no oral representations, statements or inducements have been made apart from this Agreement. If any provision of this Agreement is held to be unlawful, void, or for any reason unenforceable, then that provision shall be deemed severable from this Agreement and shall not affect the validity and enforceability of any remaining provisions.

I HAVE CAREFULLY READ THIS DOCUMENT IN ITS ENTIRETY, UNDERSTAND ALL OF ITS TERMS AND CONDITIONS, AND KNOW IT CONTAINS AN ASSUMPTION OF RISK, RELEASE AND WAIVER FROM LIABILITY, AS WELL AS A HOLD HARMLESS AND INDEMNIFICATION OBLIGATIONS.

By signing below, I agree that I have read, understand, and agree to be bound by all applicable Federation Bylaws, rules, and policies including the USEF Safe Sport Policy and Minor Athlete Abuse Prevention Policies (MAAPP) as published at www.usef.org, as amended from time to time. Further, by signing below, I (as the participant or as the Parent/Legal Guardian of the minor identified below) hereby accept and agree to the terms and conditions of this Agreement in connection with my (or the minor's) participation in USEF Events. If, despite this Agreement, I, or anyone on my behalf or the minor's behalf, makes a claim for Liability against any of the Released Parties, I will indemnify, defend and hold harmless each of the Released Parties from any such Liabilities as the result of such claim.

The parties agree that this agreement may be electronically signed. The parties agree that the electronic signatures appearing on this agreement are the same as handwritten signatures for the purposes of validity, enforceability, and admissibility.

RIDER/DRIVER/HANDLER/VAULTER/LONGEUR OWNER TRAINER OFFICIAL STAFF VOLUNTEER COACH (IF APPLICABLE)

Signature: _____ Date: _____ Print Name: _____

Parent/Guardian Signature: (Required if Rider/Driver/Handler/Vaulter/Longeur is a minor) _____ Date: _____

Print Parent//Guardian Name: _____ Emergency Contact Phone No. _____

08.18.25

2026 WEC Rules & Information

“EVERY CLASS OFFERED HEREIN WHICH IS COVERED BY THE RULES AND SPECIFICATIONS OF THE CURRENT USEF RULE BOOK WILL BE CONDUCTED AND JUDGED IN ACCORDANCE THEREWITH.”

US EQUESTRIAN FEDERATION rules are in force from the moment show management allows access to the show grounds, and includes the arrival day BEFORE the show begins. This includes conduct, training/coaching, correct saddlery and equipment, and attire.

ATTENTION COMPETITORS - It is the responsibility of all riders to know the rules applying to showing in the Dressage Discipline. THE RULES MAY HAVE CHANGED FROM THE CURRENT RULE BOOK. IT IS THE COMPETITORS' RESPONSIBILITY TO CHECK THE CURRENT US EQUESTRIAN RULE BOOK FOR ANY CHANGES. The listed rules are only general and are subject to change at the discretion of the Board of Directors of USEF. Current rules can be found on www.usef.org

Competition Numbers (Bridle Numbers): must be worn at all times when a horse is out of the stall, being exercised or being ridden.

Helmet // Headgear Rule: ([DR120_1.1](#)) Protective headgear is defined as a riding helmet, which meets or exceeds current ASTM (American Society for Testing and Materials)/SEI (Safety Equipment Institute) standards for equestrian use and carries the SEI tag.

From the time horses are officially admitted to the competition grounds by competition management, anyone mounted on a horse at any time on the competition grounds, including non-competing riders, riders on non-competing horses, mounted participants in exhibition classes, and those competing in all classes and tests, must wear protective headgear as defined by this rule and otherwise in compliance with [GR801](#). The harness must be secured and properly fitted. Any rider violating this rule at any time must immediately be prohibited from further riding until the headgear is properly in place.

Effective 12/01/2015 (USEF DR 206.6) ALL Handlers, Assistant Handlers and Whip Assistants are required to wear protective headgear, defined as a riding helmet which meets or exceeds ASTM/SEI standards for equestrian use and carries the SEI tag, with the harness properly fitted and secure when in the competition ring.

Protective headgear may be the same as or a coordinating color with the coat, and may include contrast coloring, accent, and crystal decoration. See [DR136](#) for dress code rules for exhibitions.

Warning: Under the Equine Activity Liability Act, each participant who participates in an equine activity expressly assumes the risks of engaging in and legal responsibility for injury, loss, or damage to person or property resulting from the risk of equine activities.

2026 WEC Rules & Information

=====
Directions / Show & Office Hours / Facility Rules / Accommodations / Dogs
=====

DIRECTIONS: WEC is located on Whidbey Island, approximately 0.5 mile south of Coupeville, WA. Whidbey Island is part of Island County. The facility is approximately 26 miles north of the Clinton ferry terminal, on the east side of Hwy 20.

WEC Address:

Whidbey Equestrian Center
21306 SR 20
Coupeville, WA 98239

PRIZELIST: The official prize list is posted on the website at www.ridewec.com.

SHOW & OFFICE HOURS:

- Show grounds are open for arrival AFTER 1:00 PM the day before the competition begins.
- For check-in, the office is open at 2 PM the day of check-in until 5 P.M.
- Office hours during the show days are as follows: Office opens one hour prior to the first ride of the day and closes one hour after the last ride.

SHOW TIMES (& Ride times):

- Entry confirmation and tentative ride times will be e-mailed to the Rider's email address provided.
- Official and final ride times will posted on <https://hideshowoffice.com/#/events>.
- Official show times will be available at the show office on the day prior to show start and posted on the announcement board.
- It is the responsibility of the rider to inform the management of any time or Judge conflicts as soon as possible after receiving the schedule. Ride times cannot be changed unless dire need is demonstrated and an equitable solution among all riders affected is available.

FACILITY RULES:

- Please DO keep entrance gate closed and latched at night (9 p.m. to 8 a.m.).
- All children under the age of 13 must be chaperoned by an adult at all times.
- Keep out of hay-lofts and off the hayloft stairs in ALL barns.
- Barn wash racks for WEC boarding residents only.
- No climbing, sitting, or using rockeries or planters as mounting blocks.
- Photography only from seating area. No photography from the A entrance of the Rings or around/behind the judges boxes. No photography when calling/reading tests. No overhead/drones allowed.
- NO SMOKING on the show grounds, barns, arena or stabling areas. Smoking is allowed in the Main Barn office.
- No bicycles (of any kind) around at the arenas. Bicycles (and tricycles) to stay in parking area.
- Barn Cats – Please leave barn cats alone.

ACCOMMODATIONS, LODGING & CAMPING, PARKING:

- A variety of hotel/motel accommodations can be found at www.coupevillelodging.com. Please see visitor's link at www.ridewec.com.
- FIRE LANES WILL BE MARKED - KEEP THE FIRE LANES AND BATHROOM CLEAR FOR ACCESS!

2026 WEC Rules & Information

- LIMITED parking is available at the Show Office is reserved for farrier, veterinarian, show staff and/or persons who need assistance.
- Competitor parking is at the stabling area as designated.
- Camping (Parking) for campers and motor homes is available and is not preassigned. No showers, utility, or electrical hookups available. Toilets are available. There are NO fees for camping during the show. Ideally, parking is close to the assigned stabling.
- Portable, self-contained, QUIET generators may be used in the parking/camping area. Generators should be off from 10 p.m. to 4:30 a.m. No generators in the barns, stalls or tack stalls.
- NO wood, briquette, open or pit fires allowed at any show. Unless otherwise posted, gas barbecue permitted.

DOG(S): If possible, please leave your dogs at home!

- Dogs (GR1301.6) are not permitted to be loose and must be leashed. We request leashes not be more than six (6) foot long and be non-retractable.
- Dog(s) are to be at your stabled area – PLEASE USE XPEN with top barrier, AND PROVIDE SHADE.
- Dogs shall not be tied to any fences or any place that would constitute a hazard.
- NO dogs in arena seating areas, or around the concession stand, any of the barns or at the WEC Office or Lounge area!!
- If your dog becomes a hazard to any person or other animal at the facility YOU (the dog owner) are solely responsible solely responsible for any damages, claims, losses, or actions resulting from their dogs' behaviors. Dog owners failing to comply with the USEF Rule will be issued a Yellow warning card and may be subject to penalty under [USEF General Rules Chapter 7] AND YOU will be requested to leave the competition without refund.

=====

Concessions / Announcements / Arenas / Stabling, Tack Stalls, Bedding

=====

FOOD & CONCESSIONS: Concession will be available, with times posted.

ANNOUNCEMENTS: Announcements and ride time announcements will be posted at the show office and the concessions areas. Please check for announcements each morning.

ARENAS:

- All tests will be ridden in a standard size outdoor 20m x 60m arena. Warm-up will be in a 20m x 60m covered arena or a 150 ft x 260 ft outdoor arena. Footing is either only sand, or Combination of Sand and ProStride by Premier Equestrian
- Competition arenas are closed at 5 PM the day PRIOR to the competition date. Unless otherwise posted, NO horses in, or around, any of the arenas after this time.
- Horses are not permitted in or around the competition arenas on any show day, except for the competitor's ridetime.
- No one (including trainer and coach) on foot is allowed in designated warm-up arenas.
- No lunging in the indoor (covered) arena, outdoor warm up (Ring 3) or competition arenas at any time for the duration of the competition INCLUDING from your time of arrival at the facility. Lunging shall be done in the designated areas only.
- Watering – Arenas are watered as necessary by large equipment. Be aware that equipment moves around the facility at any time of the day.
- Lunging areas are the enclosed round pen, or at the small warmup area next to Ring 3. If using the enclosed round pen, two people are required and contact show office before using.

2026 WEC Rules & Information

STABLING & TACK STALLS:

Stabling and tack stall rate as stated on fee schedule for this show. Facility and Stabling map is will be posted on reader board at facility entrance. Stabling map will show locations for stall assignment. Facility stabling will also be posted to media (website and/or Facebook).

STABLING:

- Stabling is done on a “first come” basis” (see multi day shows). Stabling is allocated according to postmark/on-line entry completion for the two day and three day/weekend shows.
- MULTIDAY SHOWS: stabling for sequential shows on same weekend -- example: the “ONE DAY” and “Summer” show, is prioritized by postmark in the following order: (1) competitors entering both shows for all three days, (2) entries for the “Summer” show only for both days, (3) entries for the “ONE DAY” show).
- Stabling is per horse, and is assigned for the duration of the competition. No subletting or sharing of stabling between horses.
- HAUL-INS (a.k.a. Jump Outs, or non-stabled horse): All horses must have stabling. No haul-in or working from trailer only.
- Primary stabling will be in portable stalls (10x10) with full doors.
- For requests for permanent stall, please request on entry (limited availability). Rider will be contacted before stall assignment.
- Please confirm/complete the emergency contact details on the stall cards provided on the stall door.
- Stallions must have stabling and be attended by and adult at all times.
- Horses shall not be tied to any fences or any place that would constitute a hazard.
- Bring your own wheel barrows, water buckets, and feed.

TACK STALLS: Tack Stalls are on a space available basis. Tack stalls will be assigned by post-marked after all stabling assignments have been fulfilled.

DAY STALLS: Day stalls are on a space available basis. Only one horse is allowed per day stall. Day stall pricing per calendar day, per horse, as listed for each show. Entry must include date of arrival. Horses must be out of the day-stall by the end of that day’s competition or 5 PM whichever is earlier. Day stalls are for a singular show day, not the entirety of a show weekend. Day stalls have a required \$25 additional stall stripping fee.

BEDDING:

- Initial stall bedding provided (one bale).
- Bedding material is dried wood chips.
- Bedding is available by the bale from the Show Secretary at the price listed or the current market price. Indicate quantity of bales on entry form. Purchased bedding will be placed in your stall, unopened.
- Bedding requested by 3 PM to be delivered the evening of that day. Requests after 3 PM will have bedding delivered by 8 AM the following day.
- No outside bedding is permitted unless a signed veterinary note is included when entry is submitted. Please contact Show Manager.

FACILITY DAMAGES:

- No stall construction changes, marking or painting allowed.
- All riders, owners and exhibitors will be held responsible for any damage caused by them, their agents, their horses, or their employees to stalls, buildings, and other properties on the show grounds and shall be billed accordingly.

2026 WEC Rules & Information

- Damage to stalls, show grounds, gates or buildings (example – excessive kicking resulting in breakage) will incur a \$250 damage fee to be applied for repair expenses. Expenses above this will be billed to the rider (if over 18 years age, otherwise the billed to the horse owner or rider's parent).

=====

Tests / Awards / Entry Info / Refunds / Returned Checks / Competitor and Management Responsibilities

=====

TESTS: This show will use the current USDF and FEI tests.

USDF - For the current test, please go to: <https://www.usdf.org/downloads/forms/index.asp?TypePass=Tests>

FEI - For the current test, please go to:

<https://inside.fei.org/fei/your-role/organisers/dressage/tests>

AWARDS and Prizes:

- For Classes with four or more competitors, positional ribbons up to FIVE places.
- For a class with four or more competitors and entries that multiple rider divisions, the classes will be awarded by rider division noted in the Prizelist (AA, JrYr, and Open).
- If a Class is held with less than three (3) entries, no award(s) will be presented.
- Ribbons and awards will be determined and presented at the completion of each class.

ENTRY INFORMATION:

1. The title page of the prize list publishes the OPENING and RECEIVED BY (CLOSING) DATE.
2. A COPY OF ALL APPROPRIATE USEF & USDF MEMBERSHIP CARDS, (OWNER, AGENT, LEESE, RIDER, TRAINER, & COACH) HORSE REGISTRATIONS AND REQUIRED PREREQUISITE TEST(S) MUST ACCOMPANY EVERY ENTRY. The horse, owner and rider information must be identical on all submitted USEF and USDF membership cards AND Horse registrations/HID information on the entry form. Horses must be entered in qualifying classes under their official recorded names and ownership, and transfers of ownership or lease registrations must be completed in compliance with USEF rules prior to the competition.
3. A complete entry form is required for each horse/rider combination for each show (only one horse-rider combination per entry form). Each WEC show requires a separate entry form. The entry form, and the signature pages are valid for only one show and SHALL NOT be used for multiple show entries.
4. All entries are taken on a first come, first served basis. Multi-show weekends will be accepted based on stabling. If the show is over-subscribed (as determined by stabling), show management shall determine IF complete entries will be placed on wait list.
5. Complete entry definition: To avoid Incomplete Entry fee, each entry must be filled out in its entirety, and signed by rider, owner, and trainer (even if same person), and coach (if applicable). Copies of all current rider/owner/trainer/coach USEF/USDF membership cards and Horse ID number (or registration) MUST accompany EACH entry. Emergency contact information must be completed. Safe Sport must be completed and not expiring during competition. Incorrect or incomplete entries may be returned at rider's expense.
6. Entry form must have rider's email address clearly and legibly printed to receive the ride-time schedule and/ or entry confirmation.
7. If the test number and/or description is not indicated on the entry, test will be assigned the highest test for the class.
8. Riders must clearly specify division choice. When rider's not designation is made, riders will be automatically entered as OPEN. Riders may only enter one division per class for the show.
9. A horse/rider combination may enter each Test of Choice class only once. Any change in test choice level after the class is scheduled be considered as a Test Level Change.
10. No phone, email or faxed entries will be accepted.

2026 WEC Rules & Information

11. No Minor's entry will be accepted without signatures by a parent or guardian. The signature of an instructor, coach, trainer, agent or other unrelated persons will NOT be accepted.
12. An entry received after the RECEIVED BY (CLOSING) DATE is a Late Entry. Entries after closing date will be accepted on the basis of stabling availability but will be charged a late fee. This fee is in lieu of the post-entry fee.
13. If after the Received By (closing date), any change to an entry (horse, rider, trainer/handler) will require a completely new entry form and a change fee.
14. Post entries (at show) will be taken as scheduling/space permits, or in the case of scratches or cancellations. Post entries accepted if rides are available. Written requests for post entry must be done by 3:00 p.m. the day before the test. See Fee Schedule.
15. Online show entries through Horse Show Office are required. All signature pages must be printed, signed, scanned, and uploaded to each online entry.
16. Mailed entries, or Dropped off entries (at facility office) shall be coordinated with the show manager and be initialed and dated by the show manager. The show manager's date shall act as the post-mark. Note: No entries shall be "dropped-off" at the facility residence. Mailed (or dropped off) entries will have a \$5.00 computer/data entry fee.
17. HSO entries require payment at processing for entry submittal. For mailed entries, entry payment can be made via credit card or check at time of entry submittal.

PAYMENTS

- All entry forms must be accompanied with full payment (US Funds only). If requesting tack stall, please put on separate check;
- Bridle number will not be issued until all entry, late fee, membership fees, or incomplete are paid;
- All check and/or credit cards will be processed on the stated closing date of the show, and upon receipt thereafter.

REFUNDS: All entries are accepted with the following understanding:

1. After the Show Closing Date, no refunds for any reason.
2. Refund request before the closing date:
 - a. \$50 cancellation fee for cancellations or withdrawals, and
 - b. Only Stabling, drug fees, tack stall and bedding will be refunded, and
 - c. Refund request shall be submitted in writing (not by email) and postmarked prior to the show closing date. Include information from Vet for a Vet-out.
3. No refunds if show (or any part of the show) is postponed or cancelled due to Act of God.
4. No transfer of fees for entries, stabling, or bedding from show to show, or exhibitor to exhibitor.
5. No refunds will be made if the entry is a no-show.

CHECK-IN (& No-Shows):

- Exhibitor number will not be released until show fees are paid.
- All exhibitors or representatives must check in with the Show Office and pick up their exhibitor number at least 60 minutes PRIOR to their FIRST class for the show.
- Exhibitors that have not checked in with the Show Office and received their show number, will be considered a NO-SHOW and be scratched for the rest of the show and time slots may be filled. All "No Shows" that have not contacted the show office will be considered a scratch for the rest of the show and time slots may be filled.

RETURNED CHECKS / DECLINED CREDIT CARD / Chargebacks:

Checks returned by the bank or Credit card chargebacks for any reason are regarded as a most serious offense and will be handled according to the following procedure: A \$50 penalty will be assessed for each returned check or chargeback OR 10% of the face value of the check or chargeback, whichever is greater. Accounts will be given ten (10) days to be

2026 WEC Rules & Information

paid in full with cash or cash equivalent or they will be reported to the U.S. Equestrian Federation, Inc., PCHA and other appropriate association(s). Checks will not be deposited a second time.

UNPAID CHARGES: Any exhibitor leaving the show with an unpaid balance will be billed for these charges and a \$50 billing fee will be added to the total due. Until these charges are settled, all further entries of rider, horse and/or owner will be returned. Rider, owner or horse will not be allowed to compete in WEC event until past account(s) are paid in full.

MANAGEMENT RIGHTS:

- Management reserves the right to make any changes deemed necessary for the safe and efficient conduct of this competition.
- Management reserves the right to interpret all questions and conditions in regard to or arising out of any incident in the show without claims for damages or recourse of any kind.
- All questions not covered in these rules and regulations shall be decided by Show Management and the Show Management's decision shall be final.
- The Management reserves the right to cancel, combine or divide classes for award purposes when less than three horses are entered. Show Management also reserves the right to change the order of the classes as they are listed in the prize list, including change rings or rotate, add or vary officials and changing a class to a different day. Competitors in changed classes will be notified.
- Management reserves the right to vary or add officials and refuse any entry for a cause; to disqualify any exhibitor and/or his or her horse for cause; to cause an exhibitor to forfeit his or her ribbons and winnings for cause; to return any entry and/or stall fee before or during the show for cause; all without being liable for damage or compensation.
- **HAZARDOUS WEATHER/ACTS OF GOD/ACCIDENT/EMERGENCY/PANDEMIC POLICY:** Management reserves the right to cancel any classes due to Hazardous Weather, Acts of God, Accidents, Emergencies or Pandemics. Every effort will be made to reschedule with priority given to any Championship or qualifying classes being offered. No refunds for cancellations due to Hazardous Weather, Acts of God, Accidents, Emergencies or Pandemics.

EXHIBITOR / COMPETITOR RESPONSIBILITY:

- It is the exhibitor's responsibility to verify the accuracy of test scores. Any scoring errors must be reported to the Show Secretary and/or assistant within one hour of the last ridden test for that class. Failure to report any errors within allowed time will mean the error will not be corrected and there will be no change in class placing.
- It is the rider/owner/member responsibility to make sure of their membership status is correct. WEC is not responsible for refunding membership fees that have been submitted to USDF or USEF.
- It is the exhibitor's responsibility to indicate to the Show Management if they are NOT eligible to compete under the judge listed on the show ride time schedule. If the judge has been added/changed, show management will make every effort to make adjustments to schedules as long as we are notified 72 hours BEFORE the first show ride.
- Exhibitors are responsible for presenting themselves to the ring at their designated time and accept the full responsibility for doing so.
- Exhibitors are responsible for knowing the correct show time and their scheduled performance time regardless of announcements or ring stewards. No protest will be upheld, nor ride time changed due to failure of the exhibitor to meeting their responsibilities.
- The rules may have changed from the current USEF Rule Book. It is the competitor's responsibility to check the current USEF Rule Book for any changes. Current rules can be found on www.usef.org.

=====

Horse Class Info / Pony Measurement / Non-Compete Horses / Scratches, Time Changes

=====

Horse - Classes per Day and Class Levels (DR119)

2026 WEC Rules & Information

- Horses under 36 months of age may not compete in any dressage under-saddle class. Proof of horse's age is required for all 3-year olds.
- No horse may be ridden more than once in any Dressage class (including separate divisions or sections of the same class).
- Horses may enter no more than two consecutive levels, Freestyle levels included, at any one competition, even with more than one rider.
- Horses are limited to a maximum of three Dressage rides per day at Fourth Level and below or two Dressage rides per day above Fourth Level. Horses competing at both Fourth Level and Prix St. Georges, or their equivalents, are limited to two Dressage rides per day. Dressage Seat Equitation and Materiale classes are excluded from the maximum limit of rides per day and horses in these classes may compete at any level for which they are otherwise eligible during the same competition.

HORSE RECORDING NUMBERS:

- Except for horses entered ONLY in Opportunity or Introductory classes, every horse entered in this show must have an USDF and/or USEF identification number. Horses without a USDF HID number must include the USDF fee with their entry. If you are riding Qualifying classes, these must be USDF Lifetime numbers and a USEF annual or lifetime numbers.
- If NOT riding qualifying classes, the number may be a USDF HID & USEF HID. If you have used an annual USEF number in the past, this will suffice for USEF, but you must have at least a USDF HID number.
- Horse owner, Business and/or Leasing names must be correctly recorded and verifiable with USDF and USEF.

FEI Pony / Pony Measurement: (DR135)

- If ponies are entered in FEI Pony Test(s) and in need of a USEF measurement card, an appointment for measuring MUST be made with show management at least five days prior to the start of the competition weekend.
- Pony measurements, with veterinarian and TD present, will be determined and communicated to pony competitor/owner as soon as veterinarian and TD availability has been confirmed. Pony measurements will take place in the designated area near WEC Main Office.
- Management will pro-rate the fee charged by the veterinarian among the pony owners. This fee will be the actual charge by the veterinarian and due upon vet visit. Owner/Competitor will pay veterinarian directly for this service.

NON-COMPETING HORSES (including Schooling Horses and Companion Horses):

- Schooling-only entries are subject to the same rules as competing horses with additional restrictions on the times and general use of any facility amenities.
- Any participant's horse(s) not competing, but on the show grounds, must: (1) complete an entry signed by rider, parent, owner/lessee, coach and trainer; (2) pickup and wear an Exhibitor's number; (3) Pay applicable office fee and non-competing horse fee and (4) pay stabling/haul-in fees.
- Non-competing horse (including schooling horse and companion horse) will be accepted on a stabling/space-available basis

SCRATCHES: Prior to the ride time, riders are requested to complete a written scratch request at show office. Scratches at gate will be considered as a scratch for the rest of the show and time slots may be filled. No refunds for scratched entries or classes.

TIME CHANGE WITHIN A CLASS:

- Competitor can request a class change in writing and management reserves the right to accommodate individual class/schedule changes subject to availability.

2026 WEC Rules & Information

- All class changes must be in writing and include contact information – including cell phone. Entry changes by phone message will not be accepted.

WITHDRAWALS: USEF rules require that competitors must request permission of the show secretary prior to withdrawing or removing their horse from the show facility prior to the end of the show. (GR1305.1)

=====

Coach / Trainer / AA & JR/YR / USDF & USEF Memberships
Class Informaiton (Para, Freestyle, Opportunity, USDF &/or USEF Qualifying)

=====

COACH: For purposes of these rules, a coach is defined as any adult or adults on the competition grounds who has or shares the responsibility for instructing, teaching, schooling, or advising a rider, driver, handler, or vaulter in equestrian skills (and Coaching) [See GR108]

Coaches MUST sign the entry competitors form.

Coaching must be done from OUTSIDE of the arena, and in such a way as not to impact the other riders.

NO LOUD/AUDIBLE COACHING IN THE DESIGNATED WARM-UP AREAS.

NO COACHING BETWEEN THE END OF THE COVERED ARENA AND RING ONE, OR BETWEEN RING 3 AND RING 2.

TRAINER: A trainer is the person who has responsibility for the horse on the competition grounds and must sign the entry form. Lessons and/or clinics ARE NOT to be conducted on the show grounds after the start of the competition. Lessons and clinics are beyond the scope of “coaching”.

Adult Amateurs: Only active Federation members may obtain amateur status. Every person who has reached his/her 18th birthday and competes in classes for amateurs under Federation rules must possess current amateur status issued by the Federation. Any person who has not reached his/her 18th birthday is an amateur and does not require amateur status. Adult Amateur entries must enclose a copy of their current USEF membership card.

JR/YR: Open to Juniors and Young Riders only; any rider is eligible until the end of the calendar year in which they reach the age of 21. Only riders ages 14-18 may ride FEI JR Tests. Only riders ages 16-21 may ride FEI YR Tests. Only riders ages 12-16 may ride FEI Pony Tests. Must include birth date on entry form. Specify as Jr or YR, but not both.

Candidates for FEI Championships (NAYC) are responsible for knowing and complying with the North American Youth Championship Qualifying Criteria and Selection Procedures and all FEI and USEF rules regarding participation in qualifying competitions for this championship.

Open Classes: Open classes are open to anyone eligible to compete, including professionals.

USEF MEMBERSHIP STATEMENT

Life, senior active and junior active members shall be eligible to participate in all classes at Regular Competitions, Eventing Competitions at the Modified Level or above and Combined Driving Competitions at the Advanced Level, Dressage, Reining and Vaulting Competitions and Endurance Rides. A non-member may participate as a handler, rider, driver, owner, lessee, or agent at Regular Competitions, Eventing Competitions, Dressage Competitions, Reining Competitions and Combined Driving Competitions upon payment of a Show Pass fee. Participants in the following classes are exempted from the Requirements of this rule: 1) leadline; 2) exhibitions; 3) games and races; 4) classes for 4-H members; 5) walk trot and academy classes (academy classes are classes limited to horses used regularly in a lesson program); 6) USDF introductory level tests, pas de deux and quadrille classes; 7) assistant handlers in Dressage Sport Horse Breeding classes

2026 WEC Rules & Information

USEF & USDF Membership: The proof of membership numbers must be in the form of either their actual membership/registration cards or a facsimile of them. Proof of membership must be included with entry form. Please provide the USEF/USDF Master Verification ([www. Eqverification.org](http://www.Eqverification.org)) although membership cards or photocopies of cards are still acceptable. Failure to provide proof of USEF and/or USDF membership be an incomplete entry and possibly have non-member fees. Members that are unable to produce the USDF memberships cards/registrations or a facsimile will be asked to sign an affidavit and pay the applicable affidavit fee. See also USDF Recognition page.

USEF SHOW PASS: Effective 12-1-2022 any rider, handler, driver, or owner are limited to ONE Show Pass purchase annually (December 1-November 30). The Show Pass is only good for ONE competition. A USEF Show Pass will be available for purchase by exhibitors on-line only, within 7 days of the show's start date. Competitions will not accept payment for show pass fees and therefore this fee will not appear on the entry blank.

Trainers and Coaches are no longer eligible to be non-members or use a Show Pass. Trainers and Coaches must be members. Individuals, including parents who are signing as trainers on behalf of a minor, who are participating as a trainer or coach are not eligible for a Show Pass and must obtain a Senior Competing membership to participate in a USEF-licensed competition.

Foreign Competitors (including Canada): Foreign participants must join USEF as a Competing Member to Participate in National Competitions. Please also see USDF requirements.

Para Equestrian Classes: Para Equestrian riders must have current International (FEI) or National (USEF) Dispensation Certificate indicating classification status. Riders, horses and owners are no longer exempt USDF membership requirements. All tests for para equestrians are ridden in a standard (20m x 60m) arena, except Grade I- III are ridden in a shortened (20m x 40m) arena. For more info see <https://inside.fei.org/> or USEF.org. and USEF Rulebook Subchapter DR-3.

GAIG/USDF QUALIFYING CLASSES (membership/registration requirements)

- Riders and owners must have an active USEF Membership. Riders are required to have a USDF Participating Membership; Owners may have a USDF Participating or Business Membership. Group membership is not sufficient.
- Horses must be Annual or Lifetime Recorded with USEF and USDF Lifetime Registered, an HID is not sufficient.
- Great American qualifying entries must include a copy of the horse USEF and USDF registration, and all rider's and owner's USEF and USDF card(s).
- To compete in a qualifying class for GAIG/USDF Regional Dressage Championships, declare the qualifying ride on entry form. Please indicate that the class is to count for qualifying by placing a Q after the class number. Qualifying will not require a separate ride in the class. Fee is class fee plus Q-fee and must be paid prior to start of the class.

Freestyle Prerequisite Requirements: Prior to the competition where the horse/rider combination is entered to ride a freestyle class, rider/horse combination must have achieved a minimum qualifying score (ref DR129.9).

Effective December 1, 2019 (DR129.9) Except for USEF/USDF Championship classes and for FEI Pony Riders, FEI Junior, FEI Young Rider, and FEI Para-Equestrian Freestyles, in order to enter a freestyle class at any level, a horse/rider combination must have received a minimum score of 63% for Training through Fourth levels and 60% for FEI levels in the highest test of the declared freestyle level or any test of a higher level at a USEF/USDF licensed Dressage Competition, Federation Licensed or FEI recognized Dressage Competition, or "open" Dressage class (i.e. open to all breeds) at a Federation Licensed Competition held prior to the competition where the horse/rider combination is entered to ride a freestyle class.

A photocopy of the test verifying eligibility, or copy of the USDF score verification, must be submitted with the entry for a freestyle class. Specify level of freestyle on your entry.

2026 WEC Rules & Information

Freestyle Sound Check / Music Submittal:

- It is the responsibility of the rider to have a standard-size, good quality CD submitted to the Show Secretary a check-in. Music should be in a non-proprietary format useable on a commercial CD player. Rider and Horse names must be on CD. Contact show management for alternate arrangement/format options.
- Sound check will be published in the show office and/or ride times.
- Management will not be responsible for music left after the closing of the show.

OPPORTUNITY CLASSES: Opportunity classes are intended for entry level participants. Horses, riders, owners, trainers, and coaches participating only in Opportunity classes are exempt from Federation and affiliate organization membership and Horse Identification (HID) requirements and non-member fees. Riders are required to list the Federation membership number if the participant is a member. Horses entered in Opportunity classes are subject to and must comply with all Drugs & Medications rules, including vaccinations, and are subject to testing but are exempt from the Federation fee.

- Cross-entry between Opportunity and other classes is allowed; however, the above exemptions apply only to the Opportunity Classes.
- Opportunity class riders may compete wearing breeches and shirts of any color as permitted in DR120. Jackets or vests of any type are allowed but not required and neckwear may be worn only if the rider chooses to compete in a riding jacket. Boots and protective headgear are required as specified in DR120.1.6.
- Scores earned in Dressage Opportunity classes may not be used towards USEF or USDF awards or programs. See USEF GR821 for complete rules.
- Scores from Opportunity classes may not be used toward the WEC finals.

=====

MAAPP & Safe Sport / Horse Vaccinations / Biosecurity

=====

MAAPP & USEF SAFE SPORT

All USEF Life and Senior Active members, as well as participants who have regular contact with minor athletes, are required to comply with the U.S. Center for SafeSport training requirement to be eligible to participate in the competition. All participants must adhere to the U.S. Center for SafeSport Code, USEF Safe Sport Policy, and the Minor Athlete Abuse Prevention Policies. More information about these can be found at www.usef.org.

(GR1303) The Federation Safe Sport Policy defines a "Federation Participant" as any Federation member, or non-member, who participates in or attends a Federation Licensed Competition or sanctioned event. The Federation's Safe Sport Policy can be found at www.usef.org and the U.S. Center for SafeSport Code can be found at www.safesport.org. Every Federation member and Federation Participant shall abide by the Federation's Safe Sport Policy and the U.S. Center for SafeSport Code, which can be found at www.usef.org and www.safesport.org respectively. Beginning January 1, 2019, every Federation adult member (18 years of age and over) with a "Competing Membership" shall complete Federation-approved Safe Sport Training in accordance with the U.S. Center for SafeSport's Education & Training Policies.

Vaccination Requirements and USEF Biosecurity Requirements

VACCINATIONS/HEALTH CERTIFICATES: (GR844 & 845)

No horse will be permitted on the grounds without a valid health certificate or proof of vaccinations (Equine Influenza Virus & Equine Herpes Virus (Rhino pneumonitis) within 6 months prior to arriving. (GR845)

Exhibitors are reminded of USEF's vaccination policy, applicable to horses more than 7 months of age. All horses must have proof of Equine Influenza and Equine Herpes Vaccinations (Rhino pneumonitis) within 6 months of show date.

2026 WEC Rules & Information

Health certificate and documents must list the same horse name and description as is listed on the entry blank and on the USEF horse identification or recording documents (GR906).

The completed and signed vaccination document(s) must be submitted with your entry. Competition Management reserves the right to review vaccination documentation. Non-compliant entries may be quarantined or denied permission to unload and will not be allowed to compete nor to mingle with other horses. No refunds will be given if right to compete is denied because the Vaccination Record is missing or incomplete. Whether the horse is vaccinated by a veterinarian, or by an owner or agent, or is exempt for medical reasons, documentation is required. For your convenience a downloadable form is available at: www.usef.org. Search 'Equine Vaccination Record'.

COGGINS AND CERTIFICATE OF VETERINARY INSPECTION ARE ONLY REQUIRED FOR HORSES ARRIVING FROM OUT OF STATE!! The State of Washington requires current (6 month) health certificate from the State of origin, identification papers on the horse and Coggins test. The Washington State Department of Agriculture at (360) 902-1878 has the most recent information.

Horse Medication – Exhibitors should exercise extreme caution before medicating their horses and should be aware of the US EQUESTRIAN rules governing drugs and medications. Any questions about the use of certain medications and regarding Rule IV should be directed to the USEF Equine Drugs and Medications Program, 956 King Ave, Columbus, Ohio 46212 Phone: (800) 633-2472

Competitor Requirements (GR870)

All riders, drivers, vaulters, handlers, owners, trainers, coaches, grooms, agents, and lessors must abide by and comply with biosecurity measures and equine health requirements imposed by the Federation, Competition Management, and local, state, and federal animal health officials.

Competition Management Requirements (GR871)

Competition Management must ensure licensed competitions are conducted in accordance with all applicable Federation, local, state, and federal animal health requirements.

Mandatory Reporting of Febrile Horses (GR873)

The trainer, as defined by Federation rules, or the owner if the trainer is unavailable, or the rider if the trainer and owner are both unavailable, shall notify the competition veterinarian and Competition Management as soon as possible but no later than two hours after detection of any febrile horse or pony. A febrile horse or pony is one with an unexplained temperature above 101.5°F at rest (i.e. two hours after exercise or transport). If a febrile horse or pony is detected outside of competition hours or before the competition begins, notification must occur as soon as possible but no later than one hour detection of the fever above 101.5°F.

=====

USEF MOTORIZED VEHICLE STATEMENT / SHARPS DISPOSAL

=====

USEF MOTORIZED VEHICLE STATEMENT (GR1301.7 & 1301.8)

Minors who do not have a valid driver's license which allows them to operate a motorized vehicle in the state in which they reside will not be permitted to operate a motorized vehicle of any kind, including, but not limited to, golf carts, motorcycles, scooters, or farm utility vehicles, on the competition grounds of licensed competitions. Minors who have a valid temporary license may operate the above described motorized vehicles as long as they are accompanied by an adult with a valid driver's license. The parent/legal guardian or individual who signs the entry blank as a parent or guardian of a minor operating a motorized vehicle in violation of this rule are solely responsible for any damages, claims, losses or actions resulting from that operation. Violations of this rule will be cause for

2026 WEC Rules & Information

penalties against those responsible for the child committing the offense. Wheelchairs and other mobility assistance devices for individuals with disabilities are exempt from this rule.

The unsafe use of personal electronic transport devices, as determined by the competition officials and management in their sole discretion, that do not require a driver's license to operate, including but not limited to segways, hover boards, and single wheeled scooters is prohibited on competition grounds.

Operating such devices in areas where people gather may be deemed "unsafe use" if there is a risk of harm to others. If the operator of the device is a minor, the parent/legal guardian or individual who signs the entry blank as a parent or guardian of a minor operating the device in violation of this rule is accountable and may be subject to penalties. Wheelchairs and other mobility assistance devices for individuals with disabilities are exempt from this rule.

USEF POLICY ON SHARPS DISPOSAL (GR1210.4)

Competition management shall place a minimum of one sharps container per each competition, whether or not stabling is provided. Additionally, at least one sharps container per fifty occupied stalls for the disposal of needles and other disposable sharp instruments in convenient locations in barns housing competition horses. It is competition management's responsibility to replace such containers when full and dispose of them properly. Competition management may fine any individuals including trainers, owners, exhibitors, or their agents up to \$100 for improper disposal of needles or other sharp disposable instruments. Competition management will place a notice of this requirement either in its prize list or on a specific handout given to trainers on check in at the competition. If local law has different requirements, local law will prevail. Competitions failing to comply with placing the required number of containers on the show grounds will be considered in violation of the rules and may be subject to penalty as determined by the CEO or his designee and/or the Hearing Committee.

For the WEC competitions, Sharps containers are located at the ends of each barn aisle, in the show office and at the ends of the portable stabling areas.

=====

Whidbey Equestrian Center 2026 Series Championships Open, Adult Amateur, Jr/Yr Divisions
Held during the August 2026 "Summer's End" Dressage Show





USDF Horse Welfare Statement

As those engaged in equestrian sport, we are committed to ensuring our horses receive the best possible care to the best of our ability. We acknowledge that we are the caretakers of our horses and as such we are committed to always, without exception, treating our horses with dignity, fairness, kindness, and understanding.

We realize that horses, whether in a herd or as an individual, will communicate contentment, fear, pain and confusion in the only way they can, which often takes the form of physical reactions that can be misinterpreted and misunderstood.

Therefore, we believe it is our obligation to seek to understand our horses with the goal of providing care and training methods that are never the manifestation of anger, frustration or cruelty. We are committed to these principles at all times, whether on or off the show grounds.

We are committed to humane treatment and application of these principles on behalf of all animals including but not limited to horses, donkeys, mules, companion animals, and pets. Lack of humane treatment, whether the result of actions taken, or by care withheld, will not be tolerated.

United States Dressage Federation
4051 Iron Works Parkway, Lexington, KY 40511
Phone: 859-971-2277, Fax: 859-971-7722
usdressage@usdf.org, www.usdf.org

Revised 4/2025

ATTENTION COMPETITORS

Each competitor is responsible for supplying Management with correct applicable numbers (USDF and USEF) for horse, owner, rider, and trainer, before the day(s) of the competition.

The scores of competitors who fail to supply correct numbers may not be counted toward national awards.

USDF Membership Benefits: USDF is dedicated to education, the recognition of achievement, and promotion of dressage. For details on member benefits, including educational programs, awards, and other opportunities, refer to the *USDF Member Guide* or the USDF website at www.usdf.org.

**This
competition
is recognized
by USDF
for 2026**

Membership Requirements for USEF-licensed/USDF-recognized Competitions: Owners and riders, including foreign riders and owners who are not residents of the US, wishing to participate in a USEF-licensed/USDF-recognized competition as a rider or owner/lessee, must have either a USDF Group Membership (GM), Participating Membership (PM), or have a USDF Non-Member (NM) identification number and pay the USDF Non-Member (NM) fee. (Note: USDF Business Members can own horses but cannot compete as riders with their USDF Business Membership.)

Horses competing at USEF-licensed/USDF-recognized competitions must have either a USDF Horse Identification (HID) number or a USDF Lifetime Horse Registration (LHR). Proper credentials or verification certificates must be presented to the competition secretary.

Riders and owners wishing to participate in a USEF-licensed/USDF-recognized competition, and not able to present the competition secretary with verification of a USDF membership or NM identification, and USDF LHR or USDF HID, must complete a USDF Competition Affidavit Form and pay the \$5 affidavit filing fee. A copy of a completed affidavit form from another competition may also be used for verification purposes for up to 60 days. (Exception: Affidavits cannot be used at Great American Insurance Group/USDF Regional Dressage Championships.)

Exceptions:

- Horses competing only in Individual Breed Classes (IBCs) at DSHB competitions, sires and dams of horses in DSHB group classes, where those sires or dams are not actually competing in the same competition, horses competing only in breed restricted dressage or DSHB classes at Regular Competitions (e.g. all Arabian, all Friesian, or all Morgan classes), or in USDF Introductory Level tests, pas de deux or quadrille, are exempt from this requirement. Also exempt are horses ridden in leadline, exhibitions, games and races, classes for 4-H members, walk-trot, academy, and opportunity classes.
- Riders and owners/lessees competing only in classes which are exempt from the USDF HID requirements are also exempt from the USDF NM identification number and NM fee requirements. Also exempt are handlers of horses competing in DSHB In-Hand or Group classes.

Memberships Defined

Participating Membership (PM): A membership issued to an individual directly by USDF. The membership year is December 1 through November 30. PMs are available for 1-year (\$100), 5-years (\$400), or life (\$2,000). A USDF Youth Participating Membership (YPM) is available for individuals who have not reached their 21st birthday by December 1 of the current membership year (\$80). A PM allows the member to compete at USEF-licensed/USDF-recognized competitions and to participate as a rider and/or owner/lessee for all Adequan®/USDF Year-End Awards and the Great American Insurance Group/USDF Regional Dressage Championship program.

Group Membership (GM): A membership issued to an individual by USDF when the member name and dues are submitted to USDF through an affiliate Group Member Organization (GMO). The GM year begins December 1 and ends November 30. A GM allows the member to compete at USEF-licensed/USDF-recognized competitions and participate in the USDF Rider Awards Program.

Business Membership (BM): A membership that runs December 1 through November 30 and is issued to a business or organization directly by USDF. The USDF BM (\$280) offers a wider variety of advertising benefits. BMs satisfy requirements of horse ownership only.

Non-Member (NM) Identification Number: For each USDF NM owner/lessee and USDF NM rider there will be a USDF NM fee of \$55 per competition that must be collected by the show secretary and submitted to USDF, along with the USDF Report of Fees document and the \$5 affidavit fee and Competition Affidavit Form if the person cannot provide a copy of their USDF NM card. Owners/lessees or riders exempt from the NM number requirements are also exempt from paying the USDF NM fee. If there are multiple owners of a horse and all are NMs, only one of the owners must pay the NM fee. If the horse has at least one owner who is a current USDF PM, GM, or BM there is no NM fee assessed. Competition management will be invoiced for all applicable USDF NM fees not received with the USDF post-competition paperwork, along with a report listing all USDF NMs. Competition management is then required to submit the NM fees within 30 days to the USDF. An individual with a USDF NM identification number is not eligible for any USDF membership benefits. Once a USDF NM number has been assigned, a USDF NM card can be obtained from the USDF website.

Horse Identification (HID) Number: A one-time tracking number for horses (\$45). Scores earned by a horse with an HID number will be recorded but will NOT be counted towards Adequan®/USDF Year-End Awards. A horse with an HID number is not eligible to compete in Great American Insurance Group/USDF Regional qualifying or championship classes. An HID number can be upgraded to a Lifetime Horse Registration (LHR) for a fee of \$95. If a horse has a USDF LHR it does not need an HID number. An HID number is a one-time fee that does not need to be renewed.

Lifetime Horse Registration (LHR): A horse with an LHR (\$140) is eligible for Adequan®/USDF Year-End Awards, and eligible to compete in Great American Insurance Group/USDF Regional qualifying and championship classes, assuming requirements for the owner and rider are met. If a horse has an LHR it does not need an HID number. An LHR does not need to be renewed.

How to Join USDF

Applications for USDF Participating Membership (PM), Business Membership (BM), Horse Identification (HID) number, and Lifetime Horse Registration (LHR) may be found in the following locations:

- On the USDF website: www.usdf.org. You can submit the application online or download the form.
- In the show office at USEF-licensed/USDF-recognized competitions classified by USEF as Dressage Competitions, and Regular Competitions which are open to all breeds.
- By calling or writing the USDF office at (859) 971-2277, 4051 Iron Works Parkway, Lexington, KY 40511

The effective date of membership is the date the form and correct fees are received in the USDF office or, if applying at a competition, the date accepted by the competition secretary, provided the application is signed and dated by the competition secretary, member, and/or horse owner on that same day.



2026 Great American Insurance Group/USDF Regional Dressage Championships

A single Regional Dressage Championship program organized by the United States Dressage Federation (USDF), and recognized by the United States Equestrian Federation, Inc. (USEF), will be held in each of the nine USDF regions. In addition, Alaska and Hawaii may each hold state championships if an official request from a Group Member Organization (GMO) is received by April 1 of the prior year. The Regional Championship Program Rules can be found on the USDF website at www.usdf.org. Please refer to the 2026 USDF Member Guide for the comprehensive list of rules and requirements for this program.

Membership/Registration Requirements for Qualifying and Championships

All memberships and registrations/recordings must be correct and current at the time qualifying scores are earned and at the time of the championships.

Rider:

- Must have a USDF Participating* Membership (PM).
- Must have a USEF membership (Active or Life).

Horse:

- Must have a USDF Lifetime Horse Registration (LHR).
- Must have a USEF (Annual or Lifetime) Horse Recording.
- USDF horse registration and USEF horse recording must be in the name(s) of the current owner(s) or lessee(s).

A horse is not required to have breed registry papers.

- Horses must be entered in qualifying and championship classes under their official recorded names and ownership as specified in USEF GR1102.3, and transfers of ownership or lease registrations must be completed in compliance with USEF rules GR1105 and GR1108 prior to the competition in order for the horse to compete under the name of the new owner or lessee. (USEF DR127.2)

Owner:

- Must have a USDF Participating or Business Membership and a USEF membership (Active or Life Membership or Annual Recorded Farm/Business (with Senior Active Competing Farm Owner in good standing)). If the horse has more than one owner, at least one owner must have both active USEF membership and active USDF Participating or Business Membership and must be the owner of record with USEF and USDF. For a business or farm to be the valid owner under this requirement, it must be listed as an owner of the horse with both USEF and USDF.

* PMs are USDF members who join USDF directly. USDF Group Members (GM) are ineligible.

Minimum Qualifying Scores: One set of nationally-standardized qualifying scores has been established for all USEF/USDF Regional Championships, for Training Level through Grand Prix, in three divisions: open, adult amateur and junior/young rider.

The minimum percentages are as follows:

	OPEN	AA	JR/YR
Training Level (Test 3)	68%	63%	63%
First Level (Test 3)	66%	62%	62%
Second Level (Test 3)	64%	61%	61%
Third Level (Test 3)	62%	60%	60%
Fourth Level (Test 3)	62%	60%	60%
Prix St. Georges	62%	60%	60%
Intermediate I	62%	60%	60%
Intermediate II	62%	60%	60%
Grand Prix	60%	60%	60%
FREESTYLE	OPEN/Jr/YR	AA	
First Level	65%	65%	
Second Level	65%	65%	
Third Level	65%	65%	
Fourth Level	65%	65%	
Intermediate I	65%	65%	
Grand Prix	65%	65%	

ev 6/30/2025



MAAPP

MINOR ATHLETE ABUSE PREVENTION

LEARN ABOUT MAAP POLICIES



Safe Sport Training



Local Travel



One-On-One Interactions



Social Media & Electronic Communications



Read about these & more at usef.org/MAAPP

REPORT MAAP POLICY VIOLATIONS



usef.org/safe-sport/reporting

859-225-6915 or Text Anonymously 855-682-8733



CHIP CHALLENGE RETURNS!!

We want to recognize the achievements through the season

How Does It Work?

Earn Your First WEC Chip and Claim A Token Bag

Then Begin Collecting Chips for the following:

For every 8, 9, or 10 on a dressage test = 1 WEC chip, or ..

For every score of 70.00% or above = 1 WEC chip

Collect WEC chips and turn them in for cool swag

& prizes at the end of show season



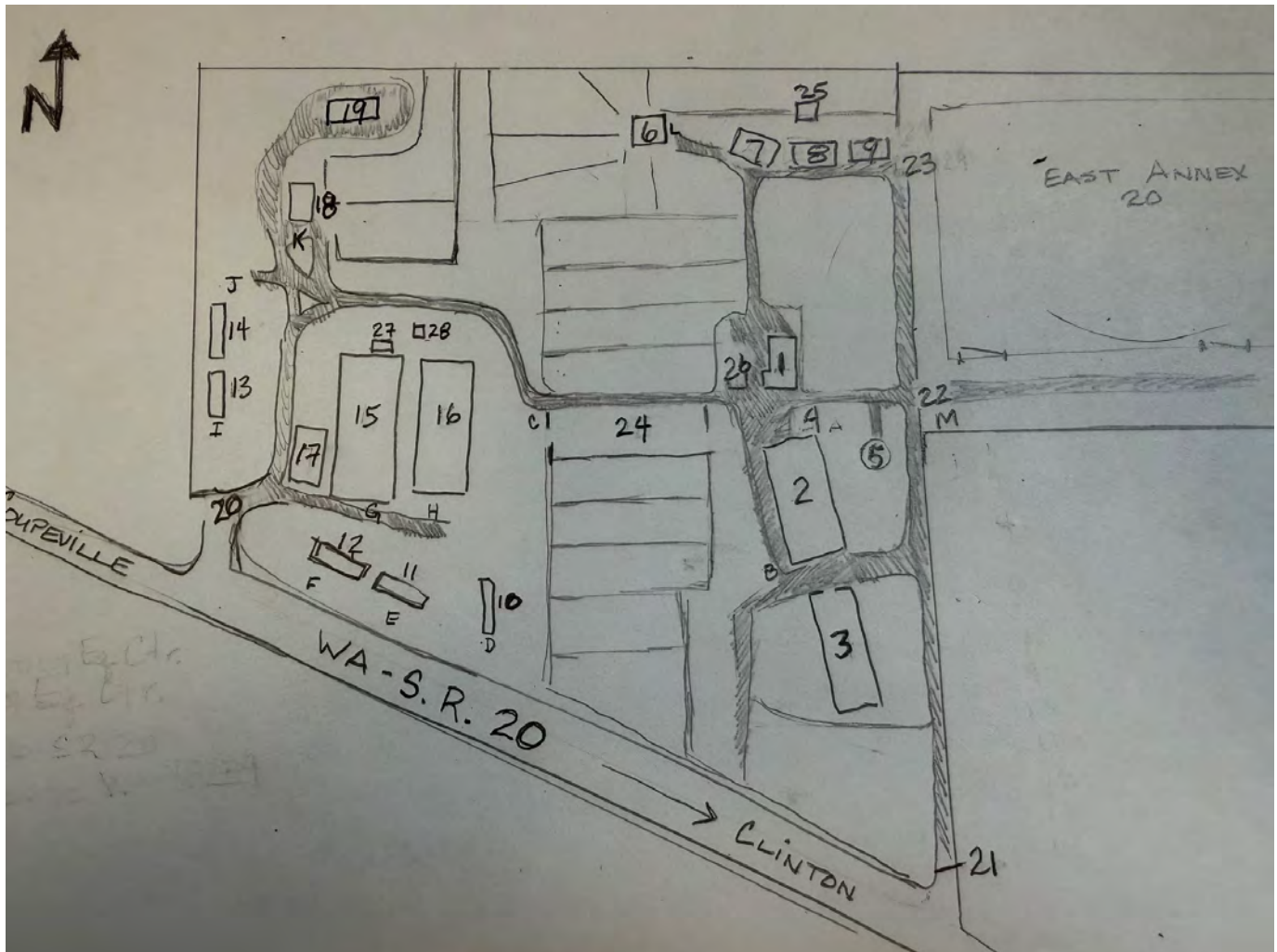

ID	Name
1	Main Barn / Facility Office
2	Covered Arena / Barn
3	Competition - Ring One
4	Concession Stand
5	Round Pen
6	Upper Barn
7	Main House (Private)
8	Shop (Private)
9	Equip Bldg (Private)
10	Portable Barn A
11	Portable Barn B
12	Portable Barn C
13	Portable Barn D
14	Portable Barn E
15	Ring Three (Warm Up)
16	Competition - Ring Two
17	Lounging Area
18	West Wing Barn
19	West House (Private)
20	Main Entrance
21	Service Entrance
22	South West Entrance - Annex
23	North West Entrance - Annex
24	Hoof & Foot Walk Thru Path
25	Well House
26	Officials Meeting Area (HQ)
A - M	Port-A-Potty Locations