

**Owner** EUCLID LAND REUTILIZATION PROGRAM  
**Address** 24025 GLENBROOK BLVD  
 EUCLID, OH. 44117  
**Land Use** (5100) R - 1-FAMILY PLATTED LOT  
**Description** AT-TR SHERFRES 0003 ALL 65008017  
**Neighborhood Code** 14111

**SKETCH**

**MAP VIEW**

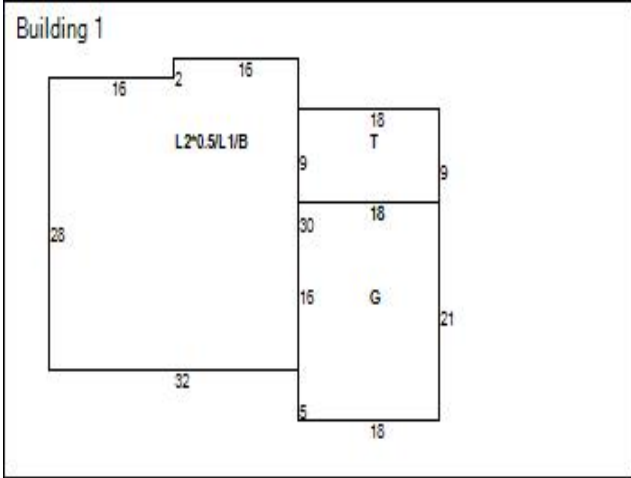

Map Image

**BUILDING INFORMATION**

Building Record Number	1	Occupancy	1-FAMILY	Story Height	1.5
Style	BUNGALOW	Year Built	1950	Exterior Walls	BRICK
Condition	AVERAGE	Construction Quality	C / AVERAGE	Roof Type	GABLE
Roof Material	ASPH-SHINGLE	Heat Type	FORCED-AIR	Air Conditioning	NONE
Attic Type	UNFINISHED	Basement Type	BASEMENT	Basement Square Feet	928
Basement Finished	No	Rooms	4	Bedrooms	2
Bathrooms (Full/Half)	1/1	Garage Type	ATTACHED	Garage Capacity	2
Year Garage Built	1956	Garage Size	378	Living Area Basement	
Living Area 1	928	Living Area 2		Living Area Upper	
Living Area Total	928	Floor Location		Party Wall	

**LAND**

**VALUATION**

Code	Frontage	Depth	Acreage	Sq Ft
PRM	60	188	0.26	11,280

2025 Values	Taxable Market Value	Exempt Market Value	Abated Market Value	Assessed Taxable Value

**PERMITS**

**IMPROVEMENTS**

Tax Year	Reason	Tax Change	Exempt Change	Percent Complete	Reinspect	Notes

Type	Description	Size	Height Depth

**SALES**

Date	Buyer	Seller	Price
3/5/2026	EUCLID LAND REUTILIZATION PROGRAM	Yuhas, Mary D	\$0
3/4/1994	Yuhas, Mary D	John G Yuhas	\$0
9/12/1980	John G Yuhas	Yuhas Jno G & Mary D	\$0
1/1/1975	Yuhas Jno G & Mary D		\$0