



# OZ STAR EMU SERIES 20FT FAMILY TRIPLE

TRUSTED QUALITY CARAVANS FOR UNRIVALLED ADVENTURES

The affordable 20FT Oz Star Emu Series Family Triple lets you explore the country's beauty with unbeatable comfort and style.

## 5 YEARS WARRANTY

PEACE OF MIND. **BUILT IN.**

**5 YEARS ROADSIDE ASSIST**

INCLUDED ON EVERY OZ STAR CARAVAN



### Every New Oz Star Caravan Includes:



**5 YEARS WARRANTY**



**AUSTRALIA-WIDE APPROVED REPAIR NETWORK**



**EMERGENCY ACCOMMODATION COVER**



**NATIONAL WARRANTY COMPANY BACKING**



**FAST & SIMPLE CLAIMS PROCESS**



**5 YEARS ROADSIDE ASSIST**

### Key Features



**Sleeps 5**



**Queen Bed + Triple Bunks**



**300Ah 12V Lithium Battery**



**800W Solar Panels**



**Diesel Heater + A/C**



**240L Fresh + 120L Grey Water**



**Ensuite Shower & Toilet**



**Premium Construction**



## BUILT STRONG FOR ADVENTURE

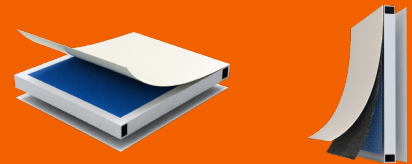

- 44mm Composite Sandwich Roof Construction
- 47mm Composite Sandwich Side Wall Construction
- Thickened Aluminium Interlocking Frame
- Thickened Sandwich Composite Panels

- CNC Solid Plywood Furniture
- 2mm High-Gloss Fibreglass Exterior
- 1.5mm Premium Fibreglass Interior Panel
- 5 Year Structural Warranty



**Exceptional Durability**

Built to withstand Australia's toughest conditions



**Superior Insulation**

Excellent thermal performance for all-season comfort



**Strength and Reliability**

Designed and engineered for long-lasting performance



**Built for Australia**

Tested for Australian roads, climates and adventures



**Call 1300 999 888**



Locations in Sydney, Brisbane, Perth, Melbourne, and Adelaide



info@ozstarcaravans.com.au



www.ozstarcaravans.com.au

# OZ STAR EMU SERIES 20FT FAMILY TRIPLE

## INCLUSIONS

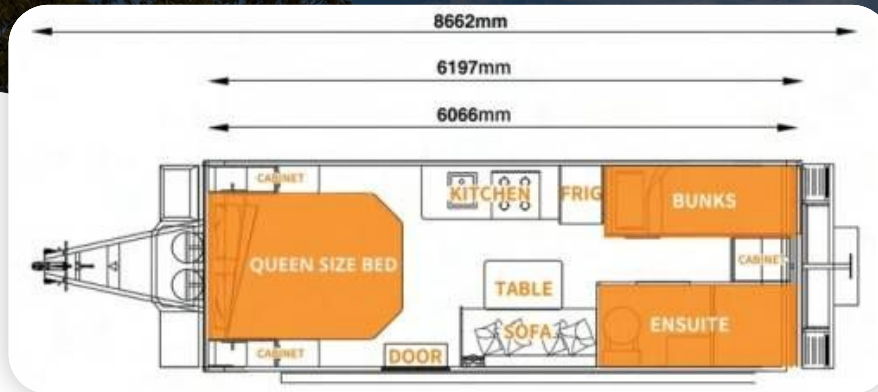

## Specifications

- ATM 3500kg
- GTM 3230kg
- Ball Weight 250kg
- Payload 630kg
- Height 3100mm
- Width 2200mm
- Tare Weight 2860kg

## Interior

- High-Density Foam Mattresses
- Optional - New Inner Spring Mattresses
- Queen Bed (1500 mm x 2000 mm)
- Top Bunk (710 mm x 1900 mm)
- Bottom Bunk (710 mm x 1900 mm)
- Third Bunk (Optional) (710 mm x 1900 mm)
- Ensuite, Separate Shower and Toilet
- Leatherette Seating
- Environmentally Friendly Vinyl Flooring
- Environmentally Friendly Square Benchtops
- Living Area Cupboards and Draw System includes Double-sided Acrylic Doors
- Double Glazed Window Including Block-out and Mesh Blinds

## Electrical

- Integrated Oz Star Monitoring Control Panel
- 300Ah 12V Lithium Battery in External Box (5yr warranty)
- 3000W SMART CONTROL RV Inverter
- 800W Roof Solar Panels MPPT Controlled
- Car Play Android Auto MP5/HD Video Player
- Internal and External Marine Sound System
- Internal and External 12V & 240V Power Outlets
- Internal and External LED Lighting
- 22" Smart TV
- 12V Wall-Mounted Fan

## Plumbing

- Fresh Water Tank - 240L
- Grey Water Tank - 120L
- 12V Seaflow Water Pump
- Gas Hot Water System
- Internal Stainless Steel Black Sink Including Cobbe Matte Black Fittings
- Internal Ensuite - Separate Shower and Toilet
- External Shower Box
- Certified Plumbed Gas to Internal Kitchen
- External Gas Bayonet Point

## Chassis

- Galvanised Hot-Dipped Chassis & Front Draw Bar
- Dual-sided Independent Suspension Including 265/75R 16LT Mud Terrain Tyres
- 12' Electric Brakes
- 1 Spare Tyre
- Off-Road Hitch
- AL-KO Jockey Wheel
- 2 x 4.5kg Gas Bottle Holders in Middle Tool Box - Lockable
- Heavy-Duty Stabilising Legs
- Dual Front Storage Boxes
- 7 Pin Flat Trailer Connection (Optional 7 Pin Round)
- Electric Brake Away System
- Australian Standards Hand-brake
- LED Body Running Lights (Brakes, Indicators and Clearance Lights)

## Exterior

- Marine Grade Composite Caravan Body
- Aluminium Pattern Protection Side Skirting
- RV Special Entry Door Including Anti-Mosquito Security Screen Door
- Oz Star 4600mm Heavy Duty Awning - Roll-out Awning
- Double Glazed Windows
- RV Blinds Including Anti-Mosquito Net and Sunshade
- Front-Mounted 200W LED Light Bar
- Wireless Reverse Camera and Screen