

# INSTALLATION INSTRUCTIONS

## FOR WATERPROOF WOOD FIBER FLOORING



**IMPORTANT!** Read all instructions before you begin. Improper installation will void the warranty.

**IMPORTANT HEALTH NOTICE:** SOME OF THE BUILDING MATERIALS USED IN THIS HOME (OR THESE BUILDING MATERIALS) EMIT FORMALDEHYDE. EYE, NOSE, AND THROAT IRRITATION, HEADACHE, NAUSEA, AND A VARIETY OF ASTHMA-LIKE SYMPTOMS, INCLUDING SHORTNESS OF BREATH, HAVE BEEN REPORTED AS A RESULT OF FORMALDEHYDE EXPOSURE. ELDERLY PERSONS AND YOUNG CHILDREN, AS WELL AS ANYONE WITH A HISTORY OF ASTHMA, ALLERGIES, OR LUNG PROBLEMS, MAY BE AT GREATER RISK. RESEARCH IS CONTINUING ON THE POSSIBLE LONG-TERM EFFECTS OF EXPOSURE TO FORMALDEHYDE. REDUCED VENTILATION MAY ALLOW FORMALDEHYDE AND OTHER CONTAMINANTS TO ACCUMULATE IN THE INDOOR AIR. HIGH INDOOR TEMPERATURES AND HUMIDITY RAISE FORMALDEHYDE LEVELS. WHEN A HOME IS TO BE LOCATED IN AREAS SUBJECT TO EXTREME SUMMER TEMPERATURES, AN AIR-CONDITIONING SYSTEM CAN BE USED TO CONTROL INDOOR TEMPERATURE LEVELS. OTHER MEANS OF CONTROLLED MECHANICAL VENTILATION CAN BE USED TO REDUCE LEVELS OF FORMALDEHYDE AND OTHER INDOOR CONTAMINANTS. IF YOU HAVE ANY QUESTIONS REGARDING THE HEALTH EFFECTS OF FORMALDEHYDE, CONSULT YOUR DOCTOR OR LOCAL HEALTH DEPARTMENT.

### CAUTION



- Use safety glasses and gloves when cutting wood fiber floors. Wood fiber floors will create wood dust; always use a protective dust mask and cut the product in a well-ventilated area.
- Never tap long edges; tap only as instructed in this guide.
- Never use tools designed for other wood fiber flooring installation systems.
- Never wax, polish, or use abrasive cleaners on wood fiber floors.
- This wood fiber flooring product is not suitable for use in areas where the floor is prone to continuous moisture, such as but not limited to steam rooms and saunas. Do not install in rooms that have floor drains or sump pumps.
- Do not install cabinets or affix objects (e.g., kitchen islands) to or through the wood fiber floor. Cabinets should be installed before the wood fiber floor or affixed to the wall to prevent pinning the wood fiber floor.
- Inspect every plank for defects or damage before installing it.
- Do not tap wood fiber planks directly. Always tap against a scrap piece to protect the installed planks. Tap lightly and evenly, as tapping with excessive force can result in damage.

### INTENDED USE

These wood fiber floors are designed to be used in interior, climate-controlled areas. Installation temperatures should be at a minimum of 64°F (18°C), and relative humidity should be between 50% and 60%. These wood fiber floors can be installed on grade, above grade, or below grade. Wood fiber floors are designed as a floating floor system and are not to be nailed, screwed, glued, or attached in any way to the subfloor.

## TOOLS AND SUPPLIES

- Saw (Power Saw, Hand Saw, Or Guillotine-type Cutter)
- Measuring Tape
- Carpenter's Square
- Utility Knife
- Pencil/marker
- Pull Bar
- Tap Block
- Hammer/Mallet
- 3/8" (10mm) Spacers
- Omnicchoice Vapor Bloc Underlayment (Required For Warranty).
- 2" (51mm) Wide Moisture-resistant Adhesive Tape
- Flexible 100% Silicone Caulking (Wet Area Installation Requirement)
- 1/2" (12mm) and 3/8" (10mm) Compressible PE Foam Backer Rod (Wet Area Installation Requirement)
- Safety Glasses
- Dust Mask (Niosh-designated)
- Gloves

## KEY INSTALLATION CRITERIA

**ACCLIMATION:** Store unopened cartons in the installation area for 48 hours (96 hours in especially dry or humid conditions). Cross-stack boxes and store them away from outside walls, heat sources, and air conditioning vents.

**NOTE:** *Acclimation temperature should be greater than 64°F (18°C), and relative humidity should be between 50-60%. (See Figure A)*

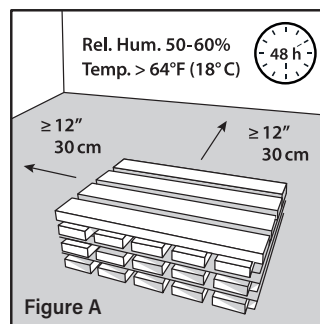

**EXPANSION GAP:** Leave a 3/8" (10mm) expansion gap between the edge of the flooring and walls or other vertical objects (e.g., plumbing, cabinets, etc.). Baseboards or finishing trims will cover this space once your installation is complete. (See Figure B)

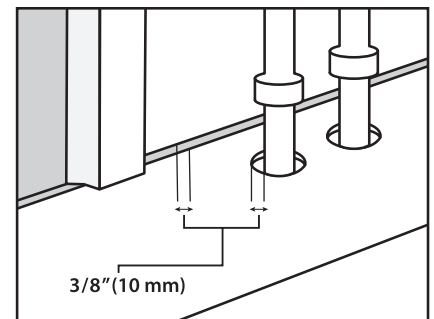
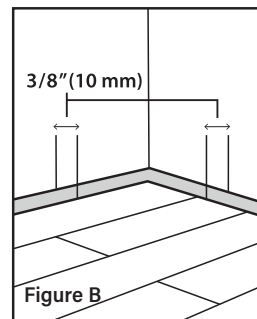

**MAXIMUM SPAN:** Installation span length and width should not exceed 36' (11m). Use T-moldings if installation is over the allowable length/ width. T-moldings should separate installations through multiple rooms. (See Figure C)

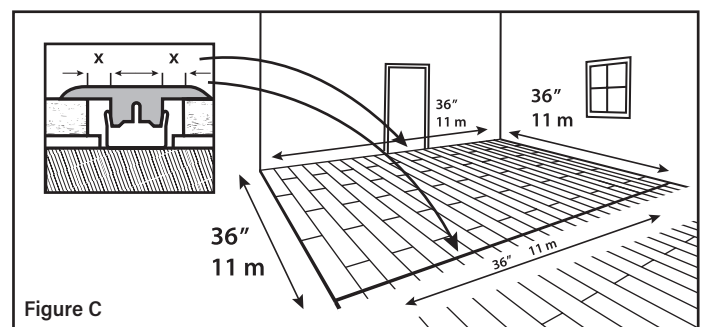

## INSTALLATION DIRECTIONS

Best practices are to install wood fiber floors parallel to the room's main light source or parallel to the room's longest wall.

### GENERAL SUBFLOOR REQUIREMENTS

- Subfloors must be clean, free of debris, and structurally sound
- Subfloors must be level to 2mm per 1m (5/64" per 3') (*See Figure D*)
- Carpet, carpet pad, and carpet tack must be removed

### WOOD SUBFLOORS

- Moisture content should not exceed 12%
- Subfloor panels must be screwed/nailed to supporting beams
- Subfloor squeaks should be remedied before installation
- Crawl spaces must be dry and meet all building codes
- Always install OmniChoice VaporBloc Underlayment over wood subfloors

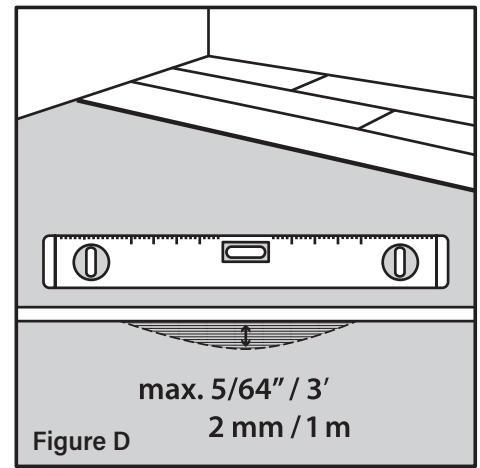

### CONCRETE SUBFLOORS

- Subfloor must be cured and allowed to dry for 60 days before installing wood fiber floors.
- A moisture test must be performed before installing wood fiber floors.
- Concrete or cement screed moisture content cannot exceed 1.8%. Calcium Sulphate screed moisture content cannot exceed 0.5%
- Moisture vapor emissions should not exceed 5 lbs / 1,000 ft<sup>2</sup> per 24 hours.
- Always install OmniChoice VaporBloc Underlayment over concrete subfloors

### EXISTING FINISHED FLOORS AS SUBFLOORS (e.g., Vinyl Sheet, Plank, Tile)

- Existing floor covering must be well bonded to the subfloor and in good condition with no tears, cracks, or other damage.
- Heavily cushioned surfaces (e.g., cushion vinyl) are unacceptable and should be removed.
- Existing finished floor covering should not exceed one layer in thickness.
- Ceramic tile grout should be made smooth by applying a self-leveling compound.
- Follow instructions pertaining to the underlying subfloor (Wood Subfloors or Concrete Subfloors)

---

## PRE-INSTALLATION PREPARATION

Undercut door jambs to fit wood fiber floors underneath them. Use a flooring off-cut and a piece of underlay as a height guide. Leave the required 3/8" (10mm) expansion spacing under door jambs. (*See Figure E*)

1. Sort planks from multiple boxes to avoid repetition
2. Inspect every plank for defects or damage before installing it.
3. The first and last row of your installation must be wider than 3.5" (9cm)
4. Each row's first and last plank must be a minimum of 12" (30cm) long.
5. Planks should be staggered from row to row by at least 12" (30cm)
6. Use spacers to maintain the required 3/8" (10mm) expansion space.
7. Choose a corner to start from and work from left to right.
8. Install OmniChoice Vapor Bloc per manufacturer's installation instructions)

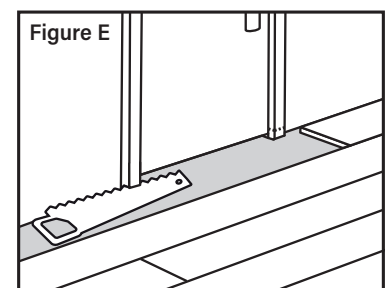

# INSTALLATION PROCEDURE

**1.** After installing OmniChoice Vapor Bloc, lay full planks against the wall with the long edge tongue facing the wall. These planks are not to be connected to each other as they will act as guides to assist in properly installing the first three rows and will be removed once these rows are connected. (See Figure F)

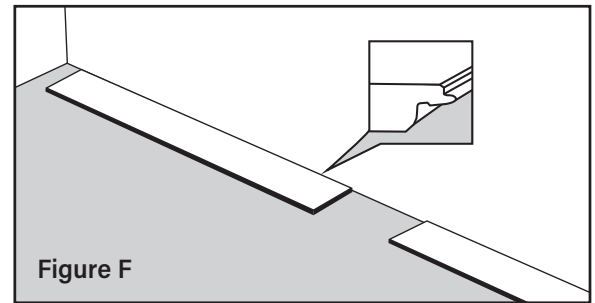

**2.** Cut a plank into three sections as follows (See Figure G):

**Cut Plank Section A:** 8" (20 cm) to be used to tap against

**Cut Plank Section B:** 16" (40 cm) to be used as a "bridge plank" when connecting short edges

**Cut Plank Section C:** Remainder of plank to be used as the first plank of the first row.

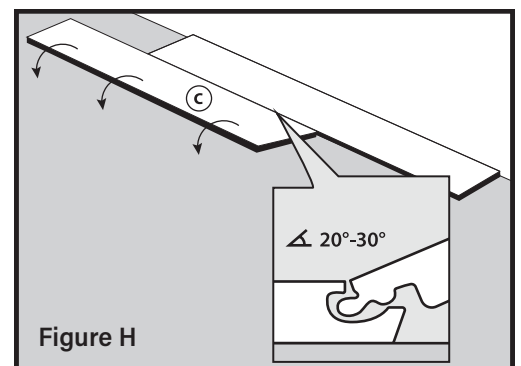
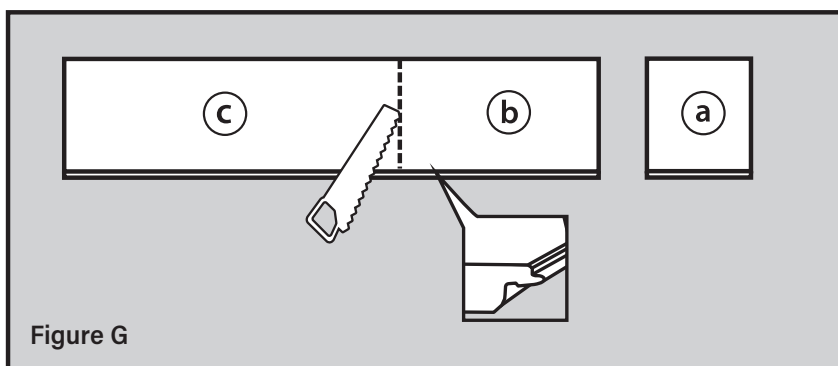

**3.** Connect the first plank (section C from the cut plank) to the guide plank by inserting its long edge tongue into the guide plank's long edge groove at an angle of between 20°-30°, then slowly lower it to engage it. (See Figure H)

**4.** Install the remaining planks of the first row by first inserting their long edge tongue into the guide plank's long edge groove, but before lowering it, ensure it is approximately 3/16" (5mm) away from the previously installed plank. To connect the planks, lightly tap the new plank's short-end groove until it is fully connected to the previous plank. Once connected, joints will be tight and there will not be a gap between planks.

**NOTE:** Tap against the scrap piece of wood fiber that was cut in the previous instruction. (See Figure I)

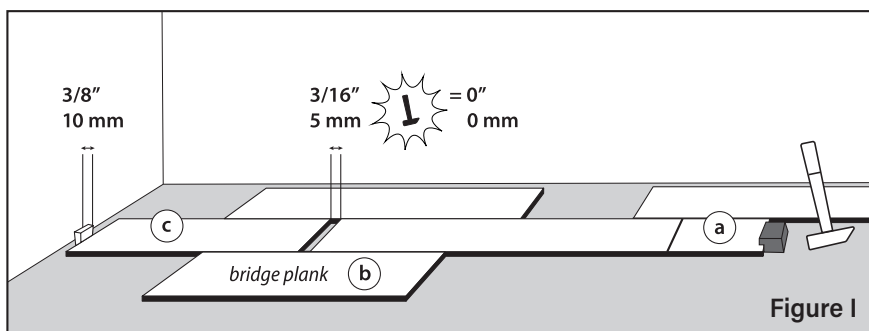

- (a) Never tap installed planks directly, as this will result in damage.
- (b) Connect the "bridge plank" to help align planks during tapping.
- (c) Ensure 3/8" (10mm) expansion space is left between first plank of each row and the wall.

**5.** Continue in this manner until the row is complete. Cut the last plank to fit and ensure the 3/8" (10mm) expansion space is left between the end of the row and the wall.

Use the remainder of the last plank of each row to start the next row, provided it is at least 12" (30cm) long and short edges are staggered by a minimum of 12" (30cm) from row to row. If this is not possible, use a new plank and cut it accordingly. (See Figure J)

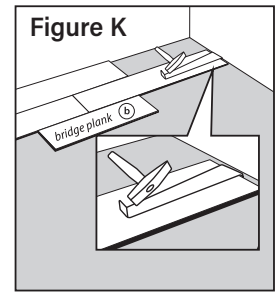
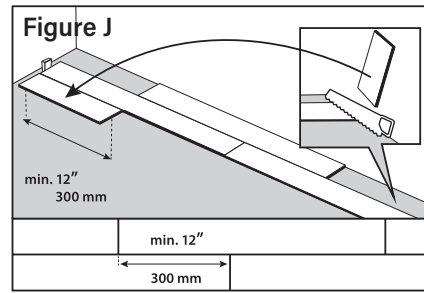

Use a pull bar instead of a tap block on the last plank of each row. (See Figure K)

**6.** Once the first three rows are complete, remove guide planks and slide installed rows towards the wall, maintaining 3/8" (10mm) expansion space. (See Figure L)

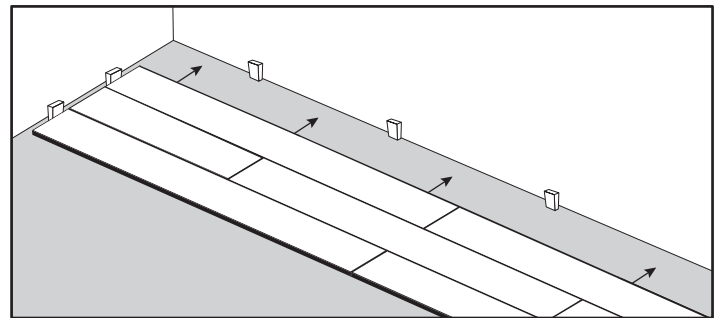
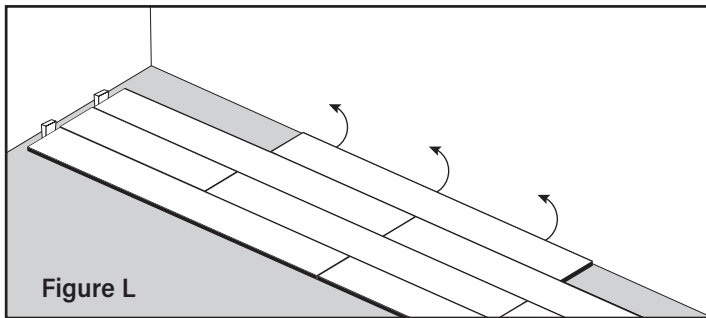

**7.** A 3/8" (10mm) expansion space must also be maintained around plumbing, pipes, and any vertical objects. If fitting planks around plumbing, cut holes approximately 3/4" (20mm) larger than the diameter of the pipe. Cut through the center of the holes and use glue to hold pieces in place. (See Figure M)

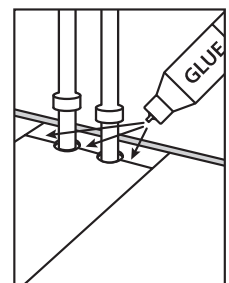
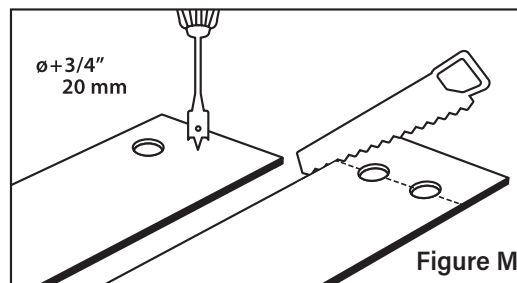

To complete the installation, remove all spacers and cover the expansion space with wall base or quarter rounds. **NOTE:** Ensure wall base or quarter rounds are fastened to the wall, not through the wood fiber floor or expansion space.

## WET AREA INSTALLATION INSTRUCTIONS

If wood fiber floors are installed in moisture-prone areas such as bathrooms, kitchens, and entryways, the expansion space must be sealed with 100% flexible silicone caulking. If desired, to reduce the amount of silicone caulking used, expansion spaces can be filled with 3/8" (10mm) Polyethylene backer rod and then covered with silicone caulking. (See Figure N)

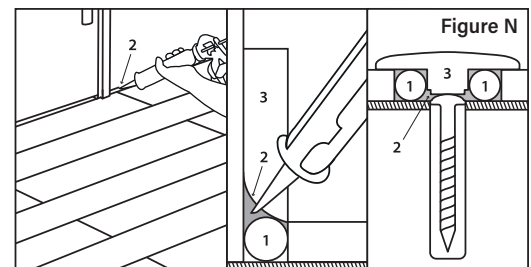

1: PE foam baker rod / Tapajuntas de PE , 2:Silicone / Silicon , 3:Molding /Moldura

Manufactured by

**CHOICE**  
FLOORING

For assistance call (800) 872-8426 or visit [www.choiceflooring.com](http://www.choiceflooring.com)