

MAG-DRIVE PUMPS FOR CORROSIVE PROCESSES

CP-U4 Drawing:

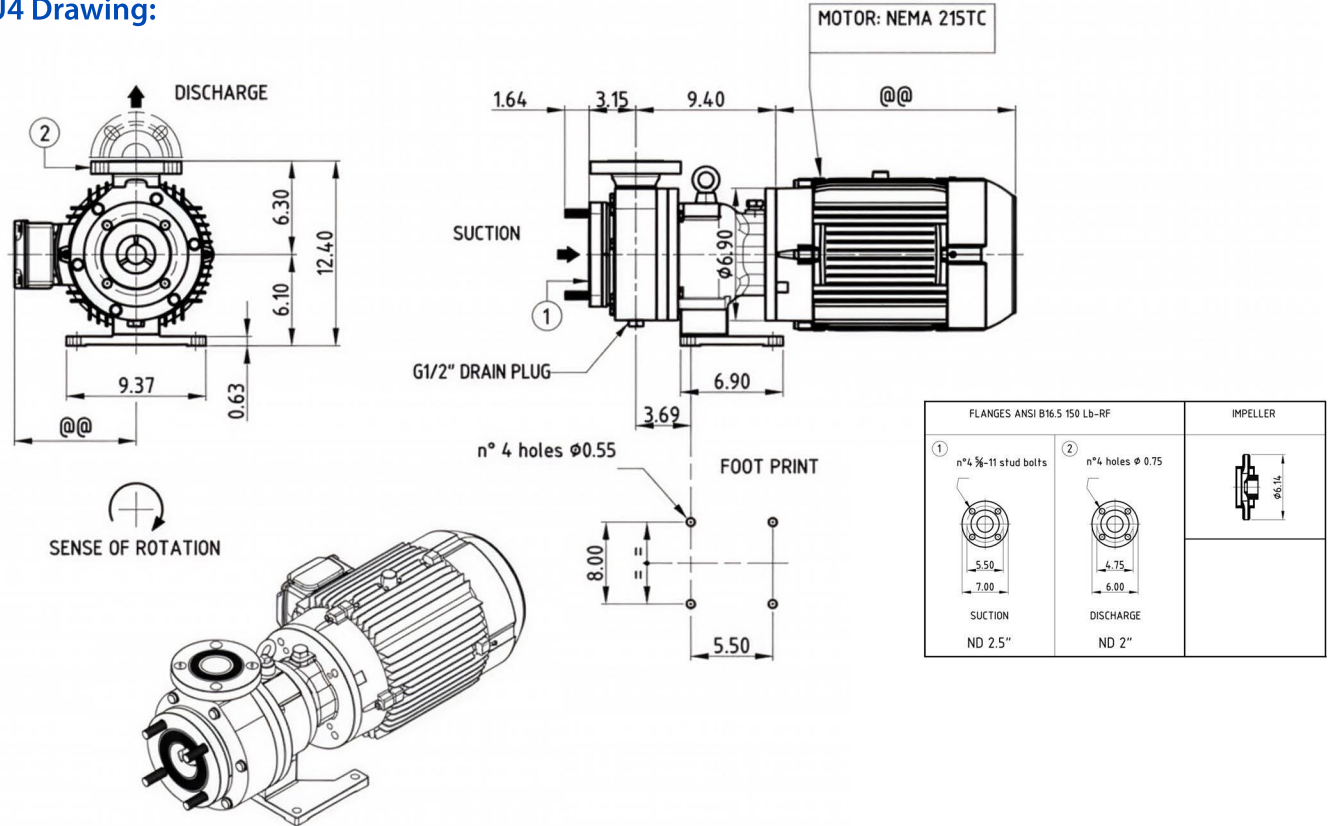

CP-U4 Exploded View:

| REF | DESCRIPTION |
|-----|---|
| 10 | Rear Casing-Reinforc. FC +Rear Casing Flange (incl. of 75d) |
| 20 | Ext. Magnet |
| 30 | Int. Magnet (incl. of 75b-75c-a-rings 2100 [e]) |
| 40 | Impeller (incl. of 61F+61R) |
| 50 | O-Ring 228 (628) |
| 61F | Imp. Front Thr. Brg-Cup |
| 61R | Imp. Rear Thr. Brg-Cup |
| 62F | Casing Front Thr. Brg-Cup |
| 62R | Casing Rear Thr. Brg-Cup+Support |
| 71 | Shaft (incl. of 75d) |
| 75 | Bearings (a-d) (b-c) (incl. of o-rings 2100 [e]) |
| 78 | Bracket |
| 78a | Casing Adaptor Flange |
| 78b | Foot |
| 78c | Foot Adaptor Block |
| 85 | Pump Head (incl. of 62F-75a) |
| 85s | Stud Bolts |
| 88 | Rear Wet End (10+30+40-50-60-61F-61R-62R+71-75) |
| 90 | Wet End (10+30+40-50-61F-61R-62F-62R-71+75-85) |

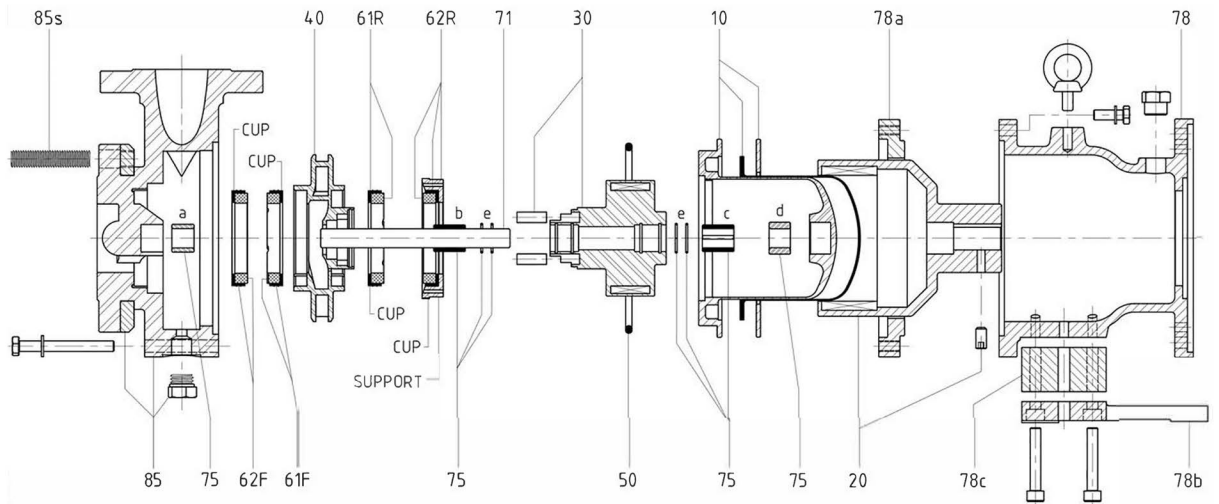

* Technical specifications available upon request