



COMMUNITY  
HOMES

REDMAN  HOMES.

# 3522D

2 BED - 2 BATH  
1213 SQ. FT.



**3602L**

2 BED - 2 BATH  
1312 SQ.FT.

23'-4"

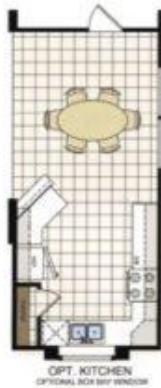

**4563K**

3 BED - 2 BATH  
1410 SQ.FT.

26'-8"







**4603L**

3 BED - 2 BATH  
1600 SQ.FT.



**4603M**

3 BED - 2 BATH  
1445 SQ.FT.



**8402D**

2 BED - 2 BATH  
787 SQ.FT.

19'-8"



40'-0"

OPTIONAL  
ENDWALL ENTRY



44'-0"

OPTIONAL  
ENDWALL ENTRY

OPTIONAL  
OFFSET

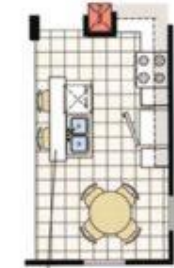

**8483D**

3 BED - 2 BATH  
944 SQ.FT.

19'-8"



48'-0"



OPTIONAL  
ENDWALL ENTRY



52'-0"

OPTIONAL  
ENDWALL ENTRY

OPTIONAL  
OFFSET



**8603D**

3 BED - 2 BATH  
1095 SQ.FT.



OPT. UTILITY W./ RECESS ENTRY



OPT. EXTERIOR STORAGE



OPT. BOX BAY WINDOW  
OPT. OFFSET

7' PORCH OPTION

19'-8"



60'-0"

OPT. BOX BAY WINDOW

59'-0"

**3443L**

3 BED - 2 BATH  
1027 SQ.FT.

23'-4"



OPTIONAL ENDWALL ENTRY

44'-0"



OPTIONAL ENDWALL ENTRY

OPTIONAL OFFSET

52'-0"





**3523L**  
3 BED - 2 BATH  
1213 SQ.FT.



**3563D**  
3 BED - 2 BATH  
1213 SQ.FT.



**4602S**  
 2 BED - 2 BATH  
 1600 SQ.FT.



SHOWN WITH OPTIONAL EXTERIOR ELEVATION



**4603D**

3 BED - 2 BATH  
1478 SQ.FT.



SHOWN WITH OPTIONAL EXTERIOR ELEVATION



**8523K**  
3 BED - 2 BATH  
983 SQ.FT.



**8562D**  
2 BED - 2 BATH  
1018 SQ.FT.



## BUILDING THE BEST

We build each and every home to meet or exceed a strict national or state building code, and we set even higher standards for ourselves. Focusing on the things you don't see as well as the things you do, we monitor and inspect our homes at every stage of construction. From the plumbing system to the electrical wiring, from the kitchen cabinets to the closets in the bedrooms -- every home we build undergoes rigorous quality inspections to ensure we're providing you with nothing but our best.



Over the years, we've built more than just homes. We've built homebuyer trust in our ability to satisfy their needs and we're confident we can provide you with a home that will meet your needs and exceed your expectations.

