

Overview

- 20 kW enclosed genset
- Designed to fit inside Prevost X3-45 Coach
- Powder coated sheet metal enclosure
- 1" Thick sound absorbing insulation
- Cooling airflow through base of generator enclosure



1721 Leesburg Commons Ct,
Leesburg, FL 34748

General Specifications

Genset Power, kW	20
Weight, lbs (kgs)	1075 (487)
Length, in (m)	63.15 (1.6)
Width, in (m)	34.5 (0.88)
Height, in (m)	29.9 (0.76)
Color / Finish	Anodized Silver Powder Coat

Engine Specifications

Engine	Isuzu 4LE2T
Displacement, cu. in. (L)	134.3 (2.2)
Cooling	Liquid / Aluminum Radiator
Cooling Fans	240V Electric Pusher
Engine RPM	1800
Power, HP (kW)	40 (30)
Governor	Electronic
Fuel Type	Ultra Low Sulfur Diesel
Emmision Standard	EPA Tier IV Final / EU Stage V
Engine Cylinders	4
Exhaust Aftertreatment	Diesel Oxidation Catalyst (DOC)
Aspiration	Turbo Charged
Exhaust Connection	2" NPT Male
Exhaust Location	Non-Service Side, On DOC
Starter Voltage, DC	12
Engine Alternator Voltage, DC	12
Engine Alternator Amps	50
Communication Protocol	J1939 CANBus
Oil Type	15W-40
Oil Capacity, qt. (L)	8.4 (8)
Coolant Type	1:1 Water / Glycol Mix
Coolant Capacity, qt. (L)	11.25 (10.6)
Fuel Consumption @ 100%, gph (Lph)	1.6 (6.1)
Fuel Consumption @ 75%, gph (Lph)	1.3 (4.9)
Fuel Consumption @ 50%, gph (Lph)	0.9 (3.4)

Electrical Specifications

Generator End	184E Brushless, 4 Pole
Voltage, VAC	120/240, Single Phase
Power Output, kW (kVA)	20 (20)
Power Factor	1.0
Amperage at 240VAC	80
Frequency, Hz	60
Voltage Regulator	SX 460
Electrical Connection	Terminal Block
Neutral Configuration	Bonded Neutral
Insulation	Class F



20A Fan Breaker
80A Main Breaker

Air Filter

Coolant Recovery Bottle

Fuel Filter, Secondary

Surge Tank

Controller

Toggle Switch
5A Breaker

Fuel Filter, Primary

Fuel Pump

Oil Filter

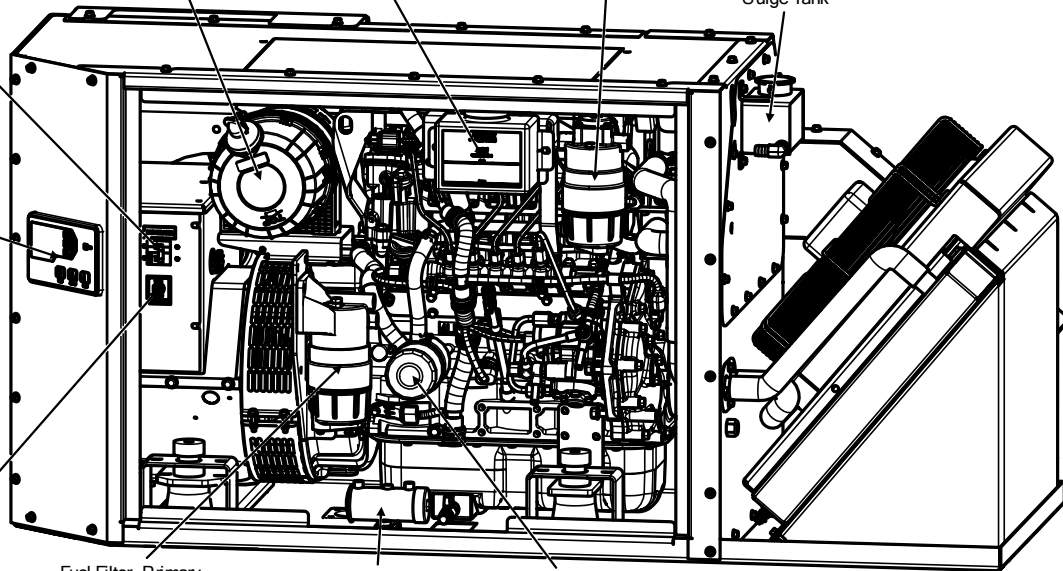

Voltage Regulator

Radiator

AC Terminal Block

Cooling Air Inlet

Enclosure
Cooling
Fan

Fuel Cooler

Exhaust Outlet 2" NPT Male

Battery Positive / Negative

Fuel Couplings, 2x 3/8" NPTF

Cooling Air Outlet

