

LC50 LIQUID LEVEL CONTROLLER

The LC50 is a float operated liquid level control. With a maximum working pressure of 500 psi it is a great choice for low to medium pressure applications. Its adjustable range allows it to be used as either a hi/low alarm or a traditional level controller.

The LC50 contains a replaceable 3-way block and bleed pilot featuring a soft seat for a bubble tight shutoff. It is available in 2" threaded, 4" or 5" union and 4" grooved connection sizes. Two stainless steel float sizes are available with other sizes and arm lengths by request. For sour service a NACE option is available. An Electric option is also available.

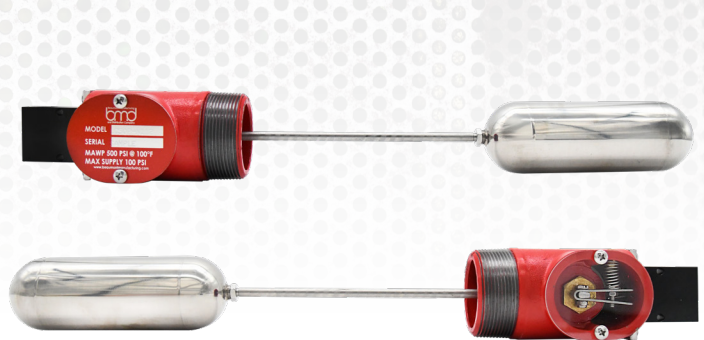

SPECIFICATIONS

Sizes:

- Threaded: 2",
- Union: 4" and 5"
- Grooved: 4"

Pressure Rating:

- 500 psi

Temperature Range:

- -20° F to 400° F (-29° C to 204° C)

Pilot Connections:

- 1/4" NPT

Max Pilot Pressure:

- 250 psi

Electric Specifications:

- Current Rating 15A, 480 VAC, 250 VDC

MATERIALS

Body:

- WCB Steel

Float:

- Stainless Steel

Arm:

- Stainless Steel

Shaft:

- Stainless Steel

Bushings:

- Brass
- Stainless Steel (Optional)

Seals:

- Buna
- Viton® (Optional)

Pilot Body:

- Aluminum

DIMENSIONS

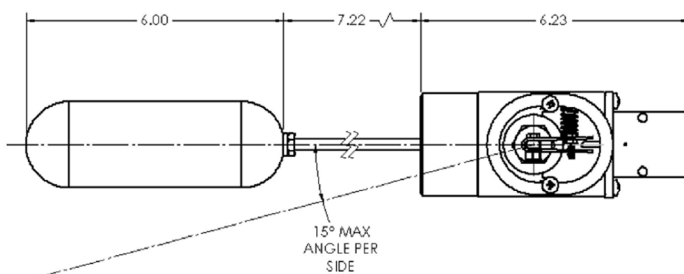

HOW TO ORDER

EXAMPLE MODEL NO. LC50P-N112

LC50 Series Liquid Level Controller,
Pneumatic, 2" NPT Connection,
Standard Service, 10" Arm, 2" X 6"
SST Float

LC50P-N112
SERIES

TYPE

P - Pneumatic

E - Electric

CONNECTION

N - 2" NPT

U - 4" Union

G - 4" Grooved

T - 5" union

MATERIALS

1 - Standard

2 - NACE

ARM LENGTH*

1 - 10" (Standard)

6 - 6" (Optional)

FLOAT SIZE

2 - 2" X 6" SST (Standard)

3 - 3 1/2" X 6" SST (Optional)

*Other lengths available upon request