

GV20 Gauge Valve

The GV20 Gauge Valves are designed to be used with BMD's LG20 Level Gauges but are also compatible with all armored flat-glass level gauges. Union tank connections make for easy installation and removal.



Specifications

Connections:

Level Gauge Connection: 1/2" FNPT
 Tank Connection: 1/2" and 3/4" Union

Features

Safety Shutoff: SST ball check upstream of the seat shuts off flow in the event of glass breakage.

Ergonomic Handle: Sturdy 0.75" diameter tee handle for ease of use and comfortable operation.

Offset Design: Body and drain connections are offset from the tank connection for easy glass cleaning.

NACE Compatible: Wetted parts conform to NACE MR-01-75 specifications for sour gas service.

Dimensions

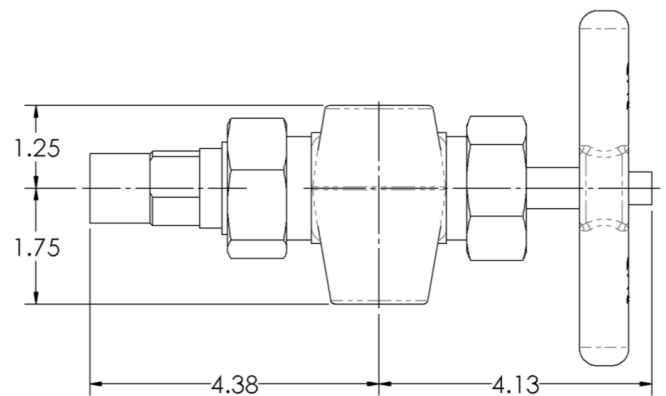

Measurements in inches

How to Order

Example Model No: **GV20-F1**

GV20 Gauge Valve with 1/2" Tank Union and 1/2" FNPT Glass Connections.

Tank Connection

F1 - 1/2" Union

F2 - 3/4" Union

GV20 - F1