



AIR2GO OWNERS MANUAL

Model 3209560

Trailer

Introduction

This trailer may only be used to transport an Air2G2 -336 machine. It is intended to be used by professional, hired operators in commercial applications. The trailer is designed primarily for use on well-maintained lawns in parks, golf courses, sports fields, and on commercial grounds. It is not approved for road or highway use. Using this product for purposes other than its intended use could prove dangerous to you and bystanders.

Read this information carefully to learn how to operate and maintain your product properly and to avoid injury and product damage. You are responsible for operating the product properly and safely.

Visit www.foleyco.com for more information, including help finding a dealer, or to register your product.

Whenever you need service, use genuine Foley parts. Use of anything other than genuine Foley parts may void your warranty. For additional information, contact an authorized Foley distributor and have the model and serial numbers of your product ready.

TECHNICAL SPECIFICATIONS:

ITEM	DESCRIPTION
TIRES	18/9.508 B SMOOTH
WHEELS	4 bolt Demountable
BED DIMENSIONS	86" x 52" [2.18 x 1.32 M]
PIN HITCH	0.75" dia max.
LOAD CAPACITY	1000 LBS [450 kg]

Table Of Contents

Safety	2-5
Setup	6
Product Overview	7-8
Specifications	9
Operation	10



Figure 2
Safety-Alert Symbol

This manual identifies potential hazards and has safety messages identified by the safety-alert symbol (Figure 2), which signals a hazard that may cause serious injury or death if you do not follow the recommended precautions.

General Safety

This product is capable of causing personal injury. Always follow all safety instructions to avoid serious personal injury.

- Read and understand the contents of this manual before using.
- Use your full attention while using this equipment. Do not engage in any activity that causes distractions; otherwise, injury or property damage may occur.
- Do not put your hands or feet near moving components.
- Do not operate without all guards and other safety protective devices in place and working.
- Keep the away from bystanders while moving.
- Keep bystanders and pets away from the machine.
- Keep children out of the operating area. Never allow children to operate.
- keep work area clean and dry. Damp or wet work areas can result in injury.
- Always wear ANSI-approved safety glasses and heavy duty work gloves during assembly and use. Do not wear loose clothing or jewelry which can get caught in moving parts.
- Store idle equipment. When not in use, tools, and equipment should be stored in a dry location to inhibit rust. Always lock up tools and equipment, and keep out of the reach of children.
- Use the right tool for the job. Do not attempt to force small equipment to do the work of larger industrial equipment. Do not modify this equipment, and do not use the equipment for a purpose for which it was not intended.
- Check for damaged parts. Before using the product, carefully check that it will operate properly and perform its intended function. Check for damaged parts and any other conditions that may affect the operation of this product. Replace damaged or worn parts immediately.
- Do not overreach. Keep proper footing and balance at all times to prevent tripping, falling, back injury, etc.
- Do not use this trailer when tired or distracted.
- Improperly using or maintaining this machine can result in injury. To reduce the potential for injury, comply with these safety instructions and always pay attention to the safety-alert symbol, personal safety instruction. Failure to comply with these instructions may result in personal injury or death.

SPECIFIC OPERATION WARNINGS

This product is capable of causing personal injury. Always follow all safety instructions to avoid serious personal injury.

- This Trailer is **NOT** designed for highway use and does not comply with DOT regulations. It is intended for private use only.
- Before each use, always examine the trailer for proper tire condition and air pressure, loose bolts and nuts, structural cracks, welds and any other conditions that may affect its safe operation. Do not use the trailer even if minor damage appears.
- Always check to make sure the payload being transported is properly and safely secured in the trailer. Load the trailer evenly side to side with 60% of the load forward of the axle.
- Make sure the towing vehicle is capable of towing the trailer and its payload.
- Make sure the hitch couple and pin are the correct size.
- Do not exceed 25 miles per hour when towing the trailer. Excess speed is the major cause of vehicle-trailer accidents.
- Whenever possible, park the trailer on a flat, level paved surface and chock both tires to keep the trailer from accidentally moving.
- Before attempting to load or unload the trailer make sure it is on a flat level surface and connected to a vehicle.
- Do not Exceed the 1000 pound weight capacity
- Do not allow anyone to ride on the trailer or load.
- The hitch must be secured, after installing pull up and down on the hitch to make sure it is secure. If the hitch and pin or ball hitch (optional) is not secured properly it may come loose while the trailer is in motion, causing property damage, serious personal injury or even death.
- Make wide turns when towing a loaded trailer, avoiding both sharp turns and u-turns. Turning too sharply can cause damage to the trailer and/or the tow vehicle.

UNPACKING

When unpacking check to make sure all the parts shown in the PARTS LIST at the back of this manual are included. If any parts are missing or broken please call your local distributor.

ASSEMBLY INSTRUCTIONS.

Read the following instructions step-by-step for easy assembly according to the complete part and hardware list. Average assembly time is 1-3 hours. You will need the following tools to assembly your trailer.

1/2" Wrench or Socket

3/4" Wrench or Socket (x2)

Wire cutter

Hammer and pry bar

Note: Tighten the wheel lugs to 85-90 ft-lbs of torque after assembling the trailer and after the first 20, 50, and 100 hours of use and before each tow thereafter.

STEP 1: Use the hammer and pry bar to remove the outer crating. Dispose of the crating per local regulations.

STEP 2: Use the 1/2" wrench or Socket to remove the 2 sides boards that the crating was attached to. There are 4 bolts per side. (Machine not shown for clarity)

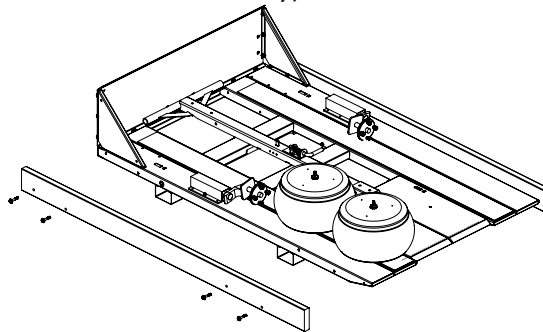

STEP 3: Remove any boxes or other items found around the Air2G2 machine.

STEP 4: Remove the tires and pads from the left rear side of the trailer. To remove unscrew the star knob. After removing the tires and pads, remove the threaded rod and dispose of the rod, nuts and knobs. (Machine not shown for clarity)

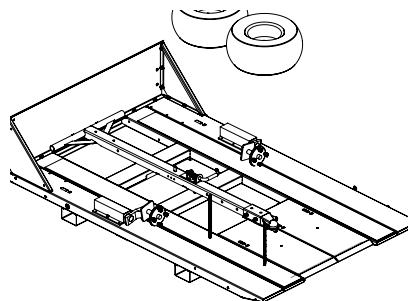

STEP 5: Use the 1/2" wrench or Socket to remove the 2 axles.

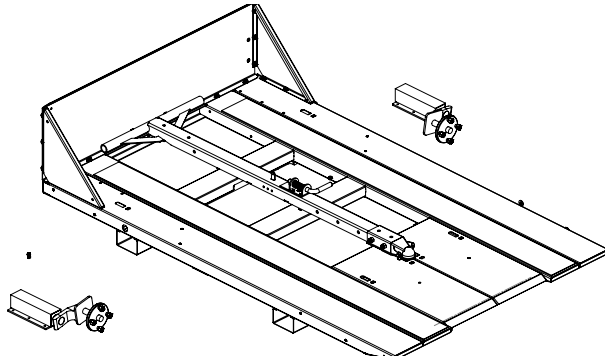

STEP 6: Unbolt the Air2G2 single tire from the trailer. Disconnect the all straps that hold the machine to the trailer.

STEP 7: Add some Fuel to the Air2G2 and Turn on (see Air2G2 operators manual for details on the operation of the machine). Once the beam is raised on the Air2G2 unit, lock the beam in the up position and turn off the unit.

STEP 8: Block up under the rear of the trailer so it doesn't flip up. Note, the 2 boards removed in step 2 can be placed behind the trailer as a small step down ramp. With the Trailer blocked up the Air2G2 can be carefully removed by putting it in neutral and pushing it off the end of the trailer. The tires should roll off the trailer and onto the boards then onto the ground. The handbar will need to be pushed up or down to disengage the brake on the machine.

STEP 9: Use the wire cutters to cut the straps that hold on the tongue assembly and remove.

STEP 10: Lift the trailer and remove the center shipping panel.

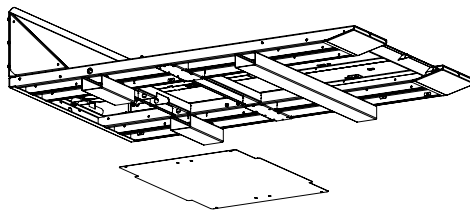

STEP 11: Install the axles using 6 of the 5/16 bolts (B311201) and lock washers (K311501) to hold on each axle. Bolts and nuts are in a bag in the box assembly. Note the wheel mounts should be pointed toward the rear of the trailer as shown.

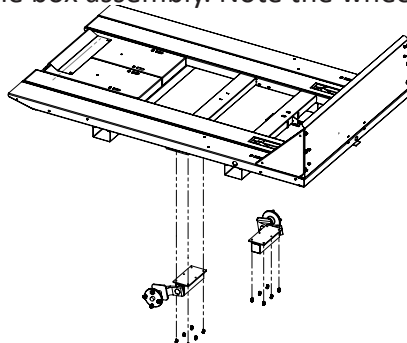

STEP 12: Install the tires onto the axles. Remove the 4 lug nuts from the axle, mount the tire and tighten the 4 lug nuts to 85-90 f-lbs. Tight in a cross pattern. Note there are 3-4 spacers on the axles, these are needed to give clearance of the wheel to the axle and should be left between the wheel and axle hub.

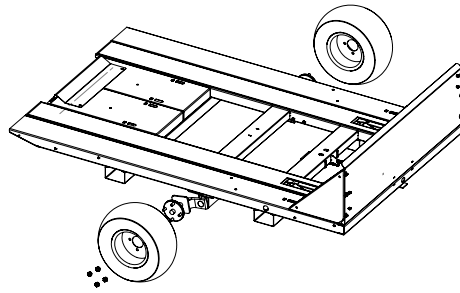

STEP 13: Place 1 connical washer 3708652 onto the tongue support 3209551. Place some grease into the end of the tongue assembly tube and insert the tongue support into the tube.

STEP 14: Raise the supports and tongue assembly and bolt into the trailer and bolt in place using 2 of the 5/16 bolts (B311201) and lock washers (K311501) on each side. If the fit is too tight you can remove one or both of the connical washers.

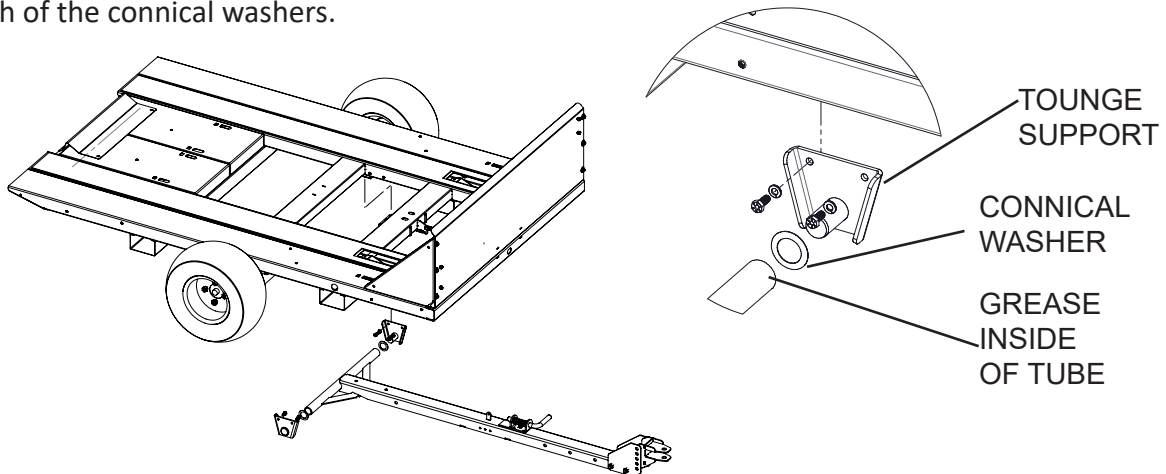

STEP 15 Cut the cable tie holding the tilt activation pedal and move to the center of the cutout. Rotate the tilt center bracket until the holes line up with the tube and insert 2 of the 5/16 bolts (B312401) and secure with locknuts (J317100).

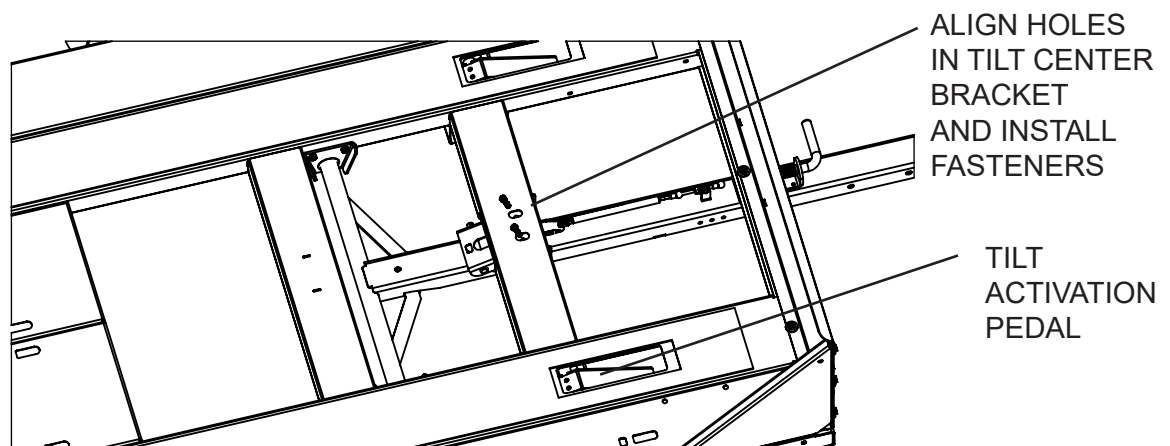

STEP 16: Use the pin (3711486) to lock the tongue to the tilt center bracket.

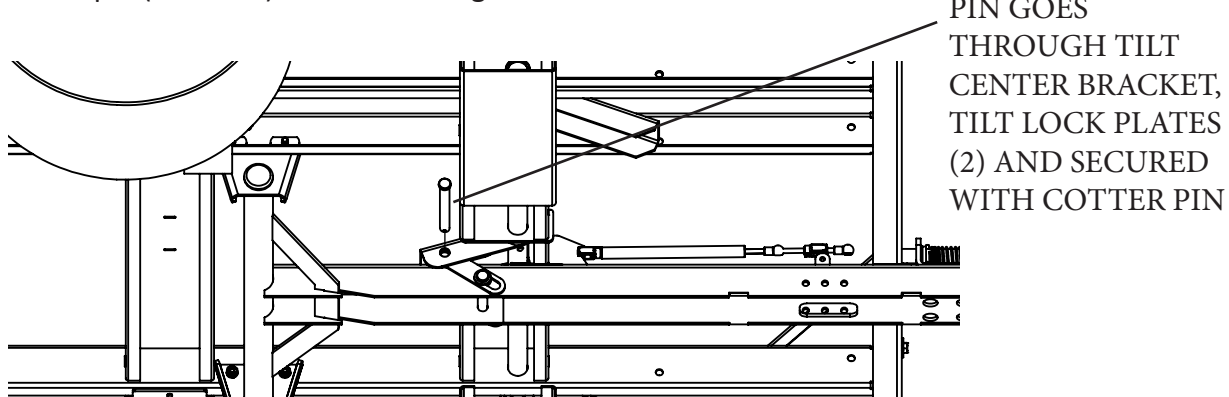

STEP 17: Attach the gas spring to the the trailer with the locking pin on the gas spring. Remove but rotating the pin and clip assembly, after installing lock by rotating back so it clips to the base.

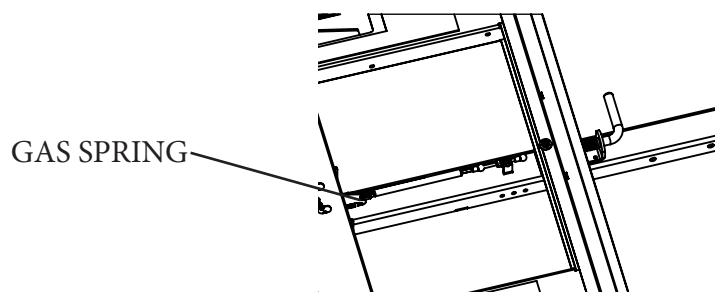

STEP 18: Measure the hitch on the towing vehicle and Install the hitch to the trailer tongue using the 1/2" bolts (B506401) and nuts (J507100). Install so the the tongue is level when connected to the vehicle. The hitch assembly can be installed in any set of holes and can be mounted with the bias up or down. See page 11.

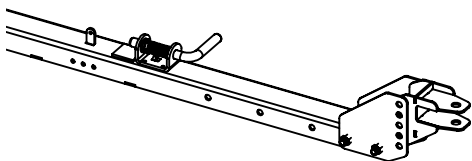

STEP 19: Install the HP support brackets using 4 of the 5/16 bolts (B311201), washers (K311000), lock washers (K311501) and nuts (J311000).

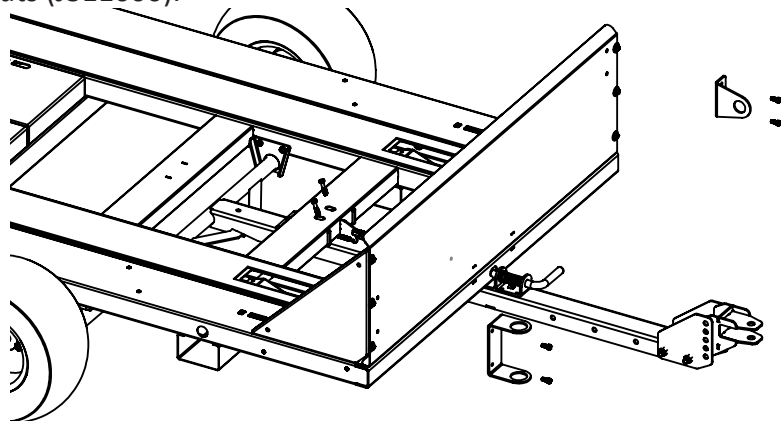

Operation

Before Operation Safety & General Safety

- Trailer is designed to carry the Air2G2, any other use of this trailer is prohibited.
- Before each use, always examine the trailer for proper tire condition and air pressure, look for loose bolts and nuts, structural cracks, bends and any other condition that may affect its safe operation. Do not use the trailer even if minor damage appears.
- Always check to make sure the payload being transported is properly and safely secured in the trailer.
- Load the trailer evenly from side to side and always attach cinch straps.
- When transporting, make sure the tip lock lever is engaged so the trailer will not tip during transport.
- Make sure the towing vehicle is capable of towing this trailer and its payload. Verify the hitch on the towing vehicle is capable of towing the Trailer and its payload.
- Make sure the hitch coupler and the vehicles hitch (not included) are of equal mating sizes and are rated equal to or greater than the weight of the trailer and its payload.
- Do not exceed 25 miles per hour when towing the trailer. Excess speed is a major cause of vehicle trailer accidents.
- Whenever possible, park the trailers on a flat, level, paved surface and chock both tires to keep the trailer from accidentally moving.
- Before attempting to load or unload the trailer, make sure it is on a flat, level, solid surface .
- DO NOT exceed the 1000 pound weight capacity.
- DO NOT allow anyone to ride in the towed vehicle or on the trailer.
- The coupler must be properly secured to the hitch. After assembly and attachment, pull up and down on the hitch to make sure the hitch secure. If the hitch is not secured properly, it could come loose while the trailer is in motion, causing property damage, serious personal injury or even death.
- **Make wide turns when towing a loaded trailer , avoiding both sharp turns and U turns. Turning Too sharply can cause damage to the trailer and/or the tow vehicle.**
- The owner/operator can prevent and is responsible for accidents that may cause personal injury or property damage.
- Wear appropriate clothing, including eye protection; long pants; substantial, slip-resistant footwear; and hearing protection. Tie back long hair, secure loose clothing, and do not wear loose jewelry.
- Do not operate the machinery or trailers when tired, ill, or under the influence of alcohol or drugs.
- Operate the trailer only in good visibility to avoid holes or hidden hazards.

Slope Safety

- Slopes are a major factor related to loss of control and rollover accidents, which can result in severe injury or death. You are responsible for safe slope operation. Operating the trailer on any slope requires extra caution. Do not operate on a slope of more than 15 degrees and do not load or unload on a slope of more than 5 degrees.
- Evaluate the site conditions to determine if the slope is safe for trailer operation including surveying the site. Always use common sense and good judgment when performing this survey.
- Review the conditions to determine whether you can operate the trailer in the conditions on that day and at that site. Changes in the terrain can result in a change in slope operation for the trailer.
- Avoid starting, stopping, or turning the trailer on slopes. Avoid making sudden changes in speed or direction. Make turns slowly and gradually.
- Do not operate a trailer under any conditions where traction, steering, or stability is in question.
- Remove or mark obstructions such as ditches, holes, ruts, bumps, rocks, or other hidden hazards.
- Tall grass can hide obstructions. Uneven terrain could overturn the trailer.
- Use extreme caution when operating the machine near drop offs, ditches, embankments, water hazards, bunkers or other hazards. The trailer could suddenly roll over if a wheel goes over the edge or the edge caves in. Establish a safety area between the trailer and any hazard.

CONNECTING TO VEHICLE.

The Air2go trailer comes with an adjustable hitch mount. The height of the hitch should be adjusted so that the trailer is level when connected to the vehicle. The hitch has 6 different positions. The largest pin that can be used with this hitch is .75 Diameter.

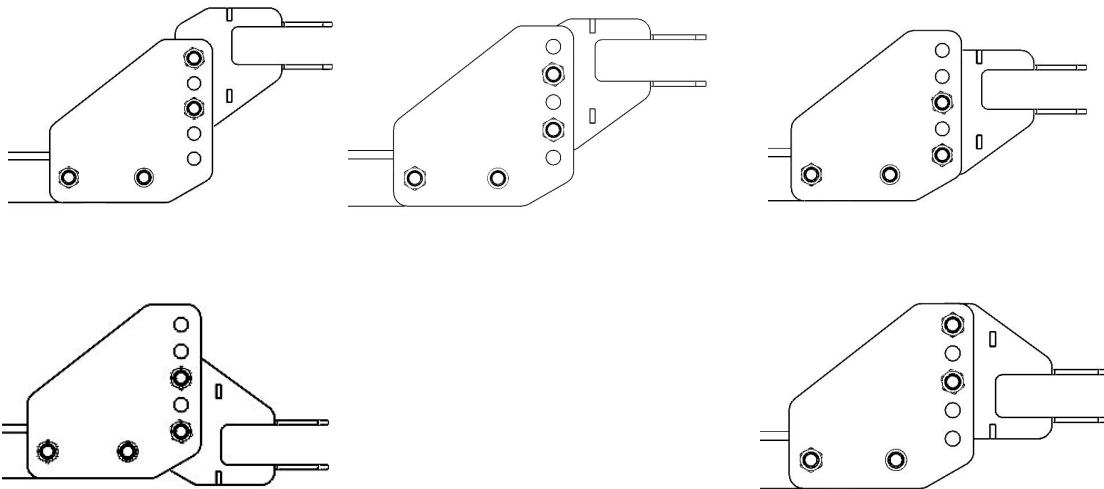

There is also an optional Ball hitch available.

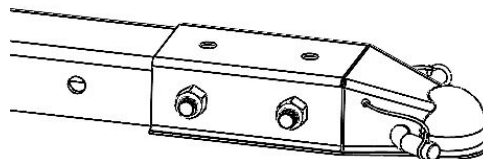

Unloading

To unload an Air2G2 from trailer, the trailer should be on flat level ground and connected to a vehicle. If there is too much slop the tip action of the trailer will not work correctly (less than 5degrees of slop is recommended).



IMPORTANT: The trailer must be connected to a vehicle to load or unload the Air2g2 machine.

Vehicles parking brake should be applied.

Step 1. Pull and lock out the tip latch located on the tounge. Turn the handle 90degrees to lock it in the retracted position.

PULL BACK
AND ROTATE
TO LOCK IN THE
RETRACTED
POSITION

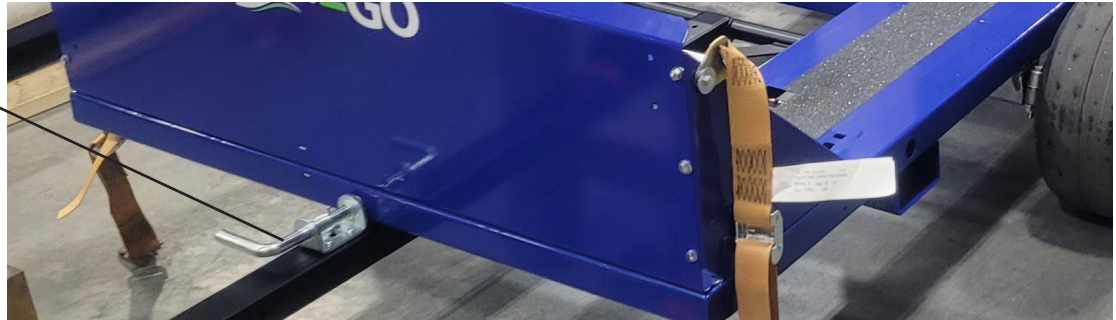

Step 2. Unlatch the 2 cinch straps from the Air2G2 trailer. You may have to loosen the straps first. Loosen by pressing on the lever on the strap.

DISCONNECT

PRESS TO
LOSSEN STRAP



Step 3: Rotate the neutral lever on the Air2g2 machine to the neutral positon. Rotate Counter-Clockwise to put the machine into nuetral. See machine manual.



NEUTRAL LEVER

Step 4: Push or pull the Air2G2 machine toward the back of the trailer. The machine has a brake that is engaged when the handlebar is in the middle position. The handlebar will need to be pushed or pulled to disengage the brake.



IMPORTANT: Never stand behind the machine when unloading, always stand to the side! The machine will unload quickly and could roll over a person or obstacle and cause injury or damage.

When the Air2G2 machine reaches the back of the trailer the trailer will rotate or tip. This will cause the machine to roll down the trailer and unload. This happens quickly so be aware and be prepared to move away from the machine and trailer. Remember the machine has a brake that will engage when the handlebar is moved to the middle position. Letting go of the handlebar should engage the brake. The machine may still roll down the trailer even if the brake is engaged but it should stop once it reaches the level surface.

NOTE: It is possible to unload by powering the Air2G2 machine on and moving it back by pulling down(back) on the handlebar. Cautions should be used as the machine will drive off the end of the trailer if the tip latch is not unlocked (see step 1). In addition controlling the speed and direction can be difficult once the trailer begins to tip. Let go and move away if you do not feel like you are in control of the machine.



Loading

To load an Air2G2 onto the trailer, park the trailer on flat level ground. If there is too much slop the tip action of the trailer will not work correctly (less than 5degrees of slop is recommended).



IMPORTANT: The trailer must be connected to a vehicle to load or unload the Air2g2 machine.

Vehicles parking brake should be applied.

Step 1. Pull and lock out the tip latch located on the tongue. Turn the handle 90degrees to lock it in the retracted position. push down on the rear of the trailer until it contact the ground, the trailer should stay in this position.

PULL BACK
AND ROTATE
TO LOCK IN THE
RETRACTED
POSITION

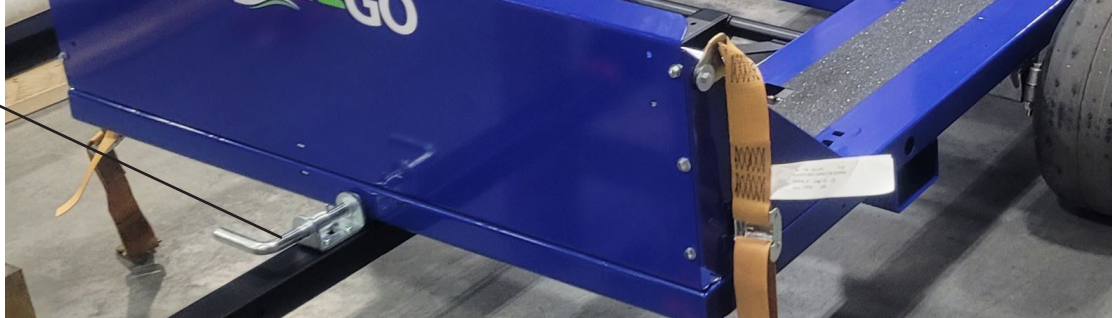

Step 2. Align the Air2G2 unit with the Trailer.



Step 3: Slowly drive the Air2G2 machine onto the tailer. The trailer will start to tip once the wheel contact the tilt activation pedals toward the front of the trailer. The machine need to be fully loaded when transported. If the tires are not against the front panel of the trailer move the machine forward until they are in contact.



Step 3. Rotate the tip latch and allow it to spring forward to lock the tip function. Check to make sure it engages the trailer.

ROTATE
AND LET
SPRING PUSH
FORWARD TO
ENGAGE AND
LOCK.

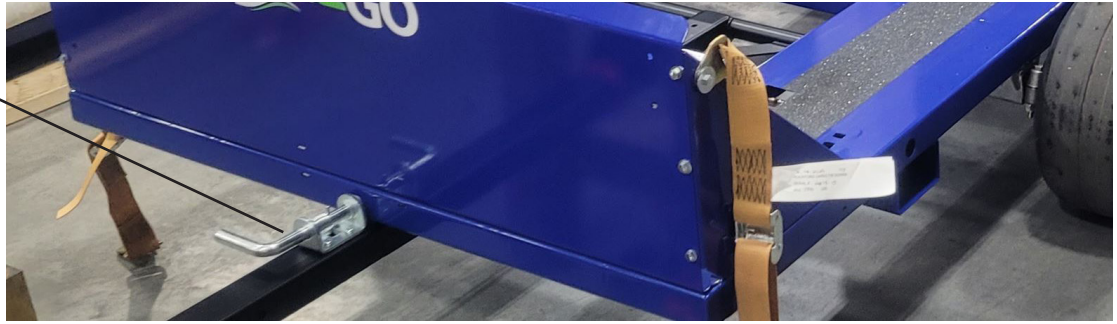

Step 4. Connect cinch straps and tighten by pulling on the strap.

CONNECT
TO AIR2G2 FRAME

PULL TO TIGHTEN
STRAP



Additional straps may be used and connected to the other tie down points if desired.

MAINTENANCE

- **Inspect coupler, hitch and ball for damage before each use.**
- **Hitch can be damaged in parking, hitting curbs, dragging when crossing ditches or railroad tracks.**
- **To prevent bearing damage, disassemble and repack wheel bearing with a good grade of wheelbearing grease every 2000 3000 miles or yearly.**
- **If you do not know how to repack wheel bearing, take your trailer to a qualified technician.**

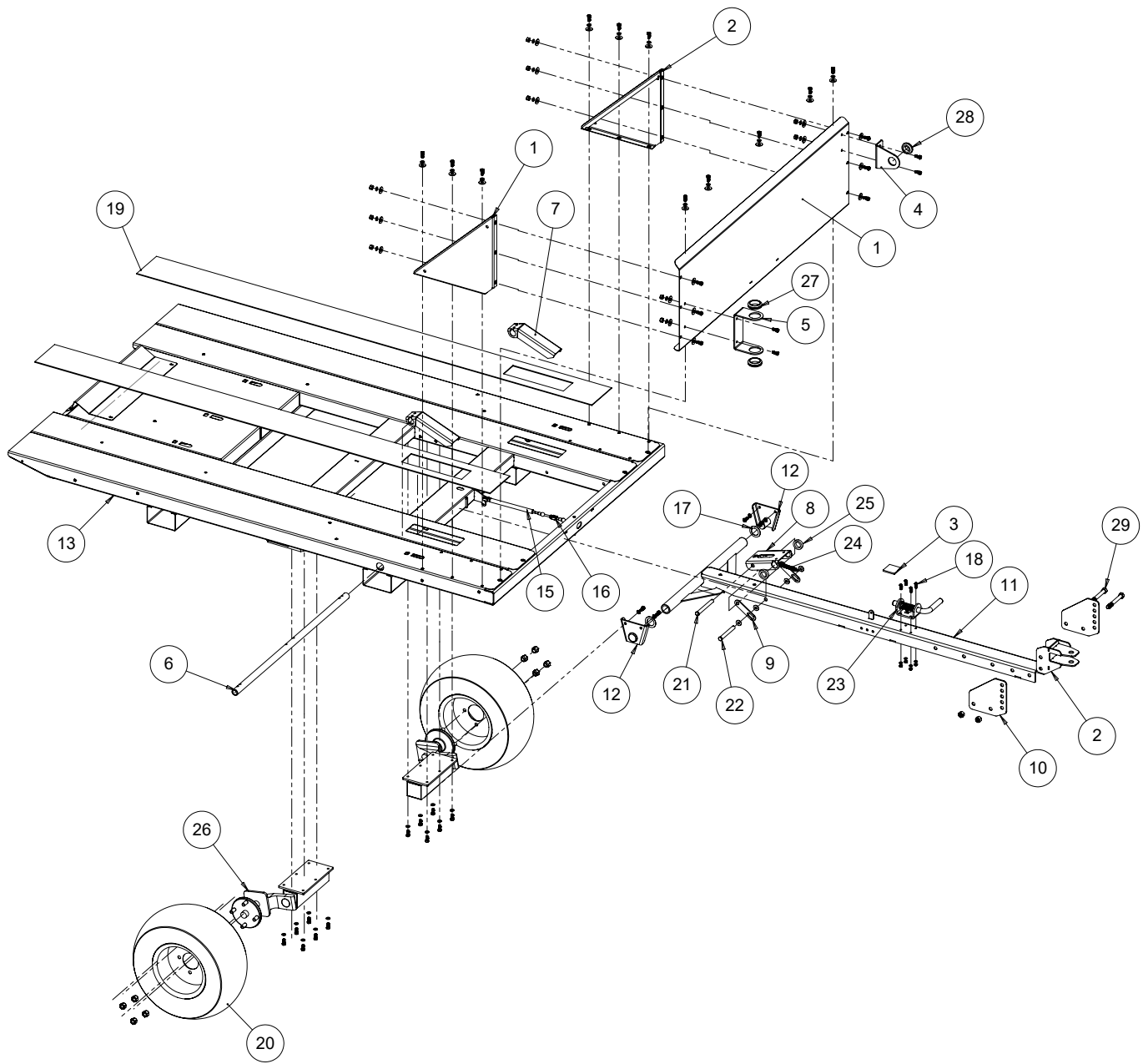

ITEM NO.	ITEM	DESCRIPTION
1	3209159	TRAILER FRONT PANEL
2	3209160	TRAILER SIDE ANGLE PANELS
3	3209167	RUBBER BUMPER PAD
4	3209171	HP SHAFT MOUNT
5	3209172	HP HANDLE MOUNT
6	3209182	TRAILER TILT LOCK TUBE
7	3209183	TILT ACTIVATION PEDAL
8	3209184	TILT CENTER BRACKET
9	3209185	TILT LOCK PLATE
10	3209186	HITCH ADAPTER PLATE
11	3209550	TOUNGUE WELDMENT
12	3209551	TOUNGUE SUPPORT
13	3209556	TRAILER WELDMENT
14	3209559	HITCH WELDMENT
15	3708866	SPRING - GAS 60# 5.5 STROKE
16	3706155	STEEL CLEVIS ROD END FOR M6x1
17	3708652	CONICAL WASHER 1.2x1.83x.024T
18	3711110	1/4"-20 x 3/4" Zinc-Plated Button-Head Bolt
19	3711345	Black Antislip Tape, 6" Wide 1/32in thick.
20	3711412	WHEEL TIRE ASSY, AIR TO GO TRAILER
21	3711486	STEEL CLEVIS PIN .5DIA 4.25 USABLE LG
22	3711487	STEEL CLEVIS PIN .5DIA 3.76 USABLE LG
23	3711489	Slide-Bolt Latch
24	3711490	EXTENSION SPRING, 4.00 LG X .50 OD X .063 DIA
25	3711491	SPACER, 1.50 OD X 1.00 ID X 3/8 LG, NYLON
26	3711501	2,000 lb. Torsion Half Axles with 4-4" Bolt Circle Hubs (Right and Left Included)
27	3711502	1-1/2" ID x 2-1/8" OD x 3/16" Thickness x 1-3/8" Panel Hole Grommet
28	3711503	1-3/8" ID x 1-3/4" OD x 3/16" Thickness x 1" Panel Hole Grommet
29	B506401	1/2-13x4 HHCS
	GOSL-1808	AIR2GO TRAILER DECAL
	SL-1810	Safety decals for Air2GO

Customer Support

Contact Customer Support

Foley Company

1750 Ryden RD

Prescott, WI 54021

Call: 904-507-8900

Email: air2g2support@foleyco.com

Facebook: facebook.com/FoleyCompany

Twitter: [@Foley_Company](https://twitter.com/Foley_Company)

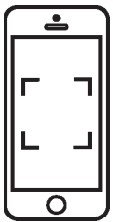

Scan on your
mobile device
to contact
customer
support

