



## imageRUNNER ADVANCE DX 6800 Series

# CONNECT SECURELY, TRANSFORM DIGITALLY

OPTIMUM PERFORMANCE AND UNRIVALLED USER EXPERIENCE FROM INNOVATIVE TECHNOLOGIES

The future of business is digital. Canon imageRUNNER ADVANCE DX is a new generation of smart multifunction devices, designed to support and accelerate every step of your digital transformation. Built with Canon's imageRUNNER ADVANCE DNA, state-of-the-art technology and software work hand-in-hand to digitise, automate and optimise content-centric workflows. As always, we're continually evolving our technology to ensure you feel safe and confident when using Canon devices.

Canon's imageRUNNER ADVANCE DX 6800 Series offers fast and reliable printing and scanning, intuitive workflows and efficient document processing. Perfect for education and legal markets, secure and sustainable devices minimise downtime and service costs with simple serviceability. Plus, reduced energy consumption and quiet operation allow devices to fit seamlessly into hybrid workspaces. uniFLOW Online Express comes as standard, delivering centralised print management and cloud connectivity that enables document access from anywhere, at any time, from any device.



**CLOUD  
CONNECTIVITY**



**PRODUCTIVITY**



**SERVICEABILITY**



**SECURITY** 



**SUSTAINABILITY**



Canon uniFLOW Online  
Outstanding Cloud Output Management Solution



New to the Line



Canon uniFLOW Online  
Outstanding Cloud Output Management Solution

# Canon

# imageRUNNER ADVANCE DX 6800 Series

## CLOUD CONNECTIVITY

- Cloud-based software-as-standard uniFLOW Online Express (uFOE) offers a single integrated solution to increase device security and simplify print management
- Scan and print documents from any location with enhanced cloud connectivity, offered with re-usable print formats for ease of use
- Canon's MEAP platform optimises processes by integrating with document capture and output management solutions and various applications such as uniFLOW Online\*, AirPrint, Mopria, Universal Print by Microsoft and Canon PRINT Business app

## SECURITY

- Combination of Verify System at startup and McAfee Embedded Control ensures device functionality is never compromised from the tampering of firmware and applications, all in real-time
- SSD data storage with cloud back-up means device settings can be quickly restored
- Updated TPM 2.0 (Trusted Platform Module 2.0) comes as standard for securely storing encryption keys, such as passwords, and protecting the device from external attacks
- Set up device authentication, two-factor authentication and device function restrictions for both device and cloud-based security measures
- Upgrade to uniFLOW Online\* for enhanced secure printing, mobile printing, and guest printing from any device

## PRODUCTIVITY

- Rapid printing and scanning, with up to 70ppm print and 270ipm scan speeds
- Reactive first copy output minimises downtime for users and improves productivity for print and scan jobs
- Cloud-based features like Filing Assist from uniFLOW Online\* accelerate digital transformation with automatic document filing
- Minimal device interaction is enabled through the Canon PRINT Business app or integrated timeline on the Home UI, which streamlines frequently-used processes and maintains productivity with flexible hybrid working
- Anti-streak, multi-feed detection, and blank page removal reduce processing time and improve scan performance
- Batch scan different sized documents with the same width (A3, A4, A4R & A5) thanks to greater support for smaller and mixed paper types
- Enhanced Eco Staple finishing reduces preparation and management time for documents
- Alleviate concerns for physical device operation, without compromising user experience, by applying\*\* optional antimicrobial film to all common touch points
- Utilise the Instant Stapler accessory to boost workflow productivity with stapling of up to 50 sheets whilst minimising physical touch - small enough to fit on top of devices or desks, anywhere within the office, home and co-working space.

## SUSTAINABILITY

- Reduced motor operation time and control decrease power consumption to save energy
- Enhanced toner technology features a lower melting point, requiring less energy when the device is active
- 43% reduction in device weight\*\*\* lessens materials in manufacturing and downsizes transportation requirements
- Noise disruption is minimised with acoustic insulation and reduced vibrations dampening operation sound
- Cut down waste with high-quality error-free scanning, including digital de-skewing and advanced stain-resistant glass
- Go staple-free for sustainable printing, with eco stapling up to 10 sheets (A3 and A4 52gsm to 64gsm)

## SERVICEABILITY

- Save costs and increase device uptime with innovative enhancements to frequently-replaced hardware parts as part of our evolving imageRUNNER ADVANCE DX portfolio
- Consumable life prediction allows parts to be replaced systematically to reduce service costs
- An IAP (Insulated & Air Pressure) toner bottle is cleaner and easier to replace, mess-free, without a technician
- User tutorials can be accessed on a mobile device via QR codes on the touchscreen
- Lighter device weight reduces installation time, so users can start using the device more quickly

\*uniFLOW Online is available as a Device Based Cloud Subscription for Document Output and Capture Management. Based on business needs, users can upgrade to uniFLOW Online to unlock a range of advanced benefits, including: Increased security with user authentication methods. Personalised workflows to enhance productivity. Reduced wastage by releasing jobs at the device. An intuitive cloud dashboard to leverage real-time data. Greater control over access and usage to reduce print costs.

\*\*It's recommended that the film is applied by a Service engineer.

\*\*\*compared to iR-ADV DX 6700 Series

NOTE - Certain features are only enabled with the combination of imageRUNNER ADVANCE DX and uniFLOW Online

## QUICK FACTS

- **Format:** Mono A3
- **Paper Supply Capacity (Max):** 6,350 sheets
- **Warm-up time:** 4 seconds or less (Quick Start Mode)
- **Finishing Capabilities:** Collate, Group, Offset, Staple, Saddle Stitch, Hole Punch, Eco Staple, Staple On Demand
- **Supported File Types:** PDF, EPS, TIFF/JPEG, and XPS
- **Print speed:** 60-70 ppm (A4)
- **Scan speed:** 270 ipm (A4)
- **Print Languages:** UFR II, PCL6, Adobe® PostScript 3™ (optional)
- **Print Resolution:** 1,200 x 1,200

- High productivity is enabled with best-in-class print speeds and innovative scan technology
- Enhanced finishing capabilities and more paper type support improves media handling and production quality
- Work safely and conveniently in hybrid environments with device features such as, personalised user timelines and protective antimicrobial film (optional), as well as mobile printing and scanning from applications like the Canon PRINT Business app
- Device reliability is assured by enhanced serviceability, with quick installation and easy maintenance
- Automated scan, search and store workflows efficiently digitise documents with applications such as OneDrive, SharePoint, Concur, DropBox
- Cloud software uniFLOW Online Express (uFOE) helps maintain continuous productivity across hybrid working
- Reduce environmental impact and workplace disruption with quieter printing and scanning
- McAfee Embedded Control alongside with other security features offers complete peace of mind and 360° protection covering document, network and device

## TAILORED SOLUTIONS TO MEET EVERY CHALLENGE

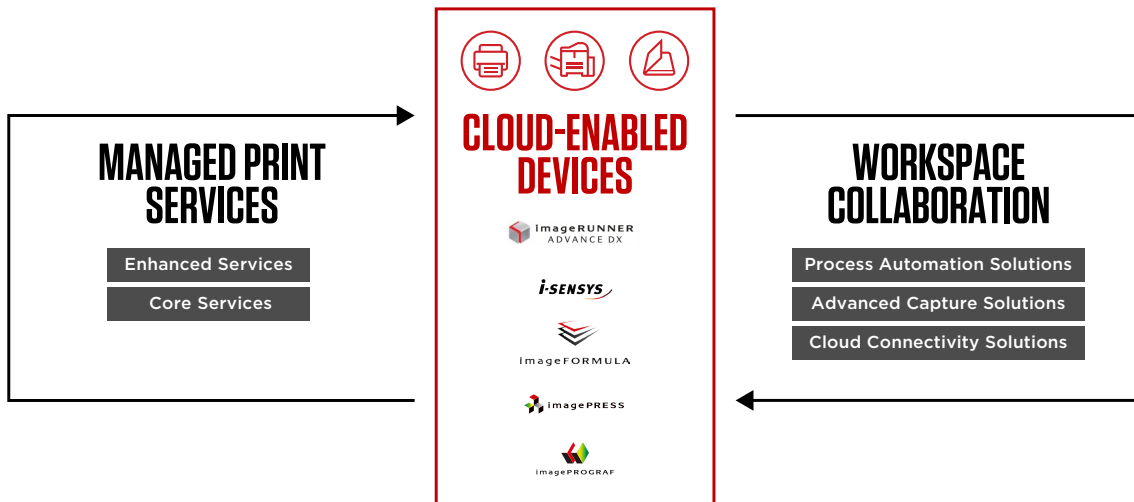

Canon's Digital Transformation Services (DTS), bring together our leading hardware and software into an integrated technology ecosystem, designed to support your transformation journey. This offering combines Managed Print Services and Workspace Collaboration solutions, to help you gain transparency and control over the entire document lifecycle.



Canon Ireland  
3006 Lake Drive  
Citywest, Saggart  
Co. Dublin, Ireland  
Telephone No: 01 2052400  
Facsimile No: 01 2052525  
canon.ie

Canon (UK) Ltd  
5 The Square  
Stockley Park  
Uxbridge  
UB11 1ET  
Tel: 01895 648 000  
www.canon.co.uk

Canon Inc.  
canon.com  
Canon Europe  
canon-europe.com  
English edition  
© Canon Europa N.V., 2021

# imageRUNNER ADVANCE DX 6800 Series

## SECURE, SUSTAINABLE A3 MONO MULTIFUNCTION DEVICES WITH INTEGRATED CLOUD-BASED SOFTWARE TO EXPEDITE PRINTING AND DOCUMENT DIGITISATION

### MAIN CONFIGURATION OPTIONS



Canon Europe Ltd.  
EU 2022-2024 Most Reliable A3 Brand



Canon uniFLOW OnJine  
Outstanding Cloud Output Management Solution



Canon Europe Ltd.  
EU 2022-24 Line of the Year

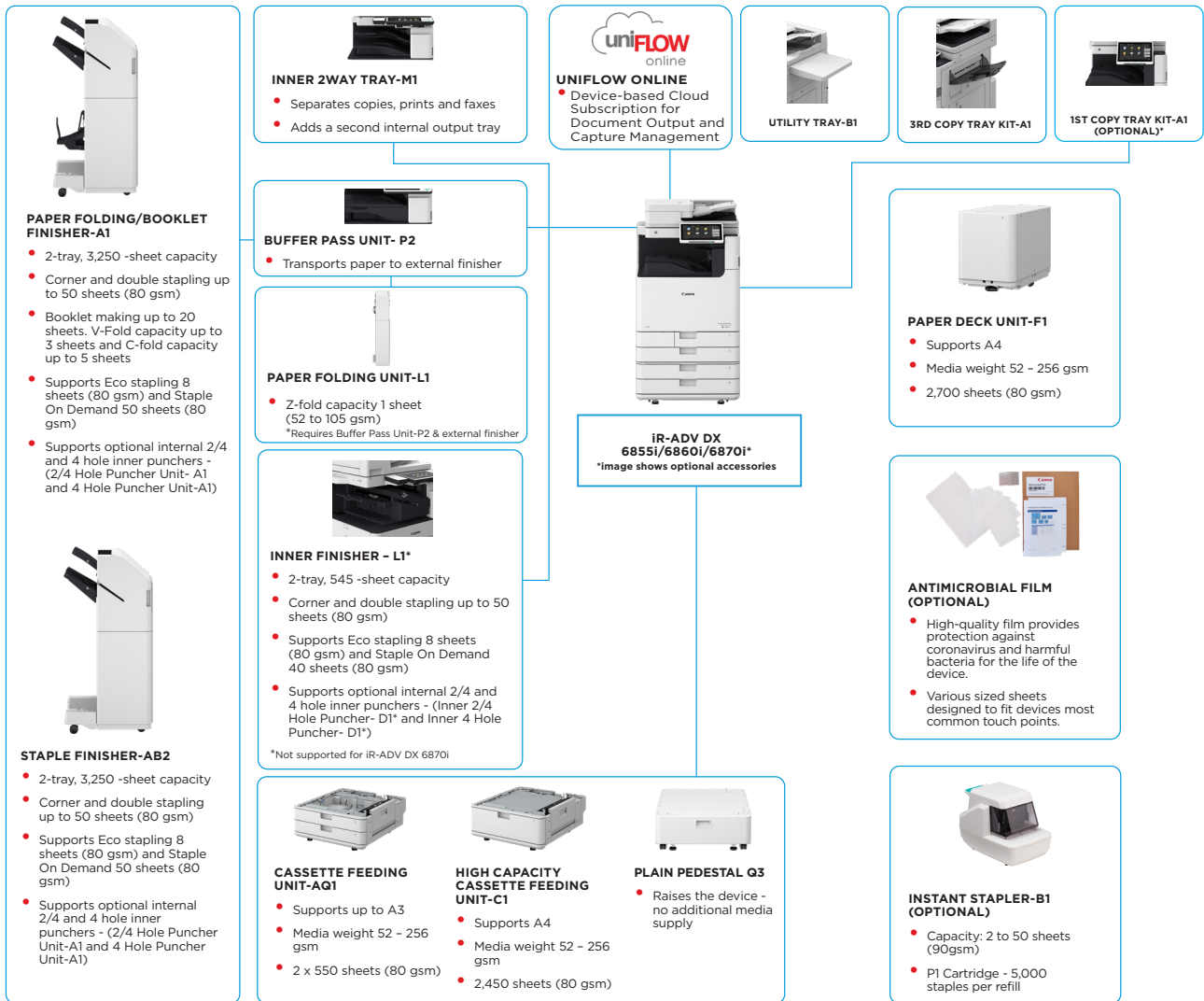

This flat configuration is for illustration purpose only. For a complete list of options and the exact compatibility relationships, please refer to the online [product configurator](#).

The Unified Firmware Platform (UFP) ensures that the latest feature upgrades and protection are available, for an enhanced user experience across the entire iR ADVANCE DX portfolio.

\*To support sustainability and save on raw materials required for plastics, 1st Copy Tray Kit-A1 is optional.

# TECHNICAL SPECIFICATIONS

# imageRUNNER ADVANCE DX 6800 Series

<b>MAIN UNIT</b>		<b>Fonts</b>	PS fonts: 136 Roman PCL fonts: 93 Roman, 10 Bitmap fonts, 2 OCR fonts, Andale Mono WT J/k/S/T <sup>1</sup> (Japanese, Korean, Simplified and Traditional Chinese), Barcode fonts <sup>2</sup>  <sup>1</sup> Optional PCL International Font Set-A1 is required. <sup>2</sup> Optional Barcode Printing Kit-D1 is required.
<b>Machine type</b>	A3 Monochrome Laser Multifunctional	<b>Print Features</b>	Secured Print, Secure Watermark, Header/Footer, Page Layout, Two-sided Printing, Mixed Paper Sizes/Orientations, Front/Back Covers, Toner Reduction, Poster Printing, Forced Hold printing, Print Date, Scheduled Printing, Printing Using a Virtual Printer
<b>Core functions</b>	Print, Copy, Scan, Send, Store and Optional Fax	<b>Operating System</b>	UFR II: Windows® 8.1/10/11/Server2012/Server2012 R2/Server2016/Server2019/Server2022, Mac OS X (10.11 or later) PCL: Windows® 8.1/10/11/Server2012/Server2012 R2/Server2016/Server2019/Server2022 PS: Windows® 8.1/10/11/Server2012/Server2012 R2/Server2016/Server2019/Server2022, Mac OS X (10.11 or later) PPD: Windows® 8.1/10/11, Mac OS X(10.11 or later)  As of Jan. 2022
<b>Processor</b>	1.8GHz Dual Core Processor	<b>COPY SPECIFICATIONS</b>	
<b>Control Panel</b>	10.1" TFT LCD WSVGA Color Touch panel	<b>Copy Speed (BW)</b>	iR-ADV DX 6870i up to 70 ppm (A4, A5*, A5R, A6R*), up to 36 ppm (A3), up to 42 ppm (A4R) iR-ADV DX 6860i up to 60 ppm (A4, A5*, A5R, A6R*), up to 32 ppm (A3), up to 36 ppm (A4R) iR-ADV DX 6855i up to 55 ppm (A4, A5*, A5R, A6R*), up to 29 ppm (A3), up to 36 ppm (A4R)  * 1-sided only
<b>Memory</b>	Standard: RAM 5GB Main CPU: 2GB Image Processing CPU: 2GB + 1GB (reserved for image processing)	<b>First-Copy-Out Time (A4, BW)</b>	iR-ADV DX 6870i: Approx. 2.7 seconds or less iR-ADV DX 6860i: Approx. 2.9 seconds or less iR-ADV DX 6855i: Approx. 2.9 seconds or less
<b>Storage</b>	Standard: (SSD) 256GB, Optional: (SSD) 1TB	<b>Copy resolution (dpi)</b>	600 x 600
<b>Interface Connection</b>	NETWORK Standard: 1000Base-T/100Base-TX/10Base-T, Wireless LAN (IEEE 802.11 b/g/n); Optional: Bluetooth Low Energy OTHERS Standard: USB 2.0 (Host) x1, USB 3.0 (Host) x1, USB 2.0 (Device) x1; Optional: Serial Interface, Copy Control Interface	<b>Multiple Copies</b>	Up to 9,999 copies
<b>Paper Supply Capacity (A4, 80gsm)</b>	Standard: 1,200 sheets 100-sheet Multi-purpose tray x 1 550-sheet Paper cassettes x 2 Maximum: 6,350 sheets (with High Capacity Cassette Feeding Unit-C1 + Paper Deck Unit-F1)	<b>Copy Density</b>	Automatic or Manual (9 Levels)
<b>Paper output capacity (A4, 80gsm)</b>	Maximum: 3,450 Sheets (with Staple Finisher-AB2 or Paper Folding/Booklet Finisher- A1 and 3rd Copy Tray Kit-A1)	<b>Magnification</b>	Variable zoom: 25% to 400% (1% Increments) Preset reduction/enlargement: 25%, 50%, 70%, 100%(1:1), 141%, 200%, 400%
<b>Finishing capabilities</b>	Collate, Group, Offset, Staple, Saddle Stitch, Hole Punch, Eco Staple, Staple On Demand, V-fold, C-fold, Z-fold * Finishing capabilities vary depending on the options connected.	<b>Copy Features</b>	Preset R/E Ratios by Area, Two-Sided, Density Adjustment, Original Type Selection, Interrupt Mode, Book to Two Pages, Two-sided Original, Job Build, N on 1, Add Cover, Insert Sheets, Different Size Originals, Page Numbering, Copy Set Numbering, Sharpness, Erase Frame, Secure Watermark, Print Date, Gutter, Print & Check, Negative/Positive, Repeat Images, Merge Job Blocks, Mirror Image, Store in Mail Box, Superimpose Image, Copy ID Card, Skip Blank Pages, Free Size Original, Reserved copy, Copy Sample
<b>Supported Media Types</b>	Multi-purpose tray: Thin, Plain, Recycled, Color, Heavy, Coated, Tracing, Bond, Transparency, Label, Pre-punched, Letterhead, Tab, Envelope Paper Cassette (Upper/Lower): Thin, Plain, Recycled, Color, Heavy, Bond, Transparency, Pre-punched, Letterhead, Envelope* * Envelope Feeder Attachment (standard) is required.	<b>Copy resolution (dpi)</b>	600 x 600
<b>Supported Media Sizes</b>	Multi-purpose tray: Standard size: SRA3, A3, A4, A4R, A5, A5R, A6R, B4, B5, B5R Custom size: 98.0 x 139.7 mm to 320.0 x 457.2 mm Free Size: 98.0 x 139.7 mm to 320.0 x 457.2 mm Envelopes: COM 10 No.10, Monarch, DL, ISO-C5 Envelope custom size: 98.0 x 90.0 mm to 320.0 x 457.2 mm Upper Cassette: Standard size: A4, A5, A5R, A6R, B5 Custom Size: 98.0 x 148.0 mm to 297.0 x 215.9 mm Envelopes: COM10 No.10, Monarch, DL, ISO-C5 Lower Cassette: Standard size: A3, A4, A4R, A5, A5R, A6R, B4, B5, B5R Custom size: 98.0 x 148.0 mm to 304.8 x 457.2 mm Envelopes: COM10 No.10, Monarch, DL, ISO-C5	<b>Copy Density</b>	Automatic or Manual (9 Levels)
<b>Supported media weights</b>	Multi-purpose tray: 52 to 300 gsm Paper Cassettes (Upper/Lower): 52 to 256 gsm Duplex: 52 to 256 gsm	<b>Magnification</b>	Variable zoom: 25% to 400% (1% Increments) Preset reduction/enlargement: 25%, 50%, 70%, 100%(1:1), 141%, 200%, 400%
<b>Warm-up Time</b>	Quick Startup Mode: 4 Seconds or less * * Time from device power-on to when the copy icon appears and is enabled to operate on the touch panel display. From Sleep Mode: 7 seconds or less (iR-ADV DX 6870i) 6 seconds or less (iR-ADV DX 6860i/iR-ADV DX 6855i) From Power On: 6 Seconds or less* * Time from device power-on, until copy ready (not print reservation).	<b>Copy Features</b>	Preset R/E Ratios by Area, Two-Sided, Density Adjustment, Original Type Selection, Interrupt Mode, Book to Two Pages, Two-sided Original, Job Build, N on 1, Add Cover, Insert Sheets, Different Size Originals, Page Numbering, Copy Set Numbering, Sharpness, Erase Frame, Secure Watermark, Print Date, Gutter, Print & Check, Negative/Positive, Repeat Images, Merge Job Blocks, Mirror Image, Store in Mail Box, Superimpose Image, Copy ID Card, Skip Blank Pages, Free Size Original, Reserved copy, Copy Sample
<b>Dimensions (W x D x H)</b>	620 x 722 x 937 mm	<b>SCAN SPECIFICATION</b>	
<b>Installation Space (W x D)</b>	Basic: 1,138 x 1,162 mm (Right Cover Open with Multi-purpose tray extended + Cassette Drawers Open) Fully Configured: 1,866 x 1,162 mm (Staple Finisher-AB2/Paper Folding/Booklet Finisher-A1 with the extension tray extended + Paper Deck Unit-F1 + Cassette Drawers open)	<b>Type</b>	Single-pass Duplexing Automatic Document Feeder* [2-sided to 2-sided (Automatic)] * Detect Feeder Multi Sheet Feed is supported.  up to 200 Sheets
<b>Weight*</b>	iR-ADV DX 6870i: Approx. 93 kg iR-ADV DX 6860i: Approx. 91 kg iR-ADV DX 6855i: Approx. 91 kg	<b>Document Feeder Paper Capacity (80 gsm)</b>	up to 200 Sheets
<b>PRINT SPECIFICATIONS</b>		<b>Acceptable Originals and weights</b>	Platen: Sheet, Book, and 3-Dimensional Objects Document Feeder media weight: 1-sided scanning: 38 to 220 gsm 2-sided scanning: 38 to 220 gsm * An acceptable weights of A6R or smaller is 50 to 220gsm.
<b>Print Speed (BW)</b>	iR-ADV DX 6870i up to 70 ppm (A4, A5*, A5R, A6R*), up to 36 ppm (A3), up to 42 ppm (A4R) iR-ADV DX 6860i up to 60 ppm (A4, A5*, A5R, A6R*), up to 32 ppm (A3), up to 36 ppm (A4R) iR-ADV DX 6855i up to 55 ppm (A4, A5*, A5R, A6R*), up to 29 ppm (A3), up to 36 ppm (A4R)  * 1-sided only	<b>Supported media sizes</b>	Platen scanning size: up to 297.0 x 431.8 mm Document Feeder media size: A3, A4, A4R, A5, A5R, A6R, B4, B5, B5R, B6R Custom size: 70.0 x 139.7 mm to 304.8 x 431.8 mm
<b>Print Resolution (dpi)</b>	1,200 x 1,200	<b>Scan Speed (ipm: BW/CL; A4)</b>	1-sided Scanning: 135/135 (300 x 300 dpi, send), 80/80 (600 x 600 dpi, copy) 2-sided Scanning: 270/270 (300 x 300 dpi, send), 160/90 (600 x 600 dpi, copy)
<b>Page description languages</b>	Standard: UFR II, PCL6 Optional: Adobe® PostScript®3™	<b>Scan Resolution (dpi)</b>	Scan for Copy: 600 x 600 Scan for Send: (Push) 600 x 600 (SMB/FTP/WebDAV/IFAX), (Pull) 600 x 600 Scan for Fax: 600 x 600
<b>Direct Print</b>	Supported file types: PDF, EPS, TIFF/JPEG, and XPS	<b>Pull Scan Specifications</b>	Color Network ScanGear2. For both TWAIN and WIA Supported OS: Windows® 8.1/10/11/Server2012/Server2012 R2/Server 2016/Server 2019/Server 2022 As of Nov. 2021
<b>Printing from mobile and cloud</b>	AirPrint, Mopria, Universal Print with Microsoft, Canon PRINT Business App, and uniFLOW Online (optional) A range of software and MEAP-based solutions are available to provide printing from mobile devices or internet-connected devices and cloud-based services depending on your requirements. Please contact your sales representative for further information.	<b>Scan Method</b>	Push Scan, Pull Scan, Scan to Box, Scan to Advanced Space, Scan to Network, Scan to USB Memory Key, Scan to Mobile devices, Scan to cloud (uniFLOW Online - Optional)
<b>OS Standard Printing</b>	Android/Windows® 10/Windows® 11/Chrome OS/macOS (11.2.2 or later)/iOS (15.2 or later)/iPadOS	<b>SEND SPECIFICATIONS</b>	
		<b>Destination</b>	Standard: E-mail/Internet FAX (SMTP), SMB3.0, FTP, FTPS WebDAV, Mail Box Optional: Super G3 FAX, IP Fax
		<b>Address Book</b>	LDAP (2,000)/Local (1,600)/Speed dial (200)
		<b>Send resolution (dpi)</b>	Push: up to 600 x 600 Pull: up to 600 x 600
		<b>Communication protocol</b>	File: FTP(TCP/IP), SMB3.0 (TCP/IP), WebDAV E-mail/I-Fax: SMTP, POP3
		<b>File Format</b>	TIFF, JPEG, PDF(Compact, Searchable, Apply policy, Optimize for Web, PDF/A-1b, Trace & Smooth, Encrypted, Device Signature, User Signature), XPS(Compact, Searchable, Device Signature, User Signature), Office Open XML (PowerPoint, Word)

# TECHNICAL SPECIFICATIONS

# imageRUNNER ADVANCE DX 6800 Series

<b>Universal Send Features</b>	Original Type Selection, Two-sided Original, Book to Two Pages, Different-size Originals, Density Adjustment, Sharpness, Copy Ratio, Erase Frame, Job Build, Delayed Send, Preview, Job Done Notice, File Name, Subject/Message, Reply-to, E-mail Priority, TX Report, Original Content Orientation, Skip Blank Pages	<b>ENVIRONMENTAL SPECIFICATIONS</b>	
<b>FAX SPECIFICATIONS</b>		<b>Operating Environment</b>	Temperature: 10 to 30 °C Humidity: 20 to 80 % RH (Relative Humidity) 220-240 V, 50/60 Hz, 6 A
<b>Maximum Number of Connection Lines</b>	1	<b>Power source</b>	Maximum: iR-ADV DX 6870i: Approx. 2,000 W iR-ADV DX 6860i: Approx. 1,800 W iR-ADV DX 6855i: Approx. 1,800 W Copying (with DADF continuous scan): Approx. 858 W <sup>*1</sup> Standby: Approx. 50.7 W <sup>*2</sup> Sleep mode: Approx. 0.8 W <sup>*2</sup>
<b>Modem Speed</b>	Super G3: 33.6 kbps G3: 14.4 kbps	<b>Power consumption</b>	<sup>*1</sup> Reference value: measured one unit <sup>*2</sup> 0.8 W is not available in all circumstances due to certain settings.
<b>Compression Method</b>	MH, MR, MMR, JBIG	<b>Noise levels (BW)</b>	Typical Electricity Consumption (TEC): iR-ADV DX 6870i: 0.85 kWh iR-ADV DX 6860i: 0.71 kWh iR-ADV DX 6855i: 0.67 kWh  <sup>*</sup> As per USA Energy Star 3.0
<b>Resolution (dpi)</b>	400 x 400 (Ultra Fine), 200 x 400 (Super Fine), 200 x 200 (Fine), 200 x 100 (Normal)		<b>Sound Power Level (LWA,m)</b> Active (1-sided) iR-ADV DX 6870i: 6.6 B*, Kv 0.3 B* iR-ADV DX 6860i: 6.4 B*, Kv 0.3 B* iR-ADV DX 6855i: 6.4 B*, Kv 0.3 B* <sup>*</sup> Reference value: measured only one unit with ISO7779, described with ISO9296 (2017).
<b>Sending/Receiving Size</b>	Sending: A3, A4, A4R, A5 <sup>*1</sup> , A5R <sup>*1</sup> , B4, B5 <sup>*2</sup> , B5R <sup>*1</sup> Receiving: A3, B4, A4, A4R, A5R, B5, B5R  <sup>*1</sup> Sent as A4 <sup>*2</sup> Sent as B4 short		<b>Sound Pressure (LpA,m)</b> Bystander's position: Active (1-sided): 52 dB* (iR-ADV DX 6870i), 51 dB* (iR-ADV DX 6860i) 50 dB* (iR-ADV DX 6855i) Stand-by: 25 dB* <sup>*</sup> Reference value: measured only one unit with ISO7779, described with ISO9296 (2017).
<b>FAX memory</b>	Up to 30,000 pages (2,000 jobs)	<b>Standards</b>	Blue Angel
<b>Speed dials</b>	Max. 200	<b>CONSUMABLES</b>	
<b>Group dials/destinations</b>	Max. 199 dials	<b>Toner Cartridges</b>	C-EXV 61 Toner BK
<b>Sequential broadcast</b>	Max. 256 addresses	<b>Toner Yield (Estimated Yield @6% coverage)</b>	C-EXV 61 Toner BK: 71,500 pages
<b>Memory backup</b>	Yes	<b>SOFTWARE AND PRINTER MANAGEMENT</b>	
<b>Fax Features</b>	Sender's Name (TTI), Selecting the Telephone Line (when sending fax), Direct Send, Delayed Send, Preview, Job Done Notice, TX Report, Interrupt Transmission, Sequential Broadcasting, Password/Subaddress Sending, Confidential Mailbox, 2 on 1 Log	<b>Tracking and reporting</b>	Universal Login Manager (ULM) uniFLOW Online Express <sup>*</sup> For more information, please refer to <a href="#">uniFLOW Online Express</a> <a href="#">uniFLOW Online</a>
<b>STORE SPECIFICATIONS</b>		<b>Remote management tools</b>	iWEMC eMaintenance Content Delivery System
<b>Mail Box (Number supported)</b>	100 User Inboxes, 1 Memory RX Inbox, 50 Confidential Fax Inboxes Maximum 30,000 Pages (2,000 jobs) Stored	<b>Scanning software</b>	Network ScanGear
<b>Advanced Space</b>	Communication Protocol: SMB or WebDAV Supported Client PC: Windows® 8.1/10 Concurrent Connections (Max.): SMB:64, WebDAV:3	<b>Optimisation tools</b>	Canon Driver Configuration Tool
<b>Advanced Space available disc space</b>	Standard:16 GB (With option: max. 480GB)	<b>Platform</b>	MEAP (Multifunctional Embedded Application Platform)
<b>Advanced Space Features</b>	Authentication for Advanced Space Log-in, Sort Function, Printing a PDF File with a Password, imageWARE Secure Audit Manager Support, Search, File Preview, Authentication Management, Open to public, URI TX, Backup/Restore	<b>Document Publishing</b>	Kofax PowerPDF Advanced (Optional)
<b>SECURITY SPECIFICATIONS</b>		<b>PAPER SUPPLY OPTIONS</b>	
<b>Authentication and Access Control</b>	User Authentication (Picture Login, Picture and PIN Login, Card Login*, Username and Password Login, Function Level Login, Mobile Login), Department ID Authentication (Department ID and PIN Login, Function Level Login), uniFLOW Online Express (PIN Login, Picture Login, Picture and PIN Login, Card Login, Card and PIN Login, Username and Password Login, Department ID and PIN Login, Function Level Login), Access Management System (Access Control)  <sup>*</sup> Card readers are optional, please refer to Hardware Accessories Activation is required	<b>Cassette Feeding Unit-AQ1</b>	Paper Capacity: 2 x 550 sheets (80 gsm) Paper Type: Thin, Plain, Recycled, Color, Heavy, Bond, Transparency, Pre-punched, Letterhead Paper Size: A3, A4, A4R, A5, A5R, A6R, B4, B5, B5R Custom size: 98.0 x 148.0 mm to 304.8 x 457.2 mm Paper Weight: 52 to 256 gsm Dimensions (W x D x H): 620 x 660 x 251 mm (attached to the main unit) Weight: Approx. 22 kg
<b>Document Security</b>	Print Security (Secure Print, Encrypted Secure Print, Forced Hold Printing, uniFLOW Secure Print*), Receive Data Security (Confidential Fax Inbox Forwarding Received Documents Automatically), Scan Security (Encrypted PDF, Device Signature PDF/XPS, User Signature PDF/XPS, Adobe LiveCycle® Rights Management ES2.5 Integration), BOX Security (Mail Box Password Protected, Advanced Space Access Control), Send Data Security (Setting for requesting password input per transmission, Restricted E-mail/File send functions, Confirming FAX number, Allow/Restrict Fax Driver Transmissions, Allow/Restrict Sending from History, S/MIME Support), Document Tracking (Secure Watermark) <sup>*</sup> Requires uniFLOW Online / uniFLOW	<b>High Capacity Cassette Feeding Unit-C1</b>	Paper Capacity: 2,450 sheets (80 gsm) Paper Type: Thin, Plain, Recycled, Color, Heavy, Bond, Pre-punched, Letterhead Paper Size: A4 Paper Weight: 52 to 256 gsm Dimensions (W x D x H): 620 x 660 x 251 mm (attached to the main unit) Weight: Approx. 29 kg
<b>Network Security</b>	TLS 1.3, IPSec, IEEE802.1X authentication, SNMP V3.0, Firewall Functionality (IP/MAC Address Filtering), WPA3 support (Wi-Fi), Dual Network Support (Wired LAN/Wireless LAN, Wired LAN/Wired LAN), Disabling Unused Functions (Enabling/Disabling Protocols/Applications, Enabling/Disabling Remote UI, Enabling/Disabling USB Interface), G3 FAX separation from LAN, USB Port separation from LAN, Prohibit the execution of files stored in Advanced Box in the MFP, Scan and Send -Virus Concerns for E-mail Reception	<b>Paper Deck Unit-F1</b>	Paper Capacity: 2,700 sheets (80 gsm) Paper Type: Thin, Plain, Color, Recycled, Heavy, Pre-punched Paper Size: A4, B5 Paper Weight: 52 to 256 gsm Dimensions (W x D x H): 344 x 630 x 440 mm (attached to the main unit) Weight: Approx. 31 kg
<b>Device Security</b>	Protecting SSD Data [SSD Data Encryption (FIPS140-2 Validated), SSD Lock], Standard SSD Initialize, Trusted Platform Module (TPM 2.0), Job Log Conceal Function, Protecting MFD Software Integrity, Checking MFD Software Integrity (Verify System at Startup, Runtime Intrusion Detection enabled with McAfee Embedded Control), HCD-PP Common Criteria Certification (pending confirmation)	<b>OUTPUT OPTIONS*</b>	<sup>*</sup> Paper capacity may vary with different paper type/size.
<b>Device Management and Auditing</b>	Administrator Password, Digital Certificate And Key Management, Audit Log, Cooperating with External Security Audit System (Security Information and Event Management), Image Data Logging, Security Policy Setting	<b>1st Copy Tray Kit-A1</b>	Capacity (with 80gsm paper): A4, A5, A5R, A6R, B5: 250 sheets SRA3, A3, A4R, B4, B5R: 100 sheets Paper Weight: 52 to 300 gsm Dimensions (W x D x H): 454 x 493 x 114 mm Weight: 1.2 kg
		<b>Inner 2way Tray-M1</b>	Tray Capacity (with 80 gsm paper) Upper tray: A4, A5, A5R, A6R, B5: 100 sheets SRA3, A3, A4R, B4, B5R: 50 sheets Lower tray (1st Copy Tray Kit-A1): A4, A5, A5R, A6R, B5: 250 sheets SRA3, A3, A4R, B4, B5R: 100 sheets Paper Weight: 52 to 300 gsm Dimensions (W x D x H): 428 x 405 x 88 mm Weight: Approx. 0.7 kg

# TECHNICAL SPECIFICATIONS

# imageRUNNER ADVANCE DX 6800 Series

<b>3rd Copy Tray Kit-A1</b>	<p>Capacity (with 80gsm paper):  A4, A5R, B5: 100 sheets  A3, A4R, B4, B5R: 75 sheets  Dimensions (W x D x H): 442 x 373 x 176 mm  (attached to the main unit, when the extension tray is extended)  Weight: 0.5 kg</p>	<b>2/4 Hole Puncher Unit-A1</b>	<p>(Requires either the Staple Finisher-AB2 or Paper Folding/Booklet Finisher-A1)  Two or Four Holes  Acceptable Punch Paper Weight: 52 to 300 gsm  Acceptable Punch Paper Size:  Two holes: A3, A4, A4R, A5, B4, B5, B5R  Four holes: A3, A4</p>
<b>Inner Finisher-L1</b> (Not supported for IR-ADV DX 6870i)	<p>Tray Capacity (with 80gsm paper):  Upper Tray: SRA3, A3, A4, A4R, A5, A5R, A6R, B4, B5, B5R: approx. 45 sheets  Lower Tray: A4, A5, A5R, B5: approx. 500 sheets, SRA3, A3, A4R, B4, B5R: 250 sheets, A6R: 30 sheets  Envelope: 10 sheets  Paper Weight: 52 to 300 gsm  Staple Position: Corner, Double  Staple Capacity: (52 to 90 gsm paper)  A4, B5: 50 sheets  A4R: 40 sheets  A3, B4: 30 sheets  Eco Staple:  A3, A4, B4, B5: 10 sheets (52 to 64 gsm)  8 sheets (65 to 81.4 gsm)  6 sheets (82 to 105 gsm)  Staple On Demand: 40 sheets (80 gsm)  Dimensions (W x D x H): 743 x 525 x 225 mm  (attached to the main unit, when the extension tray is extended)  Weight: Approx. 9.1 kg</p>	<b>4 Hole Puncher Unit-A1</b>	<p>(Requires either the Staple Finisher-AB2 or Paper Folding/Booklet Finisher-A1)  Four Holes  Acceptable Punch Paper Weight: 52 to 300 gsm  Acceptable Punch Paper Size:  Four holes A3, A4, A4R, A5, B4, B5, B5R</p>
<b>Staple Finisher-AB2</b>	<p>(Requires Buffer Pass Unit-P2)  Tray Capacity (with 80gsm paper):  Upper Tray: SRA3, A3, A4R, B4, B5R: approx. 250 sheets, SRA3, A3, A4R, B4, B5R: approx. 125 sheets  Lower Tray: A4, A5, A5R, B5: 3,000 sheets, SRA3, A3, A4R, B4, B5R: 1,500 sheets, A6R: 250 sheets  Envelopes: Monarch: 30 sheets, COM10 No.10, DL, ISO-C5: 100 sheets  Paper Weight:  Upper Tray 52 to 256 gsm,  Lower Tray 52 to 300 gsm  Staple Position: Corner, Double  Staple Capacity: (52 to 90 gsm)  A4, B5: 50 sheets  A4R: 40 sheets  A3, B4: 30 sheets  Eco Staple:  A3, A4: 10 sheets (52 to 64 gsm)  8 sheets (65 to 81.4 gsm)  6 sheets (82 to 105 gsm)  Staple On Demand: 50 sheets (52 to 90 gsm)  Dimensions (W x D x H): 637 x 623 x 1,142 mm  (when the extension tray is extended)  Weight: Approx. 31 kg</p>	<b>HARDWARE ACCESSORIES</b> <b>Card Readers</b>  <b>Others</b>  <b>SECURITY OPTIONS</b> <b>Data Security</b>	<p>Various card readers available e.g. MiCard Plus. Please contact local Canon Office for more details  Copy Card Reader-F1  IC Card Reader Box for Numeric Keypad-A1   Printer Cover-M2  Tab Feeding Attachment-F1  Buffer Pass Unit-P2  Utility Tray-B1  Numeric Keypad-A2  Instant Stapler-B1 (optional)</p> <p>250GB SSD-A1 (usage with Memory Mirroring Kit-A1)  1TB SSD-A1  Memory Mirroring Kit-A1</p>
<b>Paper Folding/Booklet Finisher-A1</b>	<p>(Requires Buffer Pass Unit-P2)  (Includes the above Staple Finisher-AB2 basic staple specifications.)  Saddle Stitch paper size: A3, A4R, B4  Saddle Stitch Staple Capacity: 20 sheets x 10 sets (52 to 81.4 gsm) (including 1 cover sheet 52 to 256 gsm)  V-fold Capacity: up to 3 sheets (52 to 105 gsm)  C-fold Capacity: up to 5 sheets (52 to 128 gsm)  Dimensions (W x D x H): 637 x 623 x 1,142 mm  (when the extension tray is extended)  Weight: Approx. 57 kg</p>	<b>SYSTEM AND CONTROLLER OPTIONS</b> <b>Print Accessories</b>  <b>Barcode Printing</b> <b>System Accessories</b>  <b>Fax Accessories</b>	<p>PCL International Font Set-A1  PS Printer Kit-BC1  Barcode Printing Kit-D1  Copy Control Interface Kit-A1  Serial Interface Kit-K3  Connection Kit-A3 for Bluetooth LE  Super G3 FAX Board-AX1  Remote Fax Kit-A1  IP FAX Expansion Kit-B1</p>
<b>Paper Folding Unit-L1</b>	<p>(Requires Buffer Pass Unit-P2 &amp; external finisher)  Paper size: A3, A4, B4  Z-fold Capacity: 1 sheet (52 to 105 gsm)  Dimensions (W x D x H): 201 x 579 x 896 mm  Weight: Approx. 12 kg</p>	<b>OTHER OPTIONS</b> <b>Accessibility Accessories</b>	<p>ADF Access Handle-A1  Voice Guidance Kit-G1  Voice Operation Kit-D1</p>
<b>Inner 2/4 Hole Puncher-D1</b> (Not supported for IR-ADV DX 6870i)	<p>(Requires the Inner Finisher-L1)  Two or Four Holes  Acceptable Punch Paper Weight: 52 to 300 gsm  Acceptable Punch Paper Size:  Two holes: A3, A4, A4R, A5, B4, B5, B5R  Four holes: A3, A4</p>	<b>Consumables</b>  <b>Device Protection</b>	<p>Staple-P1 (2 x 5,000pcs)  Staple Cartridge-Y1 (2 x 2,000pcs)*  * For Booklet Finisher only  Antimicrobial Film* - Various Sheets designed to fit the devices most common touch points.  *Application by a Service engineer is recommended</p>
<b>Inner 4 Hole Puncher-D1</b> (Not supported for IR-ADV DX 6870i)	<p>(Requires the Inner Finisher-L1)  Four Holes  Acceptable Punch Paper Weight: 52 to 300 gsm  Acceptable Punch Paper Size:  Four holes: A3, A4, A4R, A5, B4, B5, B5R</p>		

## Software & Solutions



## Certifications and compatibility



**Canon Ireland**  
3006 Lake Drive  
Citywest, Saggart  
Co. Dublin, Ireland  
Telephone No: 01 2052400  
Facsimile No: 01 2052525  
canon.ie

**Canon (UK) Ltd**  
The Bower  
4 Roundwood Avenue  
Stockley Park  
Uxbridge  
Middlesex  
UB11 1AF

**Canon Inc.**  
canon.com  
**Canon Europe**  
canon-europe.com  
English edition  
© Canon Europa N.V., 2022

