

THE ULTIMATE ENTRY LEVEL A3 BLACK AND WHITE MULTIFUNCTION PRINTER FOR CORE OFFICE NEEDS.

Black and white A3 multifunction printers ideal for small workgroups needing reliable high-quality printing and scanning.

imageFORCE 4000 Series



BOOST PRODUCTIVITY

Work faster with rapid start-up, and rock-solid reliability to help teams keep business moving. Compatibility with uniFLOW Online and Cloud Connector ensures seamless connectivity to workflows

SMOOTH USER EXPERIENCE

Simple, intuitive and quiet. Helping everyone get more done with clear on-screen steps, easy controls and a smart preview that shows your print exactly as it will appear - no surprises.

RELIABLE, PROACTIVE SECURITY

Guard every document with 360° protection, AI-driven security settings and strong authentication. Your data stays encrypted, your devices stay defended, and your teams stay confidently productive.

MEET SUSTAINABILITY TARGETS

Reduced power consumption, long-life components and recycled materials make every print a smarter choice for your business – and a lighter one for the planet.

imageFORCE 4000 Series

MAIN CONFIGURATION OPTIONS

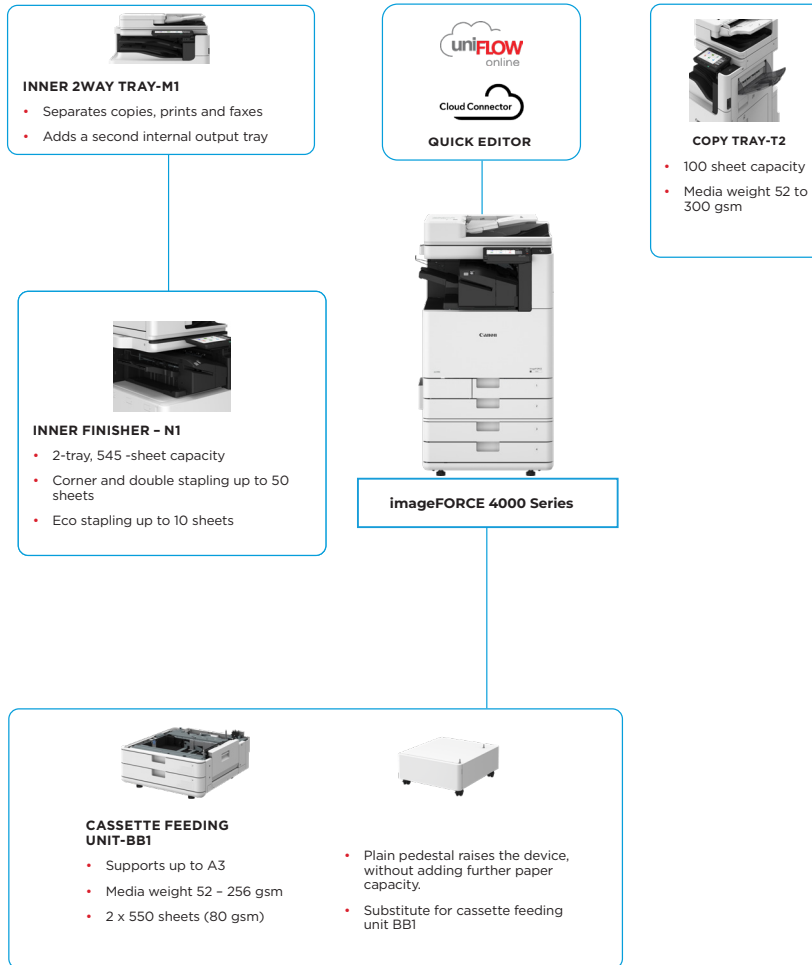

This flat configuration is for illustration purpose only. For a complete list of options and the exact compatibility relationships, please refer to the [online product configurator](#).

TECHNICAL SPECIFICATIONS

imageFORCE 4000 Series

MAIN UNIT	
Machine Type	A3 Monochrome Multifunctional
Core Functions	Print, Copy, Scan, Send and Optional Fax
Processor	1.6GHz Dual Core Processor
Control Panel	7 inch TFT LCD WVGA Color Touch panel
Memory	Standard: RAM 3.0GB
Storage	Standard: 64GB eMMC Optional: 256GB SSD
Interface Connection	<p>NETWORK Standard: 1000Base-T/100Base-TX/10Base-T, Wireless LAN (IEEE 802.11 b/g/n)</p> <p>OTHERS Standard: USB 2.0 (Host) x2, USB 2.0 (Device) x1</p>
Paper Supply Capacity (A4, 80gsm)	Standard: 1,200 sheets 100 sheets: Multi-purpose tray x 1 550 sheets: Standard Cassette x 2 Maximum: 2,300 sheets (with Cassette Feeding Unit-BB1)
Paper Output Capacity (A4, 80gsm)	Standard: 250 sheets Maximum: 645 sheets (with Inner Finisher-N1 and Copy Tray-T2)
Finishing Capabilities	Collate, Group, Offset, Staple, Hole Punch, Eco Staple, Staple On Demand * Finishing capabilities vary depending on the options connected.
Supported Media Types	<p>Multi-purpose tray: Thin, Plain, Recycled, Color, Heavy, Coated*, Tracing, Bond, Transparency, Labels, Pre-punched, Letterhead, Envelope * 257-300gsm requires Media Adjustment Kit-A1</p> <p>Upper Cassette: Thin, Plain, Recycled, Color, Heavy, Bond, Transparency, Pre-punched, Letterhead, Envelope</p> <p>Lower Cassette: Thin, Plain, Recycled, Color, Heavy, Bond, Transparency, Pre-punched, Letterhead, Envelope* * Envelope Feeder Attachment A (standard) is required.</p>
Supported Media Sizes	<p>Multi-purpose tray: Standard size: SRA3, A3, A4, A4R, A5, A5R, A6R, B4, B5, B5R Custom size: 98.4 x 139.7 mm to 320.0 x 457.2 mm Free size: 100.0 x 148.0 mm to 304.8 x 457.2 mm Envelopes: COM10 No.10, Monarch, ISO-C5, DL Envelope custom size: 98.0 x 98.0 mm to 320.0 x 457.2 mm</p> <p>Upper Cassette: Standard size: A4, A5, A5R, A6R, B5 Custom Size: 105.0 x 148.0 mm to 297.0 x 215.9 mm Envelopes: ISO-C5</p> <p>Lower Cassette: Standard size: A3, A4, A4R, A5, A5R, A6R, B4, B5, B5R Custom Size: 105.0 x 148.0 mm to 304.8 x 457.2 mm Envelopes*: COM10 No.10, Monarch, DL * Envelope Attachment A (standard) is required.</p>

Supported Media Weights	<p>Multi-purpose tray: 52 to 300 gsm (Only 60 to 300 gsm supported with Media Adjustment Kit-A1*) * Media Adjustment Kit-A1 is required for Coated (257-300gsm) Upper/Lower Cassette: 52 to 256 gsm Duplex: 52 to 220 gsm</p>
Warm-up Time (Quick start mode: ON)	<p>4 Seconds From Sleep Mode: 10 seconds</p>
Dimensions (W x D x H)	565 x 712 x 862 mm
Installation Space (W x D)	<p>Basic : 978 x 1,152 mm (right door & multi-purpose tray opened + paper cassette opened) Fully Configured: 1,146 x 1,152 mm (with DADF-F1/DADF-G1 + Inner Finisher tray max extended + Copy Tray-T2 max extended + paper cassette opened)</p>
Weight* *including regular toner	Approx. 69 kg
PRINT SPECIFICATIONS	
Print Speed(BW)	<p>imageFORCE 4045: 1-sided: Up to 45 ppm (A4), Up to 22 ppm (A3), Up to 25 ppm (A4R) 2-sided: Up to 45 ppm (A4), Up to 22 ppm (A3), Up to 25 ppm (A4R)</p> <p>imageFORCE 4030: 1-sided: Up to 30 ppm (A4), Up to 15 ppm (A3), Up to 15 ppm (A4R) 2-sided: Up to 30 ppm (A4), Up to 15 ppm (A3), Up to 15 ppm (A4R)</p> <p>imageFORCE 4025: 1-sided: Up to 25 ppm (A4), Up to 15 ppm (A3), Up to 15 ppm (A4R) 2-sided: Up to 25 ppm (A4), Up to 15 ppm (A3), Up to 15 ppm (A4R)</p>
Print Resolution (dpi)	4,800 x 2,400
Page Description Languages	Standard: UFR II, PCL6/PCL5 Optional: Adobe® PostScript®3TM
Printing From Mobile And Cloud	<p>AirPrint, Mopria, IPP Everywhere, Canon PRINT, uniFLOW Online, Universal Print and Cloud Connector</p> <p>A range of software and MEAP-based solutions are available to provide printing from mobile devices or internet-connected devices and cloud-based services depending on your requirements. Please contact your sales representative for further information</p>
OS Standard Printing	Android, Windows® 11, Chrome OS, macOS (11.2.2 or later), iOS (15.2 or later), iPadOS
Fonts	<p>PS fonts: 136 Roman PCL fonts: 93 Roman, 10 Bitmap fonts, 2 OCR fonts, Andalé Mono WT J/K/S/T*1 (Japanese, Korean, Simplified and Traditional Chinese) , Barcode fonts*2</p> <p>*1 Optional PCL International Font Set-A1 is required. *2 Optional Barcode Printing Kit-D1 is required.</p>

TECHNICAL SPECIFICATIONS

imageFORCE 4000 Series

Print Features	Secure Print, Secure Watermark, Header/Footer, Page Layout, Two-sided Printing, Mixed Paper Sizes/ Orientations, Toner Reduction, Poster Printing, Forced hold printing, Print Date, Scheduled Printing, Printing Using a Virtual Printer, Compatible with Quick Editor
Operating System	UFR II: Windows® 11/Server2016/Server2019/Server2022/Server2025*, macOS(11.7 or later)* PCL: Windows® 11/Server2016/Server2019/Server2022/Server2025* PS: Windows® 11/Server2016/Server2019/Server2022/Server2025*, macOS(11.7 or later)* PPD: Windows® 11, macOS(11.7 or later)* * As of Oct. 2025

COPY SPECIFICATIONS

Copy Speed (BW)	imageFORCE 4045: 1-sided: Up to 45 ppm (A4), Up to 22 ppm (A3), Up to 25 ppm (A4R) 2-sided: Up to 45 ppm (A4), Up to 22 ppm (A3), Up to 25 ppm (A4R) imageFORCE 4030: 1-sided: Up to 30 ppm (A4), Up to 15 ppm (A3), Up to 15 ppm (A4R) 2-sided: Up to 30 ppm (A4), Up to 15 ppm (A3), Up to 15 ppm (A4R) imageFORCE 4025: 1-sided: Up to 25 ppm (A4), Up to 15 ppm (A3), Up to 15 ppm (A4R) 2-sided: Up to 25 ppm (A4), Up to 15 ppm (A3), Up to 15 ppm (A4R)
First-Copy-Out Time (A4)	imageFORCE 4045: 5.3 seconds imageFORCE 4030: 7.0 seconds imageFORCE 4025: 7.0 seconds
Copy Resolution (dpi)	600 x 600
Multiple Copies	Up to 9,999 copies
Magnification	Variable zoom: 25% to 400% (1% Increments)
Copy Features	Preset R/E Ratios by Area, Two-Sided, Density Adjustment, Original Type Selection, Interrupt Mode, Book to Two Pages, Two-sided Original, Sort, Job Build, N on 1, Different Size Originals, Sharpness, Erase Frame, Gutter, Copy ID Card, Skip Blank Pages, Free Size Original, Reserved copy, Copy Sample

SCAN SPECIFICATIONS

Type	imageFORCE 4045: Standard: Color Scanner, DADF-F1* [2-sided to 2-sided] imageFORCE 4030/4025: Standard: Color Scanner, DADF-G1* [2-sided to 2-sided] * Multi-Sheet Feed Detection is supported as an option. DADF: Duplexing Automatic Document Feeder
Document Feeder Paper Capacity (80 gsm)	up to 100 sheets

Document Feeder Acceptable Paper Weight	Document Feeder media weight : 1-sided scanning: 38 to 128 gsm 2-sided scanning: 50 to 128 gsm
Supported Media Sizes	Platen: max. scanning size: 297.0 x 431.8 mm A3, A4, A4R, A5, A5R, A6R, B4, B5, B5R, B6R Custom size: 48.0 x 85.0 mm to 304.8 x 431.8 mm
Scan Speed (ipm, BW/CL, A4)	Single Pass DADF-F1 (for imageFORCE 4045): 1-sided Scanning: 80/80 (300 x 300 dpi, send) 2-sided Scanning: 120/120 (300 x 300 dpi, send) Single Pass DADF-G1 (for imageFORCE 4030/4025): 1-sided Scanning: 35/35 (300 x 300 dpi, send) 2-sided Scanning: 70/70 (300 x 300 dpi, send)
Scan Resolution (dpi)	600 x 600
Pull Scan Specifications	Colour Network ScanGear2. For both TWAIN and WIA Supported OS: Windows®11/Server 2016/Server 2019/Server 2022/Server 2025* *As of Oct. 2025
Scan Method	Push Scan, Pull Scan, Scan to Network, Scan to memory media (USB Memory Key), Scan to Mobile Devices, Scan to cloud-based services (uniFLOW Online)

SEND SPECIFICATIONS

Destination	Standard: E-mail/Internet FAX (SMTP*), SMB, FTP, SFTP, FTPS, WebDAV Optional: Super G3 FAX * Available OAuth 2.0 authentication method on Microsoft Exchange Online and Google Workspace
Address Book	LDAP (2,000)/ Local (1,600) /Speed dial (200)
Communication Protocol	File: FTP (TCP/IP), SFTP (TCP/IP), FTPS (TCP/IP), SMB3.1.1 (TCP/IP), WebDAV E-mail/iFAX: SMTP(send), POP3(receive)
File Format	Standard: TIFF (MMR), JPEG*, PDF (Compact, Searchable, PDF/A-1a, A-1b, PDF/A-2a, PDF/A-2b, PDF/A-2u, PDF/A-3a, PDF/A-3b, PDF/A-3u, Trace&Smooth, Encrypted), XPS (Compact, Searchable), PDF/XPS (Device Signature, User Signature), Office Open XML (PowerPoint, Word) Option: PDF(Trace & Smooth), PDF/XPS (User Signature) * Single-Page only.
Universal Send Features	Original Type Selection, Two-sided Original, Book to Two Pages, Different-size Originals, Density Adjustment, Sharpness, Erase Frame, Job Build, Delayed Send, Preview, Job Done Notice, File Name, Subject/Message, Reply-to, E-mail Priority, TX Report, Original Content Orientation, Skip Blank Originals, Dropout Color

FAX SPECIFICATIONS

Maximum Number Of Connection Lines	1
Modem Speed	Super G3: 33.6 kbps G3: 14.4 kbps

TECHNICAL SPECIFICATIONS

imageFORCE 4000 Series

Compression Method	MH, MR, MMR, JBIG
Resolution (dpi)	400 x 400 (Ultra Fine), 200 x 400 (Super Fine), 200 x 200 (Fine), 200 x 100 (Normal)
Sending/Receiving Size	Sending: A3, A4, A4R, A5*1, A5R*1, B4, B5*2, B5R*1 Receiving: A3, A4, A4R, A5, A5R, B4, B5, B5R *1 Sent as A4 *2 Sent as B4 short
FAX Memory	Up to 30,000 pages (2,000 jobs)
Speed Dials	Max. 200
Group Dials/Destinations	Max. 199 dials
Sequential Broadcast	Max. 256 addresses
Memory Backup	Yes
Fax Features	Sender's Name (TTI), Direct Send, Delayed Send, Preview, Job Done Notice, TX Report, Interrupt Transmission, Sequential Broadcasting, Password/Subaddress Sending, Confidential Mailbox

SECURITY SPECIFICATIONS

Authentication And Access Control	User Authentication (Picture Login, Picture and PIN Login, Card Login, Username and Password Login, Function Level Login, Mobile Login), Department ID Authentication (Department ID and PIN Login, Function Level Login), uniFLOW* (PIN Login, Picture Login, Picture and PIN Login, Card Login, Card and PIN Login, Username and Password Login, Department ID and PIN Login, Function Level Login), Microsoft Entra ID Authentication (Password Login, Card Login), Google Workspace (Password Login, Card Login), Two-Factor Authentication at LUI/RUI, Access Management System (Access Control) * including uniFLOW Online/uniFLOW
Document Security	Print Security(Secure Print, Encrypted SecurePrint, Forced Hold Printing, uniFLOW Secure Print*1), Receive Data Security(Confidential Fax Inbox Forwarding Received Documents Automatically), Scan Security (Encrypted PDF, Device Signature PDF/XPS, User Signature PDF/XPS*2), Send Data Security(Setting for requesting password input per transmission, Restricted E-mail/File send functions, Confirming FAX number, Allow/Restrict Fax Driver Transmissions, Allow/Restrict Sending from History, S/MIME Support) *1 Requires optional uniFLOW Online / uniFLOW *2 Requires optional Universal Send Digital User Signature Kit-C1
Network Security	TLS 1.3, IPSec, IEEE802.1X authentication, SNMP V3.0, Firewall Functionality (IP/MAC Address Filtering), WPA3 support, Dual Network Support(Wired LAN/Wireless LAN, Wired LAN/Wired LAN), Enabling/Disabling(Network Applications, Remote UI, USB Interface), G3 FAX separation from LAN, USB Port separation from LAN, Scan and Send -Virus Concerns for E-mail Reception

Device Security	Standard Storage Initialize, Job Log Conceal Function, Protecting MFP Software Integrity: Verify System at Startup (NIST SP800-193: Protection), Checking MFP Software Integrity & Platform Firmware Resiliency: Automatic System Recovery (NIST SP800-193: Recovery), Runtime Intrusion Detection: Trellix Embedded Control
------------------------	--

Device Management And Auditing	Administrator Password, Digital Certificate and Key Management, SAN certificates, Audit Log, Cooperating with External Security Audit System (SIEM), Security Policy Setting
---------------------------------------	--

ENVIRONMENTAL SPECIFICATIONS

Operating Environment	Temperature: 10 to 30 °C Humidity: 20 to 80% RH (Relative Humidity)
Power Source	220-240V 50/60Hz 4A

Power Consumption	Maximum: Approx. 1,500 W Copying (with DADF continuous scan): Approx. 642 W*1 Standby: Approx. 96W*1 Sleep Mode: Approx. 0.8W*2 *1 Reference value: measured one unit *2 0.8W is not available in all circumstances due to certain settings.
--------------------------	--

Typical Electricity Consumption (TEC)* :
imageFORCE 4045: 0.48 kWh
imageFORCE 4030: 0.29 kWh
imageFORCE 4025: 0.24 kWh

*As per USA Energy Star 3.2

For detailed information relating to Erp:Lot6/26 regulation, please go to:
https://www.canon-europe.com/for_work/lot26/

Noise Levels	Sound Power Level (LWA,m) Active (BW)(1-sided) imageFORCE 4045: 64dB, Kv 3dB imageFORCE 4030: 61dB, Kv 3dB imageFORCE 4025: 61dB, Kv 3dB
---------------------	--

Sound Pressure (LpAm)
Bystander's position:
Active(BW)(1-sided/2-sided):
imageFORCE 4045: 50dB
imageFORCE 4030: 47dB
imageFORCE 4025: 47dB
* Reference value: measured only one unit with ISO7779, described with ISO9296 (2017)

Stand-by:
Noise-free*
**"Noise-free" means that the sound pressure level at each bystander position is below the absolute criterion for background noise specified in ISO 7779.

Standards for Environmentally Friendliness	Blue Angel (Validation pending)
---	---------------------------------

CONSUMABLES

Toner Cartridge/s	Toner 1011 BK
Toner (Estimated Yield @ 6% Coverage)	Toner 1011 BK: 30,000 pages

TECHNICAL SPECIFICATIONS

imageFORCE 4000 Series

SOFTWARE AND PRINTER MANAGEMENT	
Tracking & Reporting	uniFLOW Online
Remote Management Tools	iW Enterprise Management Console Remote Distribution & Management Service Monitoring Service
Print Support Application	Canon Print Assistant Quick Editor
Scanning Software	Color Network ScanGear 2
Optimisation Tools	Canon Driver Configuration Tool
Platform	MEAP (Multifunctional Embedded Application Platform)

PAPER SUPPLY OPTIONS	
CASSETTE FEEDING UNIT-BB1	Paper Capacity: 2 x 550 sheets (80 gsm) Paper Type: Thin, Plain, Recycled, Color, Heavy, Bond, Transparency, Pre-punched, Letterhead Paper Size: A3, A4, A4R, A5, A5R, A6R, B4, B5, B5R Custom size: 105.0 x 148.0 mm to 304.8 x 457.2 mm Paper Weight: 52 to 256 gsm

OUTPUT OPTIONS	
Inner 2way Tray-M1	Capacity (with 80 gsm paper) Upper tray: A4, A5, A5R, A6R, B5: 100 sheets SRA3, A3, A4R, B4, B5R: 50 sheets Lower tray (standard tray): A4, A5, A5R, A6R, B5: 250 sheets SRA3, A3, A4R, B4, B5R: 100 sheets Paper Weight: 52 to 300 gsm
Copy Tray-T2	Capacity (with 80gsm paper): A4, A5R, B5: 100 sheets A3, A4R, B4, B5R: 75 sheets Paper Weight: 52 to 220 gsm
Inner Finisher-N1	Tray Capacity (with 80gsm paper): Upper Tray: SRA3, A3, A4, A4R, A5, A5R, A6R, B4, B5, B5R: approx. 45 sheets Lower Tray: A4, A5, A5R, B5: approx. 500 sheets A3, A4R, B4, B5R: 250 sheets A6R: 30 sheets SRA3, Envelope: 10 sheets Paper Weight: 52 to 300 gsm Staple Position: Corner, Double Staple Capacity: (52 to 90 gsm) A4, B5: 50 sheets A4R: 40 sheets A3, B4: 30 sheets Eco Staple: A3, A4, B4, B5: 10 sheets (52 to 64 gsm) 8 sheets (65 to 81.4 gsm) 6 sheets (82 to 105 gsm) Staple On Demand: approx. 40 sheets (80 gsm)

Inner 2/4 Hole Puncher-D1	(Requires Inner Finisher-N1) Two or Four Holes Acceptable Punch Paper Weight: 52 to 300 gsm Acceptable Punch Paper Size: Two holes A3, A4, A4R, A5, B4, B5, B5R Four holes A3, A4
Inner 4 Hole Puncher-D1	(Requires Inner Finisher-N1) Four Holes Acceptable Punch Paper Weight: 52 to 300 gsm Acceptable Punch Paper Size: Four holes A3, A4, A4R, A5, B4, B5, B5R

HARDWARE ACCESSORIES	
Card Readers	IC Card Reader Attachment-B4
Others	Document Feeder Double Feeding Detection Kit-A1 Option Attachment kit for Reader-A2 Media Adjustment Kit-A1 Utility Tray-B1 (imageFORCE 4045 only)

SYSTEM AND CONTROLLER OPTIONS	
Print Accessories	PS Printer Kit-BT1 PCL International Font Set-A1
Send Accessories	Universal Send Trace & Smooth PDF Kit-A1 Universal Send Digital User Signature Kit-C1
Barcode Printing	Barcode Printing Kit-D1
System Accessories	Optional Data Storage Kit-B1
Fax Accessories	Super G3 FAX Board-BV1 Remote Fax Kit-A1

OTHER OPTIONS	
Staple Cartridges	Staple Cartridge-Z1
Accessibility Accessories	ADF Access Handle-A1



Certifications and compatibility



Canon Ireland
3006 Lake Drive
Citywest, Saggart
Co. Dublin, Ireland
Telephone No: 01 2052400
Facsimile No: 01 2052525
canon.ie

Canon (UK) Ltd
The Bower
4 Roundwood Avenue
Stockley Park
Uxbridge
UB11 1AF

Canon Inc.
Canon.com
Canon Europe
canon-europe.com
English Edition
© Canon Europa N.V. 2026