

## Egli mast foundation grapple

The heart of the grab is the massive and centrally located hydraulic cylinder, which can be operated at up to 350 bar. Strong lateral forces are kept away from the cylinder by the specially developed positive guidance and are diverted directly to the body designed for this purpose.

The rotary movement is carried out with a robust spur gear and can thus be rotated endlessly through 360°. To withstand the wear and tear and the high forces, the shells are made entirely of Hardox. The slim design of the screwed teeth reduces the penetration resistance of the shells to a minimum.

Due to the external linkage of the shells, the complete interior of the shell (190 l) can be filled with excavated material and is not hindered by internal deflectors. The entire grab is designed for the operating loads of a 22 t excavator.



Mainly used in track construction, especially for time-saving excavation of mast foundation holes thanks to the large capacity (190 l) of the trays.



Mast foundation grab  
Application video

Gripper Type	Weight class carrier t	static pressure (DBV carrier) max. bar	Oil requirement max. l/min	Closing force max. kN	Bulk density up to t/m <sup>3</sup>	Content ISO
EMFG 200-900	13 - 22	350 G / 180 D)	58 G / 39 D)	53	2	190 l

### Technical data

Gripper EMFG 200-900 Variant	Height A open mm	Width A closed mm	Width B open* mm	Width C closed mm	Depth D side mm	Weight without adapter
oscillating with slewing gear	1'570	1'835	926	736	900	850
Rigid with rotary motor	1'143	1'407	926	736	900	900
Rigid without slewing gear	908	1'173	926	736	900	690

\* Max. Width may vary depending on tooth system.

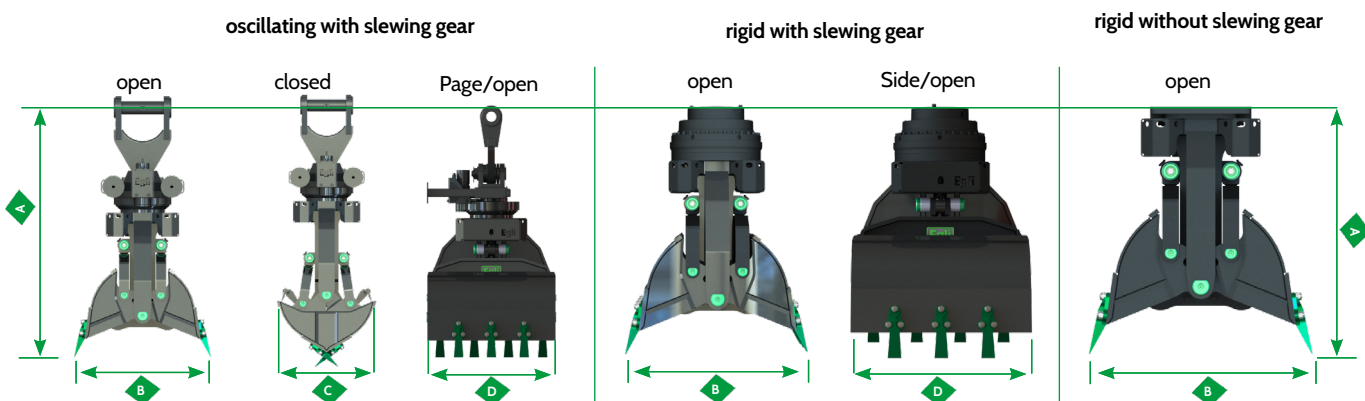

# Transport racks

## Tailor-made

We design the right transport frame for each attachment. This can be ordered as an option.

Our equipment from the rental park is always delivered with the corresponding frame.

We thus guarantee smooth transport from Rossrüti to our customers and, in turn, easier handling for them on the construction site.

Accessories, documents (operating instructions, etc.) - everything is always in its place and immediately at hand when needed.

On request, we also manufacture customised transport racks for existing devices and third-party products. Just ask us!



Transport rack multi-purpose and Sorting grab

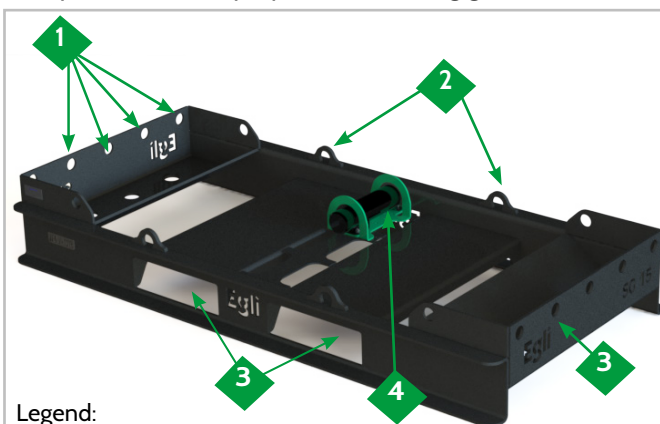

Legend:

- 1 4 fastening eyelets on each end face
  - 2 2 fastening eyelets on each side
  - 3 Access for pallet trucks and forklifts from all four sides
  - 4 Document tube
- + Optionally also available with

Transport rack pendulum grab



Transport rack Pole foundation grab\*

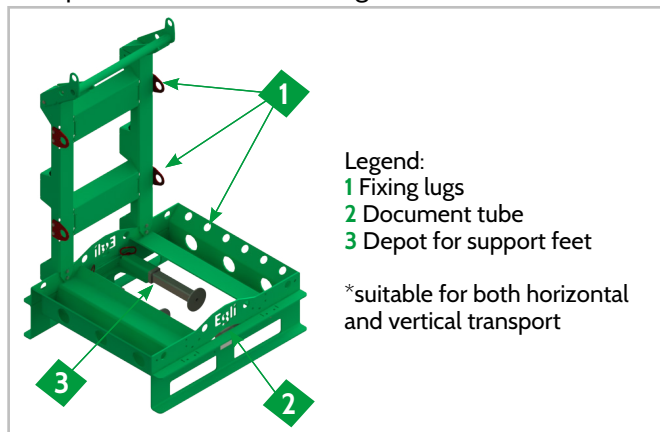

Legend:

- 1 Fixing lugs
- 2 Document tube
- 3 Depot for support feet

\*suitable for both horizontal and vertical transport

