

RAIL GUIDANCE SYSTEM [RGS]

Rail Guidance System

Hitachi - ZX170W-5	350 Wheel Cartridge Assy	HR-WH-A-350-I	1
Hitachi - ZX140W-5	Insulation Kit - 350 Rail Wheel	INSULATION KIT - 350	1
Hyundai - 170W-9	Bolt Set Suit 350x90 Bolt New	BOLT-WHEEL-350X90 SET	1
Caterpillar - M314	HBHR Lock Plate 8mm G250	HR-WH-FLG-325-3 4	1
Caterpillar - M318	RGS 350 dia wheel H/T ANZR1	HR-WH-RIM-350-AN-I-HT	1
Caterpillar - M322	350/325 - Hub Assembly	WH-HUB-TRAILER	1
Komatsu - PW148	325/400 Wheel Hub - Cartridge	HR-HUB-325-I-TR	1
Doosan - DX140W	Grease Seal Wheel Hub 110x70x10	SEAL-GREASE-110X70X10	2
	Bearing Tap-Wheel-110x60x29.75	BEARING-TAP-110X60X29.75	2
	Stub Axle for 325/400 Wheels	HR-M-002	1
	Locking Washer M60	LOCK-WASHER-M60	1
	Spacer - Rail Wheel - 70x60x12	HR-M-001	1
	Locking Nut M60	LOCK-NUT-M60	1

New style roller bearing setup from
WE/077/0116



Rail Guidance System

Hitachi - ZX170W-3	HI Rail 350 Wheel Cartridge Assy	HR-WHEEL-350	1
	Insulation Kit - 350 Rail Wheel	INSULATION KIT - 350	1
Old Design Flat Black Rail Wheel Setup to WE/76/0515	Bolt Set Suit 350x100 Bolt New set of 6	BOLT-WHEEL-350X100 SET	1
	RGS 350 dia wheel H/T ANZR1	HR-WHEEL-RIM-350	1
	Bearing-350Wheel-DG Groove	Bearing-125 x 70 x 24	2
	Lock Plate - Wheel 400/350/325	HR-COM-P17171	1
	Hub Retainer Ring (Steel)	HR-COM-M-0001	1
	Hi-Rail Axle	HR-M-0006	1
	Axle Bush	HR-M-0005	1
	Axle Lock Plate	HR-COM-F-0006	1
	Hub - 350 Rail Wheel	HR-HUB-350	1

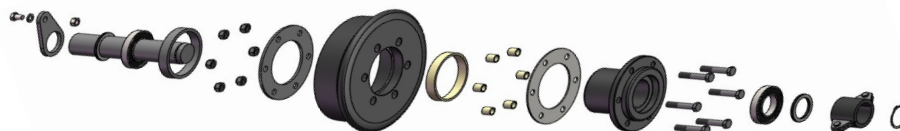

For up to date pricing email info@harrybilt.com or call on **03 5339 4859**.

Harrybilt Engineering has an extensive range of spare parts available for immediate delivery.



**VIEW OUR ROAD RAIL
VEHICLES ONLINE AT:**
[harrybilt.com.au/
road-rail-vehicles](http://harrybilt.com.au/road-rail-vehicles)



10 Golden Crescent, BALLARAT VIC 3350 | P: 03 5339 4859
E: info@harrybilt.com.au | W: www.harrybilt.com.au