









# CASEMENT

Thermally broken window that allows for both side hung and top hung outward openings. This solution, with a thermal break zone of 32 mm and a transmittance  $U_w$  from 1.0  $W/m^2K$ , has the British security certification PAS 24, being especially suitable for this market.

FEATURES		
Transmittance		$U_w \geq 0.9 (W/m^2K)$
Acoustic insulation		Rw up to 45 dB
Air permeability		Class 4
Water tightness		Class E1200
Wind resistance		Class CE 2400
Security test	 	Passed

Reference test 1.438 x 1.33 m / 1 sash + 1 fixed light  
Security test: Reference test 1.438 x 1.33 m / 1 sash

POSSIBILITIES

 SECURITY HARDWARE

 CONCEALED HINGES

OPENING POSSIBILITIES











Outward Opening  
Side hung  
Top hung

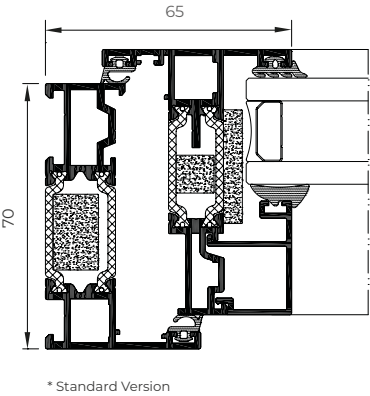
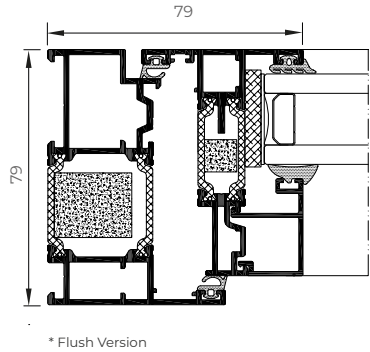

Thermally broken

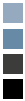

### Sightlines

Frame 70 mm, Sash 70 mm

### Polyamide Strip Length

32 mm

### Profile Thickness

Window 1.6 mm

### Glazing

Max. 44 mm, Min. 23 mm

### Maximum Sash Dimensions

#### Slim Sash (Side Hung):

Width (L) 950 mm, Height (H) 1300 mm

#### Slim Sash (Top Hung):

Width (L) 1200 mm, Height (H) 1300 mm

#### Heavy Duty Sash (Side Hung):

Width (L) 750 mm, Height (H) 1750 mm

#### Heavy Duty Sash (Top Hung):

Width (L) 1800 mm, Height (H) 1800 mm

### Maximum Sash Weight

Side Hung Slim Sash: 35 kg

Top Hung Slim Sash: 50 kg

Side Hung Heavy Duty Sash: 42 kg

Top Hung Heavy Duty Sash: 100 kg

Consult maximum weight and dimensions according to typologies



CASEMENT