

## Fiber Optic and what it is?

Fiber is a data connection carried by a cable filled with thin glass or plastic fibers. Data travels through them as beams of light pulse in a pattern that allows speeds about 20 times faster than regular cable and satellite connections. Fiber can make this a reality without interruptions!

Edge Broadband will contact Diggers Hotline for them to come to mark other buried utilities in the path of your temporary fiber line. Edge Broadband buries the line within 1-3 weeks, weather permitting.

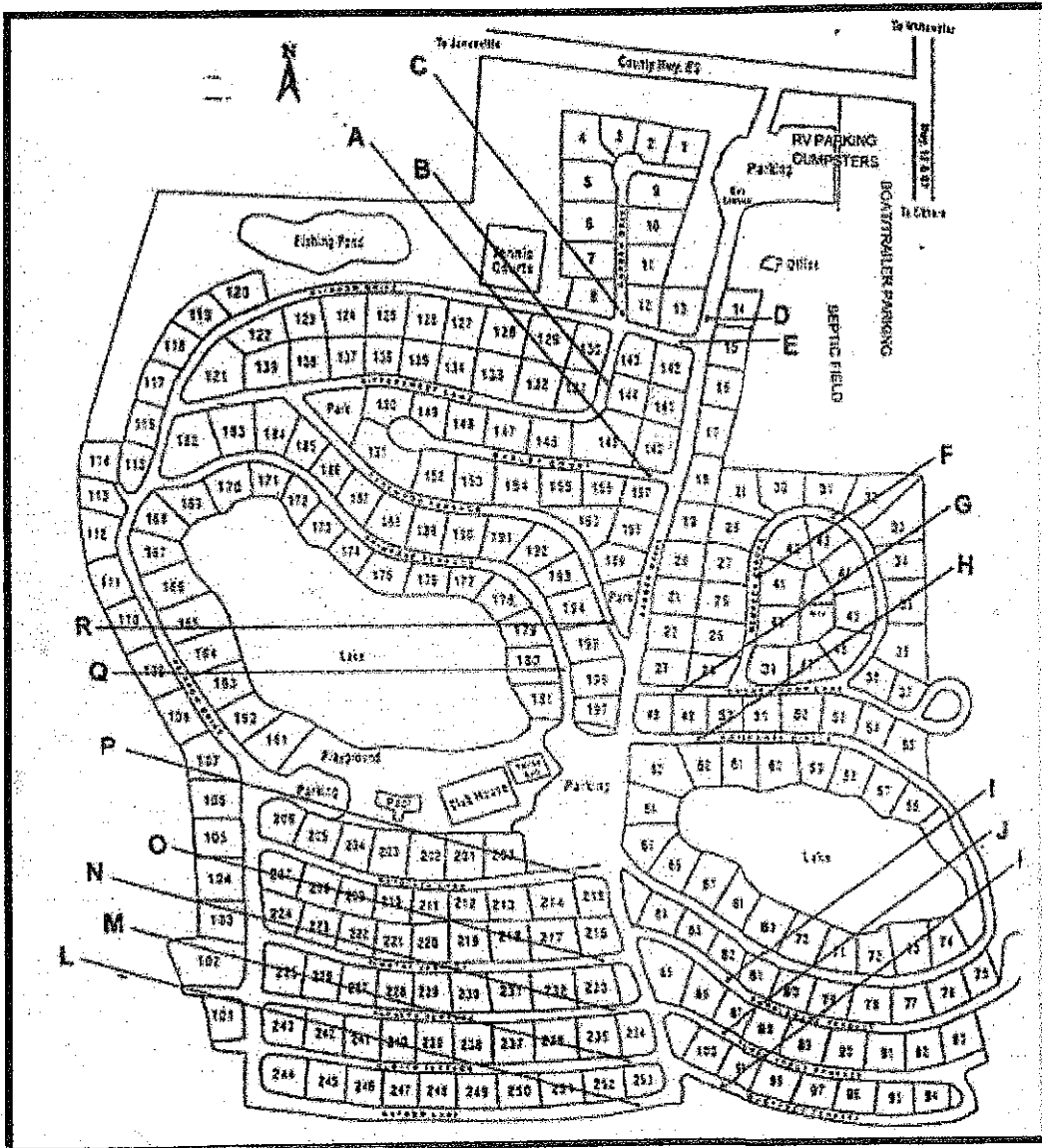



**Current Plan Information:**

- All plans run on an *annual* basis.
- Once installed your service will renew each year on your Edge Anniversary
- Service will remain active all year long.  
Customers no longer have to call us to turn on/off service.
- Managed Wifi is included in both plans.
- Installation is free
- Install time window is typically around 90 minutes.

<b>Willow Run 15</b>	<b>Willow Run 60</b>
15 Mbps Download	60 Mbps Download
5 Mbps Upload	10 Mbps Upload
<b>Seasonal Price: \$299.00</b>	<b>Seasonal Price: \$399.00</b>

**Extra services**

**VoIP Phone Service:** Includes all standard features; unlimited local & long distance in the US. (Except Hawaii and Alaska), call waiting, call forwarding, caller ID. Offered at a seasonal Rate.....**\$158.28**

**FAQ's**

**What is Managed Wifi:** Includes automatic updates, worry-free replacement if the router malfunctions, free remote tech support, and no upfront rental cost.

**What is VoIP?** VoIP services convert your voice into a digital signal that travels over the Internet. If you are calling a regular phone number, the signal is converted to a regular telephone signal before it reaches the destination. Edge can even install so that your current phone setup works with VoIP

## Wireless Router- Managed WiFi Service

A premium WiFi 6 wireless router with included remote and onsite WiFi support is referred to Edge Broadband as Managed Wifi

- Remote Troubleshooting
- Updates to the router
- Ease of mind that the professionals are at the other end keeping you up to date with your router.

## Landline Phone

Customers may also add on residential VoIP phone services for \$25/month + Tax. Our VoIP phone service features unlimited local and long-distance calling with standard calling features;

- Call forwarding
- Call Blocking
- Caller ID

Business Phone starts at \$30/m. Contact us for a free review to see how we can save your business money on your phone needs.

## Protection Plan

Covers any accidental damage to your home's wiring or equipment. The **cost of the service call** and **any repair and/or replacement needed for damaged wiring, jacks, and/or equipment** that were previously installed by an Edge Broadband technician.

## Military Discount

Receive a 10% discount when you provide a copy of your DD214