

# HARD LID



## FITTING INSTRUCTION - VARIATIONS

2025 current MG U9 Infill panel

1. Remove the 2 front screws from each side of the tub.

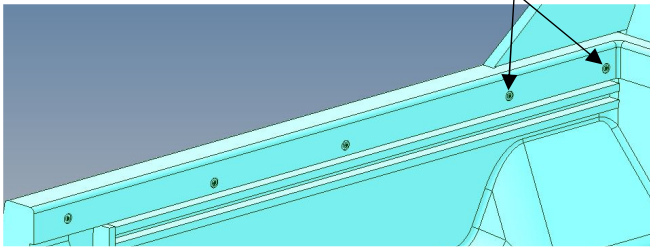

2. Carefully slide the infill into place. Fasten the sides with 2 @ M6 x 25 S/S button head socket screws, penny & spring washers (each side) into the factory holes.

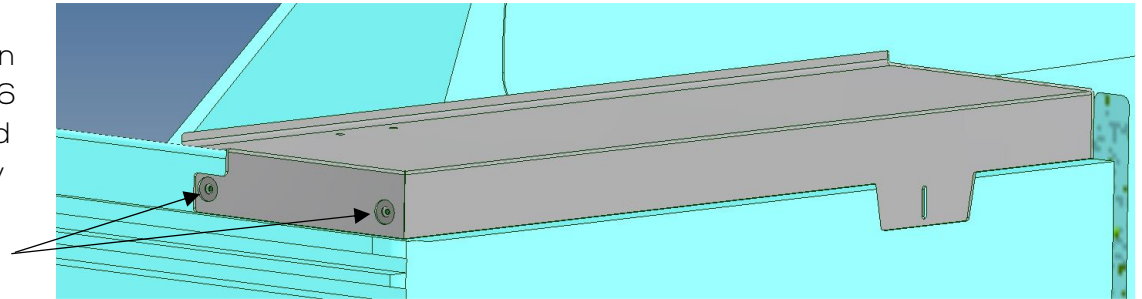

3. Fit the centre infill brace using 1 @ M6 x 25 S/S button head socket screw, spring & penny washer (top of brace has a M6 rivnut fitted).

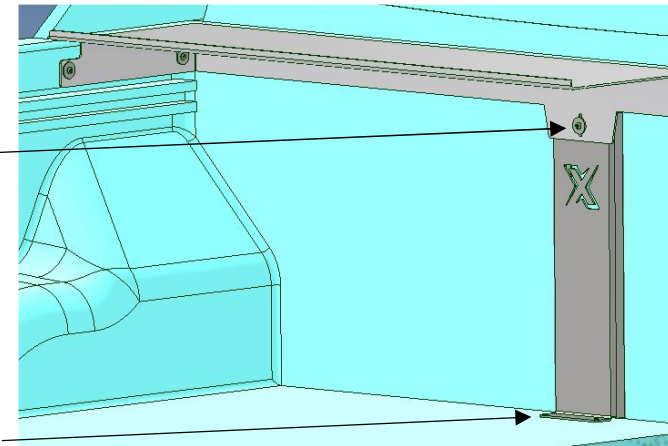

Once fastened, drill 2 @ Ø5 holes at the bottom of the support and pull up 2 @ 5mm S/S rivets.

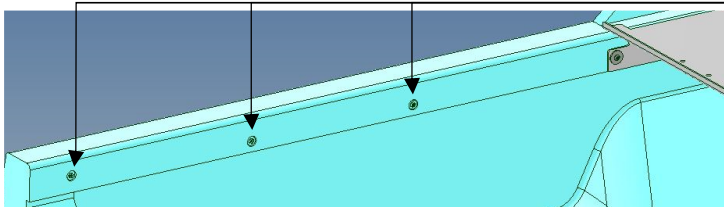

4. Seal the infill to the tub all the way around using Silicon. Smooth off and remove any excess (This MUST be done well to avoid any water ingress).

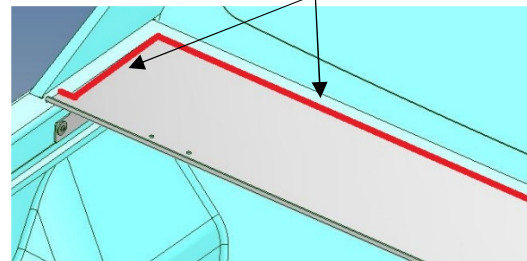

5. Remove the side tie rails (these will interfere with the S/S side rails).

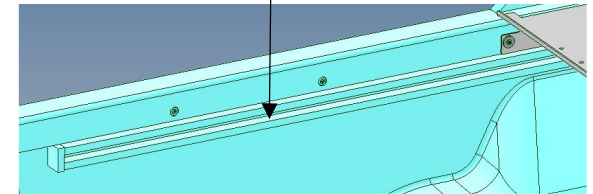

6. Remove the remaining 3 bolts from each side of the tub.

Fit the S/S side rails using 3 @ M6 x 25 S/S button head socket screws, penny & spring washers (each side) into the factory holes.

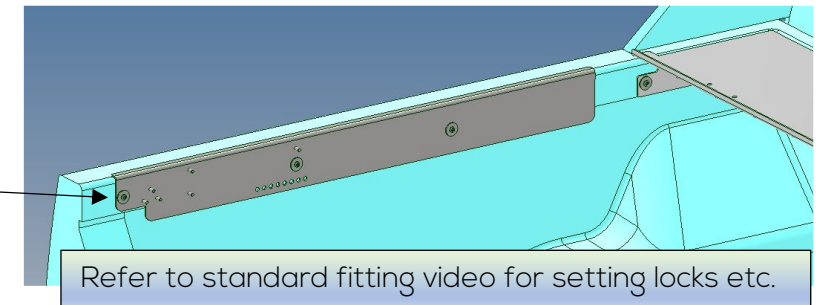

Refer to standard fitting video for setting locks etc.