

Soils Map

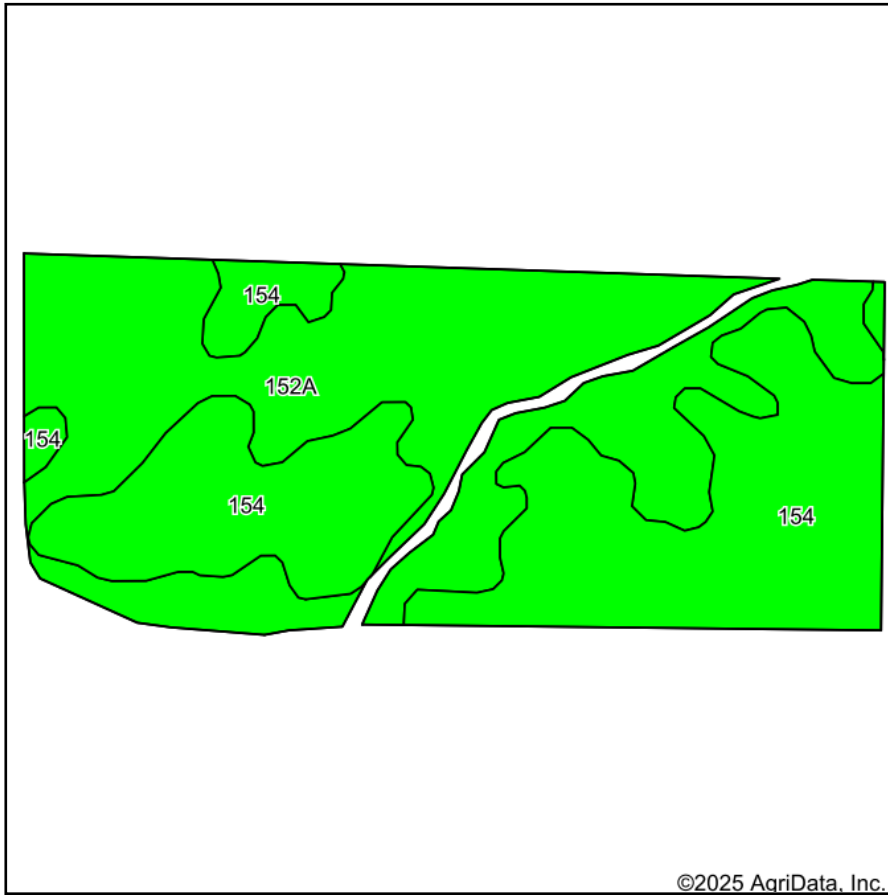

Soils data provided by USDA and NRCS.

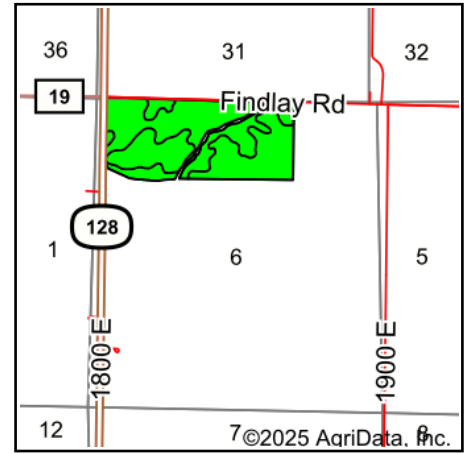

State: **Illinois**
 County: **Shelby**
 Location: **6-12N-4E**
 Township: **Okaw**
 Acres: **95.62**
 Date: **3/10/2025**



Maps Provided By:



Area Symbol: IL173, Soil Area Version: 21

Code	Soil Description	Acres	Percent of field	Il. State Productivity Index Legend	Soil Drainage	Corn Bu/A	Soybeans Bu/A	Crop productivity index for optimum management	*n NCCPI Soybeans
**152A	Drummer silty clay loam, 0 to 2 percent slopes	49.94	52.2%		Poorly drained	**195	**63	**144	74
154	Flanagan silt loam	45.68	47.8%		Somewhat poorly drained	194	63	144	70
Weighted Average						194.5	63	144	*n 72.1

Table: Optimum Crop Productivity Ratings for Illinois Soil EFOTG are sourced from Bulletin 811 calculated Map Unit Base Yield Indices, and adjusted (Adj) for slope, erosion, flooding, and surface texture. Publication Date: 02-08-2023

Crop yields and productivity (B811 EFOTG) are maintained at the following USDA web site: 2023 Illinois Soil Productivity and Yield Indices: <https://efotg.sc.egov.usda.gov/#/state/IL/documents/section=2&folder=52809>

** Base indexes from Bulletin 811 adjusted for slope, erosion, flooding, and surface texture according to the Il. Soils EFOTG

*n: The aggregation method is "Weighted Average using all components"