

Modular Housing, Age
in place, energy
efficient, own my

There is no place like
home



Introductions



CEO
CRRHFH

Jason
Tickler



Dir. Build
Operations
CRRHFH

Mac Williams



General
Manager Cavco
Martinsville

Donald Aheron

Pre-Development & How its paid for

- USDA Loans
- USDA 502 Direct and Guaranteed Loans
- Homes meet DCHD and Virginia Housing Development or DPA Grants (to date)
- Participant(Local Hero)
- Local Government Involvement(Primer & Investment Partner)



Changing the Conversation

- Value added Design
- Building Science
- Value Added Engineering
- Long Term Value(LTV)



Value Added Design

- Split Bedroom design to eliminate hallways and maximize living space
- Age in Place
- Zero Step Entry
- Saves Tax Dollars (ROI)



Value Added Energy Design

- Goal is to Control the home environment 100%
- Sealed Envelope (Zip Panel, Conditioned Crawl)
- Fresh Air Entry is controlled mechanically based on your local climate



Controlling Maintenance Costs

- Minimizing maintenance cost over life of loan
- Concrete porches
- 35 Year Shingle
- Upgraded Siding
- Avoid Handrails



Community Involvement & Local Partnerships

- CCPS Built Prototype
- Sweat Equity reduces program costs
- Partnership with Schools, and County
 - Attend School events(recruiting Heros and Volunteers)

presentations to county staff





MARTINSVILLE

- For Profit Partnership
- Solutions must be market driven
- Modular Housing reduces cost to Build



Donald



Why Modular

Quality Control & Inspections

Cavco - Martinsville uses cutting-edge systems to build our modular homes, which are designed and constructed in a climate-controlled environment that protects them throughout the building process. This means inclement weather never touches the materials we use in the construction process, and the timing of the build is not hindered by weather.

Cavco - Martinsville's modular homes must pass 300 quality inspections, including 3rd party inspections, to ensure the highest level of quality is built into every Cavco - Martinsville home.

Built Stronger to Provide More Peace of Mind

Because Cavco - Martinsville modular homes are carefully transported to the home site, they are engineered and built to higher strength standards than site-built homes. Construction materials are securely set in place to add strength and make our modular homes more durable throughout the move and to withstand the adverse effects of Mother Nature.

Energy Efficient and Resource Conscious

Unlike Cavco - Martinsville modular homes, site-built homes produce an inordinate amount waste. For instance, a 2000 square foot site-built home produces approximately 8,000 pounds of landfill waste. By building custom modular homes in a climate-controlled facility, Cavco - Martinsville home construction reduces waste by recycling, reusing and repurposing materials.

Cavco - Martinsville homes are very energy efficient. Drywall panels are nailed in place and secured with durable, long-lasting glue, and our building process reduces gaps and drafts in the building itself. Customers enjoy more efficient heating and cooling, and modular homes often use smaller furnaces or air-conditioning units than site-built homes with the same square footage.



Why Modular

Design Flexibility



Homebuilders and homeowners have the same ability to create a custom home with modular construction. Customers can select from more than 100 modular home floor plans prior to designing. You can select from thousands of personalized, upscale features to suit your tastes and accommodate your budget.

Cavco - Martinsville offers an array of styles, including Cape Cod models, ranch-style homes, split-level homes and two-story modular homes. Many personalized features allow you to customize your modular home to fit your personal tastes. It's what Cavco - Martinsville calls Custom Made Easy. Whether you are looking for a home from 1,000 square feet to 4,000 square feet, we can meet the needs of builders and homeowners.

Cost Savings



Because Cavco - Martinsville modular homes are built efficiently in a climate-controlled facility, cost savings are a natural byproduct. With so many modular floor plans and custom options to choose from, Cavco - Martinsville makes it easy to find the perfect modular home to fit your style and accommodate your budget.









Why Modular?

- **Shorter Build Times**
- **Built in a controlled environment**
- **Buying power- Savings on materials**
- **Built on a production line- Labor savings**
- **High Volume- Less downtime**
- **Fewer delays- fewer subcontractors**
- **Consistent Quality**
- **Firm pricing**
- **Allows for portions of work to be completed on site- Great for self help projects**
- **Engineered systems- stronger more durable construction**
- **Can ship to multiple states**

5/4x8 PVC FREEZE BOARD SHIPPED
FOR SITE INSTALLATION BY THE
PURCHASER

FURRING STRIP BY PURCHASER
1/2"x8" STYROFOAM

EXTERIOR ZIP SHEATHING
FACTORY INSTALLED EVEN
WITH BOTTOM OF FACTORY
INSTALLED SILL PLATE

FLASHING BY PURCHASER/WATER
PROOFING AT THIS AREA IS THE
SOLE RESPONSIBILITY OF THE
PURCHASER

MASAP 48" o.c.
SUPPLIED AND SITE
INSTALLED



WITH TOP OF SUBFLOOR/ BOTTOM RUN
OF SIDING SHIPPED FOR SITE INSTALLATION
BY THE PURCHASER

METAL DRIP CAP FLASHING SUPPLIED
AND SITE INSTALLED BY PURCHASER

2x10 P.T. CUT DOWN
TO 8 1/4" TALL

1 7/8"x8.25" LVL CUT
DOWN TO 8 1/4" TALL

2x4 P.T. FACTORY INSTALLED

2x6 P.T. SILL PLATE
BY PURCHASER

How did we achieve
the Zero Step Entry?

We'll, quite simply,
we were willing to do
what it took!



Integrated Ledge at
foundation

Engineered floor truss
w/ offset

Setting procedures

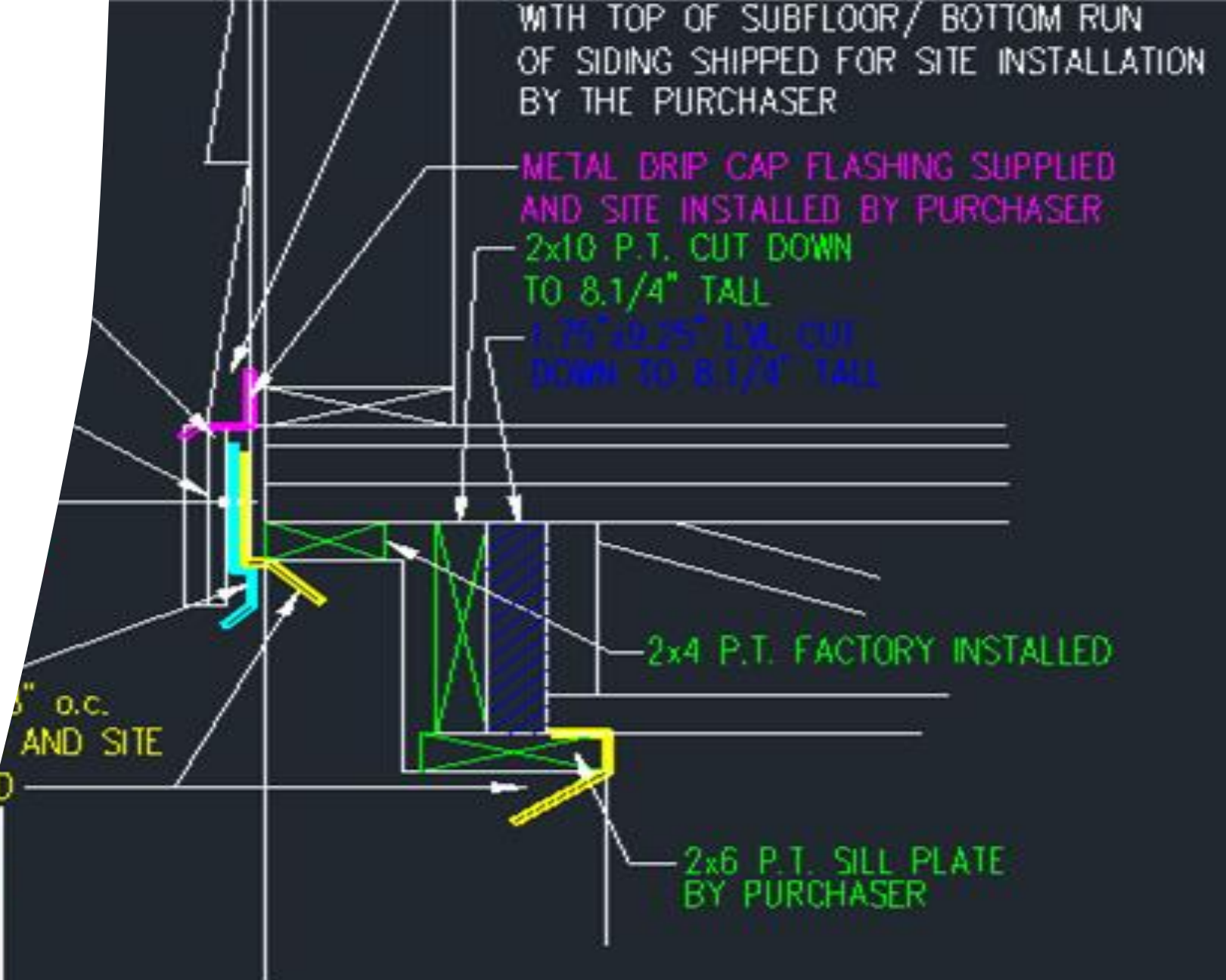

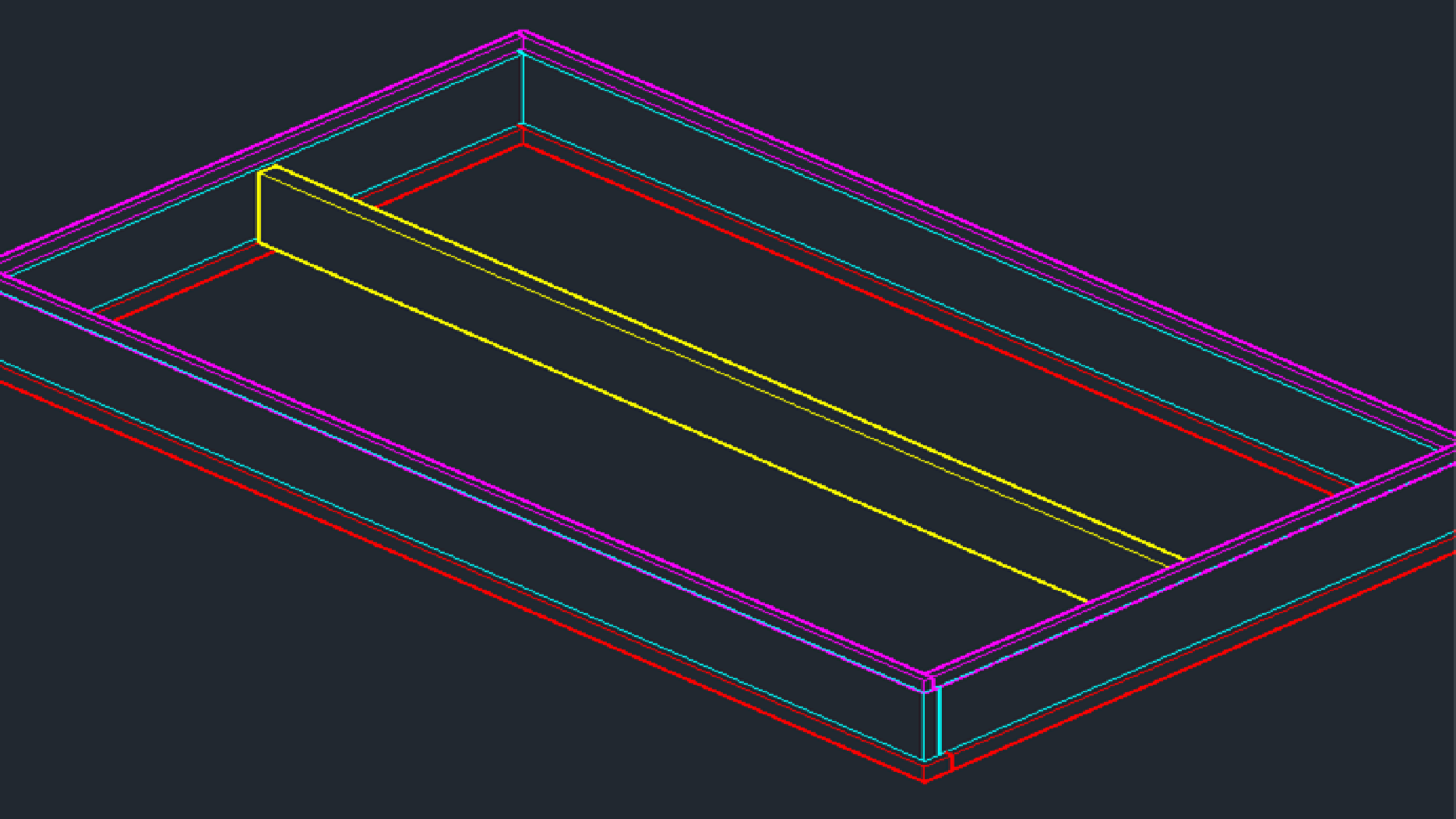

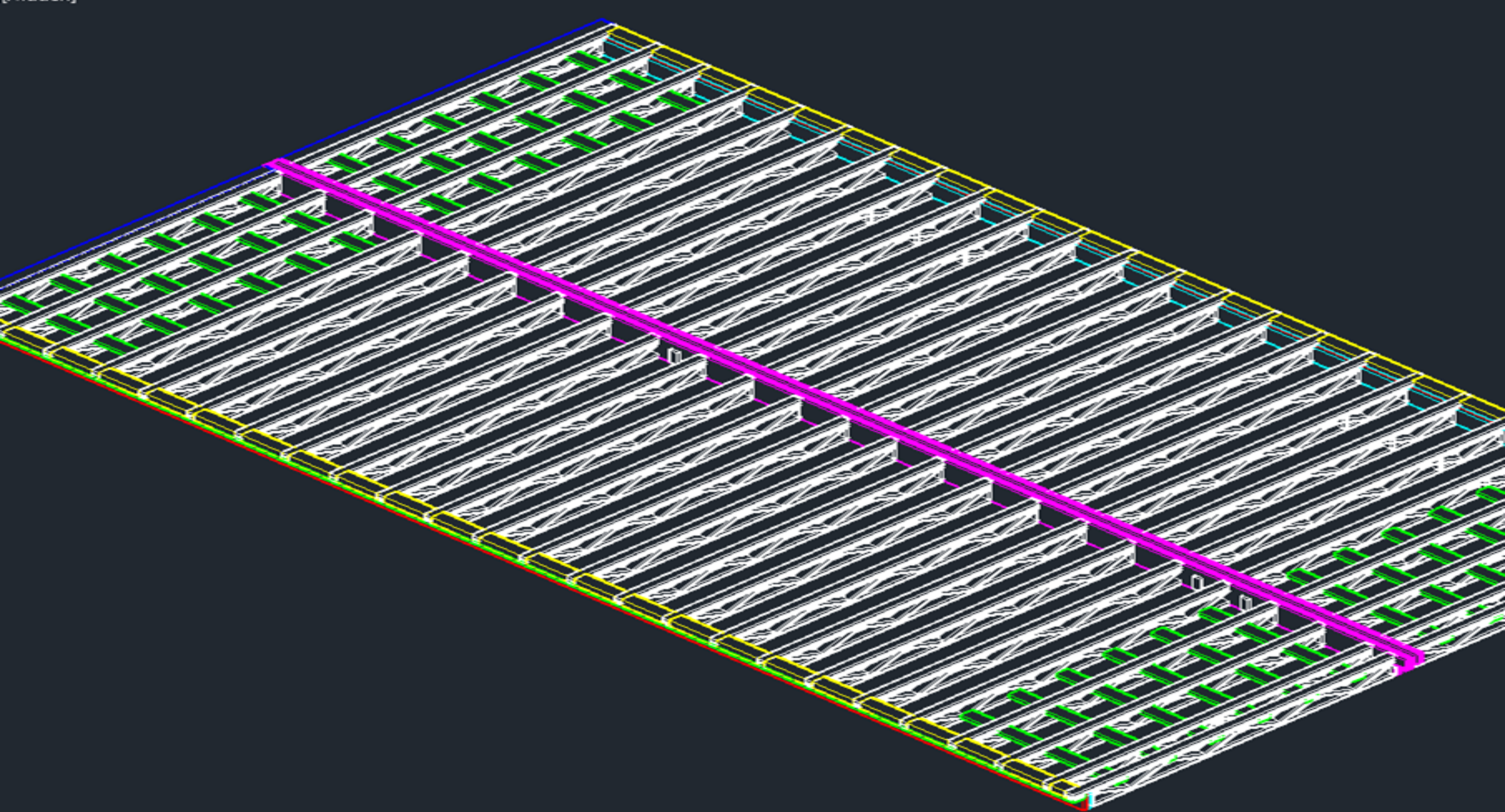

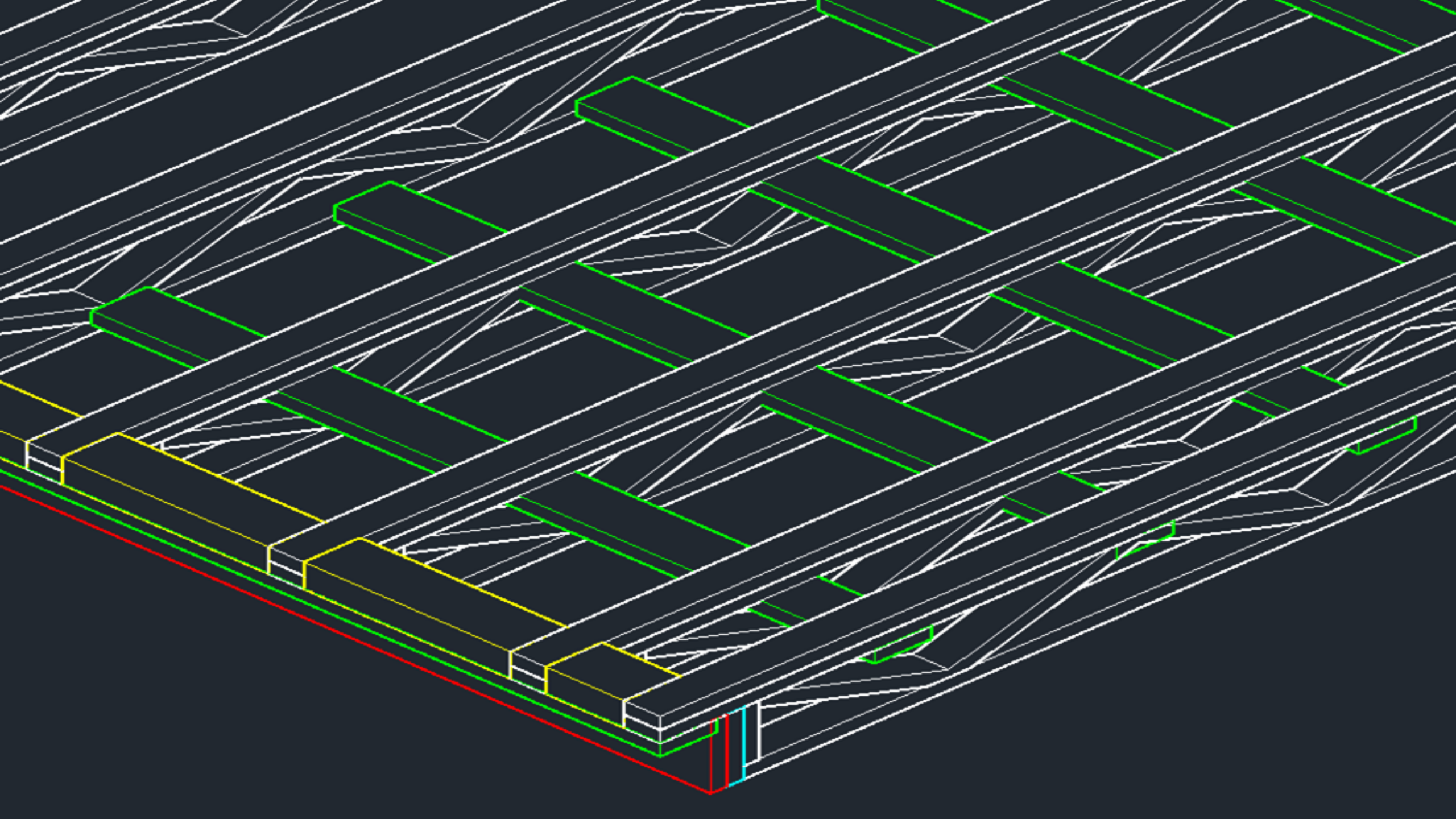

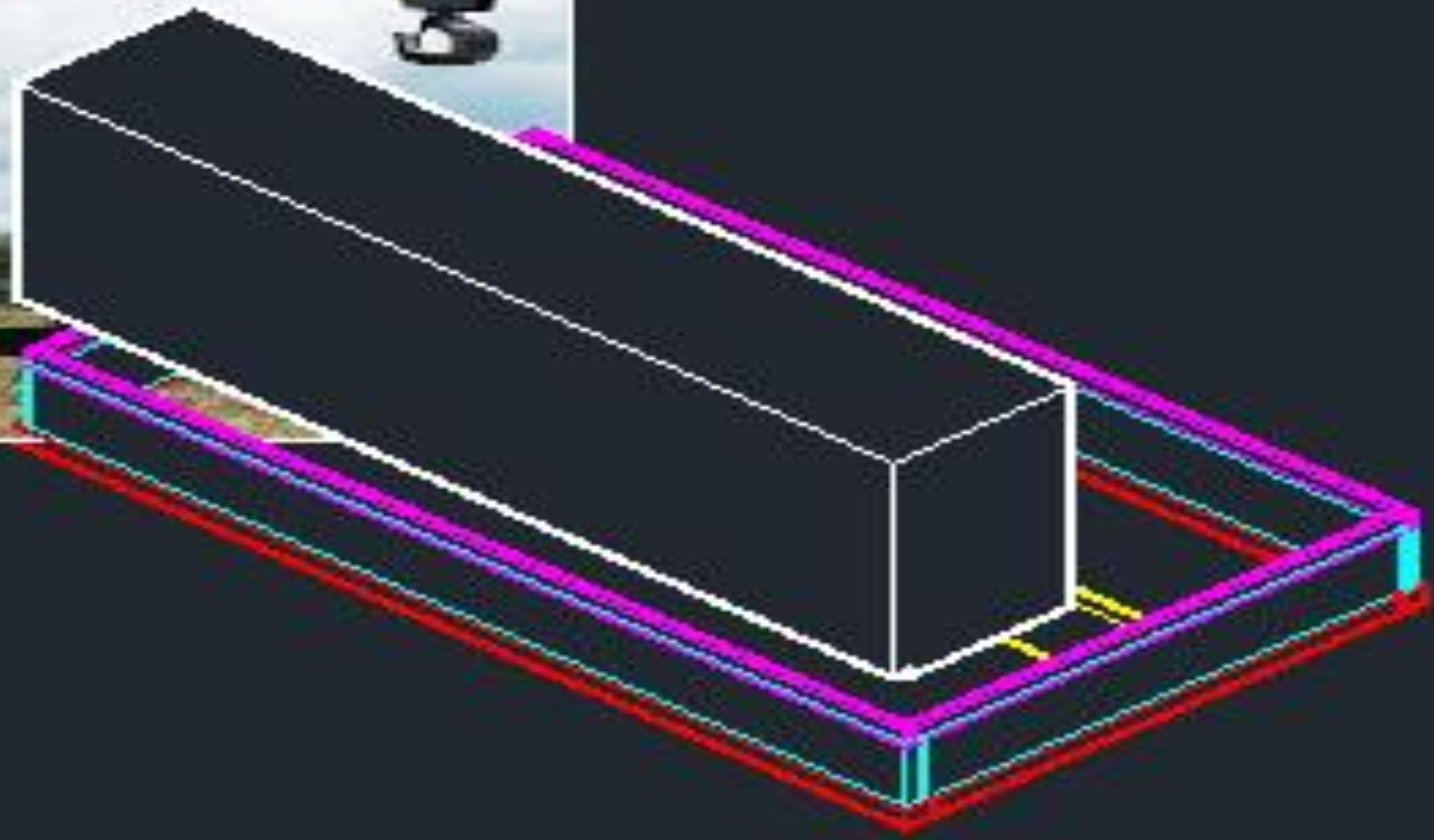



100 RICH ROAD, MARTINSVILLE, VA 24122
(703) 533-7700
WWW.CAVCO.COM/VA/MSV

400 RICH ROAD
MARTINSVILLE, VA 24122
(703) 533-7700
WWW.CAVCO.COM/VA/MSV

400 RICH ROAD
MARTINSVILLE, VA 24122
(703) 533-7700
WWW.CAVCO.COM/VA/MSV

400 RICH ROAD
MARTINSVILLE, VA 24122
(703) 533-7700
WWW.CAVCO.COM/VA/MSV

400 RICH ROAD
MARTINSVILLE, VA 24122
(703) 533-7700
WWW.CAVCO.COM/VA/MSV

400 RICH ROAD
MARTINSVILLE, VA 24122
(703) 533-7700
WWW.CAVCO.COM/VA/MSV

400 RICH ROAD
MARTINSVILLE, VA 24122
(703) 533-7700
WWW.CAVCO.COM/VA/MSV

400 RICH ROAD
MARTINSVILLE, VA 24122
(703) 533-7700
WWW.CAVCO.COM/VA/MSV

400 RICH ROAD
MARTINSVILLE, VA 24122
(703) 533-7700
WWW.CAVCO.COM/VA/MSV

400 RICH ROAD
MARTINSVILLE, VA 24122
(703) 533-7700
WWW.CAVCO.COM/VA/MSV

400 RICH ROAD
MARTINSVILLE, VA 24122
(703) 533-7700
WWW.CAVCO.COM/VA/MSV

400 RICH ROAD
MARTINSVILLE, VA 24122
(703) 533-7700
WWW.CAVCO.COM/VA/MSV

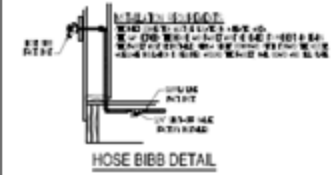
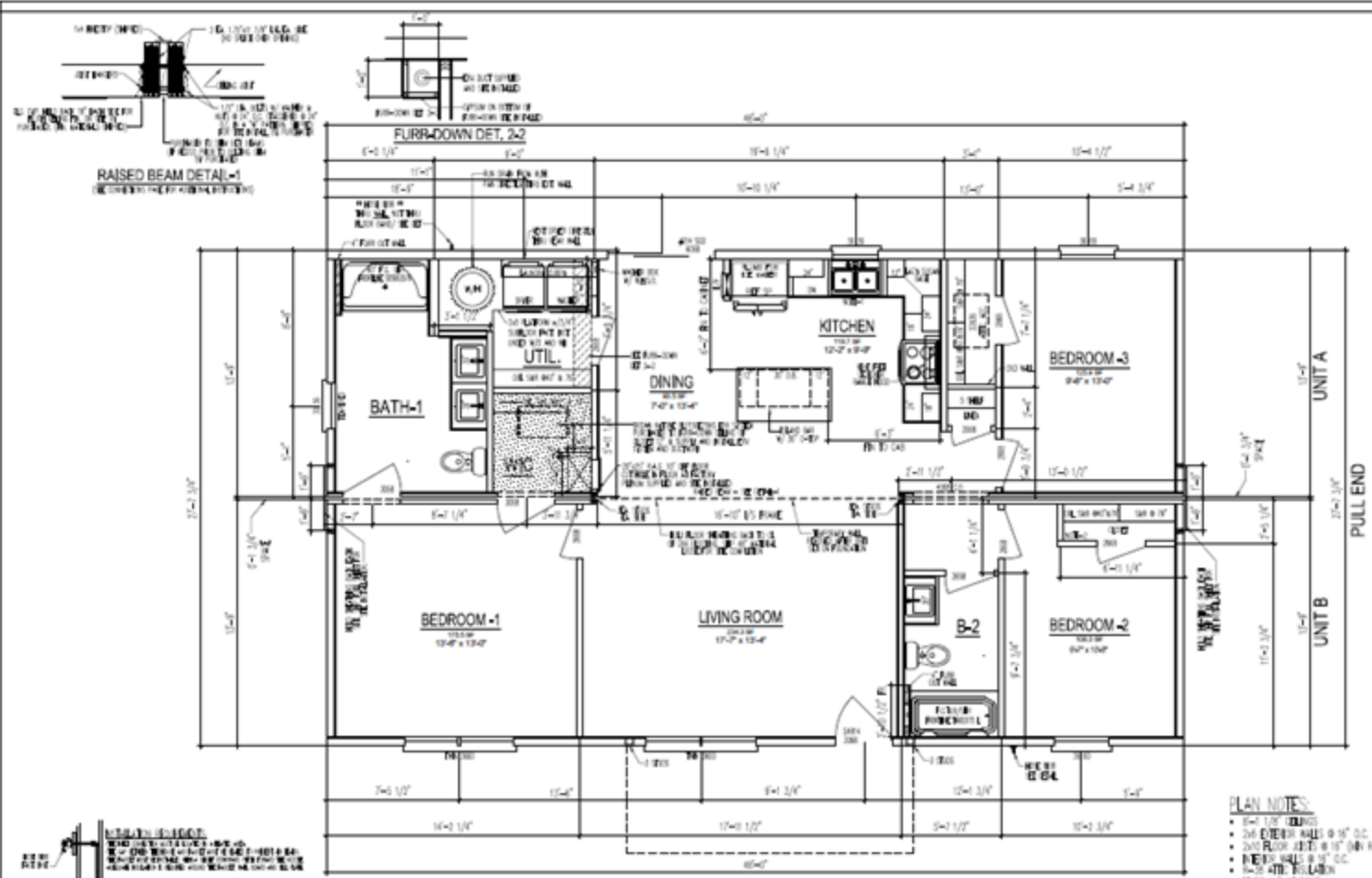

CERTIFICATION INFORMATION	
1. I, THE UNDERSIGNED, CERTIFY THAT I AM THE DESIGNER OF THE ABOVE DESCRIBED PROJECT AND THAT I AM A LICENSED PROFESSIONAL ENGINEER IN THE STATE OF VIRGINIA.	2. I, THE UNDERSIGNED, CERTIFY THAT I AM THE DESIGNER OF THE ABOVE DESCRIBED PROJECT AND THAT I AM A LICENSED PROFESSIONAL ENGINEER IN THE STATE OF VIRGINIA.

NOTES TO THE CONTRACTOR	
1. ALL DIMENSIONS ARE TO FACE UNLESS OTHERWISE NOTED.	2. ALL DIMENSIONS ARE TO FACE UNLESS OTHERWISE NOTED.

1. ALL DIMENSIONS ARE TO FACE UNLESS OTHERWISE NOTED.

SQUARE FOOTAGE
TOTAL: 1,000.00

FIRST LEVEL FLOOR PLAN
SCALE: 3/8" = 1'-0"

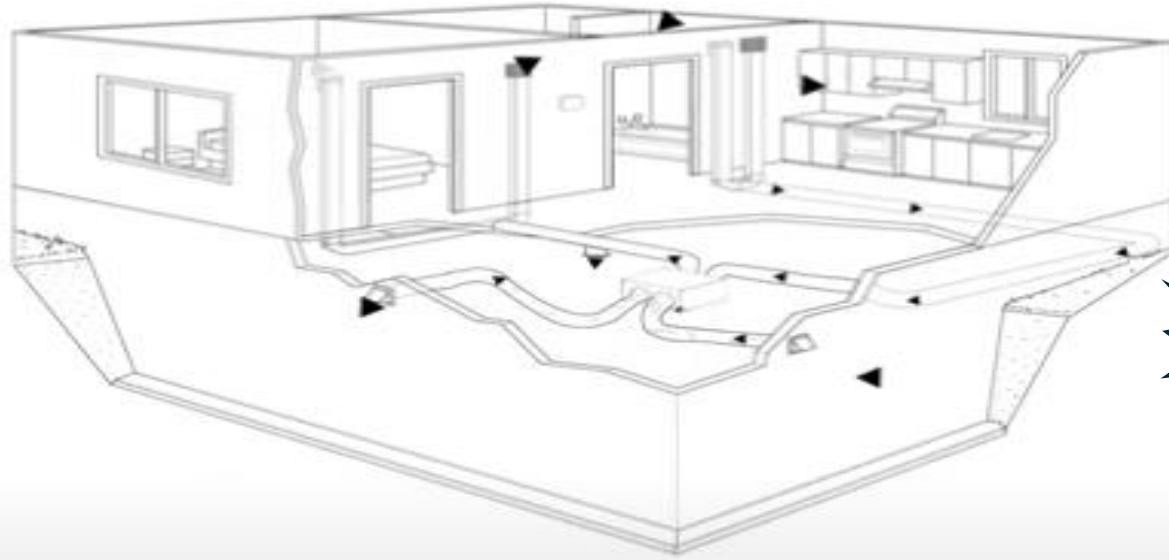

★ ERV systems
★ "Air"

★ Conditioned Crawlspaces

Sealed, insulated and climate
controlled

Improved air quality

Improved energy efficiency

Enhanced structural integrity

Greater comfort



Engineered system:

Floors

Walls

Roof

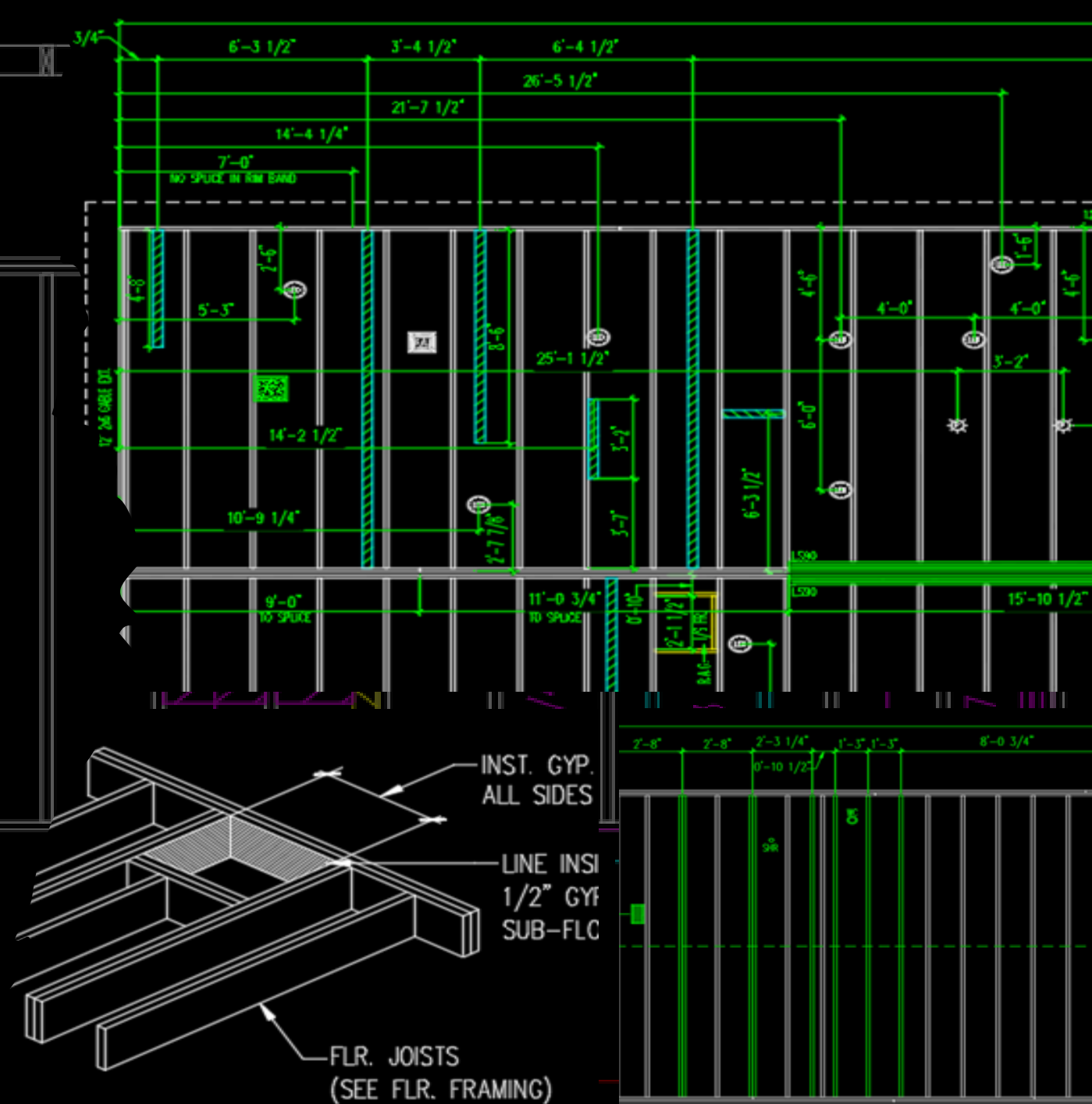
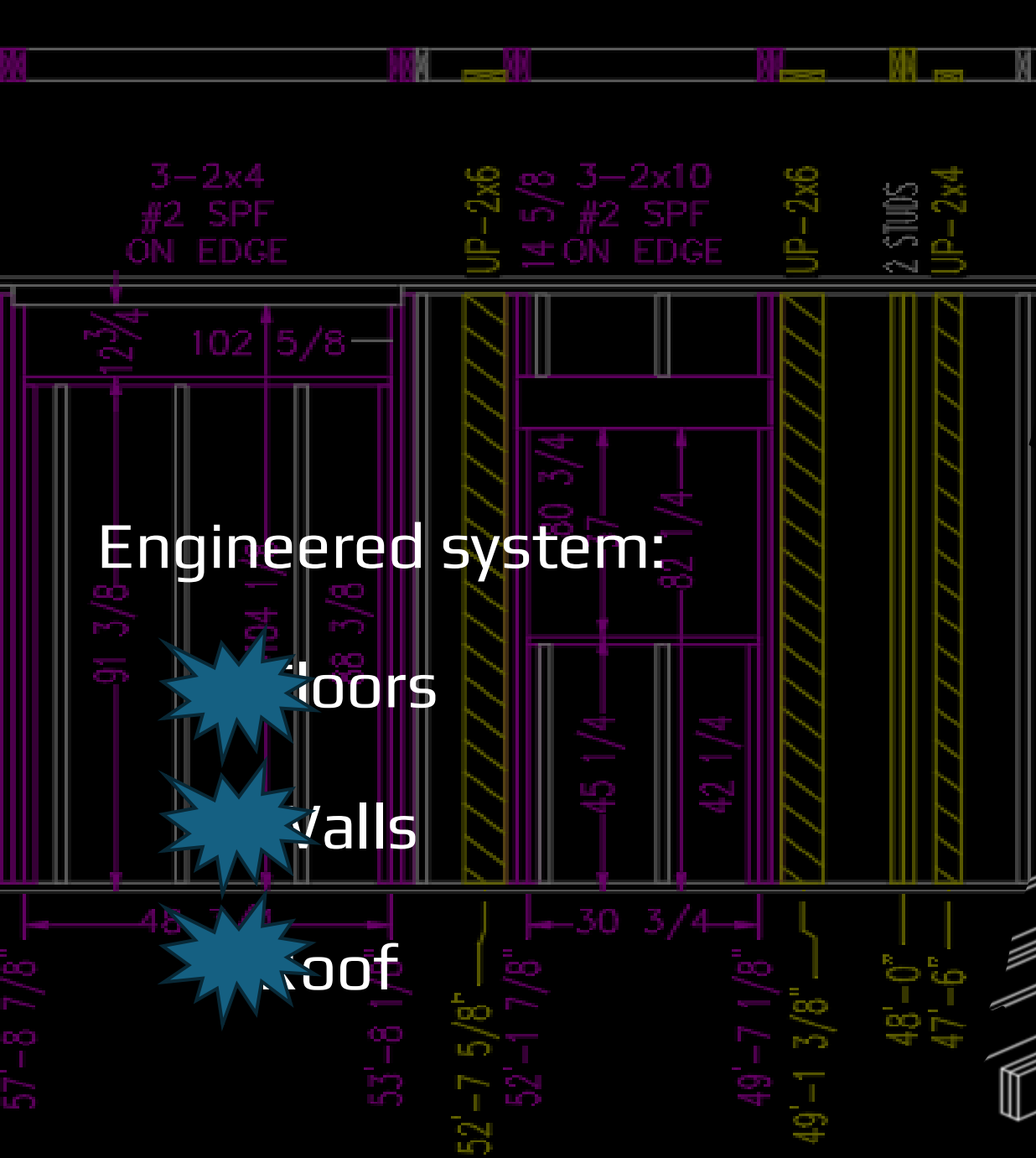

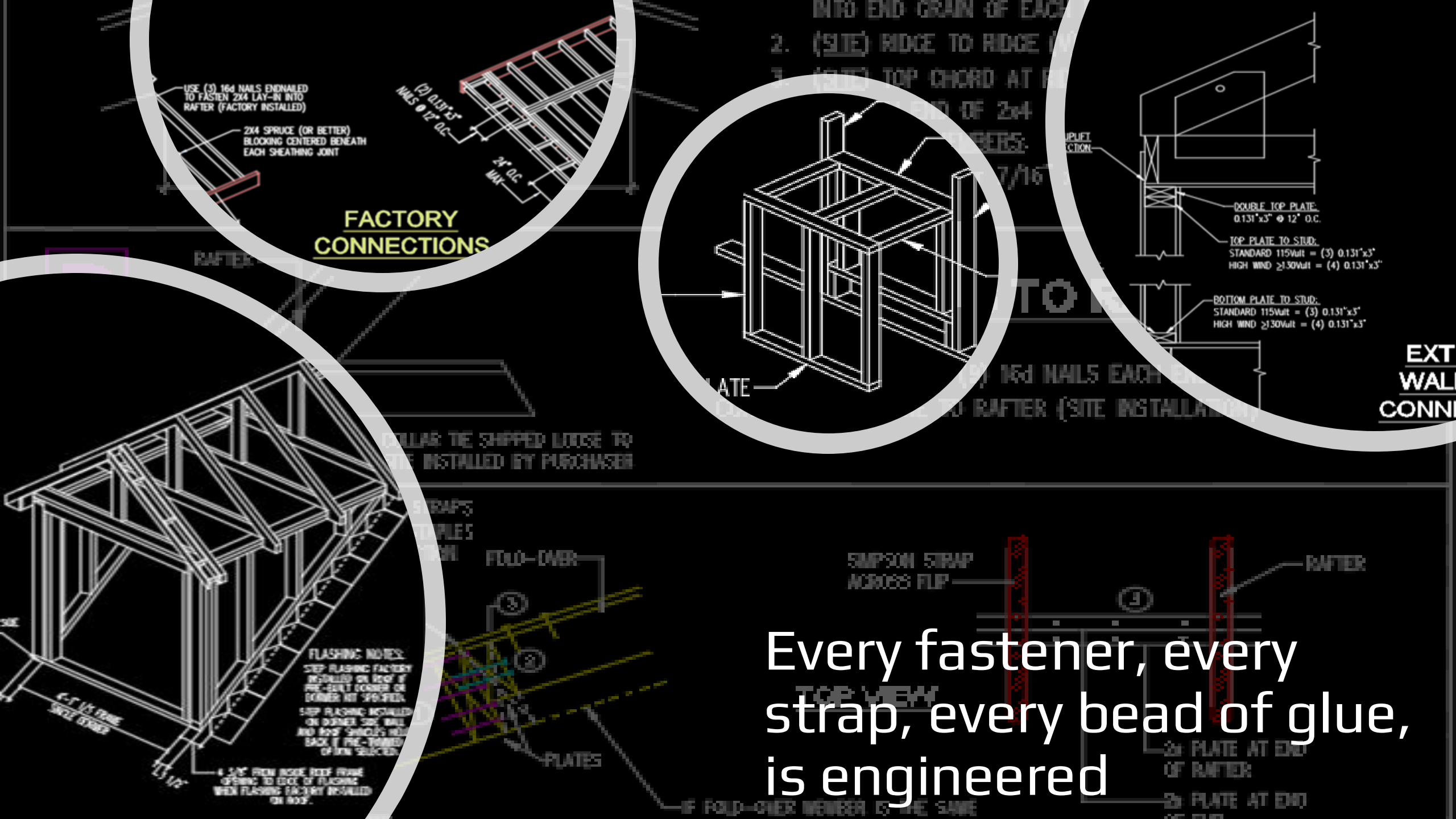

USE (3) 16d NAILS ENDNAILED TO FASTEN 2x4 LAY-IN INTO RAFTER (FACTORY INSTALLED)

2x4 SPRUCE (OR BETTER) BLOCKING CENTERED BENEATH EACH SHEATHING JOINT

(2) 0.131"x3" NAILS @ 12" O.C.

24" O.C. MAX.

FACTORY CONNECTIONS

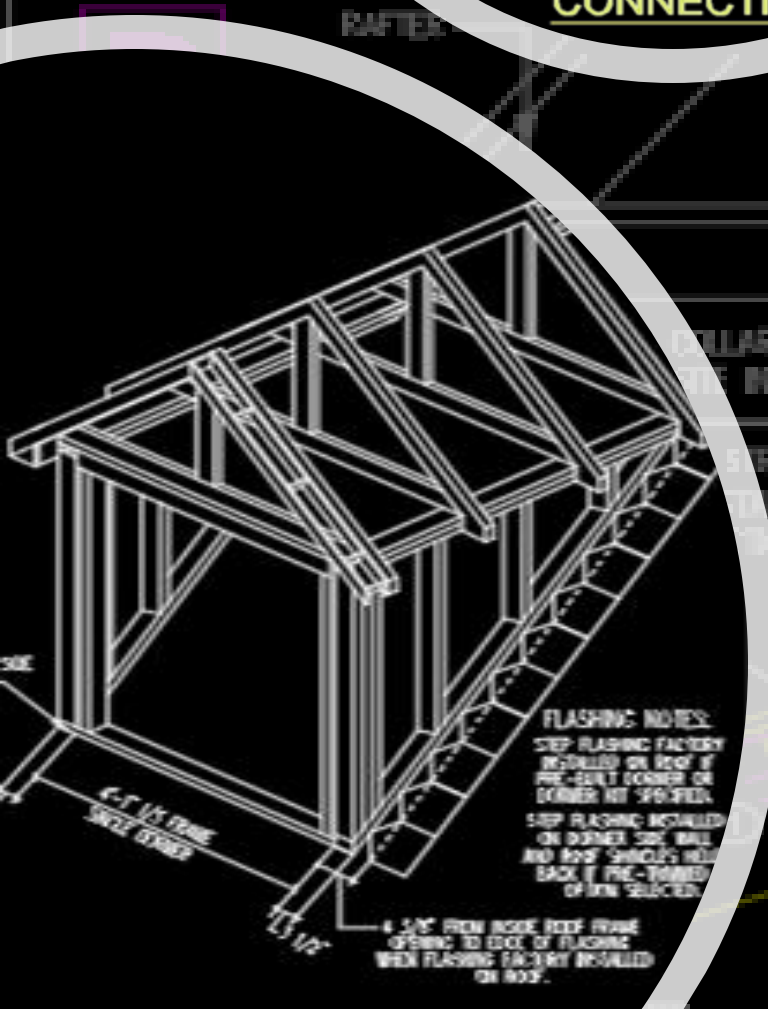
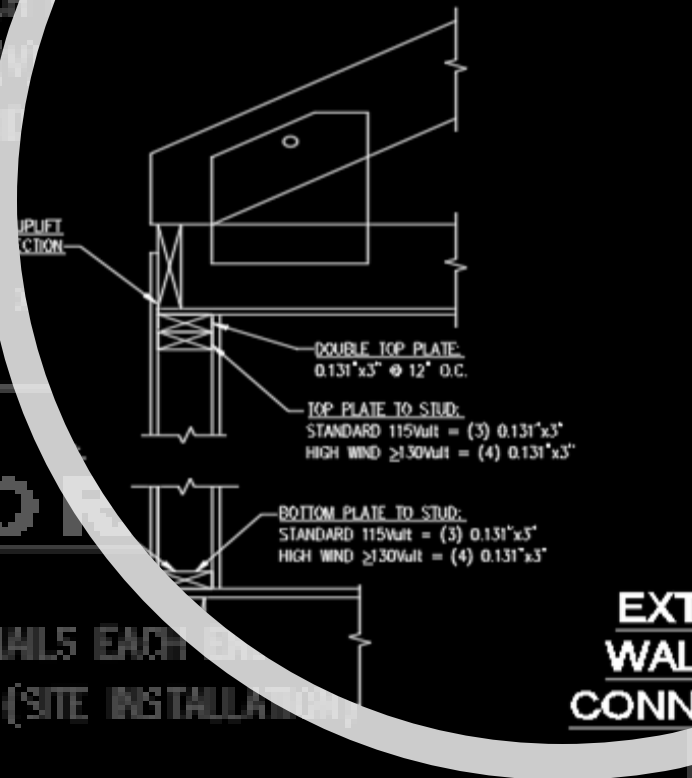
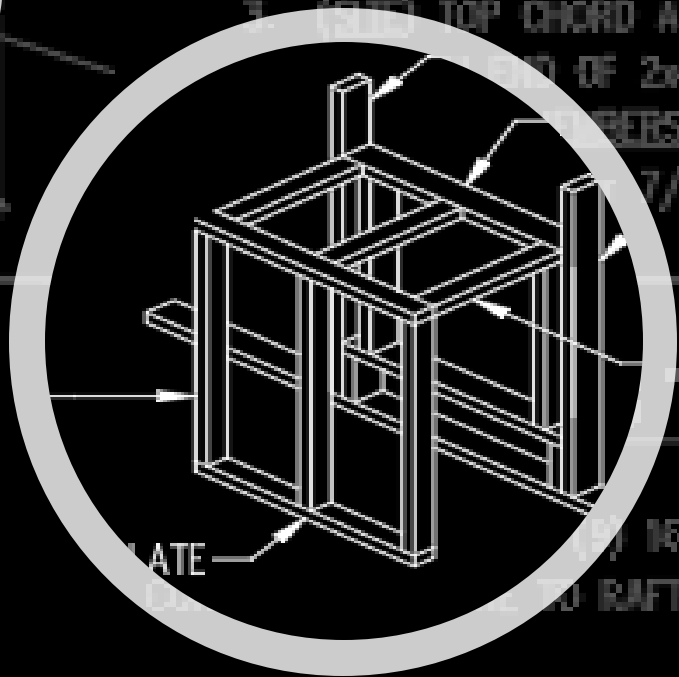

FLASHING NOTES:
STEP FLASHING FACTORY INSTALLED ON ROOF IF PRE-BUILT CORNER OR DORMER KIT SPECIFIED.
STEP FLASHING INSTALLED ON DORMER SIDE WALL AND ROOF SHEDS'S REAR BACK IF PRE-THINNED DORMER SELECTED.

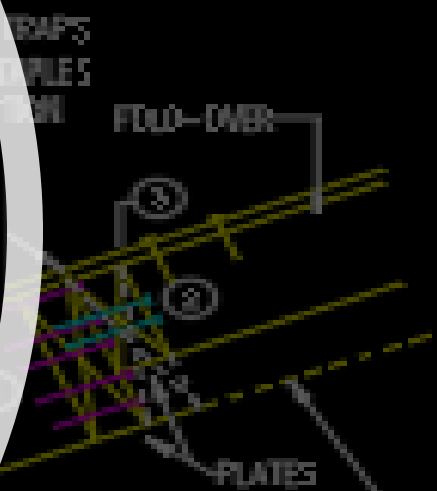

SMIPSON STRAP ACROSS FLIP

Every fastener, every strap, every bead of glue, is engineered

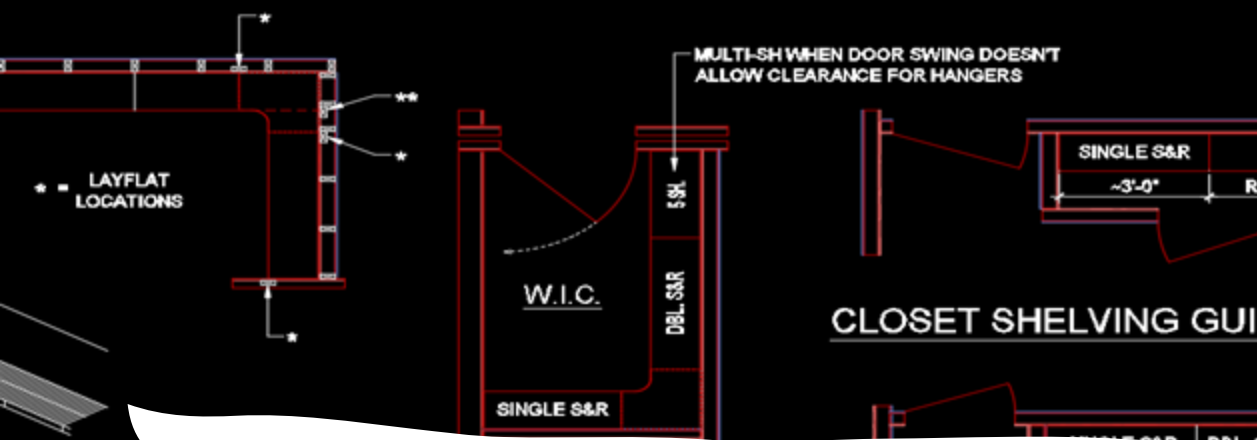

- Every piece of siding, every cabinet, even the shelving in the closets are carefully engineered

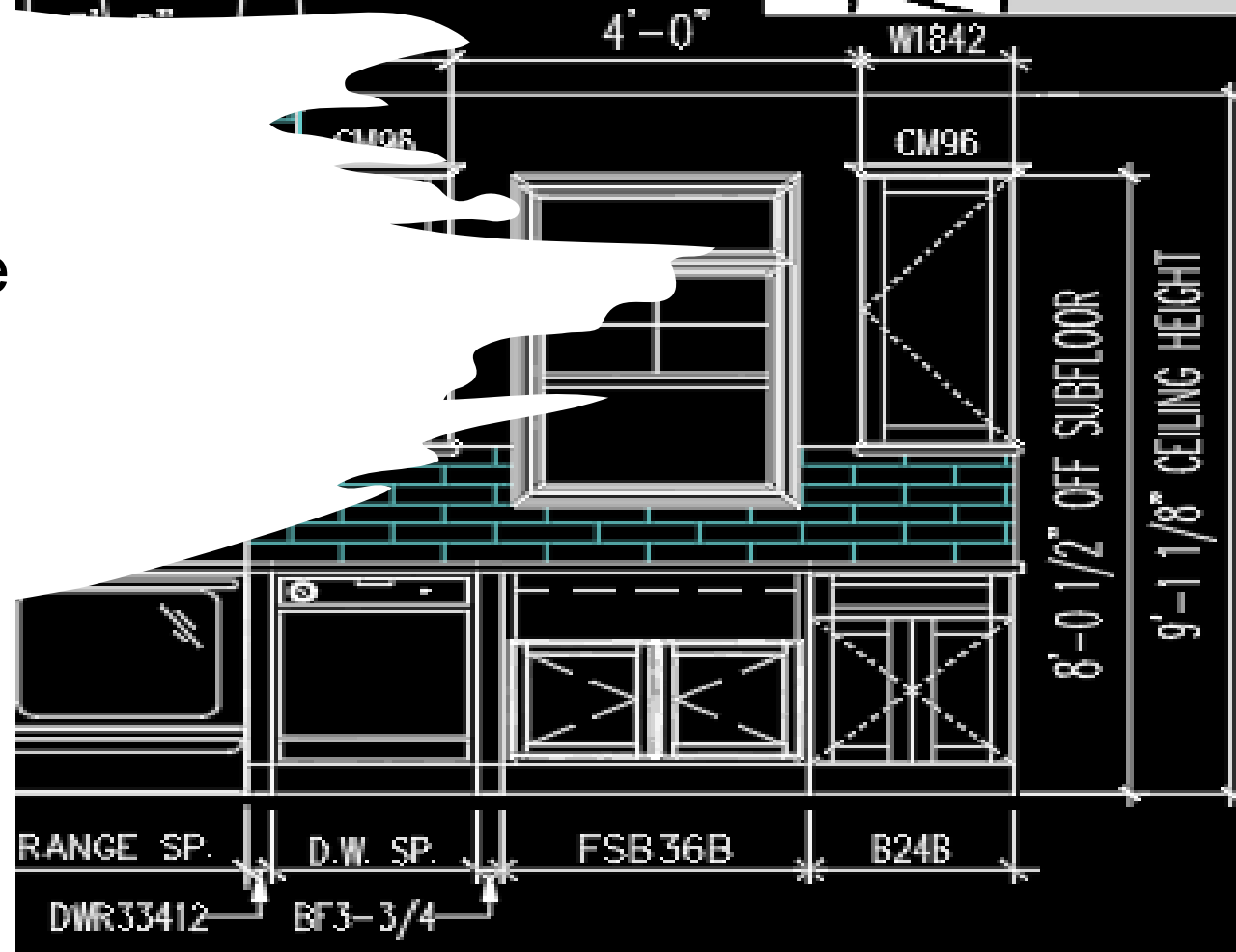



Follow Live on Youtube

Contact Info

Jason@CRRHFH.org

Mac@habitatofcaroline.org

Daheron@nationwidecustomhomes.com

