

For over a century, the Marion Chamber of Commerce has committed to helping businesses thrive and be a solid part of our community. Over the years, our projects and programs have changed to meet the needs of our growing community. One thing has stayed the same - taking an active role in making our community a better place to live, work and play.

The idea of a Chamber of Commerce might be a holdover from analogue days, but much like Consumer Reports, it is still one that people trust. Plain and simple, the biggest edge Chamber of Commerce Membership gives your business is instilling consumer confidence. Businesses that display a Chamber logo are recognized by consumers as people who practice good business, care for their customers and are trustworthy.

In a close-knit community like Marion, business network development and personal connections play a huge role in a successful business or organization. Our organizational orientations & luncheons, ribbon cuttings, and events allow you to connect with business and community leaders. Market your business through interactive or promotional sponsorships which allow you to connect with potential customers and spotlight your business.

Feel you are too busy or successful enough to 'need' the chamber? That's great! Join us as a partner to help advocate for businesses and promote economic, commercial and civic duty within southern Illinois. We...

- ... make sure our elected officials are hearing about the needs of the community.
- ... share timely information that impacts our business community.
- ... work with educational institutions to ensure a strong talent pipeline for the future.
- ... develop the leaders of tomorrow.
- ... provide 24/7/365 marketing resources to spotlight all our community has to offer.

This is the work that we do while you are busy running your business. Fellow business and community leaders have shown their support to create the environment in which you are prospering. Won't you help 'pay that forward' to others?

I would like the opportunity to discuss with you the benefits of joining the Marion Chamber of Commerce. Please let us know a time that is convenient for you!

Sincerely,



Karen Mullins
Executive Director, Marion Chamber of Commerce
(618) 997-6311



Why join



MARION

CHAMBER of COMMERCE

Join the Marion Chamber of Commerce and discover great opportunities to connect with future customers and partners. By joining the Marion Chamber, you get members-only perks, exclusive advertising, networking opportunities, and a whole lot of exposure.



2305 West Main • PO Box 307
Marion, IL 62959
(618) 997-6311 • Fax (618) 997-4665

www.marionillinois.com
director@marionillinois.com



MEMBER BENEFITS

WHY MEMBERSHIP? The answer is the Marion Chamber of Commerce is the region's largest and most active Chamber with more than 450 voting members representing more than 430 area businesses, organizations, and industries. The Chamber is focused on providing **Visibility**, **Growth**, and **Credibility** to your business.

Benefits with an additional cost are noted with a "\$"

VISIBILITY

Banner Ad on MarionIllinois.com (\$) Spotlight your business on our member directory, calendar and more.

Business After Hours (\$) Host/attend networking events for our members, their guests and colleagues.

Digital Sign Advertising (\$) Rent our outdoor digital sign.

MarionIllinois.com Our website focuses on our members, programs, events and mission. The member directory hosts 1,550 searches monthly and features your image/logo.

Marion City Maps (\$) This up-to-date community map offers advertising panels available to Chamber members only.

Marion Community Profile Book - Free/(\$) It includes a member directory and spotlights community information. Printed every few years with 3,500 books printed per issue.

Marion New Resident Bags In partnership with the City of Marion and the Park District, spotlight your business with promo items or information to new residents in our area.

Membership Mailing List - Free Our mailing list is available electronically. We do not provide our e-mail list.

Member eBlast and E-News - Free/(\$) Take advantage of weekly promotional eBlasts and newsletters.

Chamber Mobile App Our app includes a members-only area for sharing content with the chamber membership.

Press Room/Blog Post your press releases/news for chamber communications that will be shared with local media.

Racks For Member Information Rack space in our lobby displays business cards and brochures.

Social Media Tag and co-host your events and projects!

GROWTH

Business Advocacy and Consultations We work with local leaders to make this the best possible place to live/work.

Commerce Control Panel / Member Portal Our online member portal includes a variety of services / tools.

Conference Room Usage Use of the Chamber meeting room is free during normal business hours for Chamber member organizations/businesses.

Insurance Through our IACCE membership, MetLife and Aetna customers qualify for an insurance discount. Contact your insurance provider or the Chamber for more details.

Referrals The Chamber staff responds to the hundreds of inquiries received by our office each year by giving lists of appropriate members.

Save on Electric and Gas Affordable Gas and Electric and AES Solar offers exclusive opportunities to save BIG on electricity, natural gas, and solar energy bills.

CREDIBILITY & KNOWLEDGE

Chamber Committees Our committees work on the programs and projects that fulfill the Chamber's mission. They are an excellent way to network within the membership.

Grow and Protect Portal Take advantage of the online resource library on business and marketing topics.

Leadership Marion Learn about leadership principles, interacting with other leaders, and applying effective practices to your organization.

Monthly Luncheons Our well-attended luncheons feature relevant and current speaker topics for our attendees.

Ribbon Cutting Members in good standing with the Marion Chamber of Commerce can schedule a Ribbon Cutting Ceremony with the Chamber free of charge.

Workshops & Webinars Hosted by fellow members and partner organizations, these training sessions are valuable to your employees and business operations.

Advanced Member Portal Benefits
(See Reverse Side)

Learn More about membership at MarionIllinois.com under "MEMBERS" or call 618-997-6311

ADVANCED MEMBERSHIP PORTAL

Launched in 2020, the 'Open for Business' marketing tool allows you to focus on your business and leave the online documentation and promotion of your business to the team of members assistants at ChamberNation.

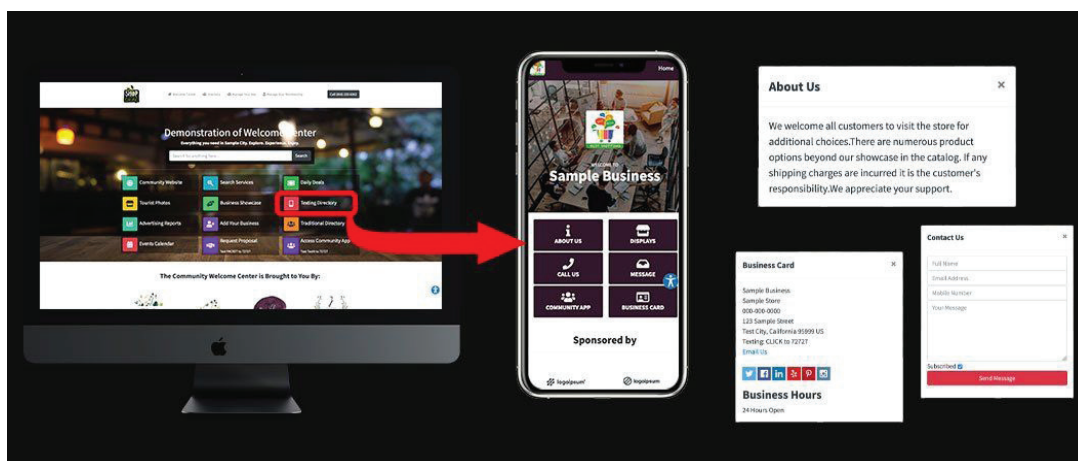

MEMBER BENEFITS INCLUDE

Texting Channel Use a texting keyword to directly connect with individuals who want to learn about your business. Share your digital business card, web links, brochures, golden ticket coupons and content to directly communicate with potential customers.

Digital Business Card / Brochure / Virtual Booth Your mobile enabled web presence spotlights services & products, a virtual booth, retail resources, and feed employment opportunities into the Marion Community Welcome Center.

Monthly Reports Every month you will receive a detailed report with marketing feedback and membership return on investment (ROI).

Personal Member Assistant A designated US-based Member Assistant will do all the work of documenting your business or organization for optimal internet searches - bringing local and international visitors to your physical and digital doorstep.

You still have total control of your content. You can manage information and your Member Assistant is there when you need them or they can update and change content to reflect the changing needs of your business. Out of the office and need to contact them? They are available via text!

You can focus on what's important - running your business.

Only \$50 per year with active chamber membership

This program is available to nonmembers for \$100.

INTEREST FORM

NAME: _____

COMPANY: _____

PHONE / EMAIL: _____

Want to Learn More? Contact the Chamber office or log on to: www.openforbusinessprogram.com
Chamber Nation is a service provider of the Marion Chamber of Commerce

Learn More about membership at MarionIllinois.com under "MEMBERS" or call 618-997-6311

Date: _____

Payment Method*: ☐ Bill Me ☐ Check Enclosed** ☐ Credit Card/Online Payment***

Membership is not active until payment received **Contact Office for Pro-rate amount *Payment Link will be emailed*

** Chamber dues cannot be deducted as a charitable donation; it can be filed as a marketing-related expense.*

Category:

☐ 1-10 Employees - \$250

☐ 51-100 Employees - \$950

☐ Individual Membership - \$250

☐ 11-25 Employees - \$425

☐ 101-250 Employees - \$1300

☐ Club/Org/Church - \$200

☐ 26-50 Employees - \$600

☐ 251 or more Employees - \$1725

☐ Add'l Business - See 2nd pg.

☐ Membership Add On: Advanced Membership Portal - \$50 annually

Business Name: _____

Voting Member Name*: _____ Voting Member Title*: _____

**If you will have more than 1 voting member, please fill out a separate application for each voting member.*

Physical Address: _____

City: _____ State: _____ Zip: _____ Year Business Started: _____

Mailing Address: _____

City: _____ State: _____ Zip: _____ Type of Business: _____

Phone Number: (_____) _____ - _____ Fax Number: (_____) _____ - _____

Toll Free Number: (_____) _____ - _____ Total Number of Employees*: _____

** Full-time employees and licensed, professionals/exclusive independent contractors (such as real estate agents, insurance agents, etc.) = 1. Part-time employees = 0.5.*

Voting Member E-Mail Address: _____

Billing E-Mail Address: _____

Business Website Address: _____

Social Media Handle:

Facebook: _____ Instagram: _____ Twitter: _____

Brief Description of Business:



ANNUAL MEMBERSHIP* INVESTMENT SCHEDULE

Categories**	Dues	Voting Members***
1-10 Employees:	\$250	1
11-25 Employees:	\$425	2
26-50 Employees:	\$600	3
51-100 Employees:	\$950	4
101-250 Employees:	\$1300	6
251 or more Employees:	\$1725	7
Individual Membership:	\$250	1

Individual Memberships are for non-business members who would like to be connected with the Marion Chamber of Commerce. If you wish for your membership to be associated with your business/organization, you must choose one of the employee-based membership categories. All individual memberships will only list the individual's name and not their business or organization in any part of the listing (including category).

Club/Organization/Church: \$200 1

Club/Organization/Church includes nonprofit clubs and organizations (any 501c status organization) and Churches. If any Club/Organization/Church wishes to have more than one voting member, they must purchase additional "Club/Organization/Church" memberships for the additional voting members.

Add an Additional Business

The first business/organization will pay the full amount for their dues and must own the second business/organization or be owned by the same company that owns the second business/organization. The second business/organization added will pay ½ of their dues, based on the number of their employees)

Categories**	Dues	Voting Members***
1-10 Employees:	\$125	1
11-25 Employees:	\$212.50	1
26-50 Employees:	\$300	2
51-100 Employees:	\$475	2
101-250 Employees:	\$650	3
251 or more Employees:	\$862.50	4

Name of Parent Company that is a member of the Marion Chamber: _____

**Memberships are pro-rated for the calendar year. **Full-time employees and licensed, professionals/exclusive independent contractors (such as real estate agents, insurance agents, etc.) = 1. Part-time employees = 0.5.*

****Number of voting members is based on Annual Dues divided by \$250. (Rounded to next whole number). The max dues amount is \$1725. A member organization/business can add a voting member by purchasing a higher employee count membership so a voting member can be added.*

The membership fee shall be payable on an annual basis. When a member is in default of payment for a period of four (4) months from the mailing of said member's investment renewal notice, the membership will be terminated. A member will not be considered in good standing if investment is not paid within 120 days of the receipt of renewal notice unless otherwise extended for good cause. The death, resignation, expulsion, dissolution or closure of a business shall terminate the member's membership and all rights incidental thereto with the exception of a business dissolution or closure which may transfer their membership to an individual status. There shall be no refund of fees or dues.

