



## Monster Truck Combo™

Congratulations on your purchase of the  
Monster Truck Combo™.

We know that you'll get many hours of excitement from your new purchase. Please read this booklet carefully, being sure to read all of the safety precautions and the do's and don'ts of the ride.

Remember to stake (tether) your inflatable as described in the "Installation and Setup" booklet, and be sure to have a minimum of (1) trained operator as defined in the booklet.

Once again, we thank you for doing business with us, and call us if you have any questions.

Sincerely,

N-Flatables / Cutting-Edge™ Brand Inflatables



2425 Enterprise Drive, Suite 600  
Mendota Heights, MN 55120



Toll Free 1-800-811-7002 • Local 651-209-8600 • Fax 651-925-0215  
www.cuttingedgecreations.com

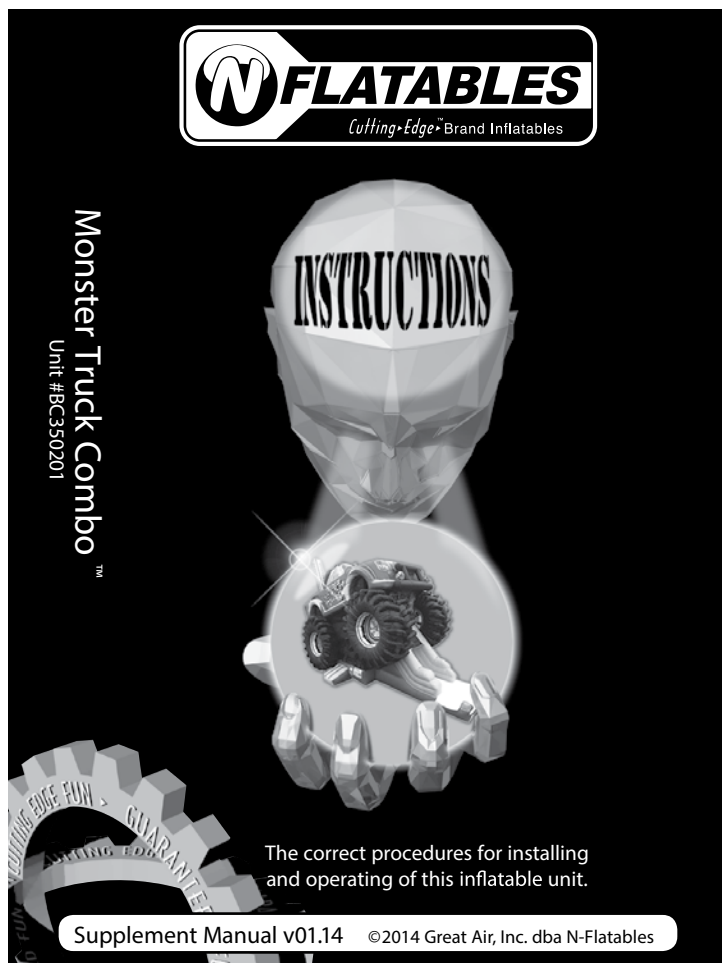

The correct procedures for installing  
and operating of this inflatable unit.

Supplement Manual v01.14 ©2014 Great Air, Inc. dba N-Flatables

## MONSTER TRUCK COMBO™ SIGNATURE BOUNCER

H W L  
18' x 13' x 33'  
UNIT #BC350201

1-Piece Unit includes: (9) giant deflation zippers, tether kit: (4) top tethers, (6) bottom tethers, mattress reinforcement strips and carrying bag. Recommended load: (6) patrons over 34" tall, maximum height not to exceed 60" tall, 150 lbs. suggested maximum weight per patron.

This Unit Requires 2 Blower(s) to Function Properly.  
CEC Suggests the following Blower Types:

• High Volume Output ..... 1.5 hp; 810 CFM

All information included in this supplement is kept current and up-to-date. N-Flatables reserves the right to update this information from time to time as needed.

### ! Safety Notice !

All materials have been tested and comply to NFPA 701 Large Scale Test and the California Title 19 fire rating test. This Inflatable Amusement Device complies to the ASTM F2374-10 standards for safety, where applicable to the specific use of this Inflatable Device. Instruction Supplement and General Installation Manuals are included with this unit.

It is YOUR RESPONSIBILITY to read and follow these important instructions to prevent injury for your patrons using this device!

Minimum CFM requirement for this inflatable is 810 CFM. NO Maximum CFM is applicable.

Recommended  
Number of  
Installers

1-2



Number  
of  
Operators

1



Maximum  
Number of  
Patrons

6



Suggested Max  
Weight per Patron  
150 lbs.



Use Whistle for Control

Total Patron  
Weight  
900 lbs.

Minimum  
& Maximum  
Height



No. of Stakes  
& Minimum  
Stake Length

(6) 40" Long

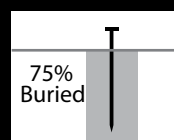

Indoor  
Weight  
Container  
Anchors

(6) 600 lbs.



Outdoor  
Hard-  
Surface  
Anchors\*

(6) 600 lbs.



\* All outdoor weight containers MAY NOT comply with all state or municipal tethering requirements for inflatable devices.



ALWAYS contact the utility company  
before pounding stakes into the ground!



# MONSTER TRUCK COMBO

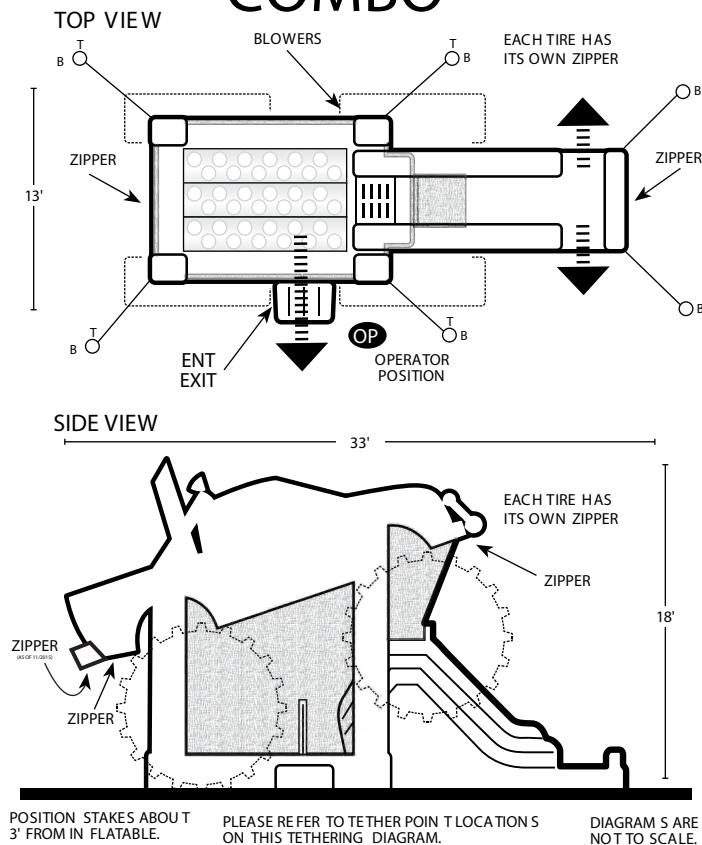

## DAILY INSPECTION CHECKLIST OF INFLATABLE

- ☐ Check to see if blower(s) is attached properly and securely to inflatable device.
- ☒ Make sure all deflation zippers are closed and secured.
- ☐ Check blower electric attachment to be sure it has been properly plugged in to receptacle.
- ☐ Make sure blower system has no obstruction restricting intake on sides of blower.
- ☐ Check inflation of unit to be sure it is properly inflated to correct firmness.
- ☐ Make adjustments to slide and climb covers if necessary to proper secure position.
- ☐ Covers need to be adjusted before each use to assure that all wrinkles are removed that could potentially cause injury. Also it is important to inspect all covers showing signs of wear are replaced before using this device.
- ☐ Make sure all tether points are attached properly.
- ☐ Check netted areas and sun covers to be sure they are in place and in good condition.
- ☐ Crawl through (if possible) inflated device and examine all visible seams for stretching or wear. If problems with any seams contact manufacturer to advise.
- ☐ Inspect the inflatable for loose stitching causing open seams, torn netting, worn holes in bottom or sides of unit. If found, cease use and repair immediately using supplied repair kit. Or if a hole or seam is open more than 1 - 2 inches, professionally repair using 207 polyester thread from a reputable inflatable repair center.

## Directions

- Read instruction booklet.
- Remove unit from storage bag.
- Position on a level ground area approximately 19' x 39'.
- Install ground stakes, at least (6) around perimeter.
- Loosely tie tethers to ground stakes.
- Attach (2) blower(s) to tubes, making sure Velcro strap is firmly secure.
- Close zippers & flaps on all locations of unit and make sure they are secure.
- Connect each blower to its own power source. Keep in mind that each blower used will require a constant supply of 110-volt, 20-amp power.
- Turn blower system on and guide the unit until it is fully inflated.
- Installer must stand at the rear of the inflatable for assistance in lifting the rear of the inflatable truck to full and upright inflated position. [See Diagram].
- Secure all tethers after the unit is fully inflated.
- Do a safety check of blowers, slide & climb covers.
- Do not operate this unit in winds in excess of 15 mph.

**NEVER LEAVE THIS RIDE UNATTENDED!**



### KEY TO DIAGRAM

- T = Top Tether
- B = Bottom Tether
- ENT = Entrance
- EXIT = Exit
- ||||| = Evacuation
- BL = Blower Locations
- ZIP = Deflation Zipper
- OP = Operator Position

### Static Dimensions (in bag)



### Dynamic Dimensions (inflated)

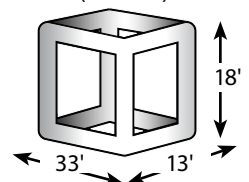

## Catastrophe!

This type of catastrophe can always be avoided by proper tethering, utilizing 24" long ground stakes, and by having trained operators on duty and avoiding inclement weather (such as high winds i.e. winds in excess of 15 m.p.h.).

## Important Notice:

Specifications for Inflatable Devices may change based on reconfigurations that may be required for the proper use of an inflatable device.

These changes may include, but not be limited to, the following:

- 1) Maximum Heights of Patrons.
- 2) Minimum Heights of Patrons.
- 3) Number of Patrons (on a device at one time).
- 4) Maximum Weight
- 5) Number Of Stakes
- 6) Size of Stakes
- 7) Number of Blowers
- 8) Overall physical dimensions of the device.

Any noted current changes made to any inflatable device will be updated on our website: <http://www.cuttingedgecreations.com>.

# Step by Step Procedure: Monster Truck Combo™



1. Enter the unit by crawling head first through the entrance.



2. Once inside, start jumping around on the mattress. Be sure to leave room for others.



Be sure to leave room  
between you and others!



3. Exit the unit with the help of the operator (if need be).

## If Using Built-In Slide...

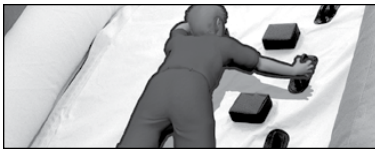

4. Climb up the hill to the slide using the safety handles!



5. With arms crossed, slide down the slide feet first. No Diving!



6. Exit the unit with the help of the operator (if needed).

**NOTE: Never Pull The Weight Of The Inflatable On A Single Portion Of The Inflatable Device**

Damage Can Be Caused By Pulling On Cosmetic Themed Portions Of The Inflatable.



**Pull To Adjust The Inflatable During Inflation And Deflation On The Supplied Anchor Tethers ONLY!**



**Avoid Contact with Others!**  
Passengers must be instructed to use or ride unit individually. Do NOT allow double-riding, as accidents WILL happen!



**Do Not Hit Your Head!**  
DO NOT dive or enter unit head first, as head or neck injuries may occur!

Improper use of this inflatable may cause serious injury!

Operator Take Control...  
**Use Whistle!**

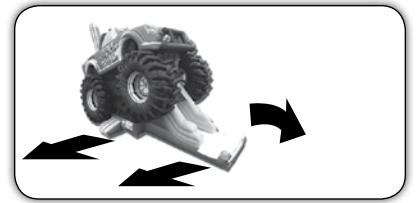

## Evacuation Procedures!

The blower tube has an automatic air flap that reduces the loss of air if the blower system goes off. In the event of a power outage or emergency take-down, direct patrons off the inflatable as shown by arrows in the diagram shown above.

ASTM Standard #F7324-06 6.6.1 Operators & attendants shall incorporate the use of whistles or other devices or signal equipment & take appropriate action at the first sign of misbehavior or violation of posted rules.

Make sure all operators understand the proper procedures for using this inflatable, and that passengers must follow the rules.

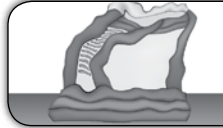

## Deflation Rate of Inflatable:

Type of Testing: Observed

Deflation Rate to unsafe conditions: 3-5 minutes.



## Avoid Contact with Others!

Passengers must be instructed to use or ride unit individually. Do NOT allow double-riding, as accidents WILL happen!



## Do Not Hit Your Head!

DO NOT dive or enter unit head first, as head or neck injuries may occur!



## Keep Landing Areas Clear!

Operators should not allow participants to land on one another. Accidents WILL happen!



## Instruct Safety!

Instruct riders to follow the safety rules located on entrance side of unit. NO flipping, as injuries may occur!



## Watch Out for High Temps!

DO NOT operate when temperatures exceed 90-degrees. Watch for early signs of heat exhaustion and for dehydration.

## ! Important! Use and Indemification: !

"Buyer" (person, company or entity purchasing the inflatable product or device), is solely responsible for the manner of use of the products and other equipment purchased from N-Flatables. "Buyer" is solely responsible for all signage, labels and warnings to consumers or other users of the products and equipment, and for any and all other acts necessary, including user warnings and limitations (e.g., weight, height, age, number of participants and medical condition limitations), to ensure the safety of the users. "Buyer" acknowledges that they have received, read and fully understand all necessary instructions for the safe setup and operation of their Cutting Edge Creations(BRAND) inflatable product or device. "Buyer" agrees to operate their Cutting Edge Creations(BRAND) inflatable product or device according to the instructions established by Cutting Edge Creations (BRAND). "Buyer" agrees to operate their inflatable product or device according to all state and local requirements. "Buyer" agrees to train any person(s) operating the inflatable product or device in the safe operation of the inflatable product or device including safe handling of emergency situations. "Buyer" shall use proper stakes, tie-downs, and other applicable devices necessary to ensure the safety of users and the general public. "Buyer" agrees to indemnify, defend and hold harmless N-Flatables and N-Flatables Insurers from actions and claims of third parties, including customers of "Buyer" and users of the goods and products sold to "Buyer", arising out of or in connection with the use of the goods and products herein described or resulting from the breach of the provisions in this Confirmation of Order by "Buyer". In the event N-Flatables is required to commence an action to enforce this provision, "Buyer" shall pay all of N-Flatables legal costs and expenses.



### SAMPLE WARNING LABEL

A Warning Label is placed on every inflatable that N-Flatables produces. The image shown above is only a sample of the Warning Label found on the side of your inflatable, and may not represent the information pertinent to the safety of this particular unit. Please instruct all participants to follow Safety Procedures!

**Please instruct all participants to follow Safety Procedures!**

## ! IMPORTANT NOTICES! !

**! Manufacturer DOES NOT WARRANT THE SAFETY OF THIS DEVICE, if used by owner or operator, in any way that violates manufacturers safety guidelines for safe set up and operation. YOU the owner or operator, are liable for any injuries that may occur because of YOUR negligence.**

**! DO NOT ALTER THIS DEVICE.** Any repairs or alterations to this device not performed by the manufacturer will **VOID** any warranty and manufacturers responsibility for the safety of this device.

**! SAFETY SUN COVER:** The Safety Sun Cover on this device must not be removed for any reason while the inflatable is in use. This Safety cover maintains the structural integrity of the device while maintaining a protective cover to prevent patrons from inappropriate use of the device, which includes but is not limited to, Diving and jumping.



ADVERTISEMENT

## Optional Safety sign: "The Inflatable Experience™"

Avoid such potential liability problems with this information board prepared especially for the inflatable industry! This durable double-sided "A" framed sign list the sensations that one may experience, such as 'dizziness or vertigo, possible strain on knees and elbows' and 'a bouncy feeling with a recoil action', etc...

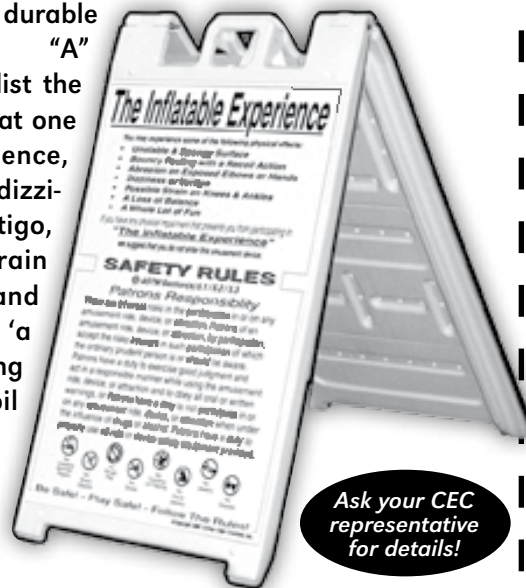

ADVERTISEMENT

ADVERTISEMENT

## WATCHDOG™ BLOWER-SIREN

The Watchdog™ blower siren is the future for safer operation of inflatable amusement rides.



It is amazing that the inflatable industry has gone without any type of device for monitoring inflation. N-Flatables, is a licensed provider of the Watchdog™ Blower Siren.

WATCHDOG™ pods are only available in 110v.

U.S. Patent #6,650,246

**Safety Air Systems, LLC**

info@safetyairsystems.com

www.safetyairsystems.com



ADVERTISEMENT

## SLIDE MAINTENANCE



### For Best Slide Maintenance Results, Apply 303 Aerospace Vinyl Protector!

Apply spray to slide areas only to keep them slippery (new inflatables will need additional coverage). All units should be maintained every hour to keep the surface slippery.

### ! WARNING! !

Do not apply spray finish to any climbing, landing or positioning surfaces as accidents may occur.