

FOR LEASE

1018 E Acacia Street Ontario, CA, 91761

±13,294 SF FREESTANDING INDUSTRIAL BUILDING



Property
Aerial

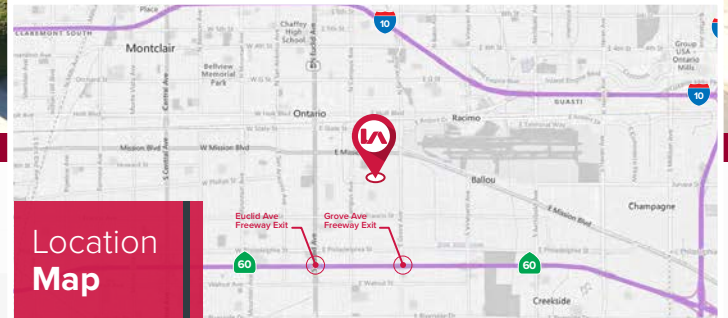

Location
Map

Property Highlights

Building Size: ±13,294 SF

Clear Height: 20'

Sprinkler: 0.21 GPM / 1,500 SF

Lot Size: ±27,390 SF

GL Loading: Three (3)

Year Built: 1992

Office Build-Out: ±1,200 SF (Single Story)

Power: 400 Amps, 480 Volts, 3 Phase

Restrooms: Three (3)

Lease Rate

TBD + CAM \$0.06 PSF/Month

JOHN SEOANE, SIOR

Senior Vice President, Principal | Lic. # 01453455
P\\ 562.547.8021
E\\ jseoane@lee-assoc.com

MICHAEL LEE, MBA, CCIM, SIOR

Senior Vice President | Lic. # 01703179
P\\ 562.568.2018
E\\ mlee@lee-associates.com

TAI NGO, CCIM

Senior Vice President | Lic. # 01779172
P\\ 626.622.9770
E\\ tngo@lee-associates.com

Lee & Associates - Industry
13181 Crossroads Pkwy, North, Suite 300
City of Industry, CA 91746
(562) 699-7500 | lee-associates.com

FOR LEASE

1018 E Acacia Street

Ontario, CA, 91761

±13,294 SF FREESTANDING INDUSTRIAL BUILDING

Property Site Plan

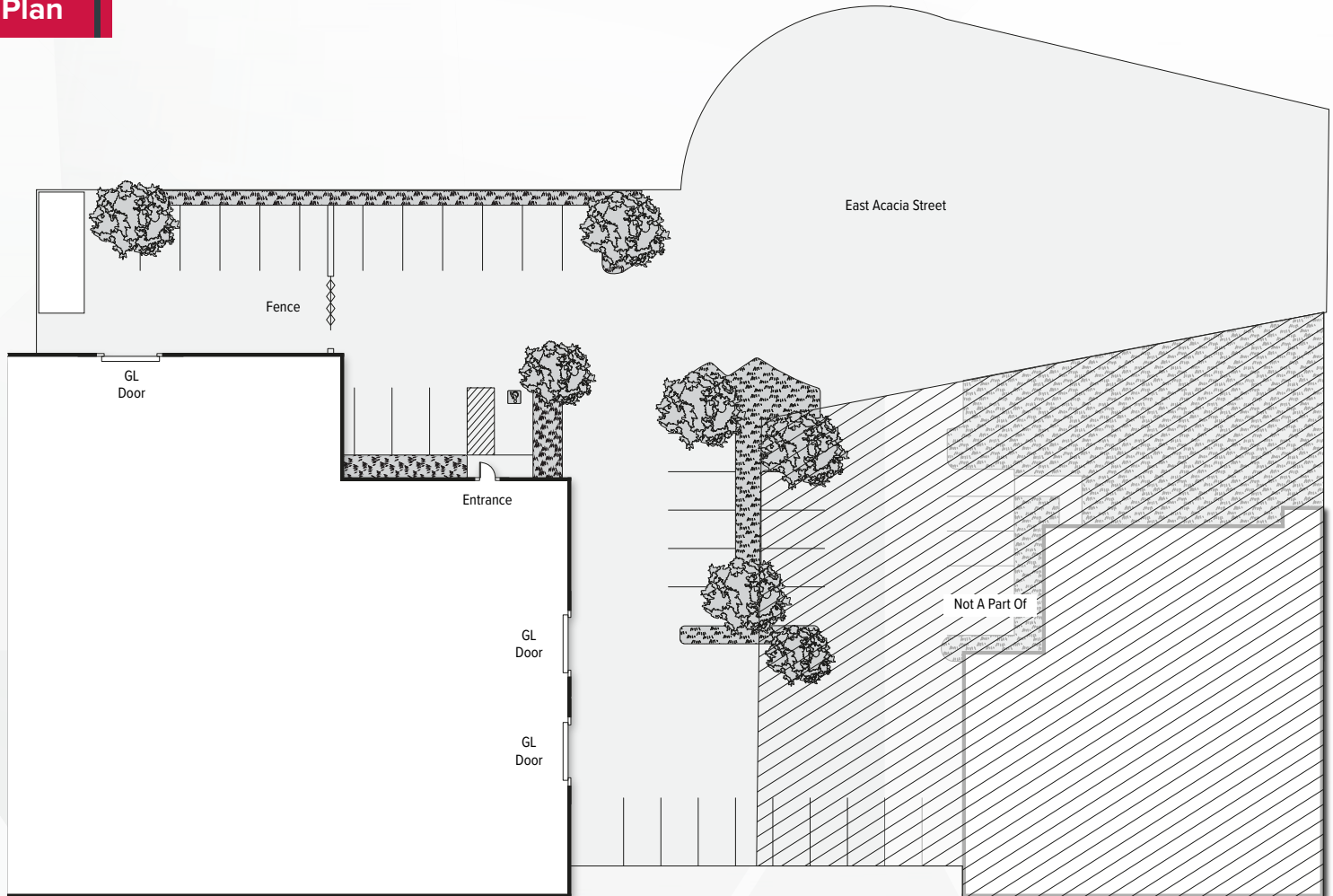

• Not to Scale | Not Exact



JOHN SEOANE, SIOR

Senior Vice President, Principal | Lic. # 01453455
P\\ 562.547.8021
E\\ jseoane@lee-assoc.com

MICHAEL LEE, MBA, CCIM, SIOR

Senior Vice President | Lic. # 01703179
P\\ 562.568.2018
E\\ mlee@lee-associates.com

TAI NGO, CCIM

Senior Vice President | Lic. # 01779172
P\\ 626.622.9770
E\\ tngo@lee-associates.com

Lee & Associates - Industry
13181 Crossroads Pkwy, North, Suite 300
City of Industry, CA 91746
(562) 699-7500 | lee-associates.com

FOR LEASE

1018 E Acacia Street

Ontario, CA, 91761

±13,294 SF FREESTANDING INDUSTRIAL BUILDING

Proximity Map

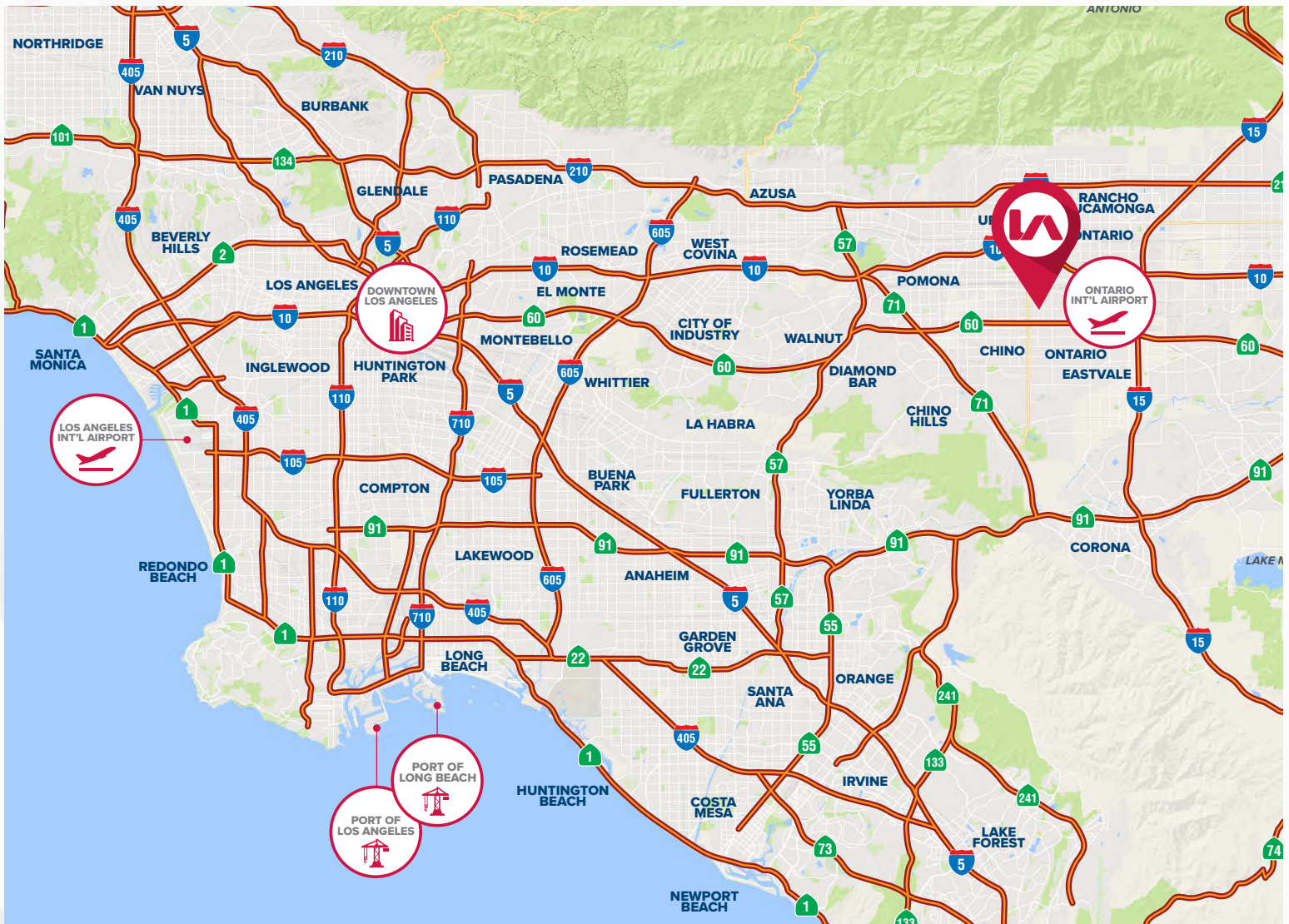

JOHN SEOANE, SIOR

Senior Vice President, Principal | Lic. # 01453455
P\\ 562.547.8021
E\\ jseoane@lee-assoc.com

MICHAEL LEE, MBA, CCIM, SIOR

Senior Vice President | Lic. # 01703179
P\\ 562.568.2018
E\\ mlee@lee-associates.com

TAI NGO, CCIM

Senior Vice President | Lic. # 01779172
P\\ 626.622.9770
E\\ tngo@lee-associates.com

Lee & Associates - Industry
13181 Crossroads Pkwy, North, Suite 300
City of Industry, CA 91746
(562) 699-7500 | lee-associates.com