



B I A
T O O L S

REGULAR SINGLE ACTING

MODEL: SR-101

Form. # 10002

sales@bia-tools.com www.bia-tools.com

Not all components of cylinder are replacement items, but are illustrated as a convenient reference of location and position in the assembly sequence.

PARTS ILLUSTRATION

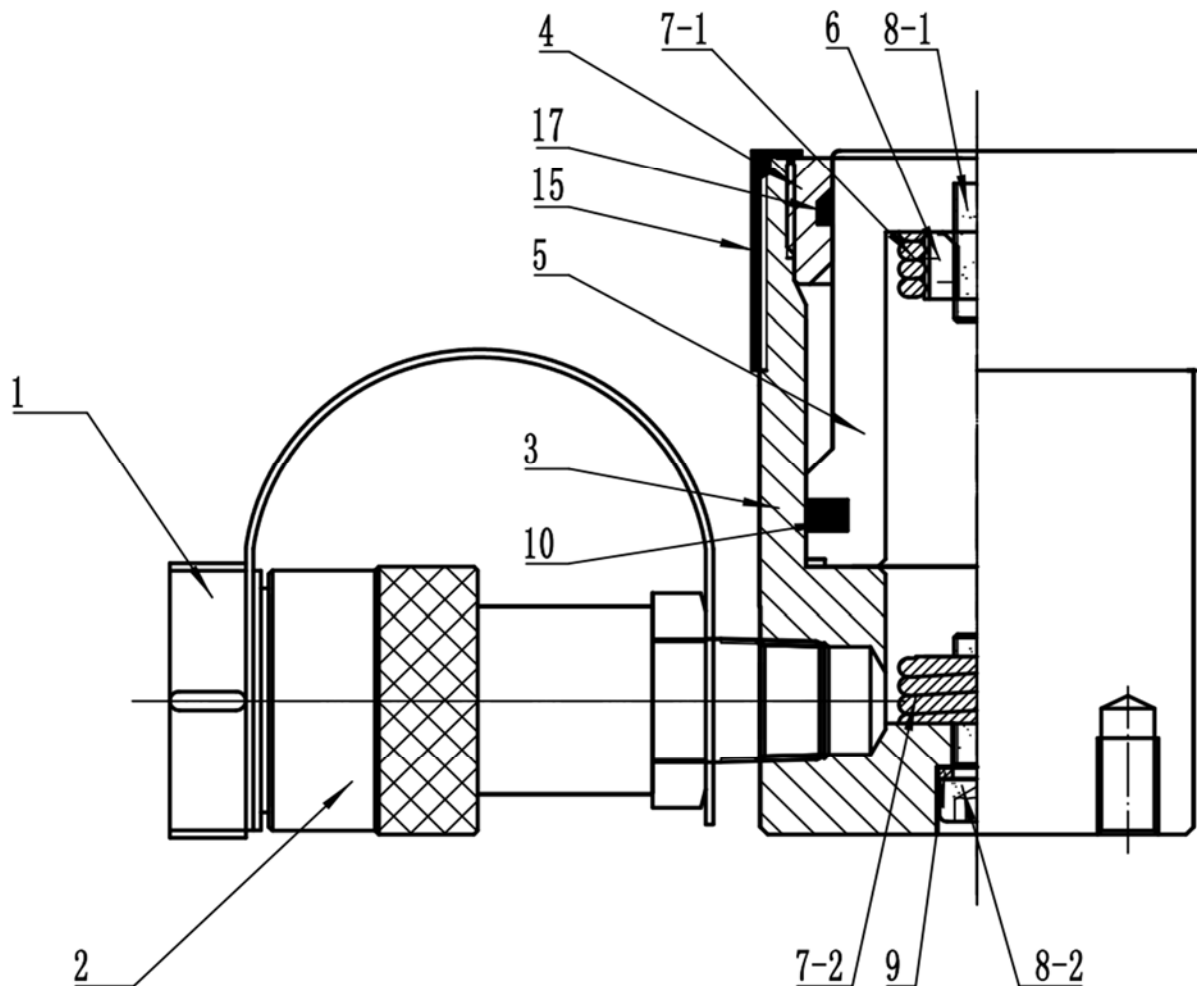



BIA TOOLS

REGULAR SINGLE ACTING

MODEL: SR-101

Form. # 10002

sales@bia-tools.com www.bia-tools.com

PARTS LIST

| ITEM | DESCRIPTION | QTY | SR-101 |
|------|-------------------------------|-----|--------------|
| 1 | Coupler Cover | 1 | BT-QCC06 |
| 2 | Quick Coupler | 1 | BT-QCF06 |
| 3 | Cylinder Body | 1 | BT-SR101-3 |
| 4 | Guide Sleeve | 1 | BT-SR10-4 |
| 5 | Piston Rod | 1 | BT-SR101-5 |
| 6 | Spring Fixing Sleeve | 1 | - |
| 7-1 | Spring Core | 1 | - |
| 7-2 | Spring (Included #6 And #7-1) | 1 | BT-SR101-7-2 |
| 8-1 | Bolt | 1 | * |
| 8-2 | Bolt | 1 | * |
| 9-1 | Copper Washer | 1 | * |
| 9-2 | Copper Washer | 1 | - |
| 10 | Seal Ring | 1 | * |
| 11 | Retaining Ring | 1 | - |
| 12 | Spring Latch | 1 | - |
| 13 | Piston Bearing | 1 | - |
| 14 | Stop Ring | 1 | - |
| 15 | Thread Protector | 1 | BT-SR10-15 |
| 16 | Adapter | 1 | - |
| 17 | Wiper | 1 | * |
| * | Included in Repair Kit | 1 | BT-SR10-RK |