

25<sup>th</sup>

# Cancer Center Summit

May 7 - 9, 2026

San Diego, CA



Turning data  
into knowledges,  
and knowledge  
into health

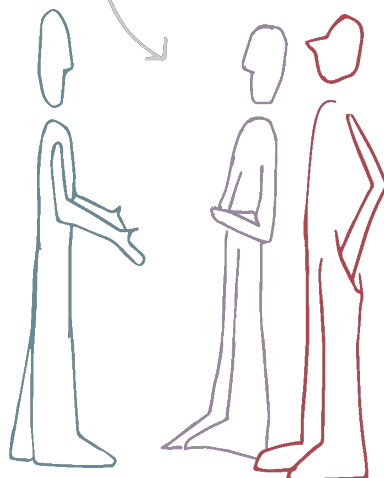

## 25th Cancer Center Summit

### “Architecting the Future of Interconnected Cancer Data Ecosystems”

Celebrating over twelve years of leadership, the 25th Cancer Center Informatics Society (Ci4CC) Summit, chaired by the City of Hope Comprehensive Cancer Center, convenes national leaders from academia, industry, government, and patient advocacy at a pivotal moment for oncology. The field is moving beyond fragmented data collection toward the deliberate design of a connected cancer data ecosystem that directly advances discovery and care.

As precision oncology demands timely, data-driven decisions, the summit will focus on integrating multimodal assets into scalable learning health systems. Sessions will address the infrastructure, interoperability, and governance needed to align wearable data, real-world datasets, patient-reported outcomes, clinical trials, cancer registries, and population-scale resources. The goal is simple: ensure insights move seamlessly from research systems to the point of care.

Leaders from federal agencies, standards organizations, life sciences, technology partners, and both NCI-designated and community-based cancer centers will define practical models for secure data sharing and national collaboration. Grounded in patient perspectives and informed by evolving policy frameworks, the 25th Ci4CC Summit will establish the standards and partnerships required to accelerate translational impact and improve outcomes nationwide.

Dr. John D. Carpten, Ph.D. (Chair)  
Director, COH’s NCI-Designated Comprehensive Cancer Center

Dr. David W. Craig, Ph.D. (co-Chair)  
COH’s Deputy Director of Translational Sciences, AD for Data Science

Dr. Stacy W. Gray, M.D., A.M. (co-Chair)  
COH’s Director of Clinical and Scientific Strategy, VP System Strategy



## 25th Cancer Center Summit

### Thursday May 7<sup>th</sup> (Pre-Conference Workshop)

12 Noon	Exhibit Hall Booth Setup Open through 9 PM (Salon CDE)
5 - 7 PM	Registration - Omni Hotel Conference Ballroom (Salon AB)
6 - 9 PM	Pre-Conference 2026 Initiative Forum (Salon AB)
	<ul style="list-style-type: none"> <li>• Joint Initiatives Program Overview &amp; Introduction: Sorena Nadaf-Rahrov, MS, MMI</li> </ul>
	<ul style="list-style-type: none"> <li>• Open to all attendees. Please RSVP <a href="#">[HERE]</a></li> </ul>
	<ul style="list-style-type: none"> <li>• Oracle Health &amp; Life Sciences Initiative</li> </ul>
	<ul style="list-style-type: none"> <li>• Natera Initiative</li> </ul>
	<ul style="list-style-type: none"> <li>• Empower Hope Initiative</li> </ul>
	<ul style="list-style-type: none"> <li>• Health Universe AI Collaborative Initiative</li> </ul>

### Friday May 8<sup>th</sup> (Day 1)

7:00 AM	<b>Registration</b> <ul style="list-style-type: none"> <li>• Salon AB</li> </ul>
7:00 AM	<b>Breakfast</b> <ul style="list-style-type: none"> <li>• Salon CDE</li> </ul>
7:05 AM	<b>Health Universe AI Collaborative Initiative Working Group</b> <ul style="list-style-type: none"> <li>• Closed – Gaslamp 1 <a href="#">(RSVP Required: Members of Academic Community)</a></li> </ul>
8:05 AM	<b>Day 1 Kickoff and Welcome Remarks (Salon AB)</b> <ul style="list-style-type: none"> <li>• Steven D. Nimer, MD - Past Chair                             <ul style="list-style-type: none"> <li>○ Director, University of Miami Sylvester Comprehensive Cancer Center</li> </ul> </li> </ul>
8:15 AM	<b>Chairs Welcome &amp; Conference Breakdown</b> <ul style="list-style-type: none"> <li>• John D. Carpten, PhD - Summit Chair                             <ul style="list-style-type: none"> <li>○ Director, City of Hope Comprehensive Cancer Center</li> </ul> </li> <li>• David W. Craig, PhD - Summit co-Chair                             <ul style="list-style-type: none"> <li>○ AD Data Science, Deputy Director Translation Sciences, COH CCC</li> </ul> </li> <li>• Stacy Gray, MD - Summit co-Chair                             <ul style="list-style-type: none"> <li>○ Director of Clinical &amp; Scientific Strategy, VP System Strategy, COH CCC</li> </ul> </li> </ul>
8:30 AM	<b>Session 1</b> Translational Research Data Systems <ul style="list-style-type: none"> <li>• David W. Craig, PhD - Deputy Director of Translational Sciences, AD for Data Science, City Of Hope Comprehensive Cancer Center</li> </ul>

## 25th Cancer Center Summit

	<ul style="list-style-type: none"> <li>○ Session Chair &amp; Moderator</li> <li>● David Birtwell, PhD - Cancer Data Officer, USC Norris Comprehensive Cancer Center</li> <li>● Michael Hogarth, MD, FACMI, FACP - Chief Research Information Officer, Professor, University of San Diego Health</li> <li>● Warren Kibbe, PhD - Deputy Director for Data Science &amp; Strategy, NCI</li> <li>● Panel</li> </ul>
9:30 AM	<p><b>Session 2</b></p> <p>Dog Catches Car: Leveraging Federated Learning in the Connected Oncology Ecosystem</p> <ul style="list-style-type: none"> <li>● Fred Lee, MD, MS           <ul style="list-style-type: none"> <li>○ Session Chair &amp; Moderator</li> </ul> </li> <li>● Umit Topaloglu, PhD - National Cancer Institute CBIT</li> <li>● Brian Bot - Fred Hutch Comprehensive Cancer Center</li> <li>● Ghulam Rasool, PhD – Moffitt Comprehensive Cancer Center</li> <li>● Eric Just - Just Health Technologies</li> <li>● Panel</li> </ul>
10:30 AM	<p><b>Networking Break</b></p> <ul style="list-style-type: none"> <li>● Exhibits &amp; Cancer Center Booths - Salon CDE</li> </ul>
11:00 AM	<p><b>Cancer Center Directors Circle Distinguished Keynote</b></p> <ul style="list-style-type: none"> <li>● Cheryl Willman, MD           <ul style="list-style-type: none"> <li>○ Director, Mayo Clinic Comprehensive Cancer Center</li> <li>○ Stephen and Barbara Slaggie Executive Director, Mayo Clinic Cancer Programs</li> </ul> </li> </ul>
11:30 PM	<p><b>Session 3</b></p> <p>Chief Data Officer Panel on Multi Model Data Assets</p> <ul style="list-style-type: none"> <li>● Madhu Behera, PhD - Chief Data Officer Winship Cancer Institute, Emory University           <ul style="list-style-type: none"> <li>○ Session Chair and Moderator</li> </ul> </li> <li>● David Craig, PhD - AD for Data Science, Deputy Director of Translational Sciences</li> <li>● Sandip P. Patel, MD, FASCO – Professor Medical Oncology, Deputy Director Sanford Stem Cell Clinical Center, Medical Director, Clinical Research Informatics</li> <li>● Cancer Registries and its future digital data ecosystem</li> <li>● Panel</li> </ul>
12:30 PM	<p><b>Networking Lunch</b></p> <ul style="list-style-type: none"> <li>● Salon CDE</li> </ul>

## 25th Cancer Center Summit

1:30 PM	<p><b>Student Abstract Presentation</b></p> <ul style="list-style-type: none"> <li>● “Detecting Toxicity Before It Happens: Artificial Intelligence for Early Identification of Immune Related Adverse Events in Checkpoint Inhibitor Therapy” <ul style="list-style-type: none"> <li>○ Gabriel Beltran, Class of 2028, NSU Florida</li> </ul> </li> <li>● “Using multi-scale spatial integration of histology and transcriptomics to discover hidden tumor microenvironment motifs.” <ul style="list-style-type: none"> <li>○ Nina Jiarong Song, PhD Student in Biological Sciences, City of Hope Cancer Genomics, Bioinformatics, and Deep Learning</li> </ul> </li> </ul>
2:00 PM	<p><b>Distinguished Corporate Keynote with Oracle Health</b></p> <ul style="list-style-type: none"> <li>● Seema Verma <ul style="list-style-type: none"> <li>○ Executive Vice President &amp; General Manager, Oracle Health &amp; Life Sciences</li> </ul> </li> </ul>
2:30 PM	<p><b>Oracle Health National Alliance Ci4CC Initiative Fireside Chat</b></p> <ul style="list-style-type: none"> <li>● Reena Desuja, MD, MS (Oracle Health)</li> <li>● Sorena Nadaf-Rahrov, MS, MMI (Ci4CC)</li> </ul>
3:00 PM	<p><b>Networking Break</b></p> <ul style="list-style-type: none"> <li>● Exhibits &amp; Cancer Center Booths - Salon CDE</li> </ul>
3:30 PM	<p><b>Distinguished Corporate Keynote with Integra Connect</b></p> <p>Precision Oncology &amp; Artificial Intelligence: Enabling Insights &amp; Optimizing Care Delivery</p> <ul style="list-style-type: none"> <li>● Jeffrey Scott, MD - President and Chief Medical Officer, Integra Connect</li> </ul>
4:00 PM	<p><b>Distinguished Corporate Keynote with Natera</b></p> <ul style="list-style-type: none"> <li>● Solomon Moshkevich, MBA - President of Clinical Diagnostics, Natera</li> </ul>
4:30 PM	<p><b>Cancer Center Distinguished Keynote</b></p> <ul style="list-style-type: none"> <li>● “RADIANT: Real Time Analysis and Discovery in Integrated And Networked Technologies” <ul style="list-style-type: none"> <li>○ Adam C. Resnick, PhD – Director, Center for Data-Driven Discovery in Biomedicine (D3B)</li> <li>○ Children’s Hospital of Philadelphia (CHOP), University of Pennsylvania</li> </ul> </li> </ul>
5:00 PM	<p><b>Cancer Center Initiatives Program Questions &amp; Answers</b></p> <ul style="list-style-type: none"> <li>● Moderated by Sorena Nadaf-Rahrov, MS, MMI <ul style="list-style-type: none"> <li>○ Recap Pre-Conference Workshop &amp; Initiatives Program Overview</li> <li>○ A Review of New National Initiatives Under Planning: <ul style="list-style-type: none"> <li>■ Guardant Health, NACCSR, SU2C, Federated Data Model Systems.</li> </ul> </li> </ul> </li> </ul>
5:15 PM	<p><b>Adjourn Day 1</b></p>

## 25th Cancer Center Summit

6:30 - 10:00 PM	<b>Chairs' Reception for all Guests</b> <ul style="list-style-type: none"><li>● Tortuga Terrace (6<sup>th</sup> Floor)<ul style="list-style-type: none"><li>○ Cancer Center Directors Circle Induction Ceremony</li><li>○ Society Dinner</li><li>○ Brady Davis Networking Reception</li></ul></li></ul>
--------------------	---



## 25th Cancer Center Summit

**Saturday, May 9th (Day 2)**

7:00 AM	<b>Registration</b> <ul style="list-style-type: none"> <li>• Salon AB</li> </ul>
7:00 AM	<b>Breakfast</b> <ul style="list-style-type: none"> <li>• Salon CDE</li> </ul>
7:05 AM	<b>Oracle Initiative Working Group</b> <ul style="list-style-type: none"> <li>• Closed : Gaslamp 1 (<a href="#">RSVP Required: Members of Academic Community</a>)</li> </ul>
8:05 AM	<b>Day 2 Welcome and Kickoff Remarks</b> <ul style="list-style-type: none"> <li>• Warren Kibbe, PhD <ul style="list-style-type: none"> <li>○ Deputy Director for Data Science &amp; Strategy, National Cancer Institute</li> <li>○ co-founder, Cancer Center Informatics Society</li> </ul> </li> </ul>
8:15 AM	<b>25th Ci4CC Cancer Center Director Distinguished Keynote</b> <ul style="list-style-type: none"> <li>• John D. Carpten, PhD <ul style="list-style-type: none"> <li>○ Director, City of Hope Comprehensive Cancer Center</li> <li>○ Chief Science Officer, Director Beckman Research Institute</li> </ul> </li> </ul>
8:45 AM	<b>Session 4</b> Turning Patient Data into Clinical Action. Patient Generated Data / PRO's <ul style="list-style-type: none"> <li>• Stacy Gray, MD - City of Hope CCC. Director of Clinical &amp; Scientific Strategy, VP System Strategy <ul style="list-style-type: none"> <li>○ Session Chair and Moderator</li> </ul> </li> <li>• Lee Jones, PhD - Director, Exercise Oncology Program, Beckman Research Institute, City of Hope CCC</li> <li>• Shelby D. Yaceczko, DCN, RDN-AP, CNSC - UCLA Health &amp; F-U Cancer</li> <li>• Alexi Wright, MD, MPH - Director of Gynecologic Oncology Outcomes Research, Dana-Farber Cancer Institute. Associate Professor, Harvard Medical School</li> <li>• Panel</li> </ul>
9:45 AM	<b>Distinguished Keynote with Guardant Life Sciences: “From Data to Decisions: Transforming Patient Care with AI”</b> <ul style="list-style-type: none"> <li>• Amar Das, MD, PhD, FACMI – Vice President, AI and Translational Medicine, Guardant Health</li> </ul>
10:15 AM	<b>Networking Break</b> <ul style="list-style-type: none"> <li>• Exhibits &amp; Cancer Center Booths - Salon CDE</li> </ul>

## 25th Cancer Center Summit

10:45 AM	<p><b>Session 5</b></p> <p>From Insight to Impact: How AI is Reshaping Learning Models</p> <ul style="list-style-type: none"> <li>● Nasim Eftekhari, MS, Chief AI &amp; Analytics Officer, City of Hope CCC <ul style="list-style-type: none"> <li>○ Session Chair and Moderator</li> </ul> </li> <li>● Helia Mohammadi, PhD - Chief Research Informatics Officer, City of Hope CCC</li> <li>● Kshitij Jaggi, CEO of RISA Labs</li> <li>● Bradley Taylor, FAMIA – Chief Research Informatics Officer, MCW Cancer Center</li> <li>● Panel</li> </ul>
11:45 AM	<p><b>Cancer Center CCSG Core Facilities &amp; NACCSR Alliance Ci4CC Initiative</b></p> <ul style="list-style-type: none"> <li>● Nick P. Ambulos, PhD - AD for Shared Services, Greenbaum CCC, SRA co-Lead. <ul style="list-style-type: none"> <li>○ Panel Chair &amp; Moderator</li> </ul> </li> <li>● Gordon Roble, DVM - AVP for Shared Resources, Fred Hutch CCC</li> <li>● John Termini, PhD - AD for Shared Resource Management, Professor, COH CCC</li> <li>● Shreya Kanodia, PhD - AVP and Deputy Director for Administration, UT MD Anderson CCC, SRM co-Lead (z)</li> <li>● Sorena Nadaf-Rahrov, MS, MMI - Shared Resources Alliance co-Lead</li> <li>● Informatics and Technology Shared Resources National Alliance</li> <li>● Panel</li> </ul>
12:30 PM	<p><b>Networking Lunch</b></p> <ul style="list-style-type: none"> <li>● Salon CDE</li> </ul>
1:30 PM	<p><b>Session 6</b></p> <p>Fueling the Future - Empowering Emerging Voices in Cancer Informatics and Data Science</p> <ul style="list-style-type: none"> <li>● Marvin Rothwell, PhD - Duke Cancer Institute <ul style="list-style-type: none"> <li>○ Session Chair &amp; Moderator</li> </ul> </li> <li>● Chloe Fournier - Senior Director, Research Strategy and Operations, Duke University</li> <li>● Seungchan Kim, PhD - Chief Scientist &amp; Executive Professor Department of Electrical and Computer Engineering, Director of CRI Center for Computational Systems Biology, Prairie View A&amp;M University</li> <li>● Melissa Davis, PhD - Director MSM Institute of Translational Genomic Medicine, Executive Director, MSM Center for Genomic Diversity, Professor Microbiology, Biochemistry, and Immunology. Morehouse School of Medicine</li> <li>● Vence L. Bonham, Jr., JD - President and CEO, Diaspora Human Genomics Institute, Founding Director, Meharry Center for Bioethics, Meharry School of Medicine</li> </ul>

## 25th Cancer Center Summit

	<ul style="list-style-type: none"> <li>• Panel</li> </ul>
2:30 PM	<p><b>Corporate Keynote RISA Labs</b></p> <ul style="list-style-type: none"> <li>• Kshitij Jaggi, CEO of RISA Labs</li> <li>• Edward Licitra, MD, CEO of Astera Cancer Care</li> </ul>
3:00 PM	<p><b>Networking Break</b></p> <ul style="list-style-type: none"> <li>• Exhibits &amp; Cancer Center Booths - Salon CDE</li> </ul>
3:30 PM	<p><b>Commercialization of Cancer Therapies</b> - “Bench to Bedside Drug Development Pipeline”</p> <ul style="list-style-type: none"> <li>• Linda Malkas, PhD - Dean, Translational Science, External Affairs, COH <ul style="list-style-type: none"> <li>○ Panel Chair &amp; Moderator</li> </ul> </li> <li>• Larry Kwak, MD, PhD - CEO, CSO, Founder - Pepromene Bio</li> <li>• Bill Benke - CEO, Cizzle Bio</li> <li>• Rick Heinick - CEO, Slam Bio</li> <li>• Panel</li> </ul>
4:30 PM	<p><b>Next Generation Clinical Trials Management Systems &amp; the EMR</b></p> <ul style="list-style-type: none"> <li>• Mike Hogarth, MD, FACMI, FACP - Chief Research Information Officer, UCSD Health</li> <li>• Sorena Nadaf-Rahrov, MS, MMI - Cancer Center Informatics Society <ul style="list-style-type: none"> <li>○ Mike &amp; Sorena: Working Group co-chairs</li> </ul> </li> <li>• Regina Schwind, MBA - Chief Clinical Data and Innovation Officer, Triomics</li> <li>• Laura Hilty, Chief Strategy &amp; Product Officer, Ignite Data. (z)</li> <li>• Anai N. Kothari, MD, MS – Assistant Professor, Medical College of Wisconsin (z)</li> <li>• Nojan Namakian, Strategic Partnerships and Alliance Management, COH</li> <li>• Launch of National CTMS-EMR Focus Group</li> <li>• Panel</li> </ul>
5:15 PM	<p><b>Adjourn 25th Cancer Center Summit</b></p> <ul style="list-style-type: none"> <li>• John D. Carpten, PhD - Director, City of Hope Comprehensive Cancer Center <ul style="list-style-type: none"> <li>○ 25<sup>th</sup> Cancer Center Informatics Society Summit Chair</li> </ul> </li> <li>• David W. Craig, PhD - AD Data Science, Deputy Director Translation Sciences, COH <ul style="list-style-type: none"> <li>○ 25<sup>th</sup> Cancer Center Informatics Society Summit co-Chair</li> </ul> </li> <li>• Stacy Gray, MD - Director of Clinical &amp; Scientific Strategy, VP System Strategy, COH <ul style="list-style-type: none"> <li>○ 25<sup>th</sup> Cancer Center Informatics Society Summit co-Chair</li> </ul> </li> </ul>
5:20 PM	<p><b>Closing Remarks</b></p> <ul style="list-style-type: none"> <li>• Sorena Nadaf-Rahrov, MS, MMI - Cancer Center Informatics Society</li> <li>• Warren Kibbe, PhD – National Cancer Institute</li> </ul>

# 25th Cancer Center Summit

5:30 PM

## Save the Date Announcements !

- Sarah Rose Butler, Cancer Center Informatics Society
- Fall 2026 Cancer Center Symposium Details

## Omni Hotel San Diego 4<sup>th</sup> Floor

Meeting Location: Salon AB

Exhibitor Booth Location: Salon CDE

*San Diego 4th Floor*

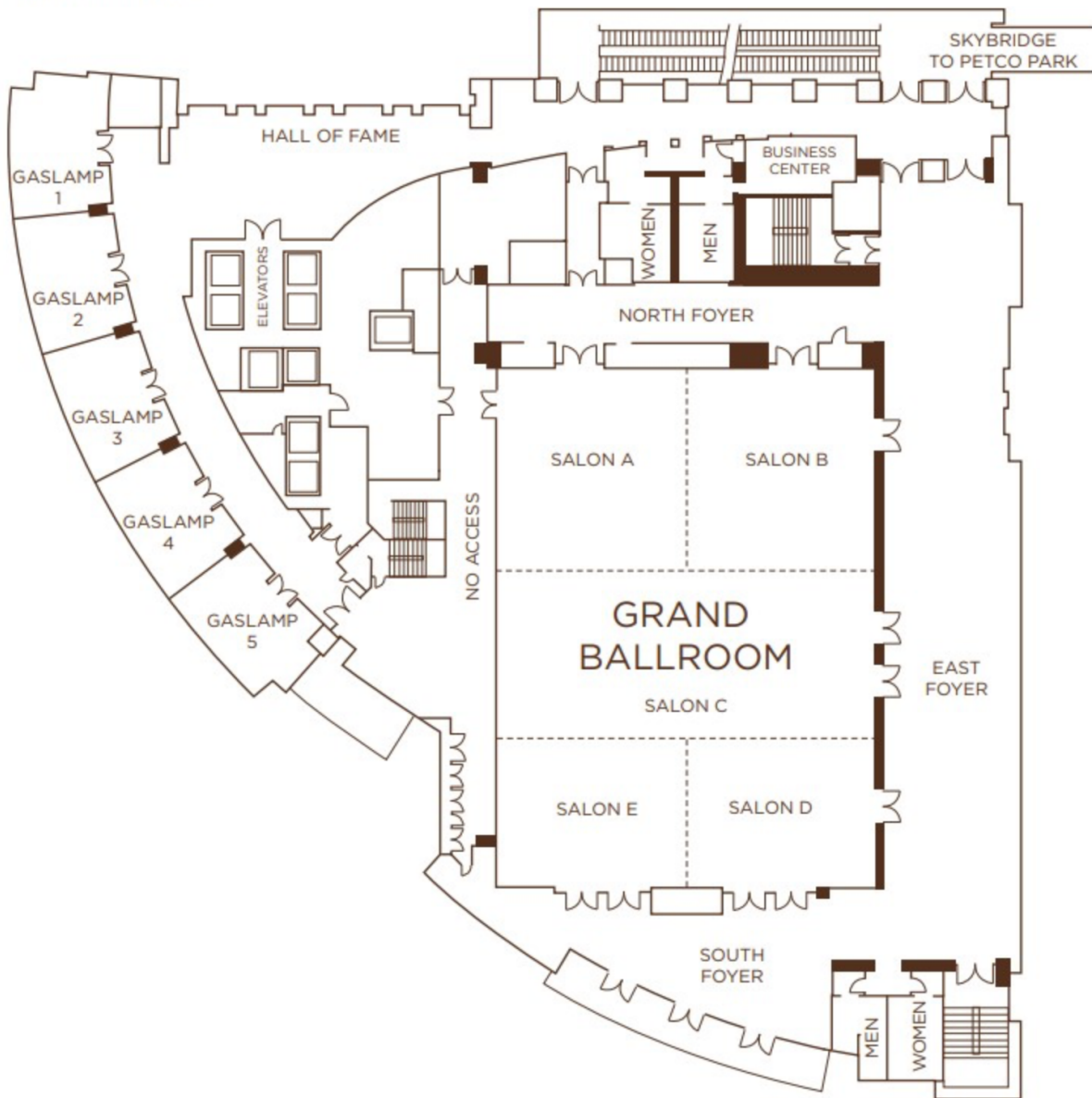

## 25th Cancer Center Summit

# Exhibitor List

<b>Booth Number</b>	<b>Organization</b>
1	Oracle
2	Natera
3	City of Hope Comprehensive Cancer Center
4	RISA Lab
5	Agile Bio
6	ThinkBio.AI
7	Emtelligent
8	Trial Library
9	Singular Genomics
10	Cirro Bio
11	Yarrow Health
12	Areti Health
13	Nuclera
14	OncoLens
15	F-U Cancer
16	Empower Hope
17	Vizlitics
18	Tempus
19	Guardant
20	Fred Hutch Comprehensive Cancer Center
21	Complete Genomics

Late Breaking Exhibitors Please Check in at Registration Desk Salon AB

# 25th Cancer Center Summit



## Hold the Dates

26<sup>th</sup> Cancer Center Symposium & Workshop  
November 6 – 8, 2026

Chaired by Sidney Kimmel & Greenebaum Comprehensive Cancer Centers

Turning data  
into knowledge,  
and knowledge  
into health

