



INDUSTRIAL SUBLEASE 28,800+/- SF

1630 SATELLITE BLVD, SUITE 560

DULUTH, GA. 30097



SPACE HIGHLIGHTS

- **Total SF: 28,800+/-**
- **Office SF: 2,779+/- SF**
- **6 Dock Doors**
- **Dock Levelers**
- **Front Load Configuration**
- **28' Clear Ceiling Height**
- **LED Motion-Activated Warehouse Lighting**
- **40' X 40' Column Spacing**
- **Remaining Term Thru: July 31, 2028**
- **Great Gwinnett Location with Easy Access to I-85, Sugarloaf, Old Peachtree Roads**

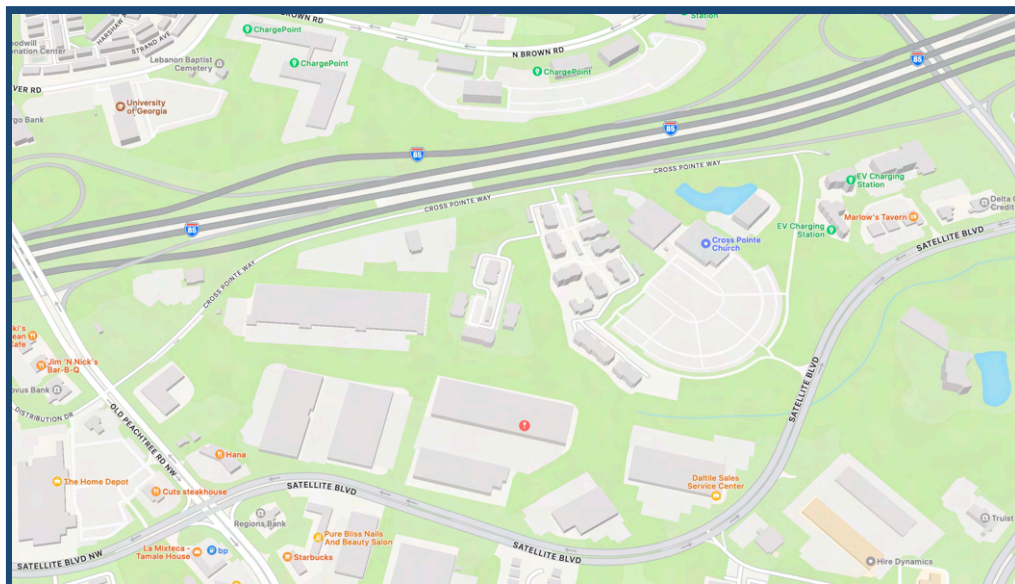

For More Information Contact:

Jeremy Dupree, SIOR

770.633.5312

jdupree@COREcommercialinc.com

www.COREcommercialinc.com

Every effort has been made to provide accurate information, but no liability is assumed for omissions and errors.

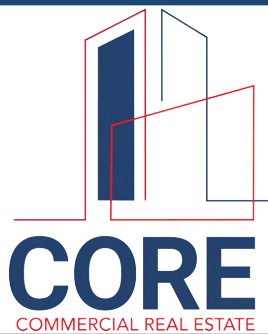

INDUSTRIAL SUBLEASE 28,800+/- SF

1630 SATELLITE BLVD, SUITE 560

DULUTH, GA. 30097



For More Information Contact:

Jeremy Dupree, SIOR

770.633.5312

jdupree@COREcommercialinc.com

www.COREcommercialinc.com

Every effort has been made to provide accurate information, but no liability is assumed for omissions and errors.



INDUSTRIAL SUBLEASE 28,800+/- SF

1630 SATELLITE BLVD, SUITE 560

DULUTH, GA. 30097

As Built Plan

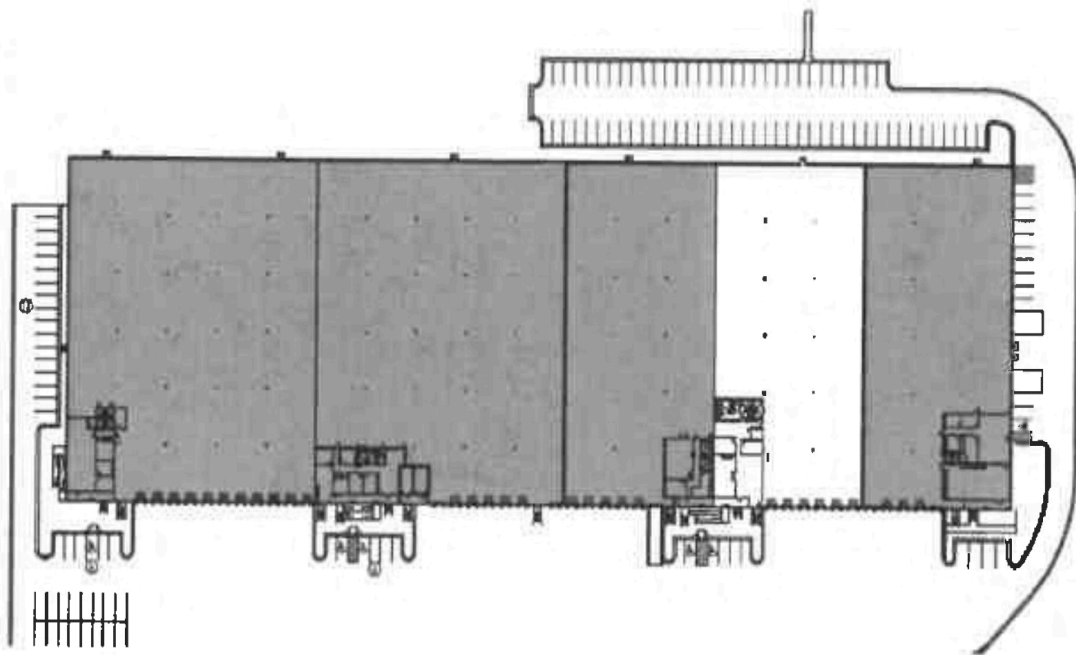
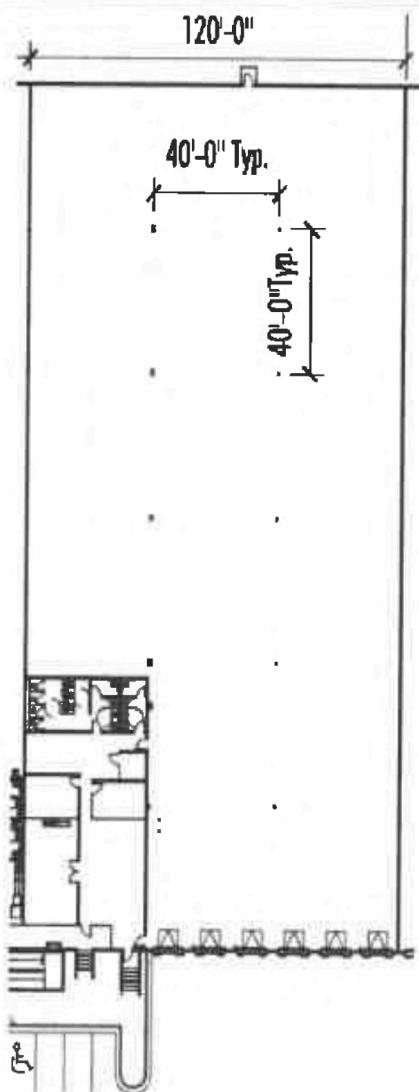

Total (Building):	182,400 SF
Total (Suite):	28,800 SF
Warehouse:	26,021 SF
Office:	2,779 SF
Dock Doors:	6

1630 Satellite Blvd

Sugarloaf Building #5 - Suite 560

NELSON

12.07.17

13080

For More Information Contact:

Jeremy Dupree, SIOR

770.633.5312

jdupree@COREcommercialinc.com

www.COREcommercialinc.com

Every effort has been made to provide accurate information, but no liability is assumed for omissions and errors.