



Installation Docs



OUR SERVICES

Marine Air Flow manufacture ventilation systems for use in both the marine industry and commercial plant & equipment rooms.

Our products are Australian made and are packaged and shipped world wide. Our easy to install systems include:

- Moisture and dust reducing air intake grilles
- AC & DC Fans
- Air Dampers
- Air-On-Demand (auto fan speed controllers)

OUR MISSION

We aim to produce quality, reliable engine room ventilation equipment for our clients, that is developed using innovative technologies & sustainable systems. We will be proud to contribute to the economic and social health of our local & global clients & community.

By continuously striving for excellence we will offer our clients long term solutions that deliver beyond expectations.

OUR STORY

Marine Air Flow International was established in 2005 with the primary purpose of engineering a product to enable better engine room operating conditions. The added advantage of promoting a safer working environment for all those working in the marine industry, and the ability to support greater environmental operational practices is also of high importance to us.

We are a business that knows first hand the problems experienced in an engine room environment and how best to combat the issue of salt and water induction into this operating space.

Our products are Australian made and are packaged and shipped world-wide from our factory on the Gold Coast, Queensland.

OUR SUSTAINABILITY

We are very proud of our how green we as a company, and how green our products are.

- Our factory is also our home so we have eliminated the dreaded daily "commute"
- We have solar power that generates more than we can use



PURPOSE:

The purpose of this document is to provide our intake separator grille installation instructions to fit your MAFI product & insure its effectiveness.

RESPONSIBILITY:

It is the owner / and or ship repairer's responsibility to correctly install the MAFI products. Any alteration or deviations should be carefully considered.

MAFI would appreciate all deviations to be referenced, made aware & noted for future reference.

TOOLS, GUAGES & FIXTURES:

The installation kit provided contains the following items:

- Coloured Silicone Sealant
- Glue-In Kit

VESSEL PREPARATION:

Confirm port and starboard orientation and dry fit the grille. NB: Pay special attention to the coverage area and also check clearances. Check that all surfaces are flat, allowing full contact.

It is critical that there is a minimum contact coverage of 90%.

Air Intake Grilles Installation Doc (Glue In)

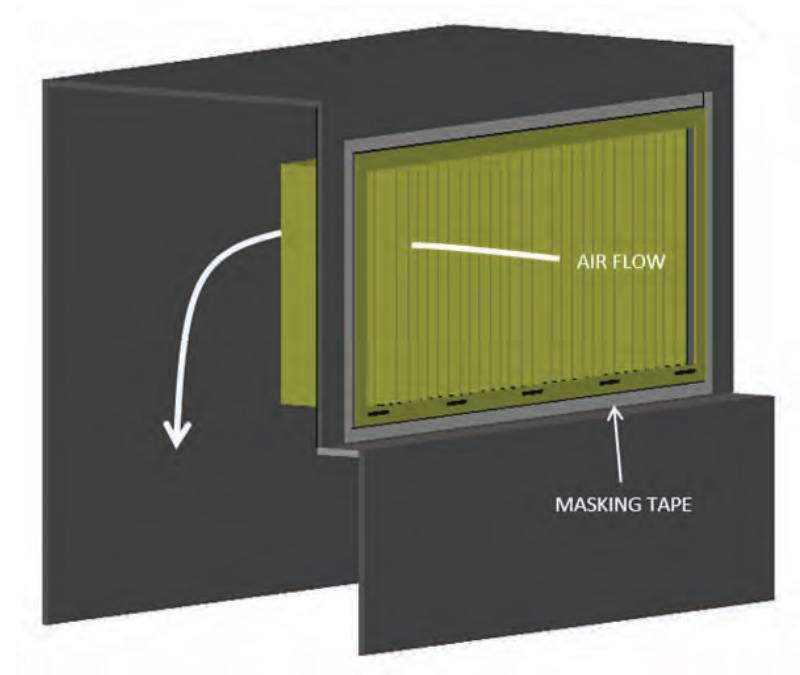
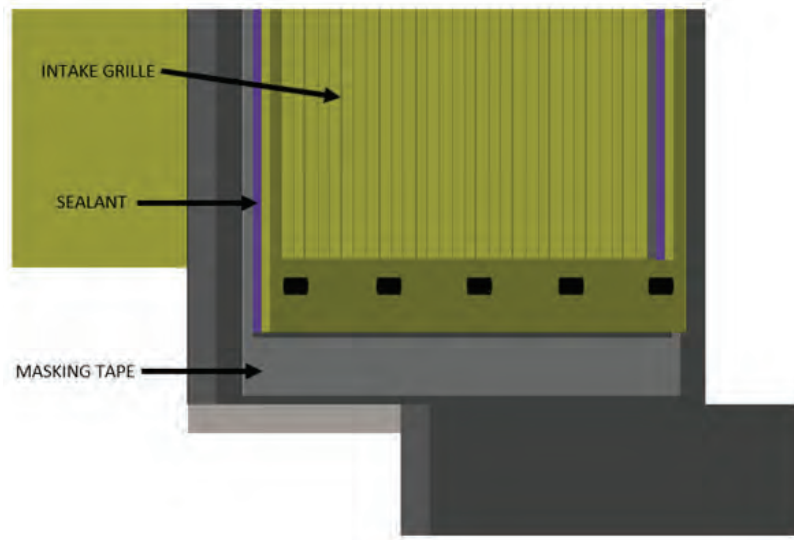
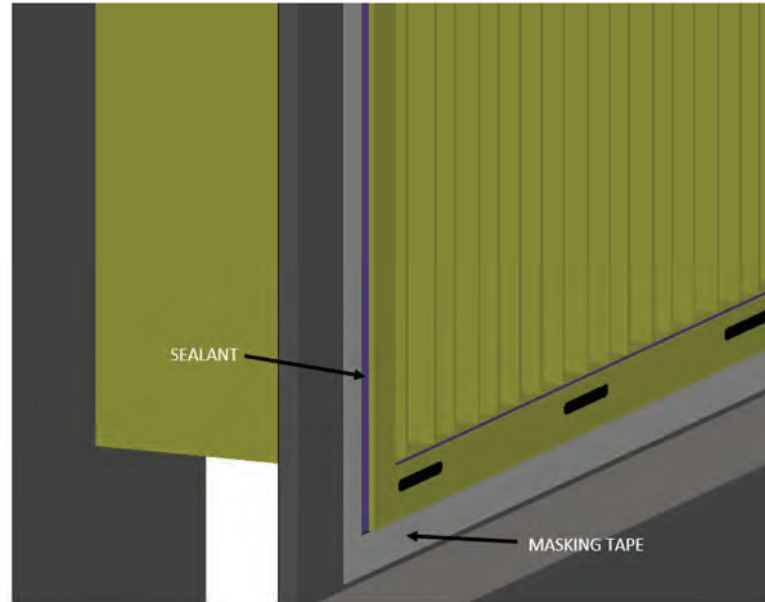



PURPOSE:

The purpose of this document is to provide our intake separator grille installation instructions to fit your MAFI product & insure its effectiveness. This installation procedure is for the screw in installation of our grilles using either M5 or M6 bolts.

RESPONSIBILITY:

It is the owner / and or ship repairer's responsibility to correctly install the MAFI products. Any alterations or deviations should be carefully considered.

MAFI would appreciate all deviations to be referenced, made aware & noted for future reference.

TOOLS, GAUGES & FIXTURES:

The installation kit provided contains the following items:

- Coloured Silicone Sealant
- Glue-in kit
- M5 drill tap kit
- Stainless steel countersunk screws

VESSEL PREPARATION:

Confirm orientation and dry fit the air damper.

NB: Pay special attention to the coverage area along with checking clearances and that all surfaces are flat, allowing full contact. It is critical that there is a minimum contact coverage of 90%.

Air Intake Grilles - M5 Countersunk Screws Installation Doc



1. Pencil mark the fixing holes while grille is in required position. Take care to ensure the coating in the pre-drilled fixing holes.
2. Mask tape around the grille perimeter +2mm all around neatly.
3. Drill and tap referenced fixing holes.
4. Scotch-brite key the hull fixing surface and clean all debris with isopropyl solution or similar.
5. Use the provided sealant between the hull surface and the mounting flange surface generously.
6. Place the grille into position.
7. Install the stainless steel countersunk screws, tensioning fasteners evenly around perimeter. NB: Do not tighten excessively.
8. After tightening the fixings, a small bead of coloured sealant will form all round. Clean excess sealant off with soapy water (dishwashing detergent mixed with water) and bog application card (supplied in kit.)
9. Remove the masking tape and ensure all excess sealant is cleaned up neatly.

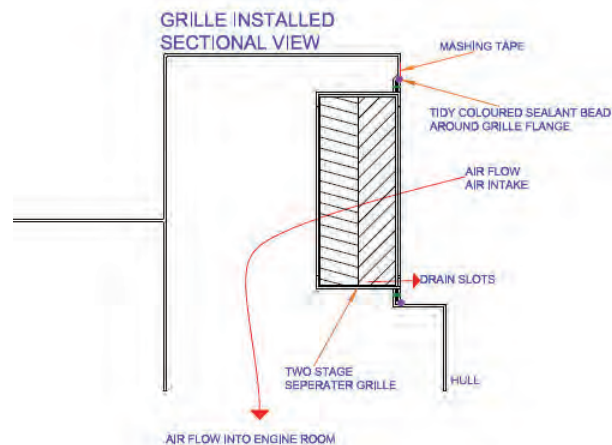



PURPOSE:

The purpose of this document is to provide our intake separator grille installation instructions to fit your MAFI product & insure its effectiveness. This installation procedure is for the screw in installation of our grilles using either M5 or M6 bolts.

RESPONSIBILITY:

It is the owner / and or ship repairer's responsibility to correctly install the MAFI products. Any alterations or deviations should be carefully considered.

MAFI would appreciate all deviations to be referenced, made aware & noted for future reference.

TOOLS, GAUGES & FIXTURES:

The installation kit provided contains the following items:

- Coloured Silicone Sealant
- Glue-in kit
- M6 drill tap kit
- Stainless steel countersunk screws

VESSEL PREPARATION:

Confirm orientation and dry fit the air damper.

NB: Pay special attention to the coverage area along with checking clearances and that all surfaces are flat, allowing full contact. It is critical that there is a minimum contact coverage of 90%.

Air Intake Grille (M6 Fasteners Installation Doc

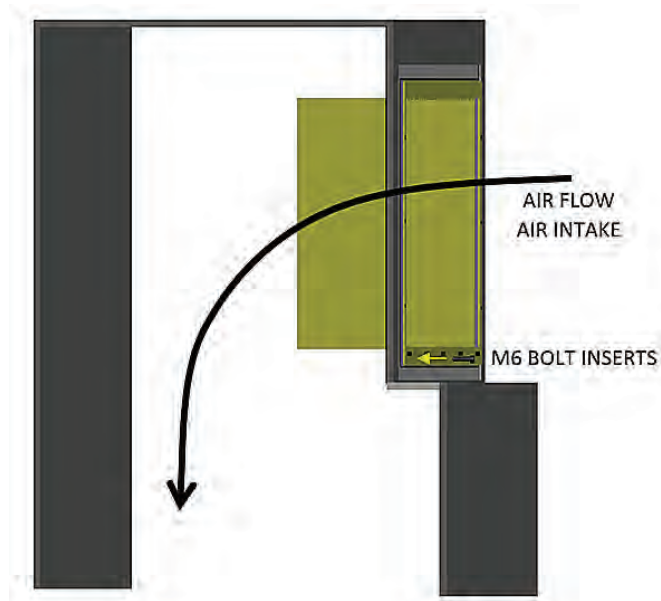
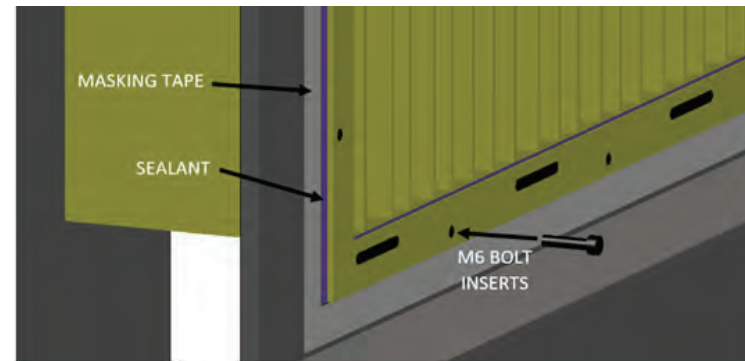
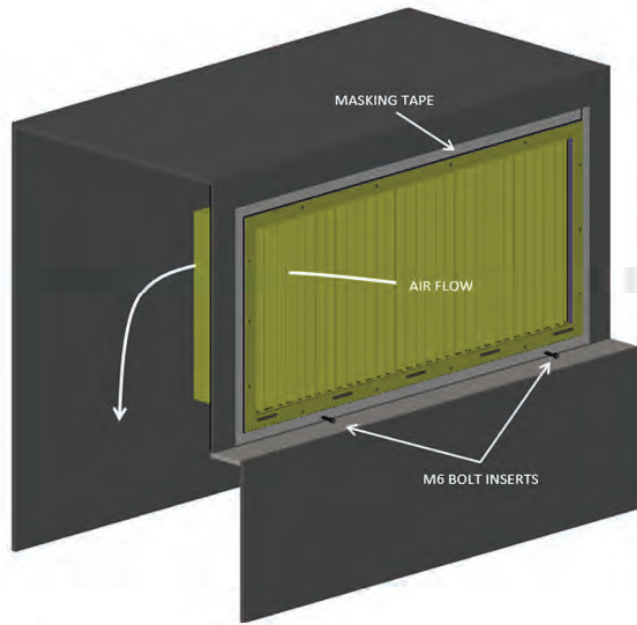



PURPOSE:

The purpose of this document is to provide our intake separator grille installation instructions to fit your MAFI product & insure its effectiveness. This installation procedure is for the screw in installation of our grilles using either M5 or M6 bolts.

RESPONSIBILITY:

It is the owner / and or ship repairer's responsibility to correctly install the MAFI products. Any alterations or deviations should be carefully considered.

MAFI would appreciate all deviations to be referenced, made aware & noted for future reference.

TOOLS, GAUGES & FIXTURES:

The installation kit provided contains the following items:

- Coloured Silicone Sealant
- Glue-in kit
- M5 drill tap kit or M6 drill tap kit
- Stainless steel countersunk screws

VESSEL PREPARATION:

Confirm orientation and dry fit the air damper.

NB: Pay special attention to the coverage area along with checking clearances and that all surfaces are flat, allowing full contact. It is critical that there is a minimum contact coverage of 90%.

Air Intake Grilles - Screw In Installation Doc



1. Pencil mark the fixing holes while grille is in required position. Take care to ensure the coating in the pre-drilled fixing holes.
2. Mask tape around the grille perimeter +2mm all around neatly.
3. Drill and tap referenced fixing holes.
4. Scotch-brite key the hull fixing surface and clean all debris with isopropyl solution or similar.
5. Use the provided sealant between the hull surface and the mounting flange surface generously.
6. Place the grille into position.
7. Install the stainless steel countersunk screws, tensioning fasteners evenly around perimeter. NB: Do not tighten excessively.
8. After tightening the fixings, a small bead of coloured sealant will form all round. Clean excess sealant off with soapy water (dishwashing detergent mixed with water) and bog application card (supplied in kit.)
9. Remove the masking tape and ensure all excess sealant is cleaned up neatly.

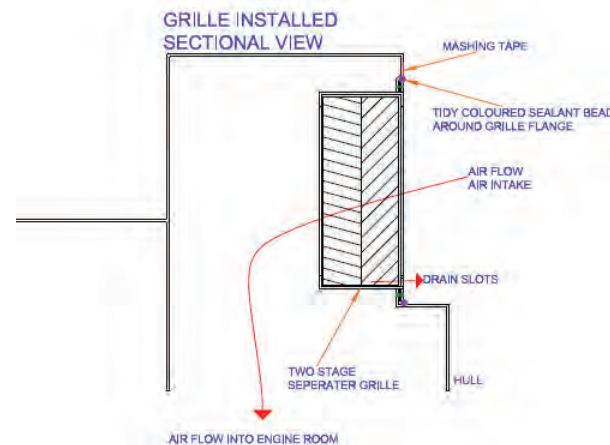



PURPOSE:

The purpose of this document is to provide our A60 air damper installation instructions so you can fit your MAFI product correctly & ensure its effectiveness.

RESPONSIBILITY:

It is the owner / and or ship repairer's responsibility to correctly install the MAFI products. Any alterations or deviations should be carefully considered.

MAFI would appreciate all deviations to be referenced, made aware & noted for future reference.

TOOLS, GUAGES & FIXTURES:

The installation kit provided contains the following items:

- Fire check Sealant
- Glue-in kit
- Air damper activation kit
- M6 stainless steel bolts
- Self-tapping stainless steel screws
- Coloured isolation bushes
- Isolation foam tape

VESSEL PREPARATION:

Confirm orientation and dry fit the air damper.

NB: Pay special attention to the coverage area along with checking clearances and that all surfaces are flat, allowing full contact. It is critical that there is a minimum contact coverage of 90%.

A60 Air Dampers Installation Doc



1. Fit adaptor plate to Control Mode and fit to mounting plate on the damper. Secure with screw & washer provided - 5Nn.
2. Select a location for the ETR on the duct as per installation notes.
 - Position the self-adhesive fusible link drilling template label provided in the appropriate position on the duct.
 - Using a 3.0mm ø bit, drill the two ETR fixing holes.
 - Using a 10mm ø drill, drill the central hole.
 - Remove sharp edges.
 - Push the ETR through the duct and ensure that both screws are used to hold it securely in position.
- 3.
4. Pencil mark the fixing holes with the supplied template in position.
5. Mask tape around the perimeter +2mm all around neatly.
6. Drill & tap referenced fixing holes for supplied bolts or pre drill holes for supplied self-tapping screws.
7. Scotch-brite key the hull fixing surface & clean all debris with isopropyl solution or similar.
8. Use the provided fire check sealant between the hull surface and the mounting flange surface generously.
9. Install the fasteners, tensioning fasteners evenly around perimeter (NB: Please check the isolation foam tape is fitted where & as per the drawing). Do not tighten excessively.
10. After tightening the fixings, a small bead of fire check sealant will form all round. Clean excess sealant off with soapy water (dishwashing deter-

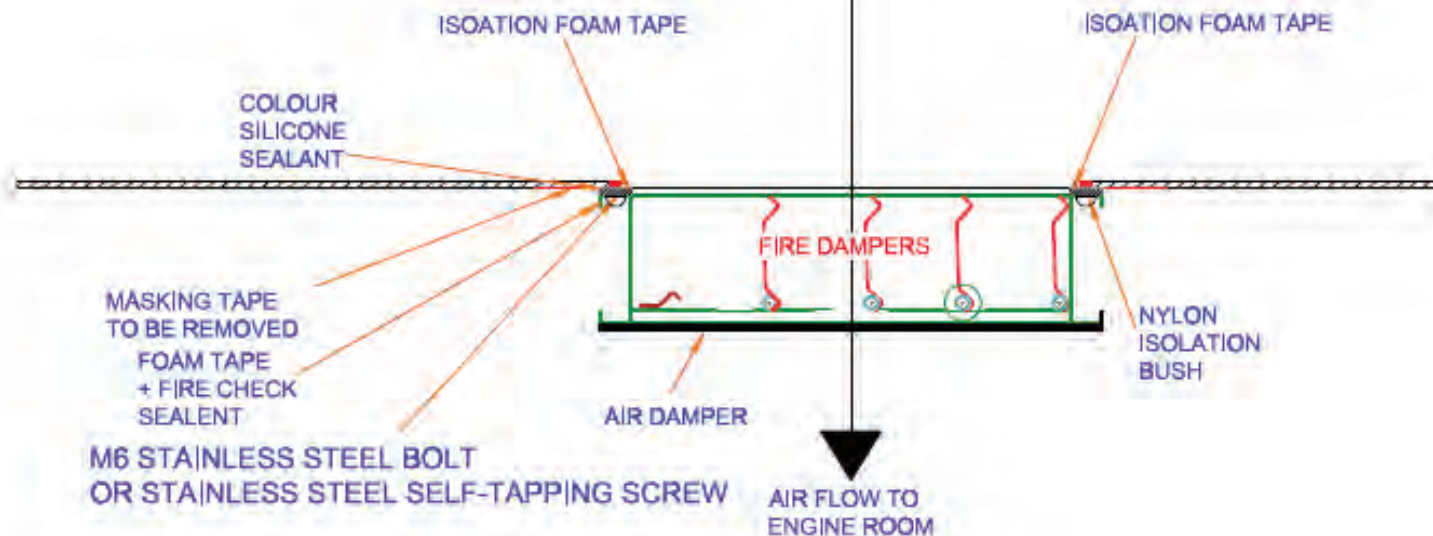

A60 Air Dampers Installation Doc



Bulkhead (Vertical)

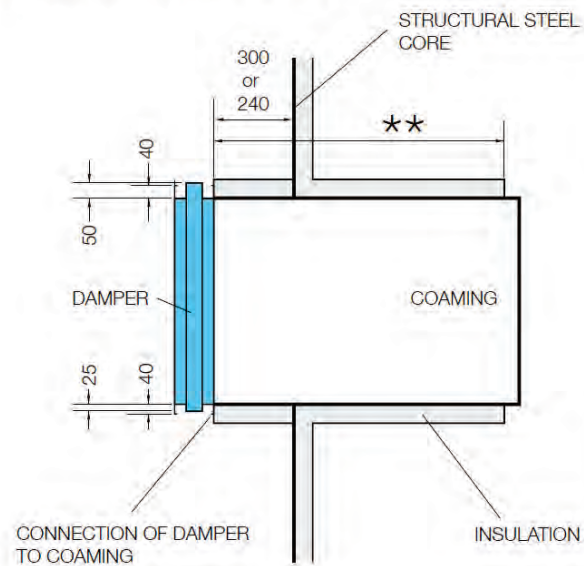

Deck (Horizontal)

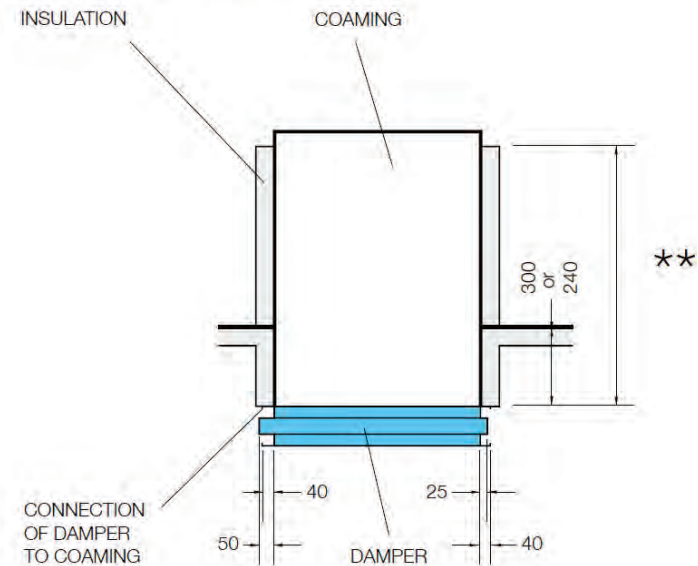



PURPOSE:

The purpose of this document is to provide our Air Damper Activation system installation instructions so you can fit your MAFI product correctly & ensure its effectiveness.

RESPONSIBILITY:

It is the owner / and or ship repairer's responsibility to correctly install the MAFI products. Any alterations or deviations should be carefully considered.

MAFI would appreciate all deviations to be referenced, made aware & noted for future reference.

TOOLS, GAUGES & FIXTURES:

The installation kit provided contains the following items:

- 1 x Activation Handle
- 25 x Stainless steel tech screw's
- 4 x radius 90 degree brackets
- 2 x straight bracket
- 1 x D-shackle crimped onto 6 meters of the Dyneema pull cord
- 1 x Keeper
- 2 x Activation Handle Crimp plugs
- 1 x Red Instruction Plate

- 1 x Engine Room Temperature Digital Sensor
- 1 x 3M VHB Surface Wipe
- 1 x Pen

The installation kit requires the following:

- Crimping Tool
- Drill

Air Damper Auto Activator Installation Doc



Selection and Installation of Manual Damper Systems

Guide to selecting the appropriate manual damper control system and subsequent setup process

This document contains instructions on:

Selecting Appropriate Manual Damper Control Set	2
Stainless Steel Manual Damper Control Set	3
Synthetic Manual Damper Control Set	3
Selecting Appropriate Handle	4
Installation Process for Spring Loaded Air Damper With T-Handle	5
Installation Process For Spring Loaded Damper With Red Handle	12
Installation Process For Manual Access Air Damper	17

Selecting Appropriate Manual Damper Control Set

At Marine Air Flow, we supply two different variations of the Manual Damper Control systems; the **Stainless Steel Manual Damper Control Set** and the **Synthetic Manual Damper Control Set**. The type of damper being used is what will dictate which is the appropriate control system to choose. The two styles of damper we have are the Spring Loaded Damper and the Manual Access Air Damper, both of which are shown below.

Spring Loaded Damper



Man Access Air Damper

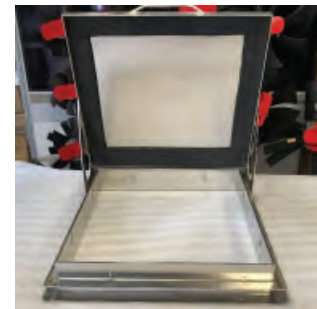

Air Damper Auto Activator Installation Doc



Selecting Appropriate Handle

The manual control systems come with the choice of 3 different types of handles, each with their own unique purpose (see figure below). It is imperative that the appropriate handle is selected as not all handle variations can be used in all the air dampers. To understand the appropriate handle for your application, consult the table below.



Handle	When It Can Be Used	When It Cannot Be Used
1: Red Handle	It is recommended for use on commercial craft utilising a Spring Loaded Air Damper larger than 490mm x 490mm. Should be used when the Stainless Steel Manual Damper Control System is used	Handle CANNOT be used in the Manual Access Air Dampers as the release mechanism will not close the damper
2: Large T-Handle	It can be used in either form of air damper that is larger than 490mm x 490mm	It is recommended not to use this handle on dampers 490mm x 490mm or smaller
3: Small T-Handle	It can be used in either form of damper 490mm x 490mm or smaller	Do not use this handle in dampers larger than 490mm x 490mm

Air Damper Auto Activator Installation Doc



4. Position the stainless steel (SS) rope jammer at required location on the boat, which is the point at which the handle will be accessed. Mount the stainless steel rope jammer using the supplied screws (note the screws in the image below may differ from the ones supplied)

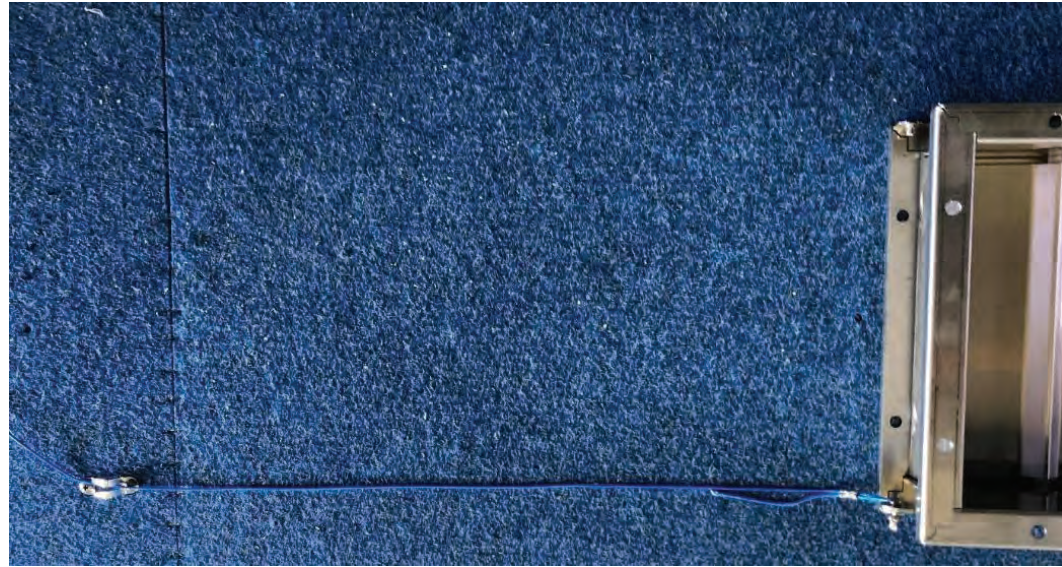
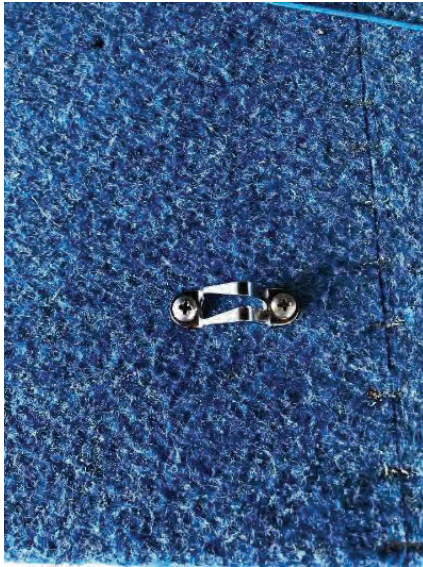

5. Remove the cap from the end of the handle using a flat head screwdriver or alternate thin-tipped tool



Air Damper Auto Activator Installation Doc

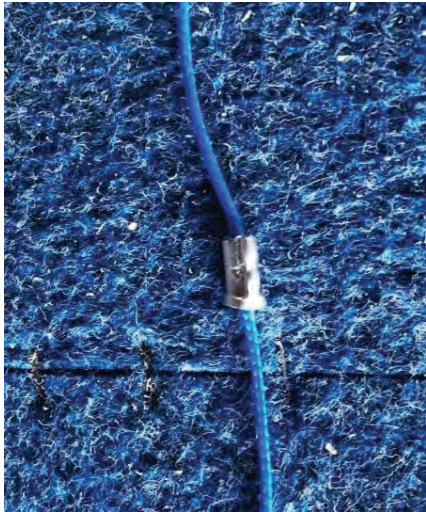

8. Release the synthetic cable/SS wire so the damper is fully closed
9. Using a crimping device, fasten the top crimp at the marked point



10. Slide the handle and bottom crimp such that the top crimp is flush inside the handle's recess and the bottom crimp is flush against the bottom of the handle

Air Damper Auto Activator Installation Doc



14. Pull and release the handle to test that the manual damper control system works as expected (damper flaps should slam shut)

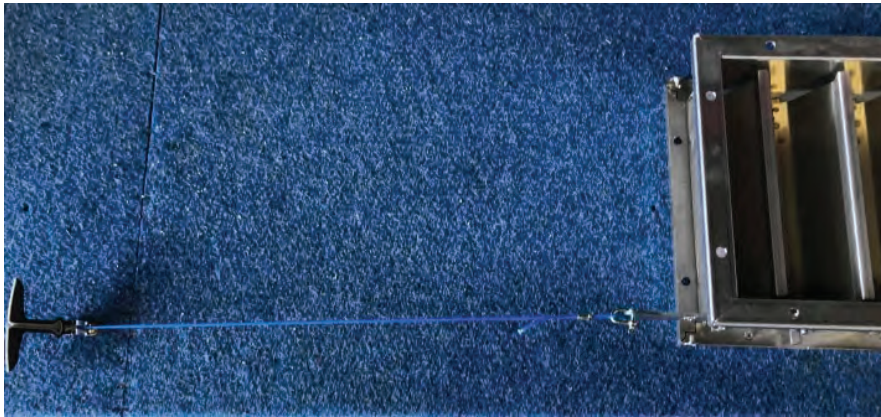

15. If the damper controller is working as expected, return handle to position stated in Step 13 and damper installation is complete

Air Damper Auto Activator Installation Doc



4. Mount the red handle at the point where it is needed using the screws provided

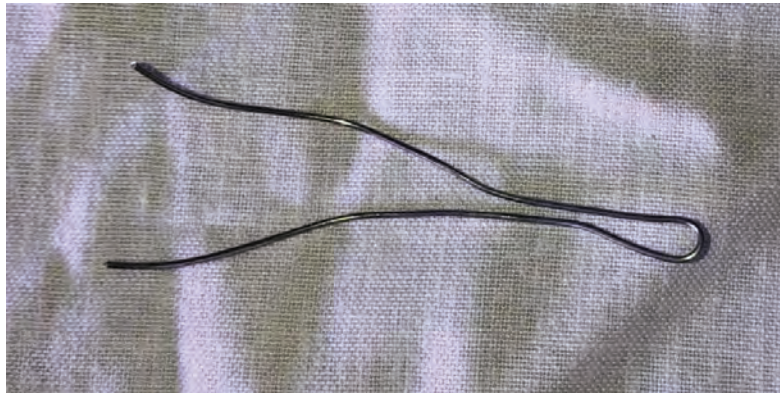

5. Using a thin piece of wire, bend it until it creates a U-shape or similar

Air Damper Auto Activator Installation Doc



11. Slip the D-shackle through loop in synthetic cable/SS wire



12. Fasten the D-shackle through the hole in the red handle. Damper flaps should be held fully open



Air Damper Auto Activator Installation Doc



Installation Process For Manual Access Air Damper

IMPORTANT: STAINLESS STEEL DAMPER CONTROL SET MUST BE USED WITH THE MANUAL ACCESS AIR DAMPER. DO NOT USE THE SYNTHETIC CONTROL SET. ADDITIONALLY, THE RED HANDLE CANNOT BE USED WITH THE MANUAL ACCESS AIR DAMPER; A T-HANDLE MUST BE USED

1. Mount Manual Access Air Damper in position
2. Attach D-shackle to the frame of the damper at the anchor point



Air Damper Auto Activator Installation Doc



7. Slide crimp and handle along the wire until they are located at the desired position. At the desired position, it is recommended that approximately 5cm worth of slack is left in the wire
8. When the handle and crimp are in position, and the appropriate slack has been left in the line, fasten the crimp using a crimping device. Cut off any excess wire



9. Slide crimp into recess of handle



Air Damper Auto Activator Installation Doc



This page is left blank intentionally.



PURPOSE:

The purpose of this document is to provide our A60 air damper installation instructions so you can fit your MAFI product correctly & ensure its effectiveness.

RESPONSIBILITY:

It is the owner / and or ship repairer's responsibility to correctly install the MAFI products. Any alterations or deviations should be carefully considered.

MAFI would appreciate all deviations to be referenced, made aware & noted for future reference.

TOOLS, GUAGES & FIXTURES:

The installation kit provided contains the following items:

- Fire check Sealant
- Glue-in kit
- Air damper activation kit
- M6 stainless steel bolts
- Self-tapping stainless steel screws
- Coloured isolation bushes
- Isolation foam tape

VESSEL PREPARATION:

Confirm orientation and dry fit the air damper.

NB: Pay special attention to the coverage area along with checking clearances and that all surfaces are flat, allowing full contact. It is critical that there is a minimum contact coverage of 90%.

A60 Air Dampers Installation Doc



1. Fit adaptor plate to Control Mode and fit to mounting plate on the damper. Secure with screw & washer provided - 5Nn.
2. Select a location for the ETR on the duct as per installation notes.
 - Position the self-adhesive fusible link drilling template label provided in the appropriate position on the duct.
 - Using a 3.0mm ø bit, drill the two ETR fixing holes.
 - Using a 10mm ø drill, drill the central hole.
 - Remove sharp edges.
 - Push the ETR through the duct and ensure that both screws are used to hold it securely in position.
- 3.
4. Pencil mark the fixing holes with the supplied template in position.
5. Mask tape around the perimeter +2mm all around neatly.
6. Drill & tap referenced fixing holes for supplied bolts or pre drill holes for supplied self-tapping screws.
7. Scotch-brite key the hull fixing surface & clean all debris with isopropyl solution or similar.
8. Use the provided fire check sealant between the hull surface and the mounting flange surface generously.
9. Install the fasteners, tensioning fasteners evenly around perimeter (NB: Please check the isolation foam tape is fitted where & as per the drawing). Do not tighten excessively.
10. After tightening the fixings, a small bead of fire check sealant will form all round. Clean excess sealant off with soapy water (dishwashing deter-

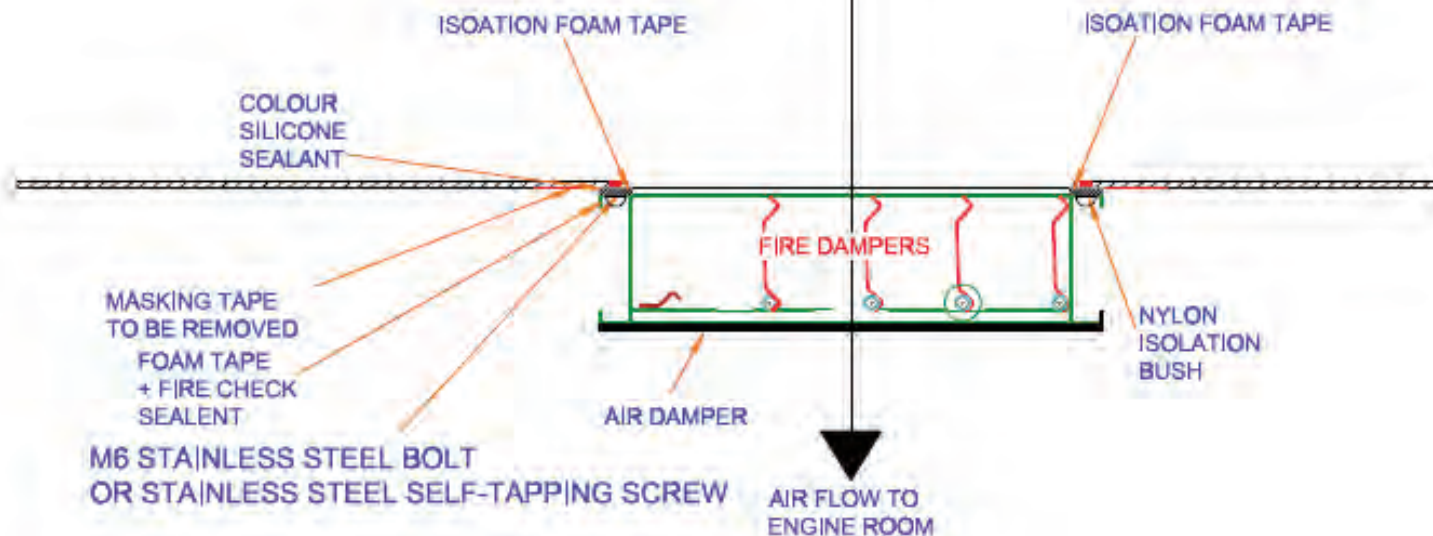

A60 Air Dampers Installation Doc



Bulkhead (Vertical)

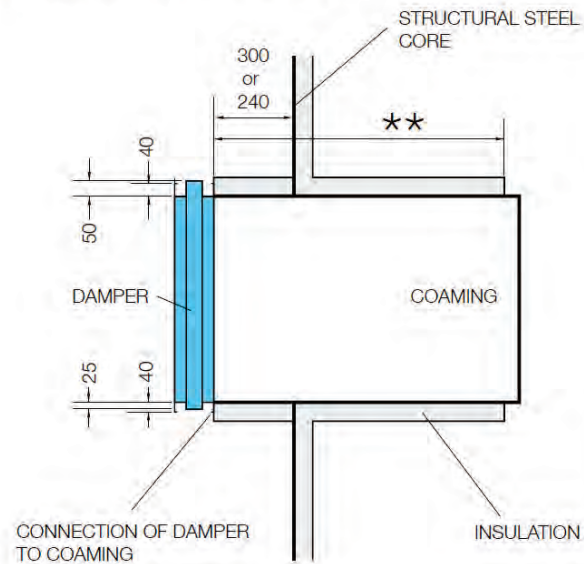

Deck (Horizontal)

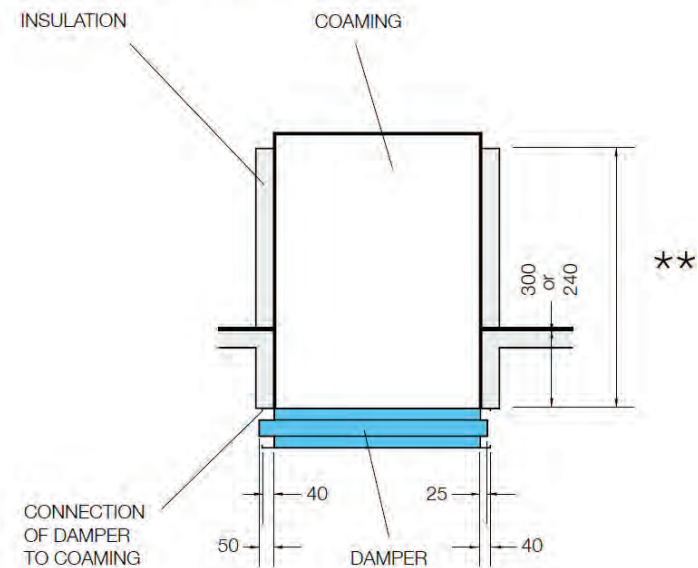



PURPOSE:

The purpose of this document is to provide our DC Inline Blower Fan installation instructions so you can fit your MAFI product correctly & ensure its effectiveness.

RESPONSIBILITY:

It is the owner / and or ship repairer's responsibility to correctly install the MAFI products. Any alterations or deviations should be carefully considered.

MAFI would appreciate all deviations to be referenced, made aware & noted for future reference.

TOOLS, GUAGES & FIXTURES:

Because of the variety of situations where our Scroll fans can be installed, no fixings are supplied with these fans. They also do not require a drill template as the fans are light weight and easy to mark drill holes while being held in position.

VESSEL PREPARATION:

Confirm orientation and dry fit the fan (refer to diagram below for guidance on flow direction)



DC Inline Blower Fan Installation Doc



INSTALLATION INSTRUCTIONS:

1. Pencil mark the holes with the fan in place.
2. Pre-drill holes ready for self-tapping screws
3. Line the fan up with the screws, insert screws and fix into place. If using a mounting bracket, mark screws positions prior to attaching the fan to the bracket for easier handling
4. Ensure all swarf and drilling debris is cleaned away
5. Connect the electrical supply and test the fan

ELECTRICAL CONNECTION AND WIRING GUIDE

CAUTION: BE CAREFUL WHEN CONNECTING AND WIRING THE FAN AND ASSOCIATED PARTS AS THERE IS A RISK OF ELECTROCUTION

Wiring the 12V/24V Scroll Fan

To wire the Scroll Fan, follow the proceeding steps carefully. Refer to diagram on the right if needed.

1. Connect the black lead extending from the scroll fan to the ground terminal of the voltage source
2. Connect the red lead extending from the scroll fan to one end of the fuse
3. Connect the positive terminal of the power supply (12V/24V) to the other end of the fuse
4. Test the circuit works

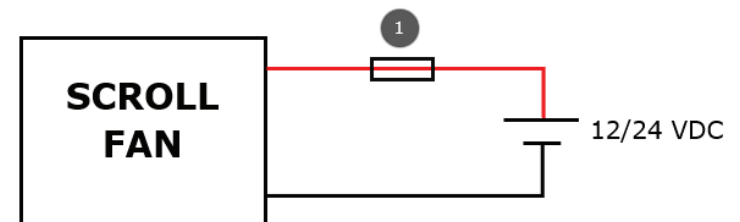

- 1 Fuse (Ensure Amp Rating Of Fuse Is Slightly Greater Than The Current Draw Of Fan)



PURPOSE:

The purpose of this document is to provide our AC High Vol Fan installation instructions so you can fit your MAFI product correctly & ensure its effectiveness.

RESPONSIBILITY:

It is the owner / and or ship repairer's responsibility to correctly install the MAFI products. Any alterations or deviations should be carefully considered. MAFI would appreciate all deviations to be referenced, made aware & noted for future reference.

WARRANTY:

For the AC high volume engine room fan to be covered under the full 3 year warranty, the vessel needs to have MAFI intake separator grilles installed to ensure the protection of the fan and engine room.

TOOLS, GUAGES & FIXTURES:

The installation kit provided contains the following items:

- Coloured Silicone Sealant
- M6 drill tap kit
- Coloured nylon isolation bushes
- M6 Stainless steel fixings
- Stainless steel metal self-tapping screws
- Isolation foam tape
- Fixing Template

VESSEL PREPARATION:

Confirm orientation and dry fit the fan.

NB: Pay special attention to the coverage area along with checking clearances and that all surfaces are flat, allowing full contact. It is critical that there is a minimum contact coverage of 90%.

AC/DC High Volume Fans Installation Doc



1. Pencil mark the fixing holes with the fixing template (if supplied) in position. Take care to ensure the coating in the pre-drilled fixing holes is not damaged.
2. Add masking tape around the fan flange perimeter creating a 2mm gap around the flange to stop the sealant spreading over the surface.
3. Drill and tap or pre drill holes ready for self-tapping screws.
4. Scotch-brite key the hull fixing surface and clean all debris with isopropyl solution or similar.
5. Scotch-brite key the fan flange fixing surface and clean all debris with isopropyl solution or similar.
6. Place the Isolation foam tape on the fan flange.
7. Apply the provided sealant between the hull surface and the mounting flange surface generously.
8. Install the M6 stainless steel bolts or stainless steel self-tapping screws with the nylon isolation bushes through the fan, tensioning fasteners evenly around perimeter. NB: Do not tighten excessively. (Please see drawings details)
9. After tightening the fixings, a small bead of coloured sealant will form all round. Clean excess sealant off with soapy water (dishwashing detergent mixed with water) and bog application card (supplied in kit).
10. Remove the masking tape and ensure all excess sealant is cleaned up neatly.

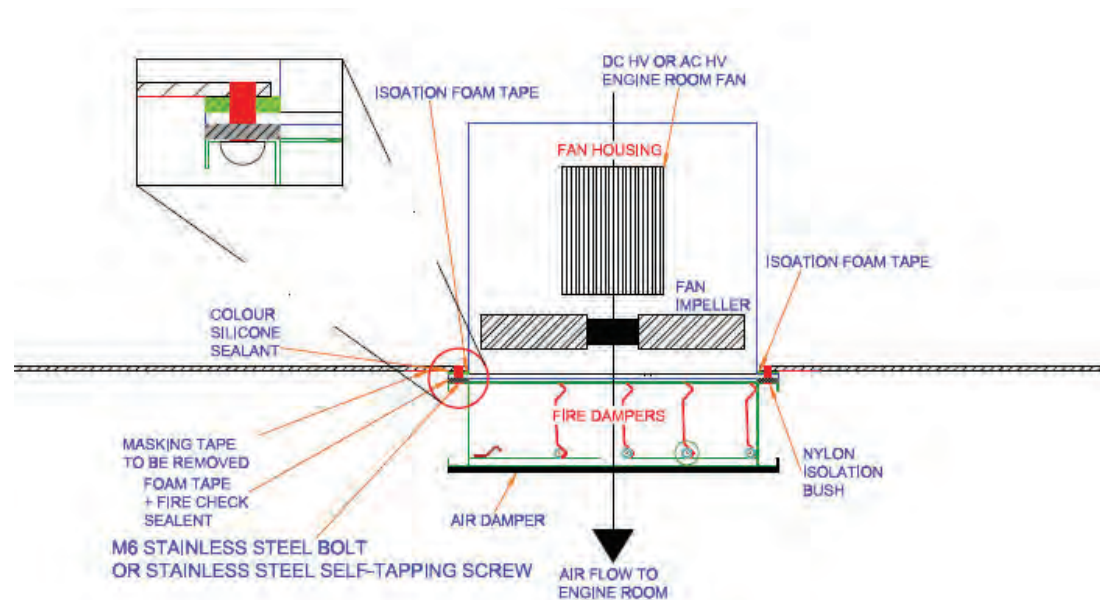



PURPOSE:

The purpose of this document is to provide our AC High Vol Fans and Damper combination installation instructions to fit your MAFI product & insure its effectiveness. **This is for A flow fans only.**

RESPONSIBILITY:

It is the owner / and or ship repairer's responsibility to correctly install the MAFI products. Any alteration or deviations should be carefully considered.

MAFI would appreciate all deviations to be referenced, made aware & noted for future reference.

WARRANTY:

For the AC high volume engine room fan to be covered under the full 3 year warranty, the vessel needs to have MAFI intake separator grilles installed to ensure the protection of the fan and engine room.

TOOLS, GUAGES & FIXTURES:

The installation kit provided contains the following items:

- Coloured Silicone Sealant
- M6 drill tap kit
- Coloured nylon isolation bushes
- M6 Stainless steel fixings
- Stainless steel metal self-tapping screws
- Isolation foam tape
- Fixing Template

VESSEL PREPARATION:

Confirm orientation and dry fit the AC high volume engine room fan.
NB: Pay special attention to the coverage area and also check clearances. Check that all surfaces are flat, allowing full contact.
It is critical that there is a minimum contact coverage of 90%.

MAFI also recommends the AC high volume engine room fan to be set as supply NOT extraction for best result with regard to the engine temperature.

AC/DC High Vol Fan & Damper Installation Doc (A Flow)



1. Pencil mark the fixing holes with the fixing template (if supplied) in position. Take care to ensure the coating in the pre-drilled fixing holes is not damaged.
2. Add masking tape around the fan flange perimeter creating a 2mm gap around the flange to stop the sealant spreading over the surface.
3. Drill and tap or pre drill holes ready for self-tapping screws.
4. Unbolt the packing bolts from air damper to AC/DC high volume engine room fan
5. Scotch-brite key the hull fixing surface and clean all debris with isopropyl solution or similar.
6. Scotch-brite key the fan flange fixing surface and clean all debris with isopropyl solution or similar.
7. Place the Isolation foam tape on the fan flange.
8. Apply the provided sealant between the hull surface and the mounting flange surface generously.
9. Install the M6 stainless steel bolts or stainless steel self-tapping screws with the nylon isolation bushes through the air damper and fan, tensioning fasteners evenly around perimeter. NB: Do not tighten excessively. (Please see drawings details)
10. After tightening the fixings, a small bead of coloured sealant will form all round. Clean excess sealant off with soapy water (dishwashing detergent mixed with water) and bog application card (supplied in kit.)
11. Remove the masking tape and ensure all excess sealant is cleaned up neatly.

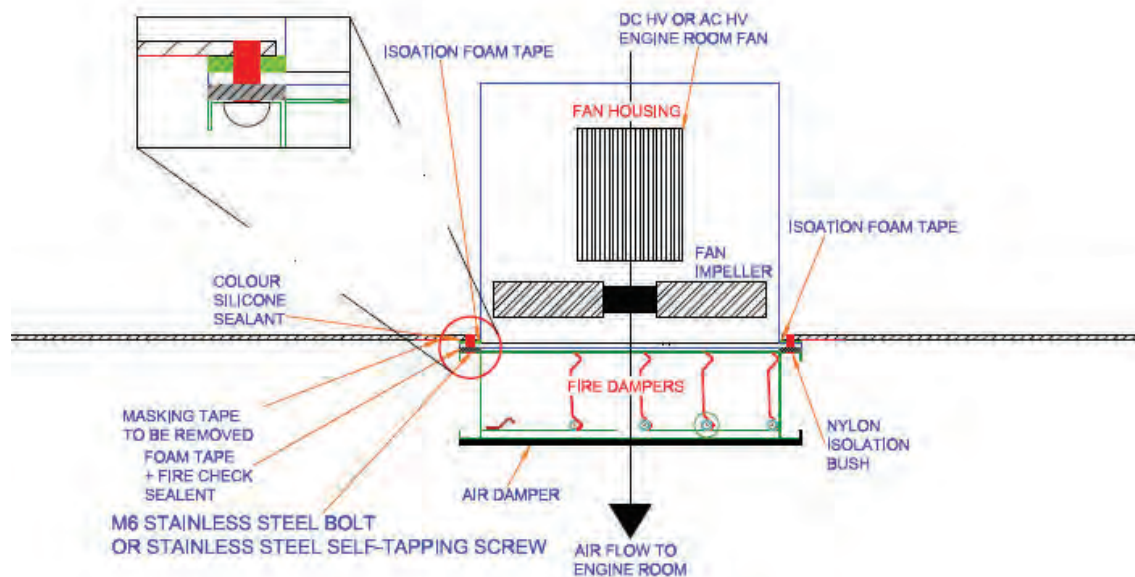

AC/DC High Vol Fan & Damper Installation Doc (A Flow)



- Ensure the cable is flat coming out of the damper as shown in picture with a spacer block
- Cut conduit and cable to length required
- Tie off pull cable to handle
- Use supplied small d shackle on damper end



- Ensure to allow sufficient clearance for the travel at full open position





PURPOSE:

The purpose of this document is to provide our AC High Vol Fans and Damper combination installation instructions to fit your MAFI product & insure its effectiveness. **This is for B flow fans only.**

RESPONSIBILITY:

It is the owner / and or ship repairer's responsibility to correctly install the MAFI products. Any alteration or deviations should be carefully considered.

MAFI would appreciate all deviations to be referenced, made aware & noted for future reference.

WARRANTY:

For the AC high volume engine room fan to be covered under the full 3 year warranty, the vessel needs to have MAFI intake separator grilles installed to ensure the protection of the fan and engine room.

TOOLS, GUAGES & FIXTURES:

The installation kit provided contains the following items:

- Coloured Silicone Sealant
- M6 drill tap kit
- Coloured nylon isolation bushes
- M6 Stainless steel fixings
- Stainless steel metal self-tapping screws
- Isolation foam tape
- Fixing Template

VESSEL PREPARATION:

Confirm orientation and dry fit the AC high volume engine room fan.
NB: Pay special attention to the coverage area and also check clearances. Check that all surfaces are flat, allowing full contact.
It is critical that there is a minimum contact coverage of 90%.

MAFI also recommends the AC high volume engine room fan to be set as supply NOT extraction for best result with regard to the engine temperature.

AC/DC High Vol Fan & Damper Installation Doc (B Flow)



1. Pencil mark the fixing holes with the fixing template in position. Take care to ensure the coating in the pre-drilled fixing holes is not damaged.
2. Add masking tape around the fan flange perimeter creating a 2mm gap around the flange to stop the sealant spreading over the surface.
3. Drill and tap or pre drill holes ready for self-tapping screws.
4. Scotch-brite key the hull fixing surface and clean all debris with isopropyl solution or similar.
5. Scotch-brite key the fan flange fixing surface and clean all debris with isopropyl solution or similar.
6. Place the Isolation foam tape on the fan flange.
7. Apply the provided sealant between the hull surface and the mounting flange surface generously.
8. Install the M6 stainless steel bolts or stainless steel self-tapping screws with the nylon isolation bushes through the air damper and fan, tensioning fasteners evenly around perimeter. NB: Do not tighten excessively. (Please see drawings details)
9. After tightening the fixings, a small bead of coloured sealant will form all round. Clean excess sealant off with soapy water (dishwashing detergent mixed with water) and bog application card (supplied in kit.)
10. Remove the masking tape and ensure all excess sealant is cleaned up neatly.

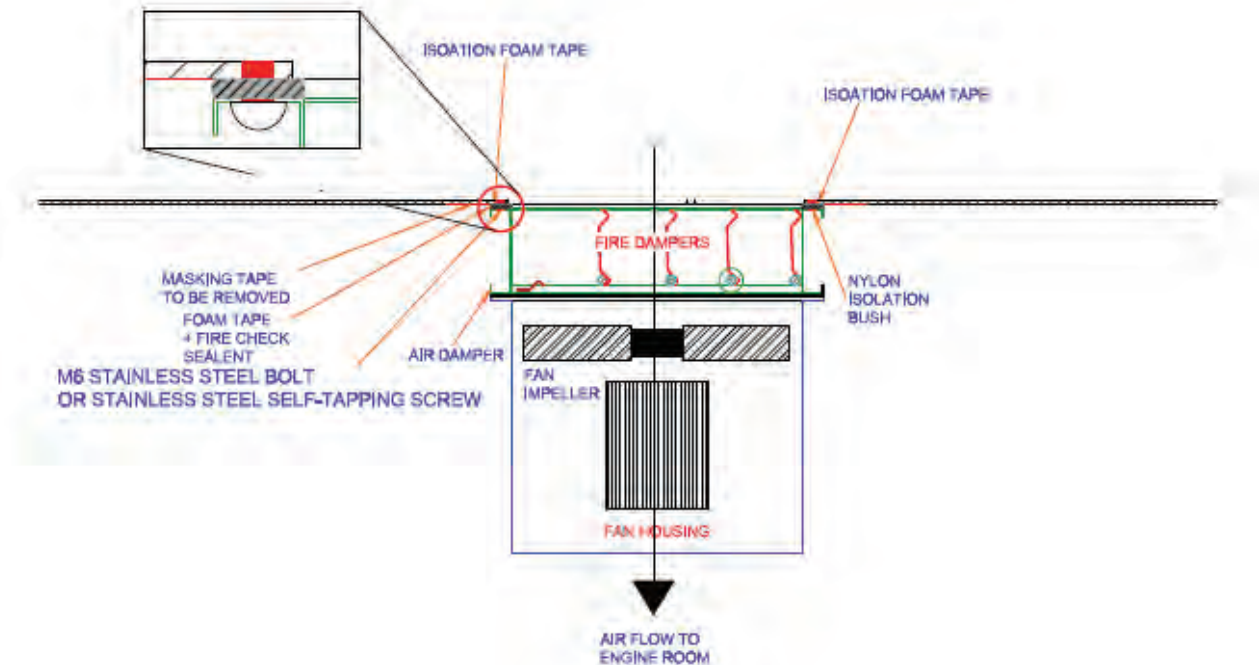

AC/DC High Vol Fan & Damper Installation Doc (B Flow)



- Ensure the cable is flat coming out of the damper as shown in picture with a spacer block
- Cut conduit and cable to length required
- Tie off pull cable to handle
- Use supplied small d shackle on damper end



- Ensure to allow sufficient clearance for the travel at full open position



**PURPOSE:**

The purpose of this document is to provide our Compact Fan installation instructions so you can fit your MAFI product correctly & ensure its effectiveness.

RESPONSIBILITY:

It is the owner / and or ship repairer's responsibility to correctly install the MAFI products. Any alterations or deviations should be carefully considered. MAFI would appreciate all deviations to be referenced, made aware & noted for future reference.

WARRANTY:

For the Compact engine room fan to be covered under the full 3 year warranty, the vessel needs to have MAFI intake separator grilles installed to ensure the protection of the fan and engine room.

TOOLS, GUAGES & FIXTURES:

Because of the variety of situations where our Compact Fans can be installed, no fixings are supplied with these fans.

They also do not require a drill template as the fans are light weight and easy to mark drill holes while being held in position.

VESSEL PREPARATION:

Confirm orientation and dry fit the fan.

NB: Pay special attention to the coverage area along with checking clearances and that all surfaces are flat, allowing full contact.

Compact Fan Installation Doc



1. Pencil mark the fixing holes with the fan in place
2. Pre drill holes ready for self-tapping screws
3. Line the fan up with the screws and insert screws and fix into place. If you are using a mounting bracket, mark the screw positions prior to attaching the fan to the bracket for easier handling.
4. Ensure that all swarf and drilling debri is cleaned away
5. Connect the electrical supply and test the fan

Fan Size	9 Inch	12 Inch
Air Vol	250 L/sec	700 L/sec
12 Volt	8 amps	19 amps
24 Volt	4 amps	9 amps

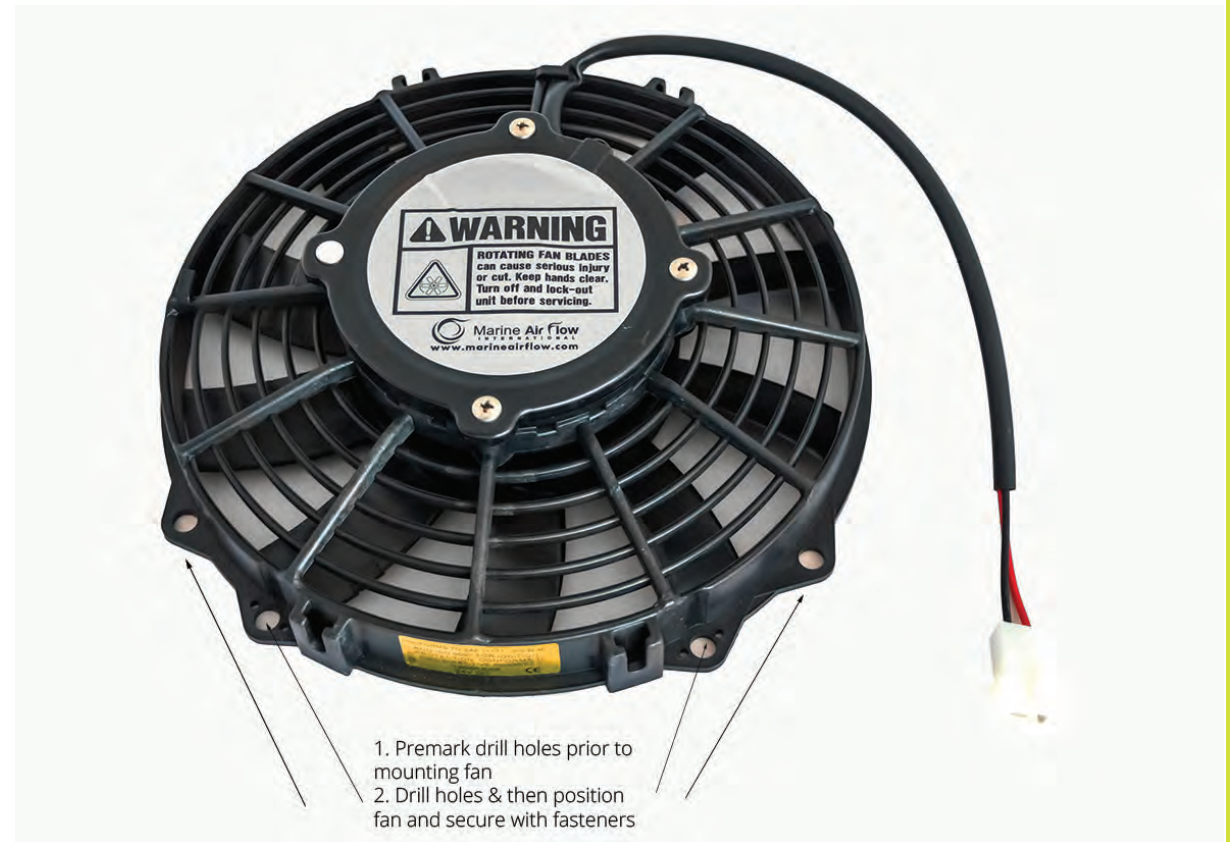



PURPOSE:

The purpose of this document is to provide our Void Area Ventilation System installation instructions so you can fit your MAFI product correctly & ensure its effectiveness.

RESPONSIBILITY:

It is the owner / and or ship repairer's responsibility to correctly install the MAFI products. Any alterations or deviations should be carefully considered.

MAFI would appreciate all deviations to be referenced, made aware & noted for future reference.

TOOLS, GUAGES & FIXTURES:

The installation kit provided contains the following items:

- Template
- Sealant
- M6 stainless steel fixings
- M6 drill and tap kit
- Foam gaskets
- Duct tape

VESSEL PREPARATION:

Please ensure you have the appropriate hole saws (or cutting system) to create the holes required for the deck pipes.

Confirm orientation and dry fit the void ventilation system before applying any sealant.



CONTACT

Should you run into any challenges during your installation, please don't hesitate to contact us using the options below.

Mark: +61 428 301 700

Brad: +61 400 714 803

office@marineairflow.com

info@marineairflow.com

Our Factory Hours are below, however if you call outside these hours please leave a message that its an installation challenge and we will return your call as a priority.

OUR MISSION

We aim to produce quality, reliable engine room ventilation equipment for our clients, that is developed using innovative technologies & sustainable systems. We are proud to contribute to the economic and social health of our local & global clients & community.

By continuously striving for excellence we will offer our clients long term solutions that deliver beyond expectations.

FACTORY HOURS:

**Monday thru Thursday 6am to 4:30pm
(Aust Eastern Standard Time)**