



# DIESEL PNEUMATIC FORKLIFTS

13,500-20,000 LB. CAPACITY: D60S-9 | D70S-9 | D80S-9 | D90S-9



# PRODUCT FEATURES OVERVIEW

# POWERFUL PERFORMANCE

Meet the new Bobcat 9 Series diesel lift trucks! Building upon Bobcat's tradition of delivering powerful performance, these trucks offer the best possible value to performance ratio. The D-9's provide increased productivity, improved comfort, and some of the lowest overall costs of ownership of any competitive forklifts on the market.

## SUPERB ERGONOMICS

- Seat-Side Hydraulic Levers & Control Switches
- Low Effort Foot Pedal
- High Comfort Full Suspension Seat
- Telescopic and Tilting Steering Column
- Increased Headroom
- Recessed Tilt Cylinders
- Full Color LCD Display
- Convenience Tray
- Ultra Quiet Hi-Viz Cab (Option)
- Full Automatic Temperature Control System (Cab Option)

## MODERN SAFETY FEATURES

- Guardian Stability System (GSS)
- Operator Sensing System (OSS)
- Superior Visibility through these improvements:
  - Optimized Mast Design
  - Lowered Dashboard
  - Redesigned Overhead Guard (Bar Type)
  - Redesigned Cabin Layout
- Easy Entry/Exit
- Electronic Parking Brake (EPB)
- Hi-Viz Orange Seat Belt
- Programmable Speed Limit (Forward & Reverse)
- Auto Deceleration
- Large Rearview Mirror
- Panoramic Mirror
- Siren & Microphone (Option)
- Rear View Camera and Proximity Sensor (Option)



## TIRELESS PRODUCTIVITY & RELIABILITY

- Powerful 3.4L Bobcat Diesel Engines
  - (55kW D60/70 or 81kW All Models)
- Quiet Running Tier-4 Final Diesel Engine
- Three Performance Modes (ECO/STD/High)
- Enhanced Cooling Capacity
- IP67 Rated Dust/Waterproof Connectors
- Full Floating Type Cabin
- 3-Speed Auto-Shift Transmission
- Electronic Inching
- LED Combination Lamps
- Weight Scale (Hydraulic/Load Cell) – Option
- Manual Tilt w/ Optional Power Tilt (OHG/Cabin)
- Vehicle Control Unit (VCU)
- Shift ProTek Hot Shift Protection
- Mast Angle Indicator

## SMART VCU FUNCTIONS (VEHICLE CONTROL UNIT)

- Guardian Stability System
- Operator Sensing System
- Mast Interlock
- Inching Pedal
- Seatbelt Alarm
- Empty Seat Alarm
- Water in Fuel Alarm
- Parking Brake Control
- Shift ProTek (Forward/Reverse) Shift Control
- Autoshift
- Speed Limit
- Mast Angle Indicator
- Load Weight Indicator
- Auto Tilt Fork Leveling
- Multi-performance Mode Indicator
- On Demand Hydraulic (Idle-Up RPMs)
- Digital Display Functions
- Planned Maintenance Reminder

\* List includes both standard and optional features

## LOWER TOTAL COST OF OWNERSHIP (TCO)

- Oil-Cooled Disc Brakes (OCDB) - 5-Year/10,000 hrs.
- Extended Planned Maintenance Intervals
  - Transmission Oil: Now 2,000 hrs.
  - Drive Axle Oil: Now 1,000 hrs.
  - Engine Oil: Now 1,000 hrs.
- 50° Wide Opening Engine Compartment
- Dual Element Air Cleaner
- Tool Free Access Panels
- Easy Diagnostics
- Quick Accessibility to Maintenance Points
- Automatic Service Notification
- Low Maintenance Engine

## OPTIONAL FEATURES

- Modular Cabin
- Newly Redesigned Hi-Viz Cabin
- Superior Climate Control, 2 in 1 Air Conditioner
- Tankless Air Compressor
- Industry-specific Application Packages
  - Anti-Dust Package
  - Anti-Corrosion Package
  - Foundry Package



# SUPERB ERGONOMICS

## FORM & FUNCTION

Equipped with all the necessary comforts, such as more operator leg room, full suspension seating, and infinitely adjustable steering column, these trucks keep the operator comfortable and in complete control, improving productivity and reducing stress and fatigue.



### NEWLY REDESIGNED FULL CABIN (OPTION)

The Bobcat cabin provides the operator additional protection against harsher environments and the ergonomic layout improves productivity at the same time. Sealed cabin eliminates outside dust, and the dual filter system quickly purifies the air.



### EXCELLENT OPERATOR VISIBILITY

The high-rigidity polycarbonate curved glass cabin provides enhanced safety and peace of mind for the operator while also enhancing overall visibility with a raised load.



### DECREASED NOISE LEVEL

Premium-grade sound-absorbing and sound insulation materials are applied to the entire cockpit. Connections to the exterior are well sealed and the thick fitted floor mat all combine to ensure a best-in-class quiet interior space.



### 7" MULTIFUNCTIONAL DISPLAY WITH ADJUSTABLE BRIGHTNESS SETTINGS

The bright 7" multi-function display provides excellent visibility of system status and settings. Features such as PIN code settings, speed limit settings, rear view camera, weight scale, and normal wear replacement cycles can all be monitored within the display.

# BEST IN CLASS

## OPERATOR COMFORT



### FULLY ADJUSTABLE OPERATOR SPACE

The steering column, suspension seat, armrest, and headrest are all adjustable to accommodate the individual preferences of each operator.



### CENTRALIZED SWITCHES

All operation switches are arranged in a single place, enhancing operator access. Additionally, a push-button style keypad greatly adds to convenience. A power jack and USB port are provided as standard features.

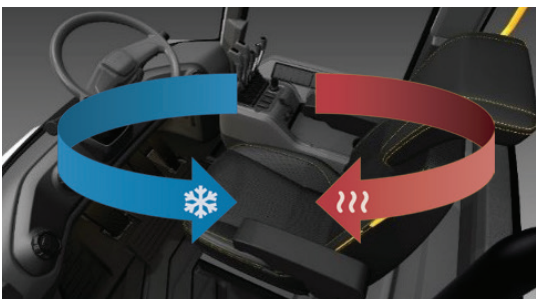

### COMFORTABLE 2-IN-1 AIR CONDITIONING SYSTEM

This system offers integrated control of heating, cooling and ventilation. Dual cabin air filters assure the operator that dust and dirty air will be cleaned quickly and efficiently.

# POWERFUL PERFORMANCE



## BOBCAT'S POWERFUL 3.4L CLEAN DIESEL ENGINES

- Bosch 1,800 bar common rail fuel injectors for reliable performance and excellent fuel economy
- ULCF Technology assures improved combustion through optimization of the piston bowl and injector nozzles
- Higher performance and less fuel consumption
- Conforms to Tier 4 final regulations
  - Automatic DPF regeneration
  - PM reduced by 40%
  - NOx reduced by 98%
- Increased engine torque in the low-to-medium range
  - 74.3hp-243.4 ft-lbs @ 1400 rpm (DM03P engine)
  - 108.5hp-339 ft-lbs @ 1400 rpm (DM03PA engine)



## ELECTRONICALLY CONTROLLED 3-SPEED AUTO-SHIFT TRANSMISSION

A control valve mounted on top of the transmission precisely modulates clutch oil pressure for smooth forward and reverse directional changes.

- A quality product by ZF – a brand trusted worldwide
- Fuel economy improves while driving long distances or working long hours
- Optimized power matching of the engine with the transmission
- Excellent engine responsiveness and powerful performance
- Efficient maintenance through the self-diagnosis system

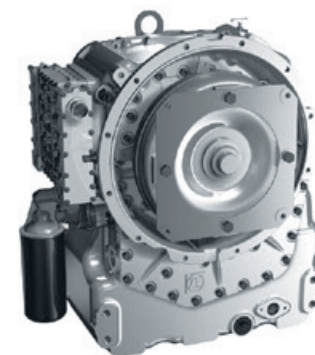

## STRONG AND DURABLE DRIVE AXLE

Bobcat's drive axle design is one of the most substantially built in the industry. Combined with Bobcat's industry leading Oil Cooled Disc Brakes, both drive axle and disc brakes offer long service life, with minimal maintenance costs.

## LOWER TOTAL COST OF OWNERSHIP (TCO)

- Maintenance-free engine valve clearance
- Auto-tensioner belt drive system
- Fewer planned maintenance intervals
- Self-diagnostics system for effective servicing

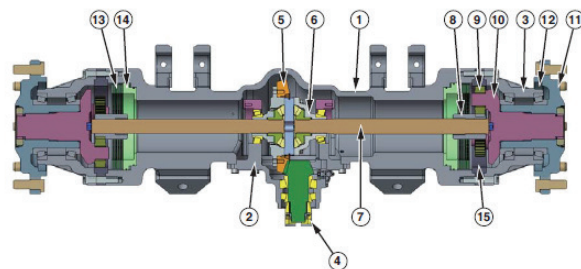

- |                   |                   |                  |
|-------------------|-------------------|------------------|
| 1. Axle Housing   | 6. Differential   | 11. Hub          |
| 2. Carrier Base   | 7. Axle Shaft     | 12. Oil Seal     |
| 3. Hub Housing    | 8. Sun Gear       | 13. Brake Discs  |
| 4. U-joint Flange | 9. Planetary Gear | 14. Brake Piston |
| 5. Bevel Gear Set | 10. Carrier Shaft | 15. Ring Gear    |

# OUTSTANDING

## PRODUCTIVITY

### PRE-PROGRAMMED PERFORMANCE MODES

Multi-Performance Mode allows operators to change parameters to meet application demands, while still delivering robust performance and excellent fuel efficiency.

- 'E' ECO Mode – Designed for fuel economy
- 'S' Standard Mode – For normal output
- 'H' High Performance Mode – Increases the power output of the truck for tough work applications



### INTEGRATED COOLING SYSTEM

The combination of a large capacity radiator and the structural design of the counterweight maximizes airflow and enhances heat dissipation. This new configuration improves the durability of the truck, particularly in challenging applications.

### OIL-COOLED DISC BRAKES (OCDB)

#### 5-YEAR, 10,000 HR. WARRANTY

- Eliminate costly brake jobs and save thousands of dollars over the lifetime of the truck
- Brake discs operate in oil to reduce heat and limit wear
- Increased braking surface with superior stopping power
- Sealed system for maximum protection against contamination

### DUAL ELEMENT CYCLONE AIR CLEANER

The efficient dual air cleaner protects the engine from contamination, prolongs the life of the engine and extends service intervals. Air intake on the overhead guard helps draw fresh, clean air into the engine.

### IP67 RATED CONNECTORS

Bobcat's 9 Series brings a new level of outdoor protection with IP67 Rated electrical connectors.

The wiring and connectors of the electrical system offer:

- Complete protection against ingress of dust and airborne particles
- Protection against water and liquids, up to and including immersion in up to 3.3 feet of water for up to 30 minutes

### AUTO THROTTLE UP

Automatically increases lift power (engine rpm) when sensors detect a load increase on the hydraulic system.

### WORKING CONVENIENCE

- Auto-Tilt leveling (Optional)
- Cluster displays mast angle, vehicle gradient & tire position

### NEWLY DESIGNED INCHING PEDAL

By eliminating the inching cable and routing the inching brakes through the TCU (Transmission Control Unit), operators have a much more controllable inching system, requiring less effort.

### INCREASED VISIBILITY THROUGH MAST

The 9 Series diesel forklifts hydraulic hoses and mast chains are neatly arranged for wide front visibility, crucial for effective operation and safety.



# ADVANCED SAFETY

## FEATURES

The 9 Series Diesel forklifts have advanced safety systems in place to protect your most valuable asset, your people. With our GSS and OSS systems safeguarding your operators, with Bobcat, you have peace of mind.



### GUARDIAN STABILITY SYSTEM (GSS)

The Guardian Stability System (GSS) will dynamically protect the operator and the load to reduce risks. Features include:

- Auto speed control when sensors indicate a sharp turn
- Decreased travel speed (50%) when mast is raised above primary stage
- Forward tilt reduced to 2° when mast is raised above primary stage
- Alarm sounds when mast is raised above primary stage with mast tilted more than 2°

### REAR DETECTION SYSTEM (OPTIONAL)

Safety alarm is triggered when a pedestrian or object comes within the sensor range, enhancing operational awareness.

### AUTOMATIC DECELERATION

When the accelerator pedal is fully released while driving, the truck automatically decelerates quickly and safely, reducing braking distance by up to 50%. This feature is fully adjustable through the cluster.

### FRONT AND REAR VIEW CAMERA W/ MONITOR (OPTIONAL)

Optional front and rear view cameras keep blind spots to a minimum, providing another level of safety and peace of mind.

### OPERATOR SENSING SYSTEM – (OSS)

Should the operator leave the seat, the OSS automatically prohibits operations such as:

- Truck movement forward or reverse

Mastlift, lower, and tilt functions while engaging:

- The electronic parking brake
- Seatbelt warning alarm reminding the operator to fasten the seatbelt

### MODERN SAFETY FEATURES

- Guardian Stability System (GSS)
- Operator Sensing System (OSS)
- Visibility Improved by 40%
  - Optimized Mast Design
  - Lower Dashboard
  - Redesigned Cabin Layout
- Safe Entry & Exit System
- Electronic Parking Brake (EPB)
- Shift ProTek Hot Shift Protection
- Safety Orange Seat Belt
- Seat Belt Safety Switch
- Travel Speed Controls (Forward & Reverse)
- Auto Deceleration
- Large Rearview Mirror
- Rear View Mirrors, Left & Right
- Panoramic Mirror
- Front and Rear View Camera (Option)
- Siren & Microphone (Option)
- Weight Load Indicator (Hydraulic/Load Cell) (Option)
- 4th Lever Interlocking for Clamp Attachment. (Option)
- Seat Belt Interlock (Option)

### TRANSMISSION EMBEDDED PARK BRAKE

- Built-in parking brake in transmission
- Parking brake is released by parking switch
- No parking lever or cable adjustment required
- Smart Braking System automatically engages when the ignition is switched off or the operator leaves the seat



# VERSATILE

## FLEXIBLE

### ANTI-DUST PACKAGE

This package prevents overheating due to dust buildup on the forklift. Preferred option for tough applications such as: Lumber & Stone, Steel, Ceramic Tile, Solid Fertilizer, Cotton and Recycling.

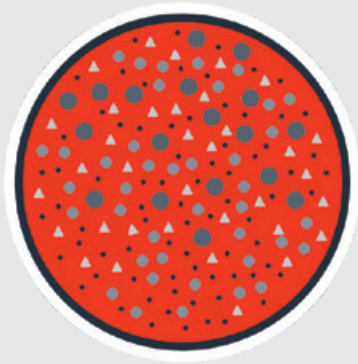

### FOUNDRY PACKAGE

Recommended for customers who mainly operate trucks in high temperature environments such as: Foundry (Iron, Aluminum, or Nonferrous Metals), Casting or Forging and Rolling.



### ANTI-CORROSION PACKAGE

Designed for high-temp and high humidity environments. Prevents corrosion due to wet or corrosive environments such as Fisheries, Ports and Chemical Storage.



### OUTSTANDING PERFORMANCE IN MANY APPLICATIONS



Building Materials



Chemicals



Lumber & Wood



Recycling



Foundries



Manufacturing

# MAINTENANCE

## MADE EASY



### EASY TO DIAGNOSE

Diagnostics are simple and quick needing only a cable and laptop. Spend less time searching for error codes, and more time working with Bobcat 9 Series Diesels.

### EASY TO ACCESS

- Effortless engine hood opening
- Cabin or OHG opens to a full 60°
- Power tilt (option)
- Hood opening increased to 50° for ease of routine maintenance



### EASY TO SERVICE

- Easy access to all routinely serviced items
- CAN bus communication
- Central junction box for fuses and relays

### OPTIONAL AIR COMPRESSOR

- The new, economical and miniaturized air compressor makes it easier to manage and clean equipment.
- Primary applications: grease filling, air filter cleaning, radiator cleaning, cooling fan cleaning, OPC cleaning, engine compartment cleaning and tire pressure replenishment.

# LOWER COST OF OWNERSHIP

## FEWER SERVICE INTERVALS

- Engine oil change: Was 500 hr. – Now 1,000 hr.
- Transmission oil change: Was 1,000 hr. – Now 2,000 hr.
- Drive axle oil change: Was 500 hr. – Now 2,000 hr.
- Fuel filter replacement was 500 hr. – now 1,000 hr.
- **Total savings on 5-year routine maintenance = \$1,995**



## STRONGER MAJOR COMPONENTS

- Larger king pins and tapered roller bearings for a stronger axle
- Angled rollers are stronger against side forces
- Tapered roller bearings have an inner race, eliminating wear on the king pin
- **Total savings on 5-year steer components = \$2,640**



## OIL COOLED DISC BRAKES (OCDB)

- Exclusive 5 Year/10,000 hr. warranty
- Enclosed system, practically no maintenance required
- Multi-Disc, OCDBs provide smooth, consistent stopping power
- Keeps brakes cool in any application
- **Total savings on 5-year brake repairs = \$3,670**



## D70S-9 SERIES TOTAL COST OF OWNERSHIP ASSESSMENT

5-Year Repair/Maintenance	Competitor	Bobcat
Planned Maintenance Services	\$2,106	\$1,911
Steer Axle Services & Repair	\$2,640	\$0
Brake Services & Repair	\$4,415	\$745
<b>TOTAL</b>	<b>\$9,161</b>	<b>\$2,656</b>

## \$6,505\* IN SAVINGS

Operating the 9 Series for 5 years can save you 71% (over \$6,500) versus competitive models!

\* Total cost of ownership savings will vary by application and hours used.

## ADDITIONAL SAVINGS

- Increased fuel economy, Eco mode can save you up to 1 liter of fuel per hour.
- Longer-lasting LED lamps
- Maintenance-free valve clearance

The purchase and ownership of a Bobcat forklift includes access to a highly knowledgeable and responsive customer support team.

As a Bobcat customer, your authorized factory-trained dealer will provide the best after-sales service and support, all backed by Bobcat's own customer service center. In addition, Bobcat's excellent parts fill rate will ensure minimal downtime.

The Bobcat network starts with your local dealer and extends to a national team of qualified and experienced personnel, ready to support a wide array of material handling needs.

# STANDARD FEATURES

## AND OPTIONAL EXTRAS

SAFETY	STANDARD	OPTIONAL
Guardian Stability System (GSS)	•	
Mast Interlock – Tilt, Lift and Lower	•	
Operator Sensing System (OSS)	•	
Anti-Cinch Orange Seat Belt	•	
Travel Speed Control	•	
Back-Up Alarm	•	
Rear Grab Bar w/ Horn	•	
Auto Deceleration	•	
Interlocking Seat Belt		•
Interlocking 4th Lever		•
Spark Arrester		•
Front & Rear View Cameras		•
Proximity Sensors		•
PRODUCTIVITY	STANDARD	OPTIONAL
Electric Controlled TCI (Turbo Charged Intercooler) Bobcat Engine	•	
Low Pressure Pedal (Accelerator, Brake and Inching)	•	
Inching Pedal	•	
LED Lighting	•	
Hi-Viz Mast	•	
3 Performance Modes (ECO/STD/HIGH)	•	
Vehicle Control Unit (VCU)	•	
Transmission Control Unit (TCU)	•	
Load Weight Indicator		•
Autotilt Leveling		•
ERGONOMICS	STANDARD	OPTIONAL
Adjustable Steering Column	•	
Integrated Display	•	
Easy Entry & Exit	•	
Full Cabin with Heater or Air Conditioner		•
Premium Seat: Suspension, Heat, Head Restraint		•
Powered Cabin Tilt		•
DURABILITY	STANDARD	OPTIONAL
Electronic Control Units (ECU) Cover	•	
IP67 Water-Resistant Connectors	•	
Dual Element Air Cleaner	•	
Full-Floating Driveaxle (with OCDB)	•	
Autoshift Controller	•	
Tilt Cylinder Cover	•	
Heavy-Duty Cooling	•	
Radiator Screen		•
Vented Side Panel		•
Engine Pre-Cleaner		•
SERVICEABILITY	STANDARD	OPTIONAL
CAN bus Communication System	•	
Electric Tilttable Cabin	•	
Ease of Service	•	
– Integrated Electric Components in the Junction Box (Relays and Fuses)	•	
– Wide Opening Cabin (60°)	•	
– Wide Engine Cover Opening Range	•	
ENVIRONMENT	STANDARD	OPTIONAL
Emission Regulation (Tier 4)	•	
Ultra Low Particulate Combustion (ULPC) System (with DOC)	•	
ISO 9001/ISO 14001	•	



Certain specification(s) are based on engineering calculations and are not actual measurements. Specification(s) are provided for comparison purposes only and are subject to change without notice. Specification(s) for your individual Bobcat equipment will vary based on normal variations in design, manufacturing, operating conditions, and other factors. Where applicable, dimensions are in accordance with ISO standards. Specifications and design are subject to change without notice. Pictures of Bobcat units may show other than standard equipment. All dimensions are given for material handling equipment with standard tires. All dimensions are shown in inches. Respective metric dimensions are enclosed by parentheses. Bobcat Company complies with the requirements of ISO9001 as registered with BSI.



Bobcat Company is a member of the Doosan Group. Doosan is a global leader in construction, grounds maintenance and material handling equipment, power and water solutions, and engineering that has proudly served customers and communities for more than a century. Bobcat®, the Bobcat logo and the colors of the Bobcat machine are registered trademarks of Bobcat Company in the United States and various other countries.  
©2025 Bobcat Company. All rights reserved.

**DOOSAN**

**BOBCAT COMPANY • 250 EAST BEATON DRIVE • WEST FARGO, ND 58078 • BOBCAT.COM**

**B-3308 (04/25)**  
EP-M-0425-8388321717-E