

M A P

of a part of The
Village of North Linden, Being

a replat of Blocks 8, 9, 10, 11, 12, 13, 14, 16, 17, 18 and west part of Block 15 in the Village of North Linden as platted by Mellen Davenport January 31, 1867 and described as beginning at a point from which the quarter part of West line of Section No. Twenty in Township No. 5 North of Range No. 6 East, Securus County, Michigan, bears south distant one thousand and twenty eight feet, thence North along Section line thirteen hundred and twenty five feet to the West line of the Detroit and Milwaukee Railroad land - thence South sixty two degrees east fifteen hundred and one feet to the West line of Main Street - thence South sixty feet to the West line of First Street - thence West one hundred and thirty feet, thence South five hundred and eighty feet, thence West eleven hundred and eighty feet to the place of beginning - Being situated on West half of North east quarter of Section No. Twenty, Township No. five North of Range No. Six East, Securus County, Michigan.

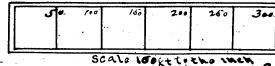

Dedication

Know all men by these presents that the land laid out and platted on the annexed Map is owned by Catho. Duthuland, of the City of Ann Arbor, Asa S. Whitehead, of the Town of Argoshtown, Securus County and George J. Gorman of the Town of Denton, same County, all of the State of Michigan. That the said Map or plat is now executed by the said Catho. Duthuland, Asa S. Whitehead and George J. Gorman as proprietors and Stephen Mathewson as Surveyor, in accordance with the provisions of an Act to provide for recording Town plats and vacating the same in certain cases, and the Acts amendatory thereto, and for the purpose of being recorded as "Map of a part of the Village of North Linden" - The size of the lots and the width of the Streets are given on said Map in feet. In Witness whereof we have hereunto set our hands and seals this (11th) eleventh day of April A.D. One thousand eight hundred and sixty eight -

Superintendent
 Jas. B. Moshier
 J. B. Hyatt

Catho. Duthuland
 George J. Gorman
 Asa S. Whitehead
 Stephen Mathewson

State of Michigan
 County of Securus do On this eleventh day of April A.D. One thousand eight hundred and sixty eight, before me a Notary Public for said County personally appeared the above named Catho. Duthuland, Asa S. Whitehead, George J. Gorman and Stephen Mathewson known to me to be the persons who executed the annexed plat, and acknowledged they executed the same for the purposes therein set forth.

Jas. B. Moshier
 Notary Public for Securus County.

Registers Office }
 Securus County } ex. Received for record Sept. 8th
 A.D. 1868 at 4 o'clock P.M. and recorded in Liber
 68 of Deeds at page 0

John Algar
 Register

7170

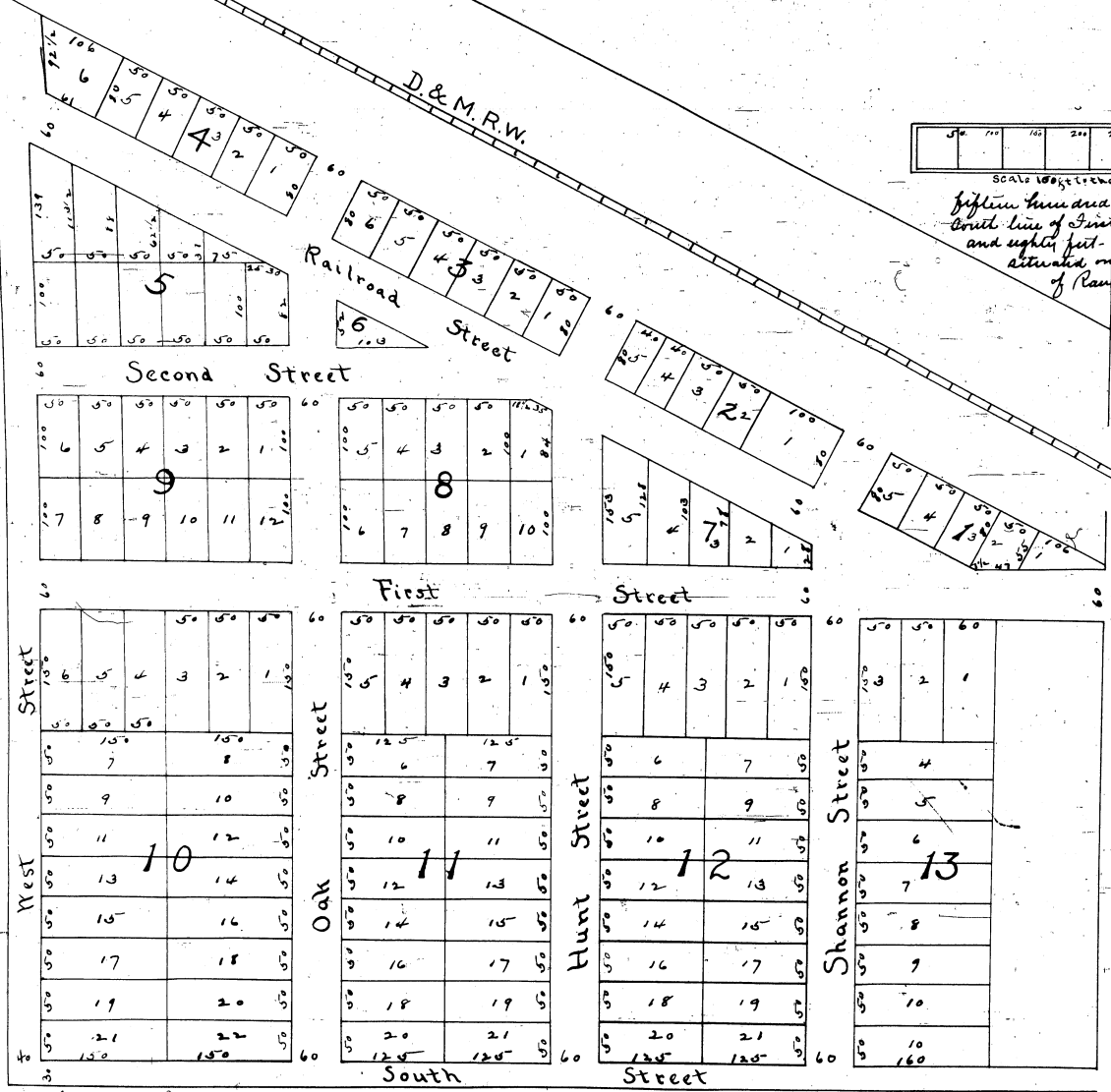

I hereby certify that this plat is a correct copy of the plat now on record in the Register of Deeds office, being made under the supervision of the Auditor General by tracing the plat on record and affixing thereto a carefully compared copy of the dedication and Certificate. Dated this 27th day of January 1910 -
 George P. McCoy, Clerk Auditor General's Department.